

9172  
UNDERGROUND EASEMENT  
(Individuals/Trustees, Corporations,  
Partnerships, L.L.C.s, etc.)

TO BE RECORDED: YES x NO     

This instrument prepared by:

STATE OF ALABAMA }  
COUNTY OF Shelby }  
TAX ID # 23-5-22-0-002-009.002

W.E. No. 61700-00-0366-6  
Parcel No. 70184180  
Transformer No. 15282

Valerie J. Acocella  
Alabama Power Company  
P. O. Box 2641  
Birmingham, Alabama 35291

KNOW ALL MEN BY THESE PRESENTS, THAT Phillip J. Knight, ~~a married man~~ AN UNMARRIED MAN as (the "Grantor", whether one or more) for and in consideration of One and No/Dollars (\$1.00), and other good and valuable consideration, to Grantor in hand paid by Alabama Power Company (the "Company") a corporation, the receipt of which is hereby acknowledged, doers hereby grant to Company, its successors and assigns, the right from time to time to construct, install, operate and maintain, along a route not greater than ten feet (10') in width to be selected by the Company which is generally shown on the attached drawing, all conduits, cables, trans closures and other appliances and facilities useful or necessary in connection therewith (collectively, "Facilities"), for the underground transmission and distribution of electric power and also the right to clear and keep clear a strip of land extending five feet (5') to either side of the center line of said underground Facilities upon, over, under and across the following described real property situated in Shelby County, Alabama (the "Property"), to wit:

**Lot 1 of Griffin's Addition to Alabaster as recorded in Map Book 28, Page 92 and being situated in the South Half of the Southwest Quarter of Section 22, Township 21 South, Range 3 West and recorded in Deed Record 20060131000049790 in the Office of the Judge of Probate in Shelby County, Alabama.**

Together with all the rights and privileges necessary or convenient for the full enjoyment or use thereof, including the right of ingress and egress to and from said facilities and the right to excavate for installation, replacement, repair and removal thereof; and also the right to cut and keep clear any and all obstructions or obstacles of whatever character on, under and above said facilities.

TO HAVE AND TO HOLD such easement to Company, its successors and assigns, forever.

IN WITNESS WHEREOF, 1 have set my hand(s) and seal(s) this the 15<sup>th</sup> day of November, 2006.

WITNESS:

GRANTOR(S):

[Signature]

(SEAL)

(SEAL)

By: \_\_\_\_\_ (SEAL)

As:

IN WITNESS WHEREOF, the said Grantor, has caused this instrument to be executed by \_\_\_\_\_ its authorized representative, as of the \_\_\_\_\_ day of \_\_\_\_\_, 2006.

  
20061218000612920 1/3 \$17.50  
Shelby Cnty Judge of Probate, AL  
12/18/2006 07:30:25AM FILED/CERT

ATTEST (if corporation) or WITNESS:

(Grantor - Name of Corporation/Partnership/LLC)

By: \_\_\_\_\_

By: \_\_\_\_\_ (SEAL)

Its: \_\_\_\_\_

Its: \_\_\_\_\_

[indicate President, General Partner, Member, etc.]

INDIVIDUAL NOTARIES

STATE OF ALABAMA }  
COUNTY OF SHELBY }

I, the undersigned, a Notary Public, in and for said County in said State, hereby certify that Phillip J Knight whose name(s) ~~is~~ are signed to the foregoing instrument and who is/~~are~~ known to me, acknowledged before me on this day that being informed of the contents of the instrument, he/~~she~~/they executed the same voluntarily, on the day the same bears date.

Given under my hand and official seal this the 15 day of November, 2006.

[SEAL]

Valerie J Acocella  
Notary Public  
My commission expires: 8-12-09

STATE OF ALABAMA }  
COUNTY OF \_\_\_\_\_ }

I, the undersigned, a Notary Public, in and for said County in said State, hereby certify that \_\_\_\_\_ whose name(s) is/are signed to the foregoing instrument and who is/are known to me, acknowledged before me on this day that being informed of the contents of the instrument, he/she/they executed the same voluntarily, on the day the same bears date.

Given under my hand and official seal this the \_\_\_\_\_ day of \_\_\_\_\_, \_\_\_\_\_.

[SEAL]

\_\_\_\_\_  
Notary Public  
My commission expires: \_\_\_\_\_

TRUSTEE/CORPORATION/PARTNERSHIP/LLC NOTARY

STATE OF ALABAMA }  
COUNTY OF \_\_\_\_\_ }

I, the undersigned, a Notary Public, in and for said County in said State, hereby certify that \_\_\_\_\_, whose name as \_\_\_\_\_ of \_\_\_\_\_ a \_\_\_\_\_ [as \_\_\_\_\_], is signed to the foregoing instrument, and who is known to me, acknowledged before me on this day that being informed of the contents of the instrument, he/she, as such \_\_\_\_\_ and with full authority, executed the same voluntarily for and as the act of said \_\_\_\_\_ [acting in such capacity as aforesaid].

Given under my hand and official seal, this the \_\_\_\_\_ day of \_\_\_\_\_, \_\_\_\_\_.

[SEAL]

\_\_\_\_\_  
Notary Public  
My commission expires: \_\_\_\_\_

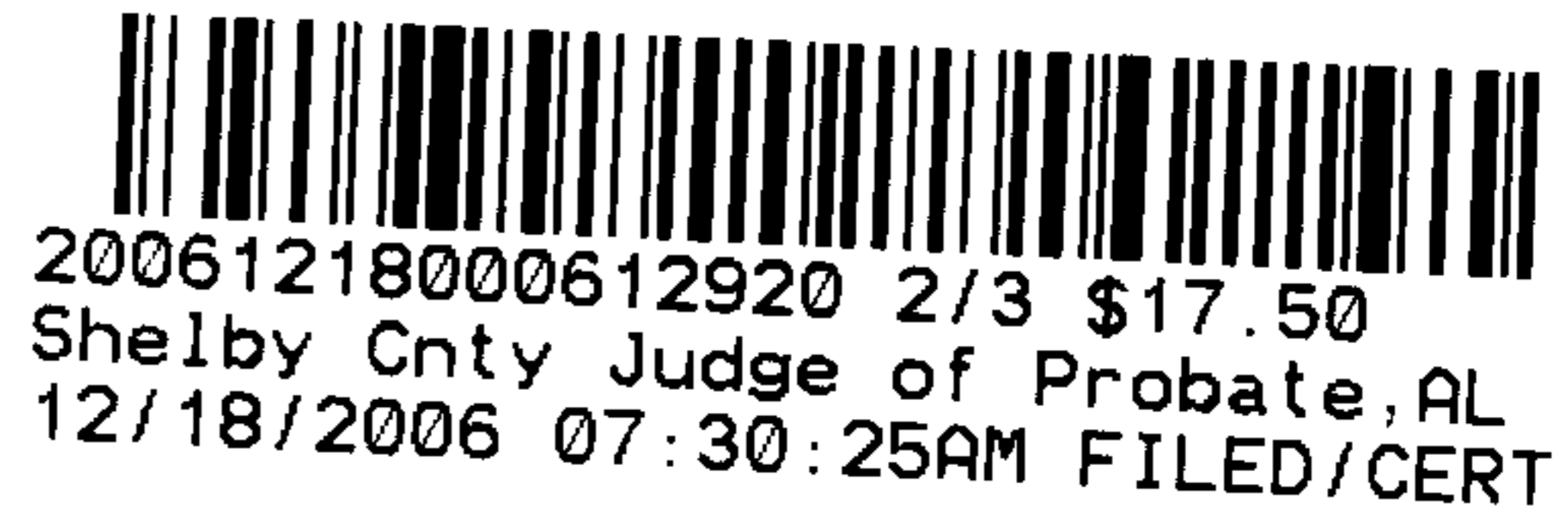

=====

**For Alabama Power Company Corporate Real Estate Department Use Only**

All facilities on Grantor: ☒ Station to Station: STA 1400 to STA 14204

SKETCH OF PROPOSED WORK  
SIMPLIFIED W.E.Map Center UTM  
1687965 12048371Map Center Lat/Lon  
-86.844523 33.189906

Customer PHILLIP KNIGHT		Location 750 MISSION HILLS RD		Agreed Serv. Date 9/13/06		Estimate No. 61700-00-03666	
Region METRO-SOUTH		Oper. Cntr. MONTEVALLO		Town/City ALABASTER		UserID wbphilli	
County Shelby		Section 22		Township 21S		Range 03W	
Acquisition Agent ACOCCELLA		Date R/W Assigned 8-11-06		Date R/W Cleared 11-15-06		Spatial Reference D3W-21S-22-3	
Voltage 19.9KV		Phone Co		CATV Co		Accessibile Y	
Trac Crew N		Rock Hole N		Permits		R/W City County State Miss All Other	

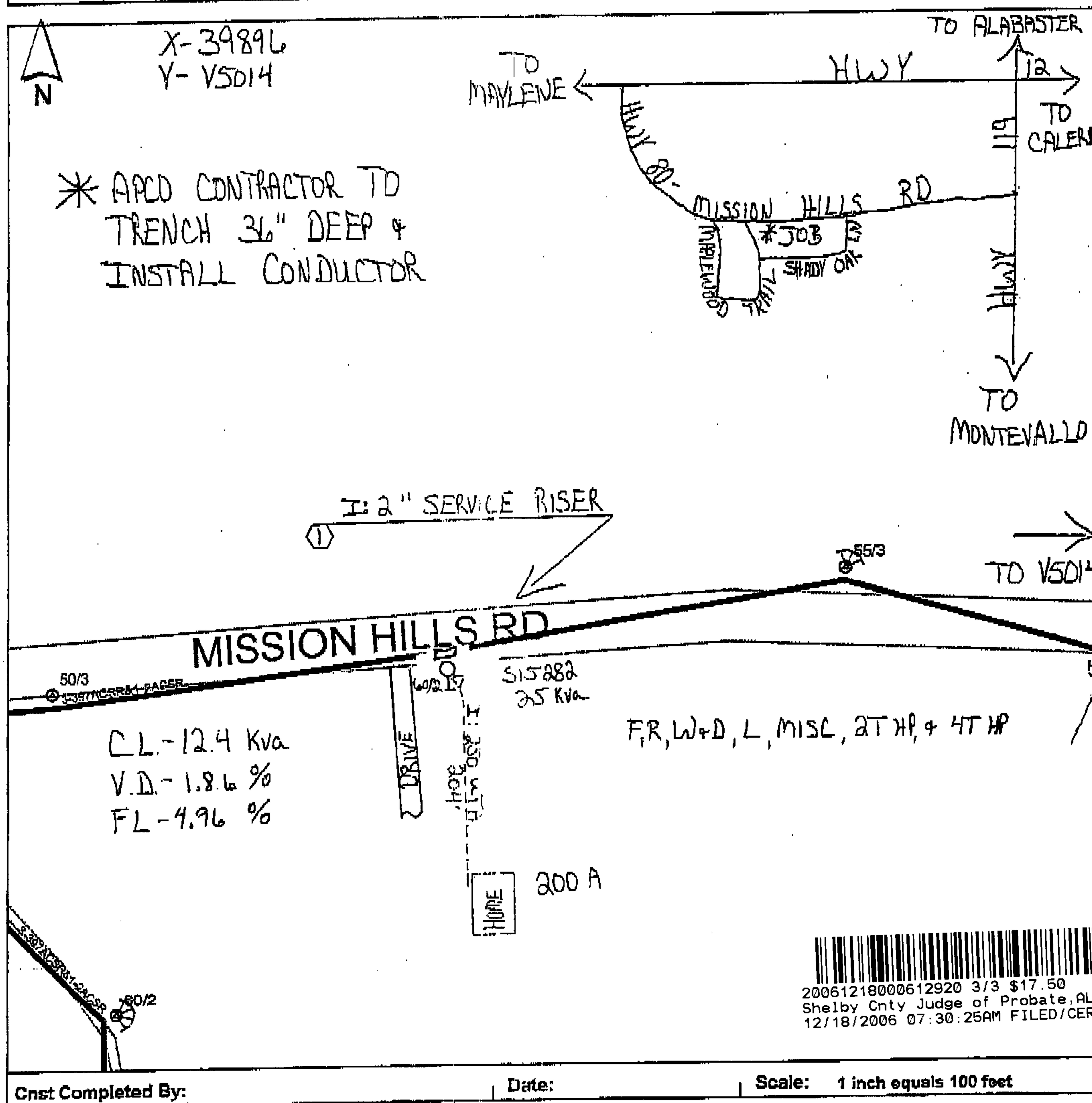

Cnst Completed By:

Date:

Scale: 1 inch equals 100 feet