

EASEMENT - DISTRIBUTION FACILITIES
(Metes and Bounds)

\$20.50

TO BE RECORDED: YES ☒ NO ☐

Sta 3+00 to 4+00

This instrument prepared by:

Matt Fields

Alabama Power Company

P. O. Box 2641

Birmingham, Alabama 35291

STATE OF ALABAMA

COUNTY OF Shelby

TAX ID # _____

W.E. No. 61730-06-00176

Parcel No. 70178926

Transformer No. _____

A. GRANT KNOW ALL MEN BY THESE PRESENTS, That Cahaba Beach Investments LLC

as grantors (s), (the "Grantor", whether one or more) for and in consideration of One and No/100 (\$1.00) and other good and valuable consideration, to Grantor in hand paid by Alabama Power Company, a corporation, the receipt and sufficiency of which are hereby acknowledged, does hereby grant to Alabama Power Company, its successors and assigns (the "Company"), the easements, rights and privileges described and designated in Section B below.

B. RIGHTS The easements, rights and privileges granted hereby are as follows:

- Overhead and/or Underground.** The right from time to time to construct, install, operate and maintain, upon, over, under and across the Property described in Section C below, along a route to be selected by the Company which is generally shown on the Company's final location drawing (which shows the general location of underground Facilities, if any, by indicating an area not greater than ten feet (10') in width), all poles, towers, wires, conduits, fiber optics, cables, trans closures, transformers, anchors, guy wires and other Facilities useful or necessary in connection therewith (collectively, "Facilities"), for the overhead and/or underground transmission and distribution of electric power, and also the right to clear and keep clear a strip of land extending five feet (5') to either side of the center line of underground Facilities and fifteen feet (15') to either side of the center line of overhead Facilities; further, the right in the future to install and utilize intermediate poles in line for overhead Facilities and the right to trim and cut and keep trimmed and cut all dead, weak, leaning or dangerous trees or limbs outside of the thirty foot (30') strip for overhead Facilities that, in the sole opinion of the Company, might now or may hereafter endanger, interfere with or fall upon any of the overhead Facilities.
- Line Clearing.** The right to trim and cut and keep trimmed and cut all dead, weak, leaning or dangerous trees or limbs that, in the sole opinion of the Company, might now or may hereafter endanger, interfere with or fall upon the electric transmission or distribution lines, poles, towers or other Facilities now or hereafter located adjacent to the Property described in Section C below along a route to be selected by the Company generally shown on the Company's final location drawing, and also the right to clear and keep clear all trees, undergrowth, and other obstructions on property in which Grantor has an interest within fifteen feet (15') of the center line of the lines of such poles, towers or other Facilities.
- Guy Wires and Anchors.** The right to implant, install and maintain anchor(s) of concrete, metal or other material on and under the Property described in Section C below, and to construct, extend and maintain guy wires from such anchor(s) to structures now or hereafter erected adjacent to such Property or property adjacent thereto (collectively, "Guy Wire Facilities") along a route to be selected by the Company generally shown on the Company's final location drawing; and also the right to trim and cut and keep trimmed and cut all dead, weak, leaning or dangerous trees or limbs that, in the sole opinion of the Company, might now or may hereafter endanger, interfere with or fall upon any of the Guy Wire Facilities.

Grantor hereby grants to the Company all easements, rights and privileges necessary or convenient for the full enjoyment and use thereof, including without limitation the right of ingress and egress to and from the Facilities and Guy Wire Facilities, as applicable, and the right to excavate for installation, replacement, repair and removal thereof; and also the right to cut, remove and otherwise keep clear any and all structures, obstructions or obstacles of whatever character, on, under and above said Facilities and Guy Wire Facilities, as applicable.

C. PROPERTY DESCRIPTION The easements, rights and privileges granted hereby shall apply to, and the word "Property" as used in this instrument shall mean, the following described real property situated in Shelby County, Alabama (the "Property"):

A parcel of Land SE 1/4 / SE 1/4 of Section 25, Township 18S, Range 2W
Recorded in Deed Instrument 2005102400055050 in the office of Judge
of Probate Shelby County, AL

D. ADDITIONAL PROVISIONS. In the event it becomes necessary or desirable for the Company to move any of the Facilities in connection with the construction or improvement of any public road or highway in proximity to the Facilities, Grantor hereby grants to the Company the right to relocate the Facilities and, as to such relocated Facilities, to exercise the rights granted above; provided, however, the Company shall not relocate the Facilities on the Property at a distance greater than ten feet (10') outside the boundary or the right of way of any such public road or highway as established or re-established from time to time. This grant and agreement shall be binding upon and shall inure to the benefit of Grantor, the Company and each of their respective heirs, personal representatives, successors and assigns and the words "Company" and "Grantor" as used in this instrument shall be deemed to include the heirs, personal representatives, successors and assigns of such parties.

TO HAVE AND TO HOLD the same to the Company, its successors and assigns, forever.

IN WITNESS WHEREOF, the undersigned Grantor(s) has/have set his/her/their hand(s) and seal(s) this the 24th day of August, 20 06.

Witness

Witness

Witness

(Grantor)

(Grantor)

By:

As:

President



20061212000601460 1/4 \$20.50
Shelby Cnty Judge of Probate, AL
12/12/2006 11:51:13AM FILED/CERT

IN WITNESS WHEREOF, the said Grantor, has caused this instrument to be executed by _____
representative, as of the _____ day of _____, 20_____.

20061212000601460 2/4 \$20.50
Shelby Cnty Judge of Probate, AL
12/12/2006 11:51:13AM FILED/CERT

authorized

ATTEST (if corporation) or WITNESS:

(Grantor - Name of Corporation/Partnership/LLC)

By: _____
Its: _____

By: _____ (SEAL)
Its: _____

[indicate President, General Partner, Member, etc.]

INDIVIDUAL NOTARIES

STATE OF ALABAMA }
COUNTY OF _____ }

I, the undersigned, a Notary Public, in and for said County in said State, hereby certify that _____
_____ whose name(s) is/are signed to the foregoing instrument and who is/are known to me, acknowledged before me on
this day that being informed of the contents of the instrument, he/she/they executed the same voluntarily, on the day the same bears date.

Given under my hand and official seal this the _____ day of _____, _____.

[SEAL]

Notary Public
My commission expires: _____

STATE OF ALABAMA }
COUNTY OF _____ }

I, the undersigned, a Notary Public, in and for said County in said State, hereby certify that _____
_____ whose name(s) is/are signed to the foregoing instrument and who is/are known to me, acknowledged before me on
this day that being informed of the contents of the instrument, he/she/they executed the same voluntarily, on the day the same bears date.

Given under my hand and official seal this the _____ day of _____, _____.

[SEAL]

Shelby County, AL 12/12/2006
State of Alabama
Deed Tax: \$.50

Notary Public
My commission expires: _____

TRUSTEE/CORPORATION/PARTNERSHIP/LLC NOTARY

STATE OF ALABAMA }
COUNTY OF Jefferson }

I, the undersigned, a Notary Public, in and for said County in said State, hereby certify that Jonathan Belcher
_____, whose name as President of Cahaba Beach
Investment a LLC [as _____]
_____, is signed to the foregoing instrument, and who is known to me, acknowledged before me on this day that
being informed of the contents of the instrument, he/she, as such President and with full authority, executed the same voluntarily for and as the
act of said _____ [acting in such capacity as aforesaid].

Given under my hand and official seal, this the 24th day of August, 2006.

[SEAL]

Loretta Lynne White

Notary Public
My commission expires: _____
NOTARY PUBLIC STATE OF ALABAMA AT LARGE
MY COMMISSION EXPIRES: Apr 13, 2010
BONDED THRU NOTARY PUBLIC UNDERWRITERS

For Alabama Power Company Corporate Real Estate Department Use Only

All facilities on Grantor: _____

Station to Station: _____



SERIAL NO.	DATE	REMARKS	TIME	LOCATION
1000	10-10-68	1000 A	1000 A	1000 A
1001	10-10-68	1001 A	1001 A	1001 A
1002	10-10-68	1002 A	1002 A	1002 A
1003	10-10-68	1003 A	1003 A	1003 A
1004	10-10-68	1004 A	1004 A	1004 A
1005	10-10-68	1005 A	1005 A	1005 A
1006	10-10-68	1006 A	1006 A	1006 A
1007	10-10-68	1007 A	1007 A	1007 A
1008	10-10-68	1008 A	1008 A	1008 A
1009	10-10-68	1009 A	1009 A	1009 A
1010	10-10-68	1010 A	1010 A	1010 A
1011	10-10-68	1011 A	1011 A	1011 A
1012	10-10-68	1012 A	1012 A	1012 A
1013	10-10-68	1013 A	1013 A	1013 A
1014	10-10-68	1014 A	1014 A	1014 A
1015	10-10-68	1015 A	1015 A	1015 A
1016	10-10-68	1016 A	1016 A	1016 A
1017	10-10-68	1017 A	1017 A	1017 A
1018	10-10-68	1018 A	1018 A	1018 A
1019	10-10-68	1019 A	1019 A	1019 A
1020	10-10-68	1020 A	1020 A	1020 A
1021	10-10-68	1021 A	1021 A	1021 A
1022	10-10-68	1022 A	1022 A	1022 A
1023	10-10-68	1023 A	1023 A	1023 A
1024	10-10-68	1024 A	1024 A	1024 A
1025	10-10-68	1025 A	1025 A	1025 A
1026	10-10-68	1026 A	1026 A	1026 A
1027	10-10-68	1027 A	1027 A	1027 A
1028	10-10-68	1028 A	1028 A	1028 A
1029	10-10-68	1029 A	1029 A	1029 A
1030	10-10-68	1030 A	1030 A	1030 A
1031	10-10-68	1031 A	1031 A	1031 A
1032	10-10-68	1032 A	1032 A	1032 A
1033	10-10-68	1033 A	1033 A	1033 A
1034	10-10-68	1034 A	1034 A	1034 A
1035	10-10-68	1035 A	1035 A	1035 A
1036	10-10-68	1036 A	1036 A	1036 A
1037	10-10-68	1037 A	1037 A	1037 A
1038	10-10-68	1038 A	1038 A	1038 A
1039	10-10-68	1039 A	1039 A	1039 A
1040	10-10-68	1040 A	1040 A	1040 A
1041	10-10-68	1041 A	1041 A	1041 A
1042	10-10-68	1042 A	1042 A	1042 A
1043	10-10-68	1043 A	1043 A	1043 A
1044	10-10-68	1044 A	1044 A	1044 A
1045	10-10-68	1045 A	1045 A	1045 A
1046	10-10-68	1046 A	1046 A	1046 A
1047	10-10-68	1047 A	1047 A	1047 A
1048	10-10-68	1048 A	1048 A	1048 A
1049	10-10-68	1049 A	1049 A	1049 A
1050	10-10-68	1050 A	1050 A	1050 A
1051	10-10-68	1051 A	1051 A	1051 A
1052	10-10-68	1052 A	1052 A	1052 A
1053	10-10-68	1053 A	1053 A	1053 A
1054	10-10-68	1054 A	1054 A	1054 A
1055	10-10-68	1055 A	1055 A	1055 A
1056	10-10-68	1056 A	1056 A	1056 A
1057	10-10-68	1057 A	1057 A	1057 A
1058	10-10-68	1058 A	1058 A	1058 A
1059	10-10-68	1059 A	1059 A	1059 A
1060	10-10-68	1060 A	1060 A	1060 A
1061	10-10-68	1061 A	1061 A	1061 A
1062	10-10-68	1062 A	1062 A	1062 A



20061212000601460 4/4 \$20.50
Shelby Cnty Judge of Probate, AL
12/12/2006 11:51:13AM FILED/CERT

6/17/06
6/18/06
6/19/06

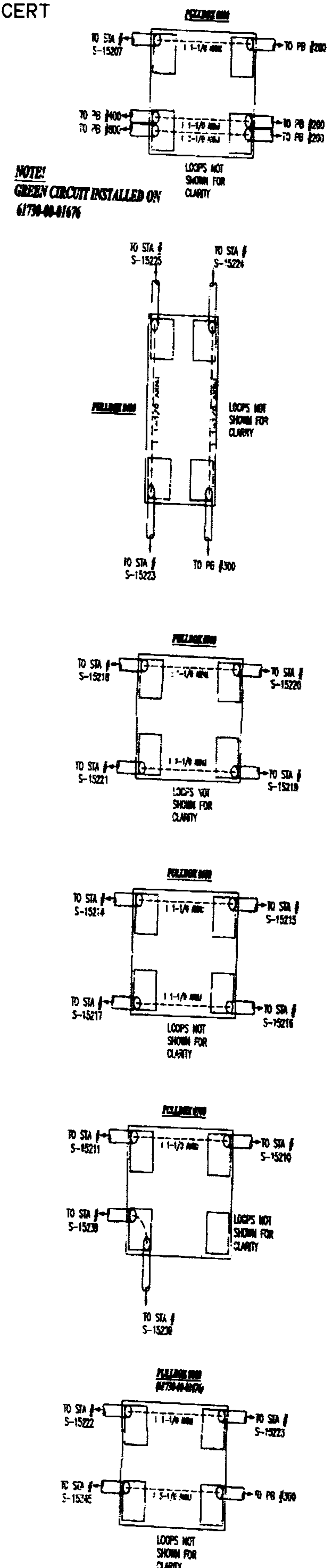


ENGINEER: WADE LOWMA
RADIO #11416
CONSTRUCTION COMPLE

DATE: _____

ANY CONSTRUCTION FIELD CHANG
ARE SHOWN IN RED ON THIS PRI

ALABAMA POWER COMPAN