



CITY OF MONTEVALLO

SHARON ANDERSON – Mayor
CAREY THOMPSON – City Clerk
KEVIN PETERS – Chief of Police



20060922000470830 1/7 \$29.00
Shelby Cnty Judge of Probate, AL
09/22/2006 09:24:08AM FILED/CERT

September 18, 2006

Shelby County
Recording Department
112 North Main Street
Columbiana, AL 35051

To Whom It May Concern,

I certify that the enclosed Resolution/Ordinance is a true and accurate copy of the original which approved the annexation of property belonging to Dr. Michael A. Remillard and Matsy L. Remillard.

Sincerely,

Carey Thompson
City Clerk

RESOLUTION 02J_{IC}

RESOLUTION 02J_{IC} TO SUSPEND THE AGENDA:

At the regularly scheduled city council meeting of 23 September 2002, council member ANDERSON introduced and council member BROWN seconded Ordinance **02J**, consenting to the annexation of certain property on owned by **Dr Michael A Remillard and wife Matsy L Remillard**, at 1895 Salem Road, Montevallo, AL 35115, and council member LIGHTFOOT, seconded by council member GOLDSMITH, asked for the unanimous consent of those present that the agenda be suspended so as to give said ordinance immediate consideration.

Whereupon, Mayor Parker called for a vote taken by yeas and nays on the request for immediate consideration, and the result of such vote was:

Yeas: Council members Anderson, Brown, Goldsmith, and Lightfoot.

Nays: None.

Whereupon Mayor Parker directed that the names of the members voting be entered on the minutes of the meeting in compliance with §11-45-2 of the *1975 Alabama Code*, and the council proceeded to give immediate consideration to Ordinance **02J**.

Approved and adopted this 23 September 2002.

Grady R Parker, Mayor

Attest:

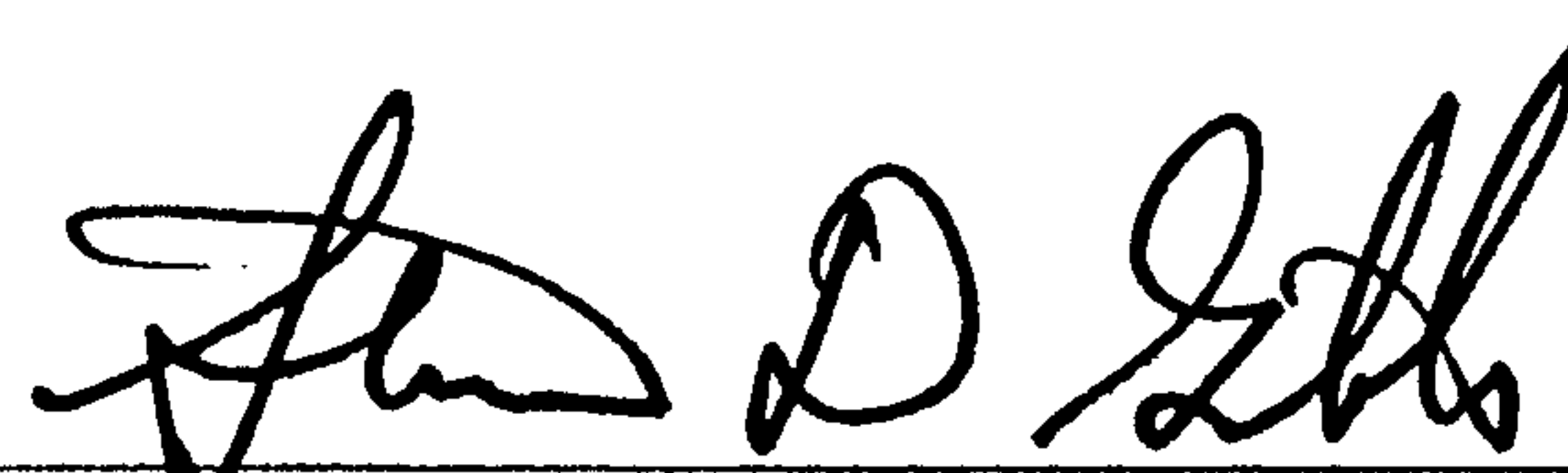
Steven D Gibbs, Clerk

ORDINANCE NUMBER 02J

COUNCIL MEMBER **ANDERSON** INTRODUCED THE FOLLOWING ORDINANCE.

COUNCIL MEMBER **BROWN** SECONDED THE ORDINANCE.

AN ORDINANCE ASSENTING TO A CERTAIN PETITION FOR ANNEXATION

WHEREAS, all of the owners of property located and contained within an area contiguous to the corporate limits of Montevallo, and not within the corporate limits of any other municipality, as provided in §11-42-21 of the *1975 Alabama Code*, have signed and filed a written petition with the City Clerk requesting that such property or territory be annexed to Montevallo, and

WHEREAS, said petition contains an accurate description of the property or territory proposed to be annexed together with a map of the said territory showing its relationship to the corporate limits of Montevallo,

BE IT ORDAINED BY THE MAYOR AND COUNCIL OF THE CITY OF MONTEVALLO, ALABAMA, AS FOLLOWS:

- ① That the City Council of the City of Montevallo, as and for its governing body, hereby assents to the annexation of that certain land described in the attached petition for annexation of: **Dr Michael A Remillard and wife Matsy L Remillard**, as provided in §11-42-21 of the *1975 Alabama Code* and other applicable law.
- ② That the annexed territory be zoned AO until it is rezoned by recommendation of the Montevallo Planning Commission.
- ③ That the annexed territory be made a part of Council District One until such time as Council Districts are redrawn pursuant to the US Census.
- ④ That the City Clerk is directed to file a copy of this ordinance, including a description of the property or territory annexed, in the office of the Judge of Probate of Shelby County, and to advertise this ordinance as provided by law.

This ordinance shall become effective upon its passage and advertisement as

provided by law.

Approved and adopted this 23 September 2002.

20060922000470830 4/7 \$29.00
Shelby Cnty Judge of Probate, AL
09/22/2006 09:24:08AM FILED/CERT



Mayor Grady R Parker

Attest:

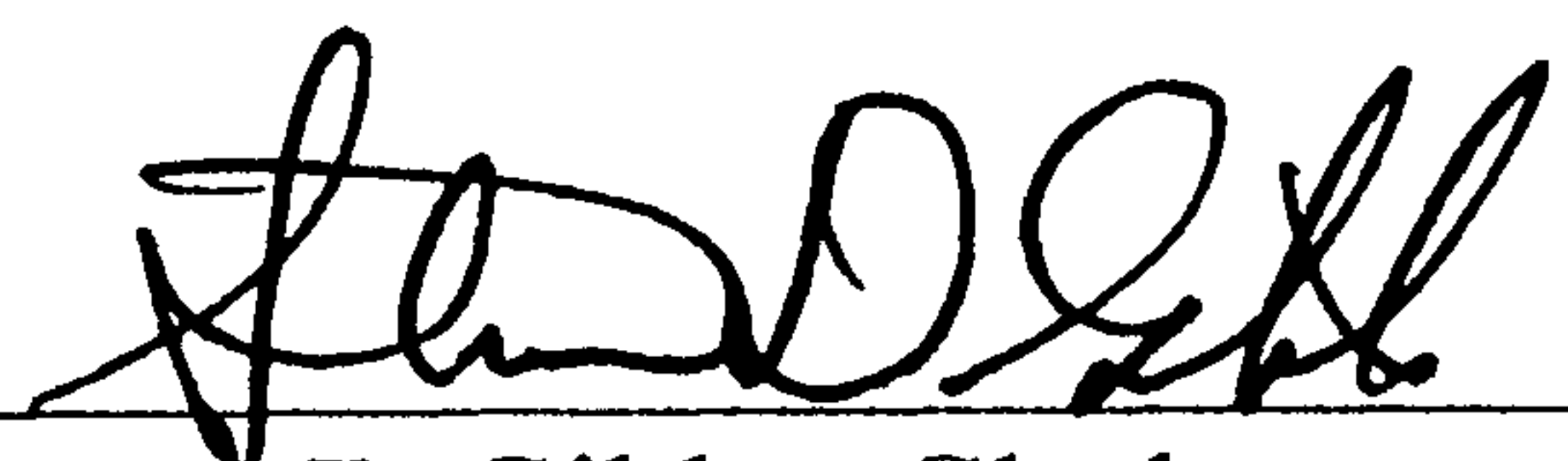

Steven D Gibbs, Clerk

I certify that the attached Ordinance **02J**, consenting to the annexation of certain territory, adopted by the Montevallo City Council on 23 September 2002, was, pursuant to §11-45-8(b) of the *1975 Alabama Code*, posted in conspicuous places within the community:

- ① the mayor's office, City Hall, 545 Main Street, Montevallo
- ② the city shop, 445 Selma Road, Montevallo
- ③ the Park and Recreation Building, Orr Park, 420 Vine Street, Montevallo
- ④ the Parnell Memorial Library, 820 Valley Street, Montevallo

beginning 24 September 2002 and continuing for more than four weeks thereafter.

According to §11-45-8(b), Ordinance **02J** therefore became effective 29 September 2002.

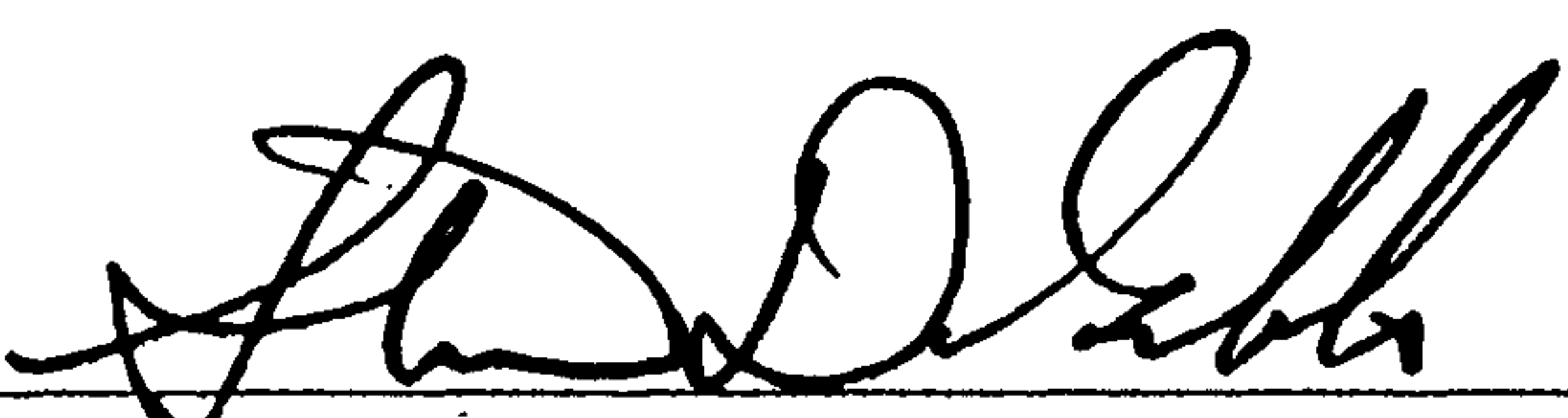

Steven D Gibbs, City Clerk

Petition for Annexation

20060922000470830 5/7 \$29.00
Shelby Cnty Judge of Probate, AL
09/22/2006 09:24:08AM FILED/CERT

Mayor Grady R. Parker
City of Montevallo
545 Main Street
Montevallo, AL 35115
205 665-2555

Dear Mayor Parker:

We are the property owners of a parcel of land described on the attached legal description and wish to be annexed into the City of Montevallo. Please consider this request at your earliest convenience.

Michael A. Remillard
Owner

Matsy L. Remillard
Owner

205-987-2683
Telephone Number
4695 Vintage Lane
Birmingham, AL 35244
Mailing Address

1895 Salem Road
Physical Address

9-5-02
Date

Attached is a:

☒ Legal description or

____ Tax Parcel Identification number: 27-3-08-0-000-018.000
(found on your tax notice)

____ Name of property owner as recorded on county records: _____

Michael A Remillard
Matsy L. Remillard

LEGAL DESCRIPTION

20060922000470830 6/7 \$29.00
Shelby Cnty Judge of Probate, AL
09/22/2006 09:24:08AM FILED/CERT

EXHIBIT "A"

The S $\frac{1}{2}$ of the SE $\frac{1}{4}$ of the NE $\frac{1}{4}$ and the N $\frac{1}{2}$ of the NE $\frac{1}{4}$ of the SE $\frac{1}{4}$ of Section 8, Township 22 South, Range 3 West, Shelby County, Alabama.

ALSO, Easement/Right of Way Description:

A 30-foot perpetual easement and right of way for ingress and egress situated in the South $\frac{1}{2}$ of the NW $\frac{1}{4}$ of Section 9, Township 22 South, Range 3 West, the centerline of which is more particularly described as follows:

Beginning at the NE corner of the S $\frac{1}{2}$ of the NE $\frac{1}{4}$ of the SE $\frac{1}{4}$ of Section 8, Township 22 South, Range 3 West, and run North 35 degrees 39 minutes 06 seconds East for a distance of 278.42 feet to a point; thence turn North 23 degrees 31 minutes 06 seconds East for a distance of 209.71 feet to a point; thence run North 57 degrees 53 minutes 06 seconds East for a distance of 140.0 feet to a point; thence run North 23 degrees 49 minutes 24 seconds East for a distance of 202.91 feet to a point; thence run North 36 degrees 20 minutes 01 seconds East for a distance of 150.69 feet to a point; thence run North 89 degrees 39 minutes 05 seconds East for a distance of 48.69 feet to the point of ending of that certain 30-foot perpetual easement and right of way established by Civil Action E708-75 in Shelby County, Alabama, Civil Court of October 3, 1975.

ALSO, a 30-foot perpetual easement and right of way for ingress and egress granted by the Circuit Court in Shelby County, dated October 3, 1975, Civil Action E708-75,

Description of easement is as follows:

A portion of the S $\frac{1}{2}$ of the NW $\frac{1}{4}$ of Section 9, Township 22 South, Range 3 West, Shelby County, Alabama, described as follows: Commencing at the SE corner of said subdivision of said Section; thence North 11 chains and 77 links to a post; thence West and parallel with the South line of said subdivision of said Section to a point on the West right of way line of Shelby County Highway No. 15, which is the point of beginning of the 30-foot easement and right of way herein conveyed; thence continue along said course to a post on the East line of the W $\frac{1}{2}$ of the SW $\frac{1}{4}$ of the NW $\frac{1}{4}$ of said Section 9; thence run South along the East line of said 20 acres for a distance of 30 feet to a point; thence run East and parallel with the South line of said subdivision of said Section to a point on the West right of way of Shelby County Highway No. 15; thence run in a Northerly direction along said West right of way line to the point of beginning. Situated in Shelby County, Alabama.

This easement is subject to the Order of the Circuit Court of Shelby County, Alabama, dated September 20, 1994, Civil Action CV-93-689, specifying the agreement of the use of the easement.

M.A.R. M.R.

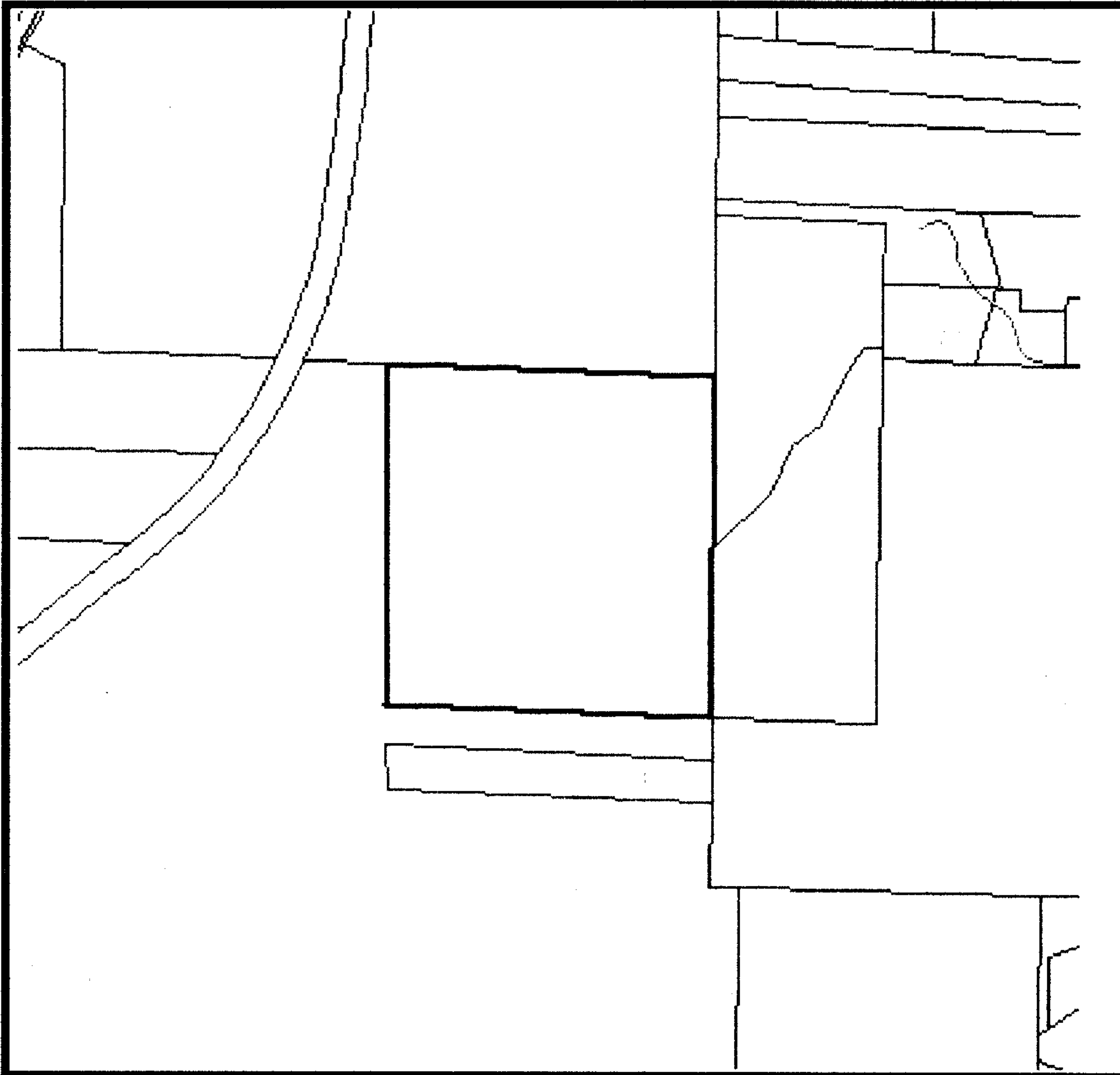

20060922000470830 7/7 \$29.00
Shelby Cnty Judge of Probate, AL
09/22/2006 09:24:08AM FILED/CERT

Property Information - 27 3 08 0 000 018.000**Owner Information**

Name 1	Name2	Address 1	Address 2	City	State	Zip Code
REMILLARD MICHAEL A & MATSY L		660 HAVENWOOD TRAIL		MONTEVALLO	AL	35115
Subdivision	Primary Lot	Secondary Lot	Block	Section	Township	Range
			000	8	22S	03W
Map Book	Map Page	Lot Dimension 1	Lot Dimension 2	Number of Acres	Square Feet	
0	0	0	0	41	1785960	

Description

S1/2 OF SE1/4 OF NE1/4 & N1/2 OF NE1/4 OF SE1/4 SEC8

Document Information

Recorded Date	Recorded Number
20000228	20000000688200000
19980518	19990002118400000
19941212	19940003637400000