

ORDINANCE 06-0501

20060721000352630 1/6 \$26.00
Shelby Cnty Judge of Probate, AL
07/21/2006 09:01:30AM FILED/CERT

Councilman William Rayfield introduced the following Ordinance:

WHEREAS, on the 01st day of May, 2006

The persons whose names are signed thereto, filed a petition with the Clerk of the Town of Harpersville as required by Section 11-42-20 and 11-42-21, Code of Alabama 1975, petitioning And requesting that the property hereinafter described be annexed to the municipality of the Town of Harpersville, Alabama and requesting the Mayor and Council of said Town to adopt an Ordinance assenting to the annexation of said property to such municipality, which petition Contained and accurate description of the property or territory proposed to be annexed together With a map of said territory showing its relationship to the corporate limits of the Town of Harpersville, and the signatures of the owners of the property or territory described were signed Thereto;

NOW, THEREFORE, BE IT ORDAINED BY THE MAYOR AND COUNCIL OF THE TOWN OF HARPERSVILLE, ALABAMA AS FOLLOWS:

That the Town of Harpersville does adopt this ordinance assenting to the annexation of The following described property or territory to the municipality of the Town of Harpersville.

Said Property being described on Exhibit "A" attached hereto.

Be it further ordained that the corporate limits of the Town of Harpersville be extended An rearranged so as to embrace and include such property and such property or territory shall Become a part of the corporate area of such municipality upon the date of publication of this Ordinance, as provided for in section 11-42-20 and 11-42-21, Code of Alabama 1975.

Be it further ordained that the Clerk is hereby authorized and directed to file a copy of This ordinance, along with an accurate description of the property or territory being annexed, Together with a map of the said property or territory showing its relationship to the corporate Limits of the Town of Harpersville to which said territory or property is being presented to the Office of the Department of Justice for approval.

Be it further ordained that the Zoning Map of the Town of Harpersville, and any other Official maps or surveys of the Town, shall be amended to reflect the annexation of properties Being presented for approval.

George Dele
MAYOR

ATTEST: Joyce Robertson, Town Clerk



20060721000352630 2/6 \$26.00
Shelby Cnty Judge of Probate, AL
07/21/2006 09:01:30AM FILED/CERT

TOWN OF HARPERSVILLE
PETITION FOR UNANIMOUS CONSENT

We the undersigned, constituting all of the hereinafter described real property do hereby execute and file with the Town of Harpersville clerk this written petition asking and requesting that our property hereinafter described be annexed to the town of Harpersville, under authority of section 11-42-20 throughout 11-42-24 code of Alabama, 1975.

Said property is described as follows:

Property Owners: **CAHABA FORESTS LLC.**

Tax ID #: **04-3499315**

See attached Map and Property Inquiry for legal description.

We further certify that said property, is contiguous to the Town of Harpersville. We further certify that all the property included in the above described which lies within the police jurisdiction of both the annexing municipality and another municipality is located closer to the annexing municipality than to the other municipality as required by sections 11-42-21 code of Alabama, 1975

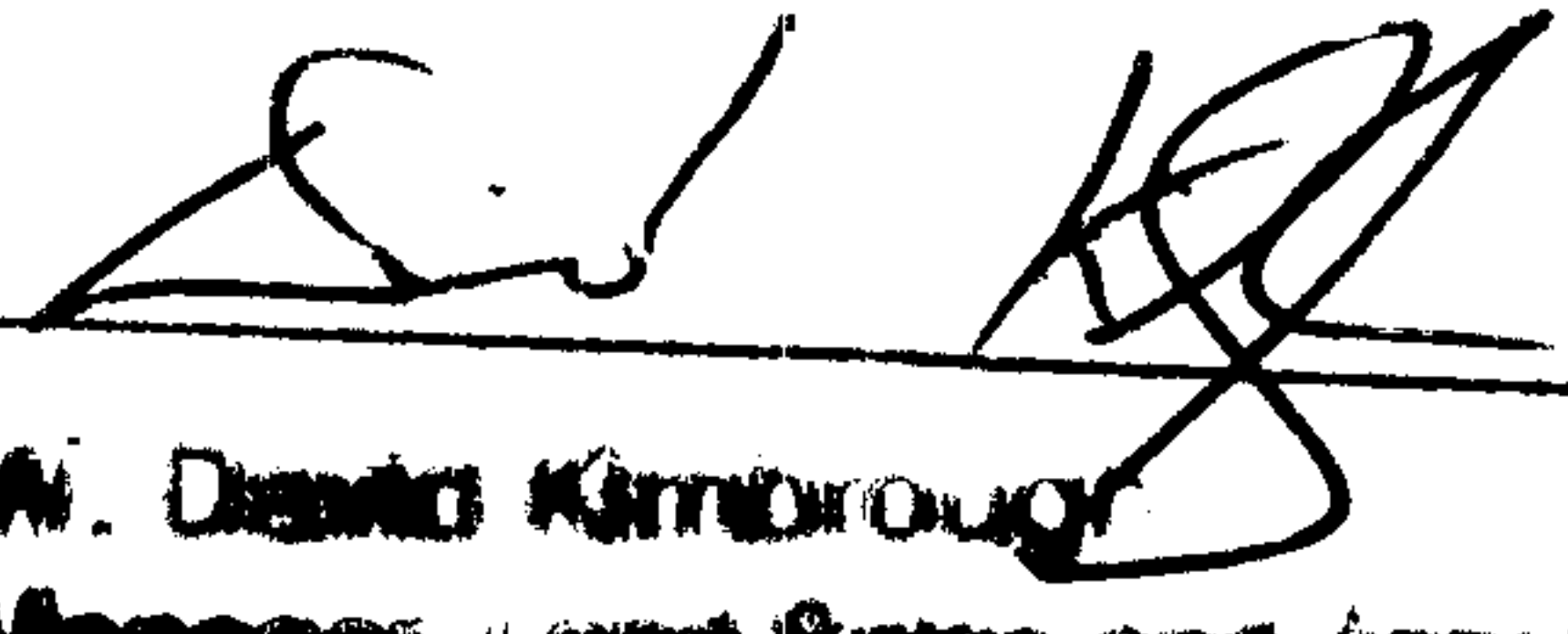
W. David Kimbrough
Manager, Land Sales and Asset Evaluation

176130 000 002.001

171120 000 007.002

17112 0000 007.001

ANNEXATION CHECK LIST

Copy of petition signed by property owners	
Map of Property	YES
Description of Property	YES
Names of Property Owners	
How many single family dwellings on property	
How many people live on parcel of land	
How many are of voting age	
How many are not of voting age	
The race of each person	
Reason for annexation	
Police + Fire Protection	

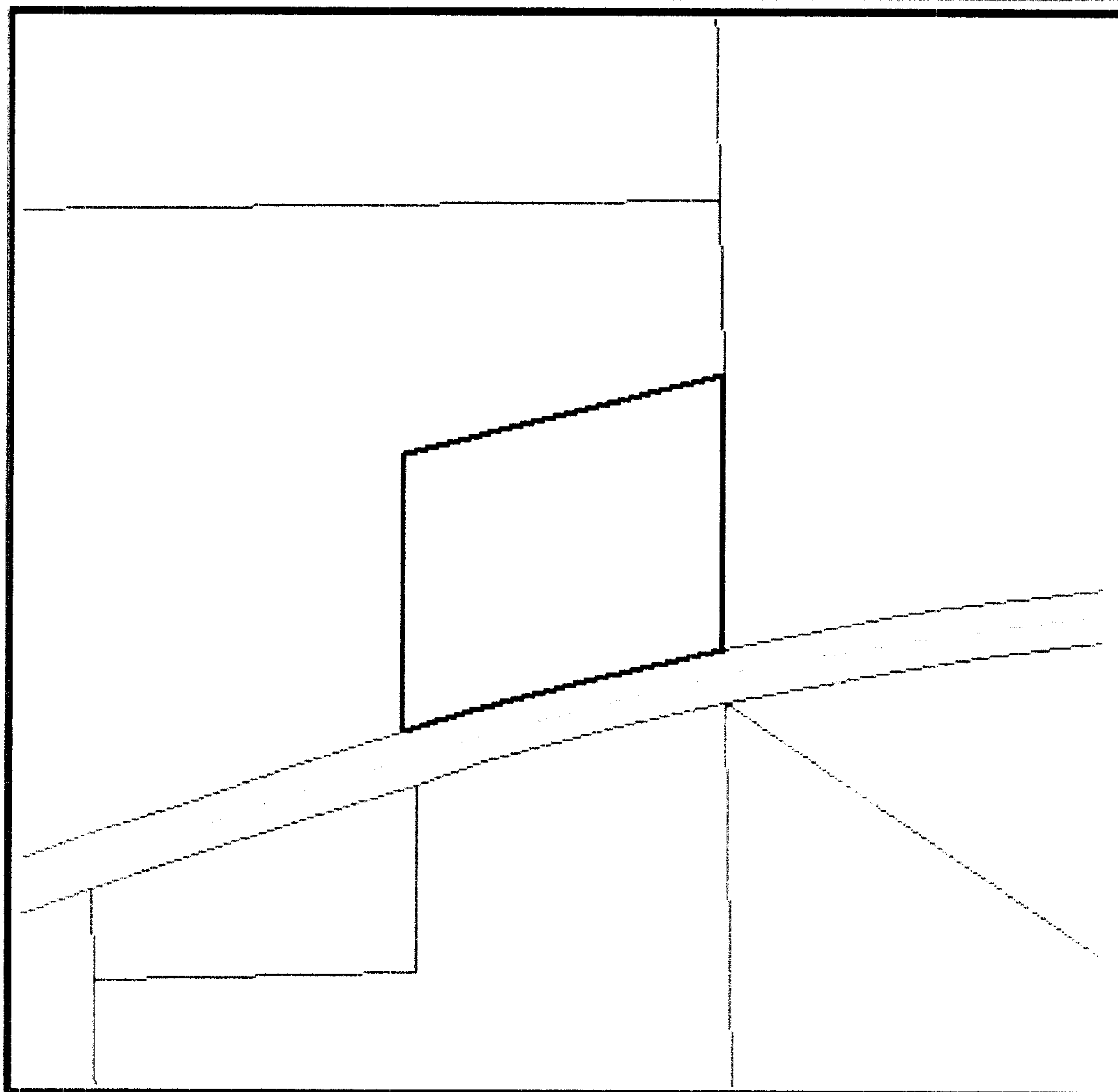

20060721000352630 3/6 \$26.00
Shelby Cnty Judge of Probate, AL
07/21/2006 09:01:30AM FILED/CERT

Property Information - 17 1 12 0 000 007.001**Owner Information**

Name 1	Name2	Address 1	Address 2	City	State	Zip Code
CAHABA FORESTS LLC		3891 KLEIN RD		HARPERSVILLE	AL	35078
Subdivision	Primary Lot	Secondary Lot	Block	Section	Township	Range
				12	20S	02E
Map Book	Map Page	Lot Dimension 1	Lot Dimension 2	Number of Acres	Square Feet	
0	0	481.95	425.46	4.53	197327	

Description

COM SW COR SEC 12 N ALG SEC LN 1326.12 E2700.35 S284.71 TO POB; CONT S414.96T O N ROW HWY#76 SW ALG ROW 481.95 N425.46 NELY480.86 TO POB

Document Information

Recorded Date	Recorded Number
20010511	20010002174400000
20000210	20000000445100000

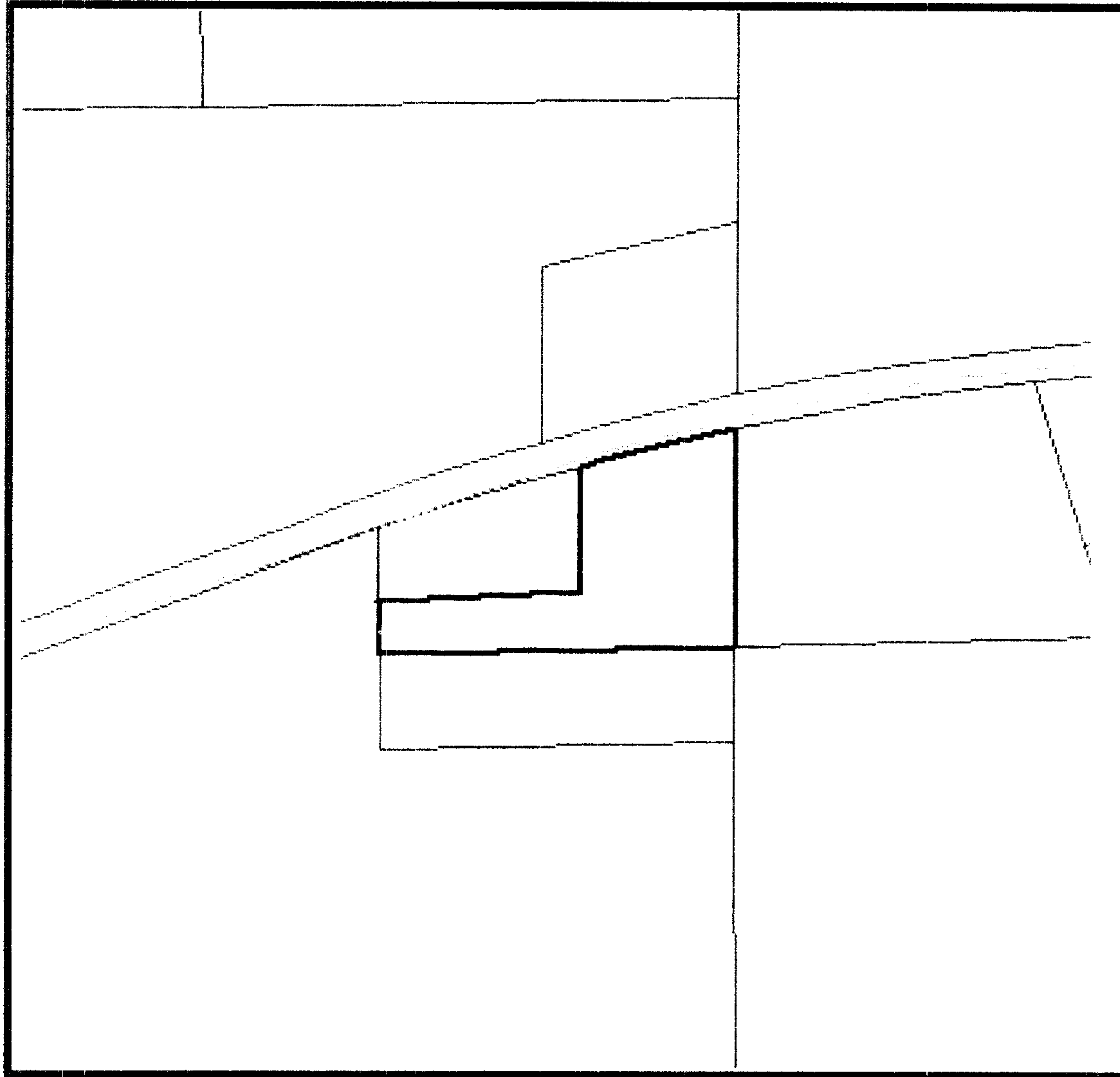

20060721000352630 4/6 \$26.00
Shelby Cnty Judge of Probate, AL
07/21/2006 09:01:30AM FILED/CERT

Property Information - 17 1 12 0 000 007.002**Owner Information**

Name 1	Name2	Address 1	Address 2	City	State	Zip Code
CAHABA FORESTS LLC	% CAHABA FOREST MGMT INC	3891 KLEIN RD		HARPERSVILLE	AL	35078
Subdivision	Primary Lot	Secondary Lot	Block	Section	Township	Range
				12	20S	02E
Map Book	Map Page	Lot Dimension 1	Lot Dimension 2	Number of Acres	Square Feet	
0	0	0	0	5.5	239580	

Description

BEG SE COR SW1/4 SEC 12 W840(S) N125(S) E488.73 N302.39 TO S ROW HWY #76 NELY356.64 ALG ROW S TO POB

Document Information

Recorded Date	Recorded Number
20021029	20020064071000000

20060721000352630 5/6 \$26.00
Shelby Cnty Judge of Probate, AL
07/21/2006 09:01:30AM FILED/CERT

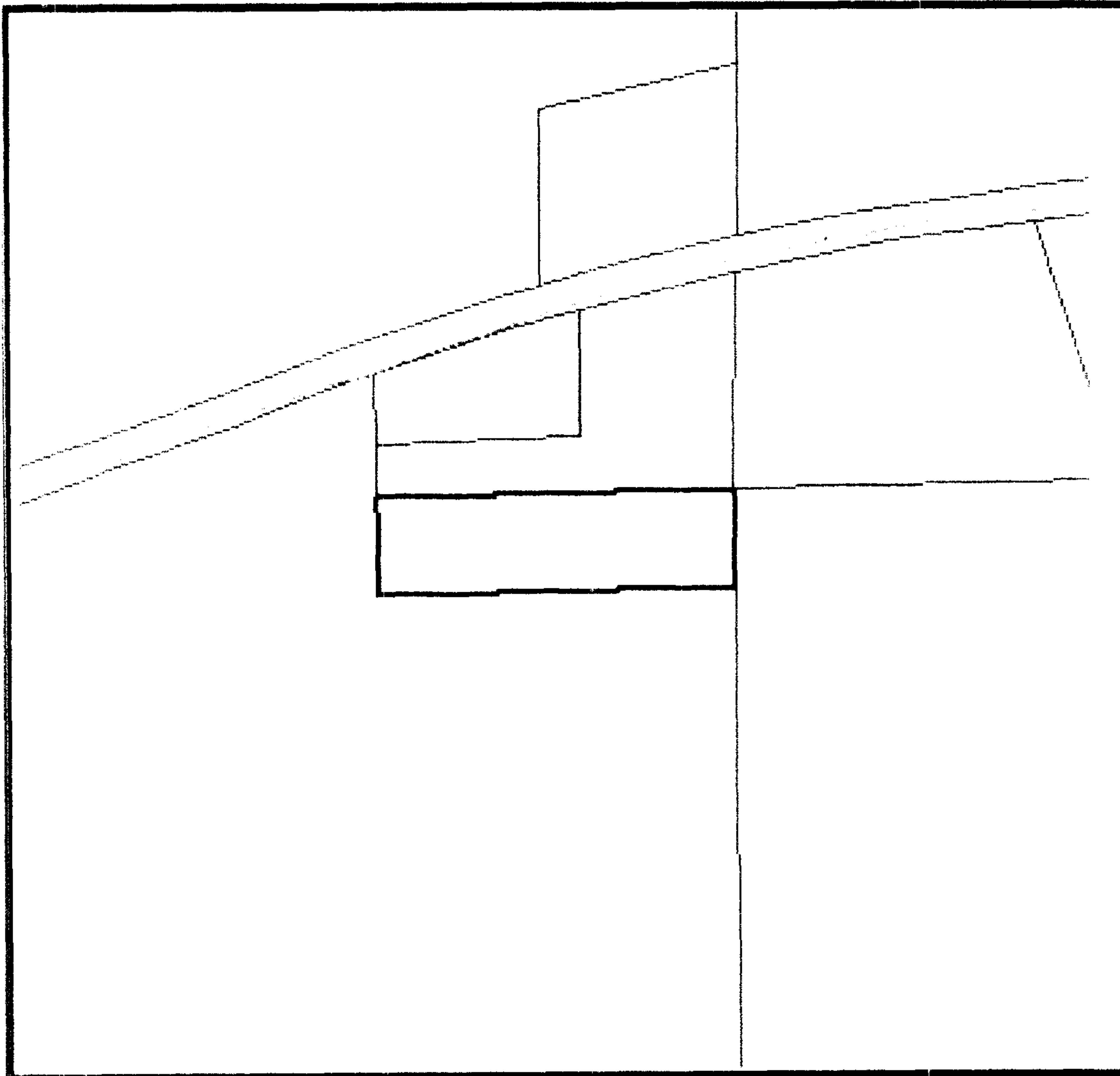
Property Information - 17 6 13 0 000 002.001**Owner Information**

Name 1	Name2	Address 1	Address 2	City	State	Zip Code
CAHABA FORESTS LLC	% CAHABA FOREST MGMT INC	3891 KLEIN RD		HARPERSVILLE	AL	35078
Subdivision	Primary Lot	Secondary Lot	Block	Section	Township	Range
				13	20S	02E
Map Book	Map Page	Lot Dimension 1	Lot Dimension 2	Number of Acres	Square Feet	
0	0	230	825.8	4.5	196020	

Description

BEG NE COR NW1/4 SEC 13 W840(S) S230(S) E825.80 N TO POB

Document Information

Recorded Date	Recorded Number
20021029	20020064071000000



20060721000352630 6/6 \$26.00
Shelby Cnty Judge of Probate, AL
07/21/2006 09:01:30AM FILED/CERT