

EASEMENT - DISTRIBUTION FACILITIES
(Metes and Bounds)

TO BE RECORDED: YES X NO

This instrument prepared by:

STATE OF ALABAMA }
COUNTY OF Shelby }
TAX ID #

W.E. No. 61700-14-0055-600
Parcel No. 70173848
Transformer No.

Larry D. Swarth
Alabama Power Company
P. O. Box 2641
Birmingham, Alabama 35291

A. GRANT KNOW ALL MEN BY THESE PRESENTS, That WACHOVIA BANK, NATIONAL ASSOCIATION

as grantors (s), (the "Grantor", whether one or more) for and in consideration of One and No/100 (\$1.00) and other good and valuable consideration, to Grantor in hand paid by Alabama Power Company, a corporation, the receipt and sufficiency of which are hereby acknowledged, does hereby grant to Alabama Power Company, its successors and assigns (the "Company"), the easements, rights and privileges described and designated in Section B below.

B. RIGHTS The easements, rights and privileges granted hereby are as follows:

1. **Overhead and/or Underground.** The right from time to time to construct, install, operate and maintain, upon, over, under and across the Property described in Section C below, along a route to be selected by the Company which is generally shown on the Company's final location drawing (which shows the general location of underground Facilities, if any, by indicating an area not greater than ten feet (10') in width), all poles, towers, wires, conduits, fiber optics, cables, trans closures, transformers, anchors, guy wires and other Facilities useful or necessary in connection therewith (collectively, "Facilities"), for the overhead and/or underground transmission and distribution of electric power, and also the right to clear and keep clear a strip of land extending five feet (5') to either side of the center line of underground Facilities and fifteen feet (15') to either side of the center line of overhead Facilities; further, the right in the future to install and utilize intermediate poles in line for overhead Facilities and the right to trim and cut and keep trimmed and cut all dead, weak, leaning or dangerous trees or limbs outside of the thirty foot (30') strip for overhead Facilities that, in the sole opinion of the Company, might now or may hereafter endanger, interfere with or fall upon any of the overhead Facilities.
2. **Line Clearing.** The right to trim and cut and keep trimmed and cut all dead, weak, leaning or dangerous trees or limbs that, in the sole opinion of the Company, might now or may hereafter endanger, interfere with or fall upon the electric transmission or distribution lines, poles, towers or other Facilities now or hereafter located adjacent to the Property described in Section C below along a route to be selected by the Company generally shown on the Company's final location drawing, and also the right to clear and keep clear all trees, undergrowth, and other obstructions on property in which Grantor has an interest within fifteen feet (15') of the center line of the lines of such poles, towers or other Facilities.
3. **Guy Wires and Anchors.** The right to implant, install and maintain anchor(s) of concrete, metal or other material on and under the Property described in Section C below, and to construct, extend and maintain guy wires from such anchor(s) to structures now or hereafter erected adjacent to such Property or property adjacent thereto (collectively, "Guy Wire Facilities") along a route to be selected by the Company generally shown on the Company's final location drawing; and also the right to trim and cut and keep trimmed and cut all dead, weak, leaning or dangerous trees or limbs that, in the sole opinion of the Company, might now or may hereafter endanger, interfere with or fall upon any of the Guy Wire Facilities.

Grantor hereby grants to the Company all easements, rights and privileges necessary or convenient for the full enjoyment and use thereof, including without limitation the right of ingress and egress to and from the Facilities and Guy Wire Facilities, as applicable, and the right to excavate for installation, replacement, repair and removal thereof; and also the right to cut, remove and otherwise keep clear any and all structures, obstructions or obstacles of whatever character, on, under and above said Facilities and Guy Wire Facilities, as applicable.

C. **PROPERTY DESCRIPTION** The easements, rights and privileges granted hereby shall apply to, and the word "Property" as used in this instrument shall mean, the following described real property situated in Shelby County, Alabama (the "Property"):

See EXHIBIT "A" attached hereto and made a part hereof for a legal
description of the property involved.

D. **ADDITIONAL PROVISIONS.** In the event it becomes necessary or desirable for the Company to move any of the Facilities in connection with the construction or improvement of any public road or highway in proximity to the Facilities, Grantor hereby grants to the Company the right to relocate the Facilities and, as to such relocated Facilities, to exercise the rights granted above; provided, however, the Company shall not relocate the Facilities on the Property at a distance greater than ten feet (10') outside the boundary of the right of way of any such public road or highway as established or re-established from time to time. This grant and agreement shall be binding upon and shall inure to the benefit of Grantor, the Company and each of their respective heirs, personal representatives, successors and assigns and the words "Company" and "Grantor" as used in this instrument shall be deemed to include the heirs, personal representatives, successors and assigns of such parties.

TO HAVE AND TO HOLD the same to the Company, its successors and assigns, forever.

IN WITNESS WHEREOF, the undersigned Grantor(s) has/have set his/her/their hand(s) and seal(s) this the 17th day of April, 20 06.

Witness

Witness

Witness

(Grantor)

WACHOVIA BANK, NATIONAL ASSOCIATION (SEAL)
(Grantor)

By: Sam R. Kile (SEAL)

As: Vice Pres RE & Construction

Shelby County, AL 06/30/2006
State of Alabama

Deed Tax: \$.50

IN WITNESS WHEREOF, the said Grantor, has caused this instrument to be executed by _____, its authorized representative, as of the _____ day of _____, 20____.

ATTEST (if corporation) or WITNESS:

By: _____
Its: _____

(Grantor - Name of Corporation/Partnership/LLC)
By: _____ (SEAL)
Its: _____
[indicate President, General Partner, Member, etc.]

INDIVIDUAL NOTARIES

STATE OF ALABAMA }
COUNTY OF Jefferson }

I, the undersigned, a Notary Public, in and for said County in said State, hereby certify that Nave Kinder
_____ whose name(s) is/are signed to the foregoing instrument and who is/are known to me, acknowledged before me on this day that being informed of the contents of the instrument, he/she/they executed the same voluntarily, on the day the same bears date.
Given under my hand and official seal this the 17th day of April, 2006.

[SEAL]

Ramona R. Hayes
Notary Public
My commission expires: December 17, 2008

STATE OF ALABAMA }
COUNTY OF _____ }

I, the undersigned, a Notary Public, in and for said County in said State, hereby certify that _____
_____ whose name(s) is/are signed to the foregoing instrument and who is/are known to me, acknowledged before me on this day that being informed of the contents of the instrument, he/she/they executed the same voluntarily, on the day the same bears date.
Given under my hand and official seal this the _____ day of _____, _____.

[SEAL]

Notary Public
My commission expires: _____

TRUSTEE/CORPORATION/PARTNERSHIP/LLC NOTARY

STATE OF ALABAMA }
COUNTY OF _____ }

I, the undersigned, a Notary Public, in and for said County in said State, hereby certify that _____
_____, whose name as _____ of _____
_____ a _____ [as _____
_____] is signed to the foregoing instrument, and who is known to me, acknowledged before me on this day that being informed of the contents of the instrument, he/she, as such _____ and with full authority, executed the same voluntarily for and as the act of said _____ [acting in such capacity as aforesaid].
Given under my hand and official seal, this the _____ day of _____, _____.

[SEAL]

Notary Public
My commission expires: _____

For Alabama Power Company Corporate Real Estate Department Use Only

All facilities on Grantor: X Station to Station: _____

EXHIBIT "A"

20060630000315050 3/5 \$23.50
Shelby Cnty Judge of Probate, AL
06/30/2006 09:10:49AM FILED/CERT

A parcel of land situated in the Southeast 1/4 of Section 1, Township 21 South, Range 3 West, Shelby County, Alabama, being more particularly described as follows:

Commence at the Southeast corner of Section 1, Township 21 South, Range 3 West; thence in a Westerly direction along the South line of said Section 1 a distance of 1965.36 feet to a point on the Easterly Right-of-Way line of Interstate Drive; thence $84^{\circ}15'29''$ to the right in a Northerly direction along said Right-of-Way line a distance of 428.78 feet to the P.C. (point of curve) of a curve to the right having a radius of 25.00 feet and a central angle of $86^{\circ}31'11''$; thence in a Northerly, Northeasterly and Easterly direction (leaving said Right-of-Way line) along the arc of said curve a distance of 37.75 feet to the P.T. (point of tangent) of said curve; thence tangent to said curve in an Easterly direction a distance of 491.10 feet to a point; thence $93^{\circ}42'51''$ to the left in a Northerly direction a distance of 60.12 feet to a point; thence $86^{\circ}17'09''$ to the left in a Westerly direction a distance of 514.15 feet to the P.C. (point of curve) of a curve to the right having a radius of 25.00 feet and a central angle of $88^{\circ}00'27''$; thence in a Westerly, Northwesterly and Northerly direction along the arc of said curve a distance of 38.40 feet to the P.R.C. (point of reverse curve) of a curve to the left having a radius of 1600.00 feet and a central angle of $25^{\circ}47'16''$; thence in a Northerly and Northwesterly direction along the arc of said curve a distance of 720.13 feet to the P.T. (point of tangent) of said curve; thence tangent to said curve in a Northwesterly direction a distance of 197.69 feet to a point said point lying on a curve to the left having a radius of 20.00 feet and a central angle of $90^{\circ}00'00''$; thence 180° to the right (angle measured to tangent) in a Southeasterly, Easterly and Northeasterly direction along the arc of said curve a distance of 31.42 feet to the P.T. (point of tangent) of said curve; thence tangent to said curve in a Northeasterly direction a distance of 27.21 feet to the P.C. (point of curve) of a curve to the right having a radius of 224.50 feet and a central angle of $26^{\circ}54'46''$; thence in a Northeasterly and Easterly direction along the arc of said curve a distance of 105.45 feet to the P.T. (point of tangent) of said curve; thence tangent to said curve in an Easterly direction a distance of 12.71 feet to the P.C. (point of curve) of a curve to the left having a radius of 30.00 feet and a central angle of $90^{\circ}00'00''$; thence in an Easterly, Northeasterly and Northerly direction along the arc of said curve a distance of 47.12 feet to the P.T. (point of tangent) of said curve; thence tangent to said curve in a Northerly direction a distance of 273.89 feet to a point; thence $85^{\circ}38'38''$ to the left in a Westerly direction a distance of 327.03 feet to a point, said point lying on a curve to the right having a radius of 500.00 feet and a central angle of $40^{\circ}06'14''$; thence $83^{\circ}12'24''$ to the right (angle measured to tangent) in a Northerly and Northeasterly direction along the arc of said curve a distance of 349.97 feet to the P.T. (point of tangent) of said curve said point being the POINT OF BEGINNING of the parcel described herein; thence tangent to said curve in a Northeasterly direction a distance of 195.83 feet to the P.C. (point of curve) of a curve to the right having a radius of 25.00 feet and a central angle of $90^{\circ}00'00''$; thence in a Northeasterly, Easterly and Southeasterly direction along the arc of said curve a distance of 39.27 feet to the P.T. (point of tangent) of said curve; thence tangent to said curve in a Southeasterly direction a distance of 72.11 feet to the P.C. (point of curve) of a curve to the left having a radius of 1045.00 feet and a central angle of $5^{\circ}30'48''$; thence in a Southeasterly direction along the arc of said curve a distance of 100.55 feet to the P.T. (point of tangent) of said curve; thence tangent to said curve in a Southeasterly direction a distance of 12.07 feet to the P.C. (point of curve) of a curve to the right having a radius of 25.00 feet and a central angle of $90^{\circ}00'00''$; thence in a Southeasterly and Southerly direction along the arc of said curve a distance of 39.27 feet to the P.T. (point of tangent) of said curve; thence tangent to said curve in a Southerly direction a distance of 19.24 feet to the P.C. (point of curve) of a curve to the left having a radius of 520.00 feet and a central angle of $18^{\circ}04'56''$; thence in a Southerly direction along the arc of said curve a distance of 164.11 feet to a point at the end of said curve; thence $108^{\circ}04'50''$ to the right (angle measured to tangent) in a Northwesterly direction a distance of 281.03 feet to the POINT OF BEGINNING.

SKETCH OF PROPOSED WORK — SIMPLIFIED W. E.

Sheet 1 of 2

Customer <i>Wachovia</i>		Location <i>500 Colonial Prom Pky</i>		Agreed Serv. Date <i>5-30-06</i>		Estimate No. <i>61700-14-00556</i>	
Division <i>Birmingham</i>		District <i>Metro-South</i>		Town <i>Alabaster</i>		Drawn by <i>G. Belcher</i>	
County <i>Shelby</i>		Section <i>1</i>		Township <i>21S</i>		Range <i>3W</i>	
Acquisition Agent		Date R/W Assigned		Date R/W Cleared		Map Reference	
						LOG - Transformer Loading	
						X 24702	
						Y XDB715	

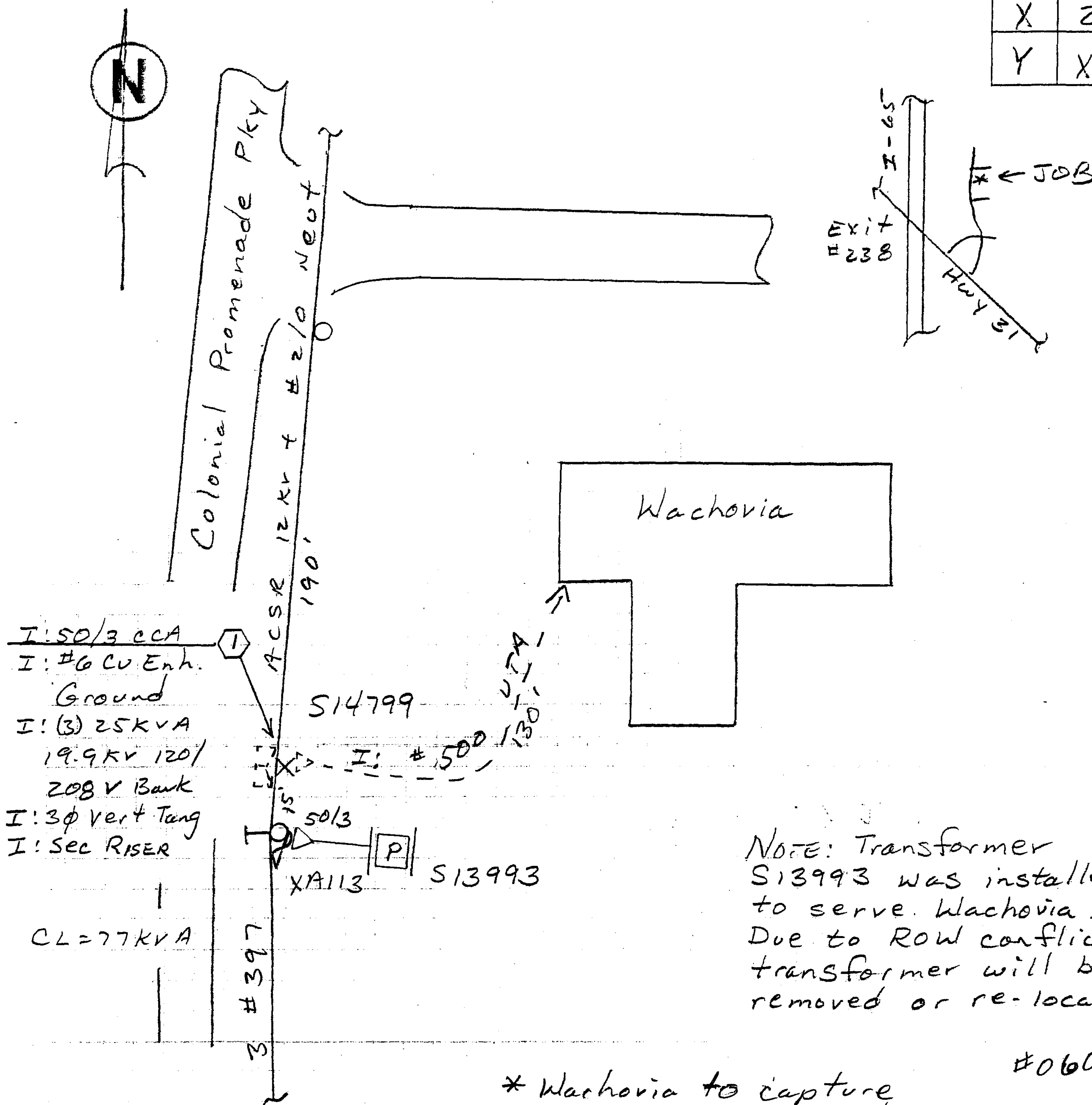

Voltage	
Pri	Sec.
12 KV	120/208
PHONE CO.	
Co. Name	
CATV CO.	
Co. Name	
ACCESSIBLE	
TREE CREW	
ROCK HOLE	
PERMITS REQ'D	
RW	
CITY	
COUNTY	
STATE	
MISSALL # 4/6 8:45 AM	
OTHER	
SCALE	
NTS	

#060940440

Cnst. Completed By

20060630000315050 4/5 \$23.50
Shelby Cnty Judge of Probate, AL
06/30/2006 09:10:49AM FILED/CERT

