

PERMANENT EASEMENT DEED

D10

20-2-03-0-000-013.003

STATE OF ALABAMA)  
SHELBY COUNTY)

Brent Wayne & Karee Morris Hughes

KNOW ALL MEN BY THESE PRESENTS: That for and in consideration of the sum of (\$ 326 ) cash in hand paid by Shelby County, the receipt whereof is hereby acknowledged, we, the undersigned (Grantors), do hereby grant, bargain, and convey unto the Shelby County (Grantee), its agents, successors and assigns a permanent easement and right of ingress and egress to and from, also over and across a strip of land for the purpose of constructing, operating, maintaining and repairing water mains, pipes, water meters, with appurtenances and the right to install and maintain other utilities at the sole discretion of the Grantee. Said strip of land being located within the property of the undersigned Grantors as described in Book 017 Page 292 , in the office of the Judge of Probate, Shelby County, Alabama said strip being more particularly described as follows:

A 40 foot utility easement for a water line situated in the SE 1/4 of Section 3, Township 21 South, Range 1 East, Shelby County, Alabama, being more particularly described as follows:

The South 40 feet of the above described parcel lying North of, also adjacent to and parallel with the North right of way line of Alabama Highway No. 25

Said easement contains 0.19 acres, more or less, and the approximate alignment and orientation is shown on the attached Exhibit A.

- NO MARKERS OF ANY KIND ACROSS PROPERTY, FENCE PUT BACK, & RE-SODDED ASAP. B.H. KMH

The Grantee shall have the right and privilege of a perpetual use of said lands for such public purpose, together with all rights and privileges necessary or convenient for the full use and enjoyment thereof, including the right to cut and keep clear all trees, undergrowth and other obstructions from said strip and on the lands of the undersigned adjacent to said strip when deemed reasonably necessary for the avoidance of danger in and about said public use of said strip.

The Grantee shall have free access, ingress and egress to and from said land over and across adjacent lands of Grantor(s) for the purposes herein mentioned, and the Grantor(s) shall erect no structures on the portion of the land above described within the width

of said easement, or do any act or thing which would in any way interfere with, damage, place at risk or pose future risk or possible risk to the mains, pipes, or appurtenances installed or to be installed within the width of said easement or interfere with the right of the Grantee to enter upon said land at any time for the purposes heretofore expressed and to have immediate access to all mains, pipes, and appurtenances.

The Grantee shall also have the right to temporarily place dirt and materials on adjacent lands of the Grantor(s) for the purposes heretofore expressed. Any and all disturbed areas within said easement will be put back to match adjacent natural ground and a suitable grass mixture for the season shall be applied.

Grantee agrees to leave the property substantially as found upon commencement of construction on said easement but is not required to improve said property beyond its original state and condition, subject to grassing and grading as described herein. Grantor(s) covenant that they have good and merchantable title to said property and good right to convey this easement.

In consideration of the benefit of the property of the undersigned by reason of the construction of said improvement, the undersigned hereby release Shelby County, Alabama, from all damages present or prospective to the property of the undersigned arising or resulting from the construction, maintenance and repair of said premises and repair of said water line and the undersigned do hereby admit and acknowledge that said improvement, if and when constructed, will be a benefit to the property of the undersigned.

IN WITNESS WHEREOF, the undersigned have hereunto set their hands and seals, all on this 13<sup>TH</sup> day of May, 2006.

By: Brent Wayne Hughes  
Brent Wayne Hughes

By: Karee Morris Hughes  
Karee Morris Hughes

WITNESSES:

20060515000227050 3/4 \$.00  
Shelby Cnty Judge of Probate, AL  
05/15/2006 09:09:19AM FILED/CERT

STATE OF ALABAMA  
COUNTY OF SHELBY

I, the undersigned authority, a Notary Public in and for said state-at-large, do hereby certify that, Brent Wayne Hughes, whose name is signed to the foregoing certificate as Grantor, and who is known to me, acknowledged before me on this date that being duly informed of the contents of said certificate, do executed the same voluntarily as such individual with full authority thereof.

GIVEN under my hand and official seal of office this 13<sup>th</sup> day of May, 2006.

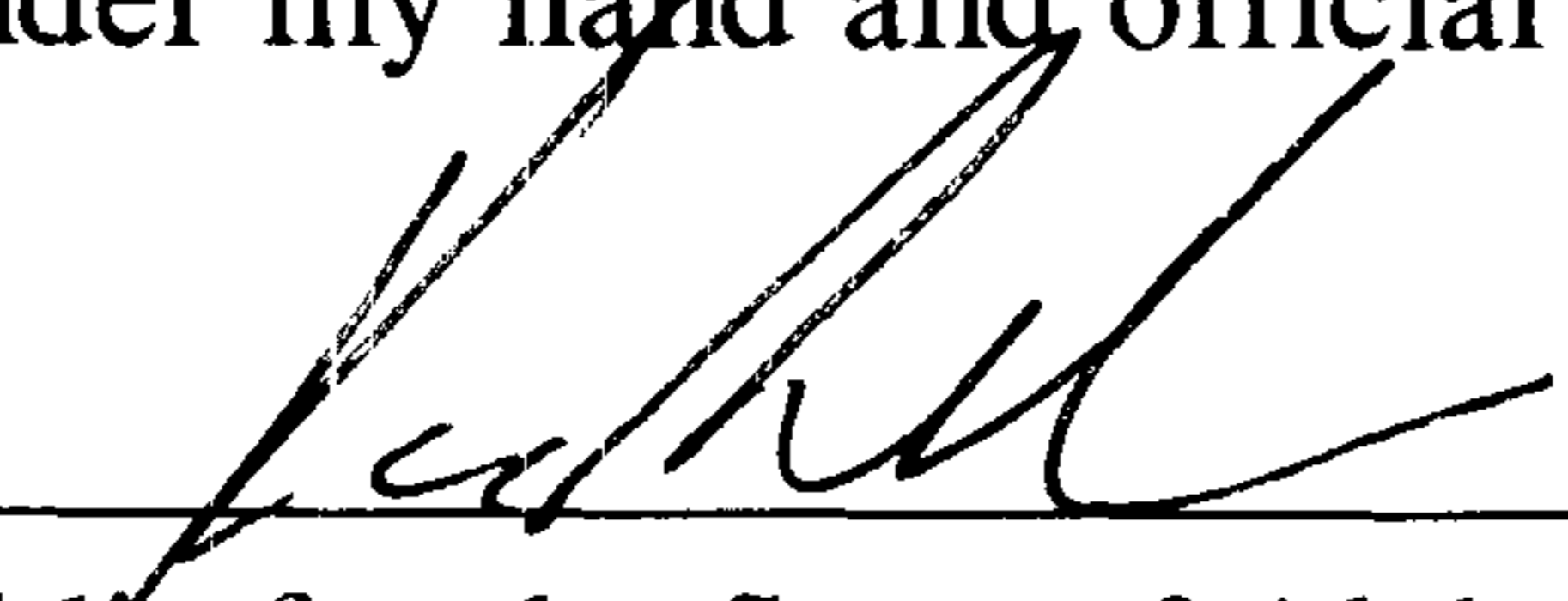
  
\_\_\_\_\_  
Notary Public for the State of Alabama  
My Commission Expires: 6-15-09



STATE OF ALABAMA  
COUNTY OF SHELBY

I, the undersigned authority, a Notary Public in and for said state-at-large, do hereby certify that, Karee Morris Hughes, whose name is signed to the foregoing certificate as Grantor, and who is known to me, acknowledged before me on this date that being duly informed of the contents of said certificate, do executed the same voluntarily as such individual with full authority thereof.

GIVEN under my hand and official seal of office this 13<sup>th</sup> day of May, 2006.

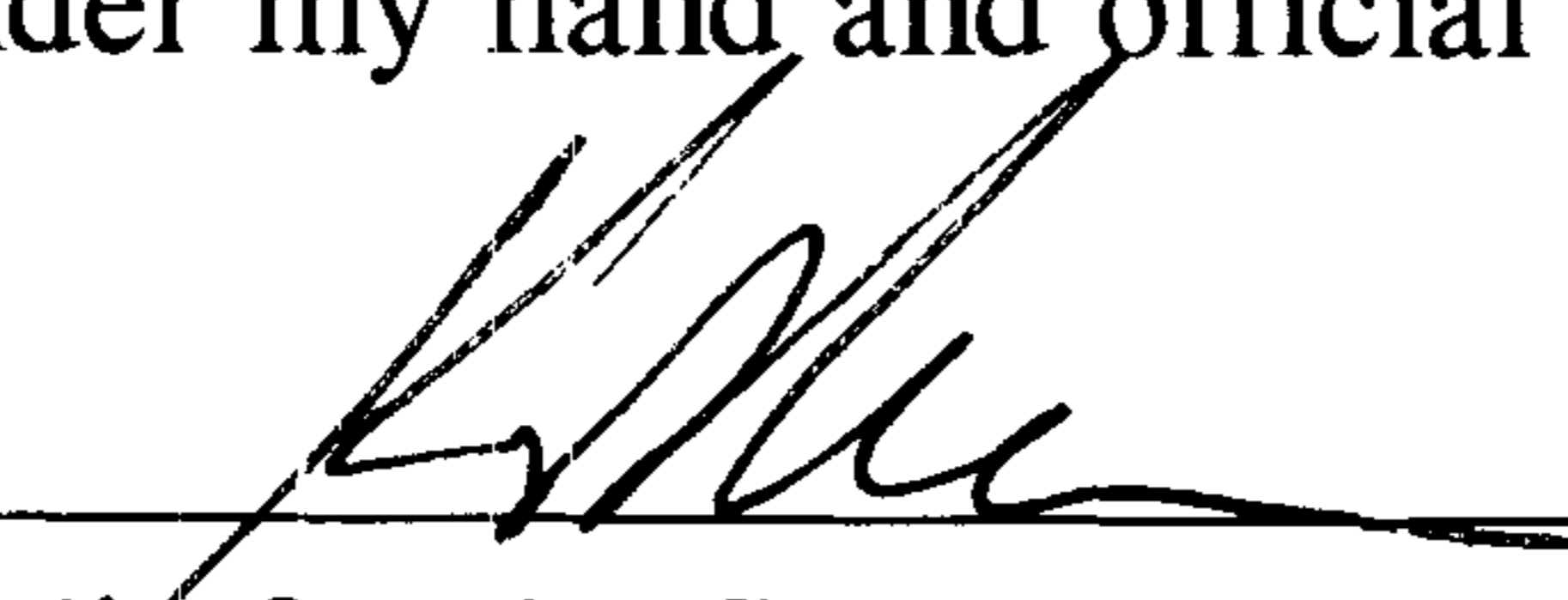
  
\_\_\_\_\_  
Notary Public for the State of Alabama  
My Commission Expires: 6-15-09



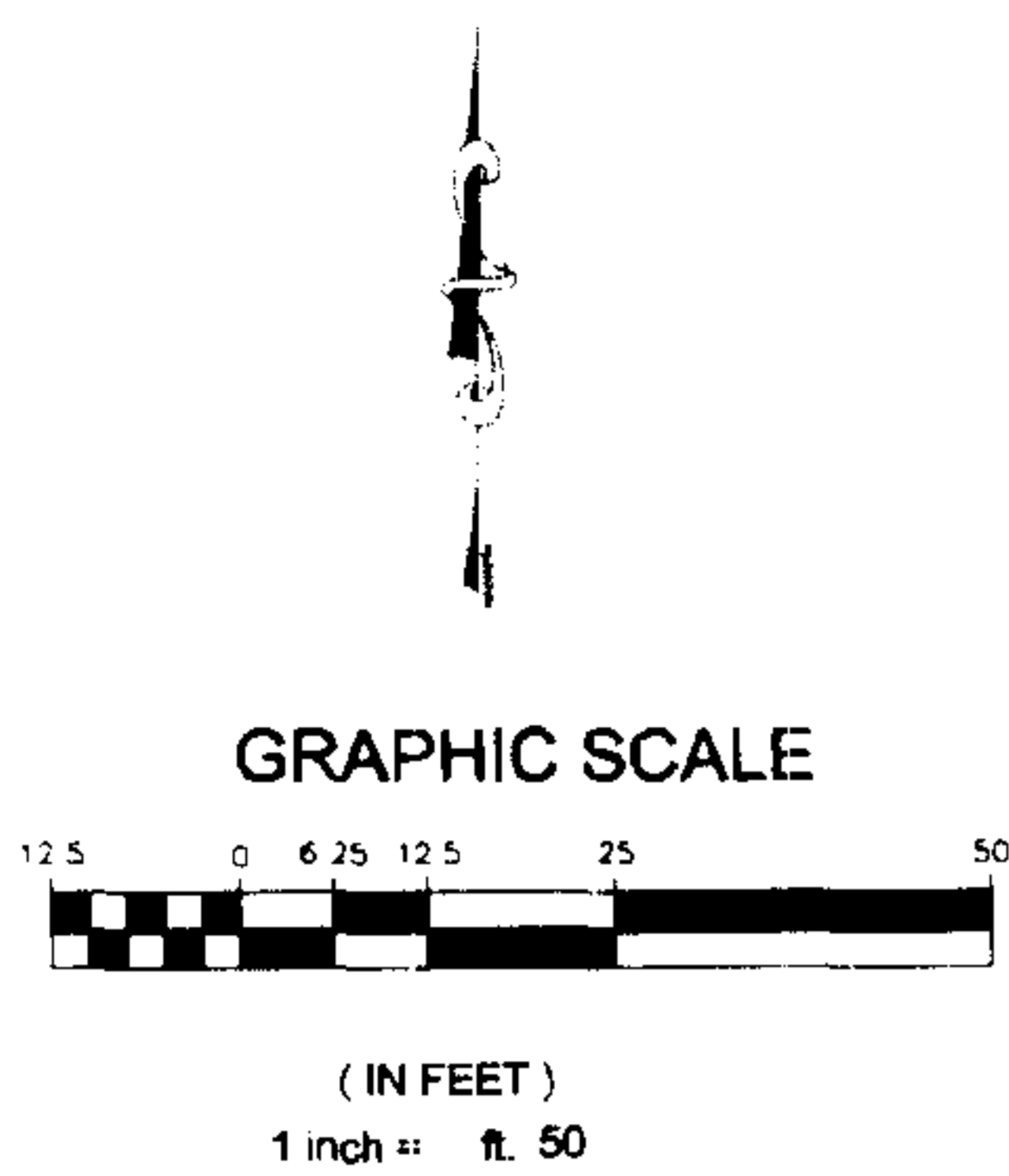

LEGEND  
—— PROPERTY LINE  
—— PROPOSED EASEMENT  
--- EXISTING APCO EASEMENT  
APCO OVERHEAD POWER

20060515000227050 4/4 \$.00  
Shelby Cnty Judge of Probate, AL  
05/15/2006 09:09:19AM FILED/CERT

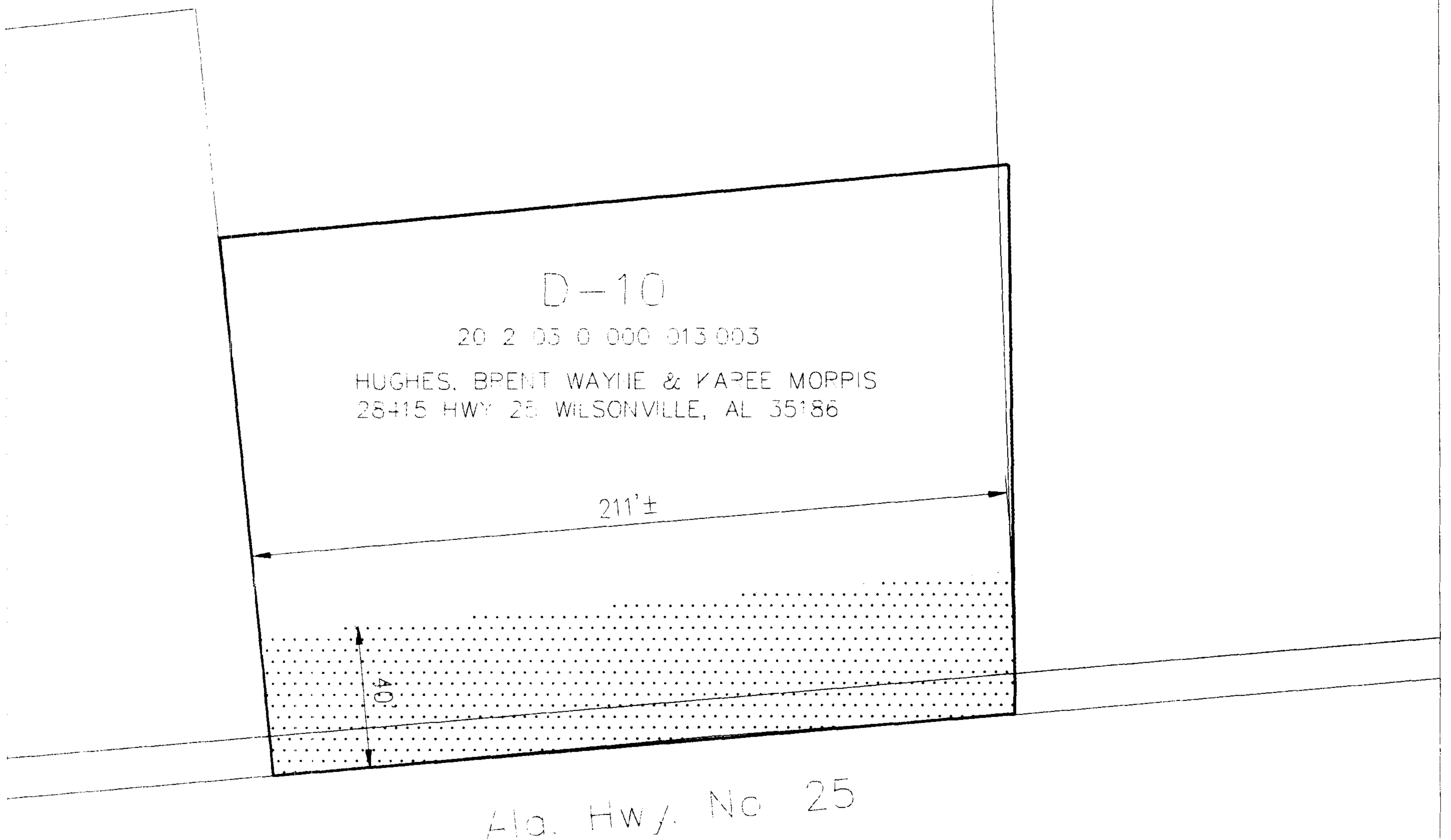

## EXHIBIT A

PARCEL ID #: 20 2 05 0 000 013 003  
PARCEL OWNER: HUGHES, BRENT WAYNE & KAREE MORRIS  
TOTAL ACREAGE: 0.70±  
EASEMENT ACREAGE: 0.19±  
REMAINING ACREAGE: 0.51±

NOTE: ACREAGES SHOWN ARE APPROXIMATE BASED ON TAX MAP DATA

SHELBY COUNTY  
COMMISSION

SOUTH WATER PLANT  
PROJECT

REF #: D-10  
DRAWING 1 OF 1