

Town of Westover
P.O. Box 356
Westover, Alabama 35185

20060303000102530 1/5 \$23.00
Shelby Cnty Judge of Probate, AL
03/03/2006 03:46:20PM FILED/CERT

**Certification
Of
Annexation Ordinance**

Ordinance Number: 2006-02-07-096

Property Owner(s): Westervelt Realty, Inc.

Property: 08-7-25-0-000-002.004 (the western ½ of parcel as per legals and maps).

I, Wayne Jones, town clerk of the Town of Westover, Alabama
Hereby certify the attached to be a true and correct copy of an
Ordinance adopted by the Town Council of Westover, at the regular
meeting held on 07 February, 2006, as same appears in the minutes
of record of said meeting, and published by posting copies thereof on
February 14, 2006 at the places listed below, which copies remained
posted for five (5) business days through February 21, 2006.

Westover Town Hall, 3312 Westover Road, Westover, Alabama 35147
Westover Water Authority, US Highway 280, Westover, Alabama 35147
Westover Leisure Wear, 4769 Old Highway 280, Westover, Alabama 35147

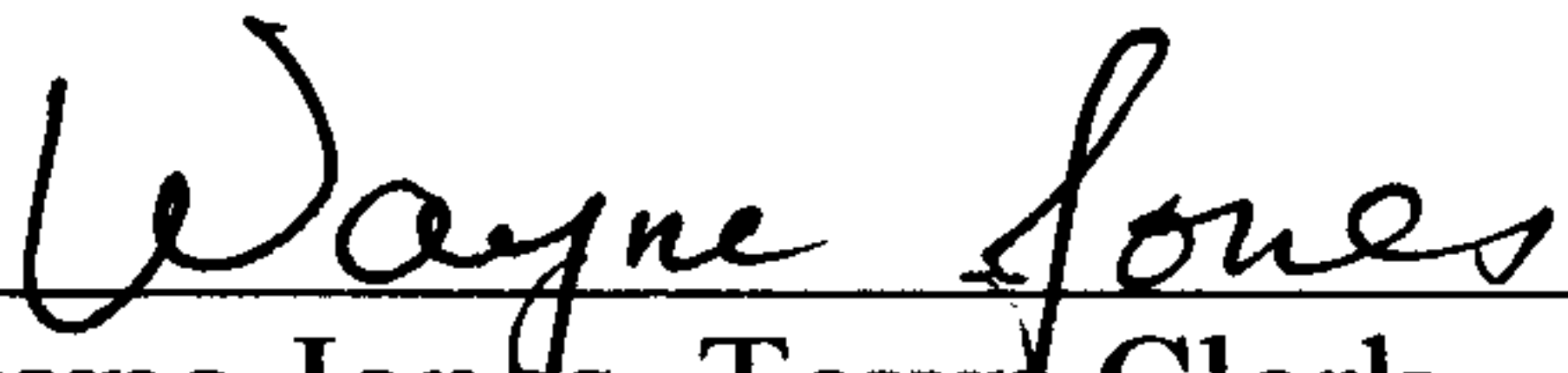

Wayne Jones, Town Clerk

Town of Westover

Annexation Ordinance No. 2006-02-07-096

20060303000102530 2/5 \$23.00
Shelby Cnty Judge of Probate, AL
03/03/2006 03:46:20PM FILED/CERT

Property owner(s): Westervelt Realty, Inc.

Property: 08-7-25-0-000-002.004

(The western 1/2 of parcel as per attached legals and maps.)

Pursuant to the provisions of Section 11-42-21 of the Code of Alabama (1975)

Whereas, the attached written petition requesting that the above-noted property be annexed to the Town of Westover has been filed with the Westover town clerk; and

Whereas, said petition has been signed by the owner(s) of said property; and

Whereas, said petition contains (as Petition Exhibit A) an accurate description of said property together with a map of said property (Exhibit B) showing the relationship of said property to the corporate limits of Westover; and

Whereas, said property is contiguous to the corporate limits of Westover, or is a part of a group of properties submitted at the same time for annexation together is contiguous to the corporate limits of Westover;

Whereas, said territory does not lie within the corporate limits of any municipality.

Therefore, be it ordained that the town council of the Town of Westover assents to the said annexation; and

Be it further ordained that the corporate limits of Westover be extended and rearranged so as to embrace and include said property, and said property shall become a part of the corporate area of the Town of Westover upon the date of publication of this ordinance as required by law.



Mayor Mark McLaughlin

Passed and approved 7 day of February, 2006



Wayne Jones, Town Clerk

PETITION FOR ANNEXATION TOWN OF WESTOVER, AL.

The undersigned owner(s) of the property described below, which is described in the attached "Exhibit A" and is contiguous to the corporate limits of Westover, Alabama do hereby petition the town of Westover to annex said property into the corporate limits of the municipality.

Name: WESTERWELL REALTY, INC.

Property Address: HIGHWAY 200

City/State/Zip Code: SEELY 6, AL

Telephone Number: 205-562-5000

Parcel ID Number: SEE ATTACHED SHEET ^{08-7-25-0-000-062.004}
(As listed on property tax notice)

Number of registered voters residing at this Parcel 0

SIGNATURE OF PROPERTY OWNER(S)

(All owners listed on the deed must sign)

Tom Chambers

TOM CHAMBERS
General Manager



20060303000102530 3/5 \$23.00
Shelby Cnty Judge of Probate, AL
03/03/2006 03:46:20PM FILED/CERT

PLEASE RETURN COMPLETED PETITION IMMEDIATELY TO THE PERSON
PROVIDING THE PETITION, OR MAIL TO:
WESTOVER ANNEXATION COMMITTEE • P.O. BOX 356 • WESTOVER, AL
35185 Phone 678-3376

0.005 Acres
Hanbury Annexation

A parcel of land being the West Half of the East Half of the East Half of the East Half of the East Half of the East Half of the East Half of the East Half of the East Half of the Northeast Quarter of Section 25, Township 19 South, Range 1 East, Huntsville Meridian, in Shelby County, Alabama, lying South of US Highway No. 280, containing Zero and Five Thousandths (0.005) Acres, more or less.

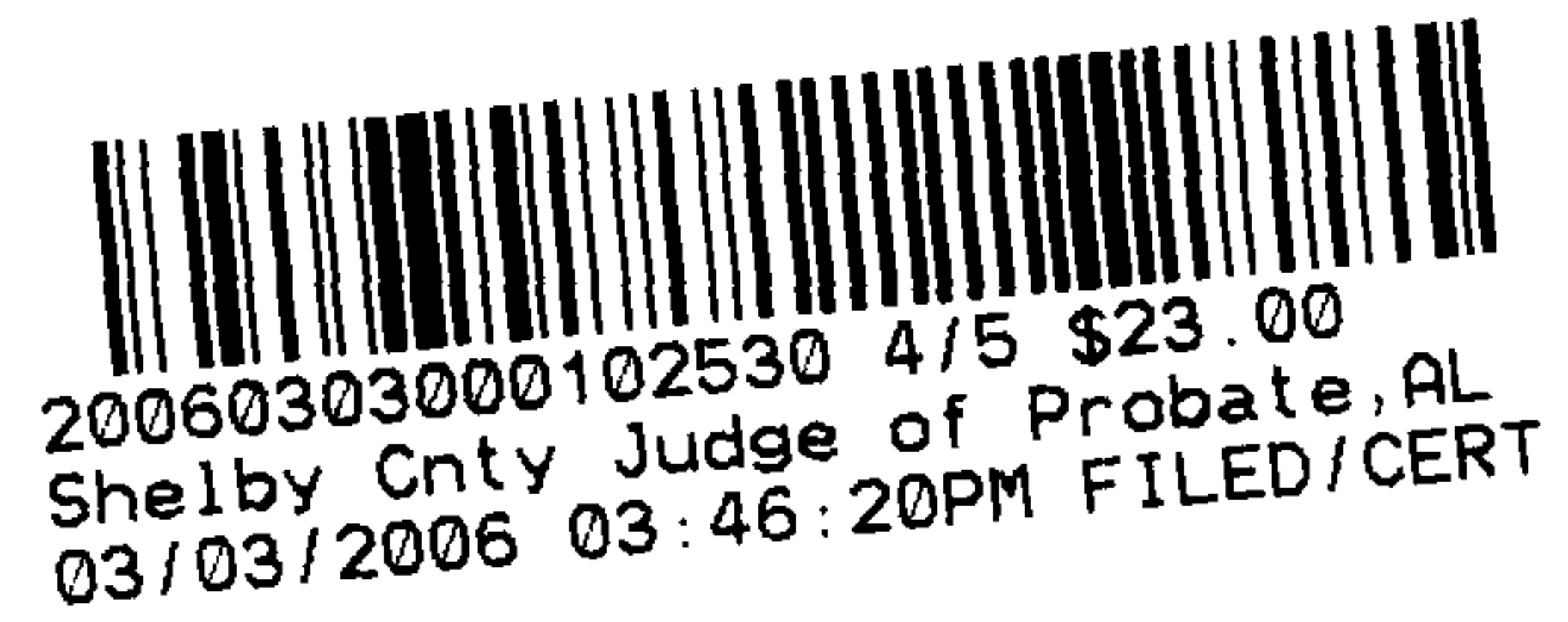

SHELBY COUNTY LAND INFORMATION TOOL
SHELBY COUNTY, ALABAMA GEOGRAPHIC INFORMATION SYSTEM

— Select Menu Item —

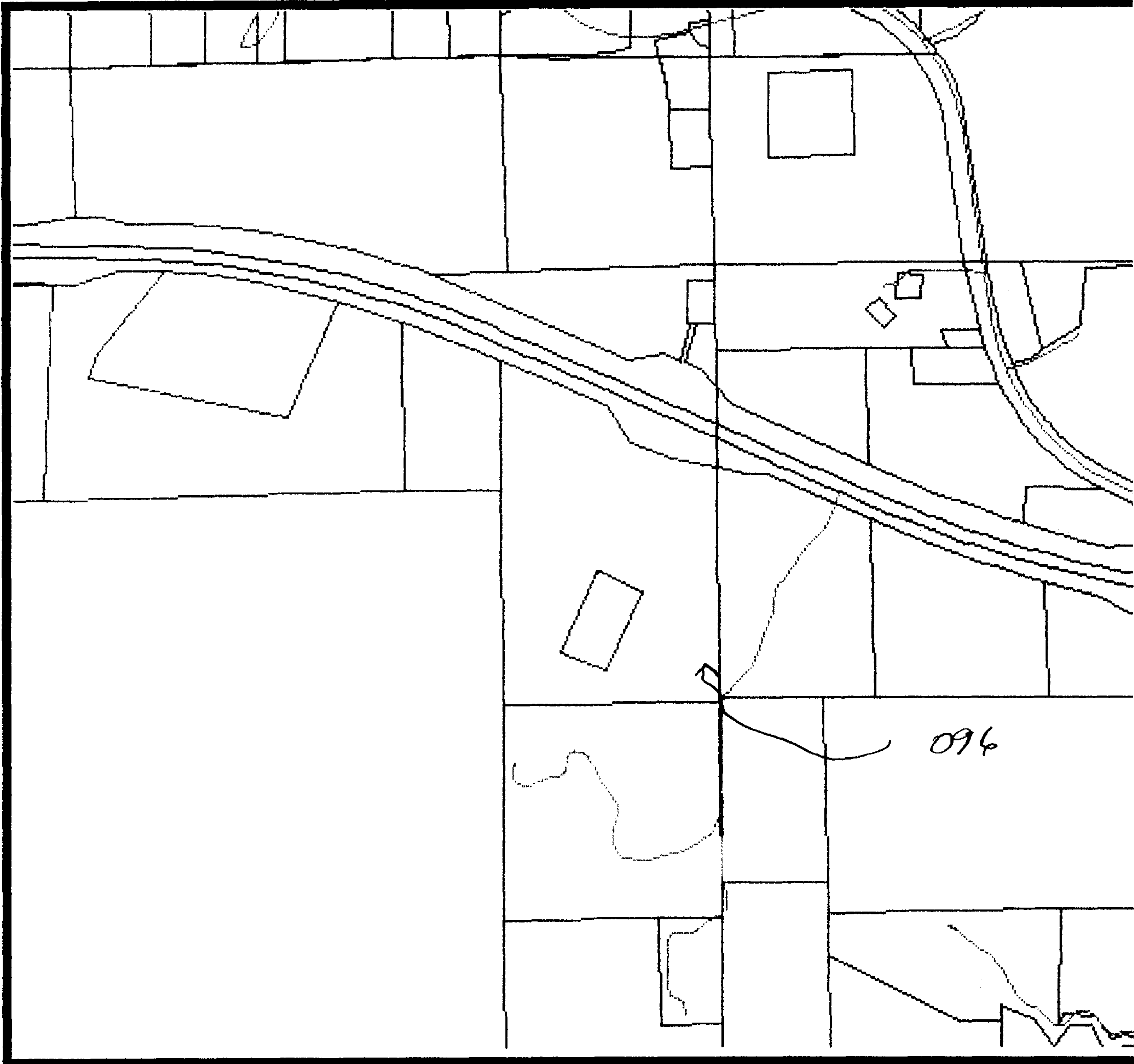

CURRENTLY MAPPED PARCELS

Feature to Add to Map:

City Limit	▼
Add Feature to Map	
Main Search Page	



20060303000102530 5/5 \$23.00
Shelby Cnty Judge of Probate, AL
03/03/2006 03:46:20PM FILED/CERT