

ORDINANCE 06-0206

Councilman Neboah Logan introduced the following Ordinance:

WHEREAS, on the 6th day of February, 2006

The persons whose names are signed thereto, filed a petition with the Clerk of the Town of Harpersville as required by Section 11-42-20 and 11-42-21, Code of Alabama 1975, petitioning And requesting that the property hereinafter described be annexed to the municipality of the Town of Harpersville, Alabama and requesting the Mayor and Council of said Town to adopt an Ordinance assenting to the annexation of said property to such municipality, which petition Contained and accurate description of the property or territory proposed to be annexed together With a map of said territory showing its relationship to the corporate limits of the Town of Harpersville, and the signatures of the owners of the property or territory described were signed Thereto;

NOW, THEREFORE, BE IT ORDAINED BY THE MAYOR AND COUNCIL OF THE TOWN OF HARPERSVILLE, ALABAMA AS FOLLOWS:

That the Town of Harpersville does adopt this ordinance assenting to the annexation of The following described property or territory to the municipality of the Town of Harpersville.

Said Property being described on Exhibit "A" attached hereto.

Be it further ordained that the corporate limits of the Town of Harpersville be extended An rearranged so as to embrace and include such property and such property or territory shall Become a part of the corporate area of such municipality upon the date of publication of this Ordinance, as provided for in section 11-42-20 and 11-42-21, Code of Alabama 1975.

Be it further ordained that the Clerk is hereby authorized and directed to file a copy of This ordinance, along with an accurate description of the property or territory being annexed, Together with a map of the said property or territory showing its relationship to the corporate Limits of the Town of Harpersville to which said territory or property is being presented to the Office of the Department of Justice for approval.

Be it further ordained that the Zoning Map of the Town of Harpersville, and any other Official maps or surveys of the Town, shall be amended to reflect the annexation of properties Being presented for approval.

MAYOR

ATTEST: Joyce Robertson, Town Clerk

✓

TOWN OF HARPERSVILLE
PETITION FOR UNANIMOUS CONSENT

We the undersigned, constituting all of the hereinafter described real property do hereby execute and file with the Town of Harpersville clerk this written petition asking and requesting that our property hereinafter described be annexed to the town of Harpersville, under authority of section 11-42-20 throughout 11-42-24 code of Alabama, 1975.

Said property is described as follows:

Property Owners: **HOLCOMBE DEVELOPMENT LLC**

Tax ID #:

See attached Map and Property Inquiry for legal description.

We further certify that said property is contiguous to the Town of Harpersville. We further certify that all the property included in the above described which lies within the police jurisdiction of both the annexing municipality and another municipality is located closer to the annexing municipality than to the other municipality as required by sections 11-42-21 code of Alabama, 1975

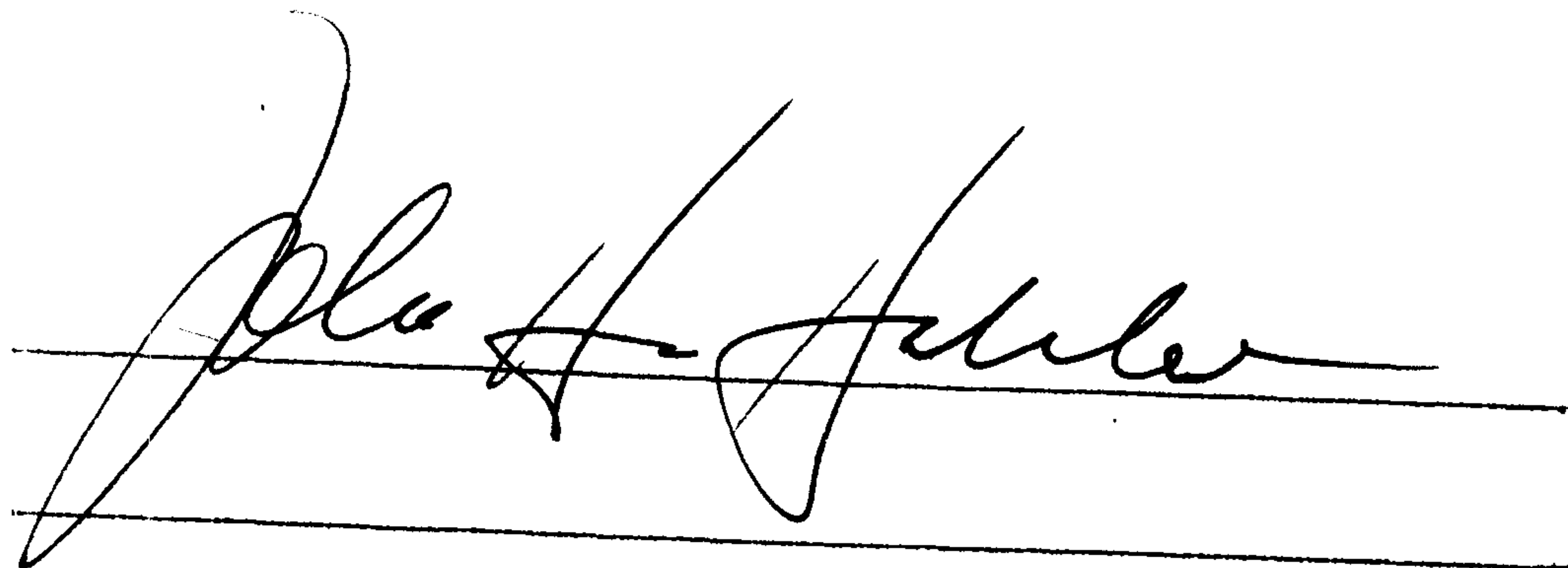

07 735 0 000 010.001

07 735 0 000 010.003

07 735 0 000 010.004

07 735 0 000 010.005



20060215000074880 2/7 \$29.00
Shelby Cnty Judge of Probate, AL
02/15/2006 09:07:49AM FILED/CERT

ANNEXATION CHECK LIST	
Copy of petition signed by property owners	
Map of Property	YES
Description of Property	YES
Names of Property Owners	Holcombe DEVELOPMENT LLC.
How many single family dwellings on property	0
How many people live on parcel of land	0
How many are of voting age	0
How many are not of voting age	0
The race of each person	0
Reason for annexation	Police & Fire Protection



20060215000074880 3/7 \$29.00
 Shelby Cnty Judge of Probate, AL
 02/15/2006 09:07:49AM FILED/CERT

Property Information - 07 7 35 0 000 010.001**Owner Information**

Name 1	Name2	Address 1	Address 2	City	State	Zip Code
HOLCOMBE DEVELOPMENT LLC		2060 EAGLE RIDGE DRIVE		BIRMINGHAM	AL	35242
Subdivision	Primary Lot	Secondary Lot	Block	Section	Township	Range
STANDRIDGE DIVISION III	1			35	19S	02E
Map Book	Map Page	Lot Dimension 1	Lot Dimension 2	Number of Acres	Square Feet	
31	112	0	0	20	871200	

Description**Document Information**

Recorded Date	Recorded Number
20050520	20050526000255830
20000524	20000001779700000
19960116	19960000231900000
19951229	19960000125000000



20060215000074880 4/7 \$29.00
Shelby Cnty Judge of Probate, AL
02/15/2006 09:07:49AM FILED/CERT

Property Information - 07 7 35 0 000 010.003**Owner Information**

Name 1	Name2	Address 1	Address 2	City	State	Zip Code
HOLCOMBE DEVELOPMENT LLC		2060 EAGLE RIDGE DRIVE		BIRMINGHAM	AL	35242
Subdivision	Primary Lot	Secondary Lot	Block	Section	Township	Range
STANDRIDGE DIVISION III	2			35	19S	02E
Map Book	Map Page	Lot Dimension 1	Lot Dimension 2	Number of Acres	Square Feet	
31	112	0	0	21.14	920858	

Description**Document Information**

Recorded Date	Recorded Number
20050520	20050526000255830
20000524	20000001779700000
19960116	19960000231900000
19951229	19960000125000000

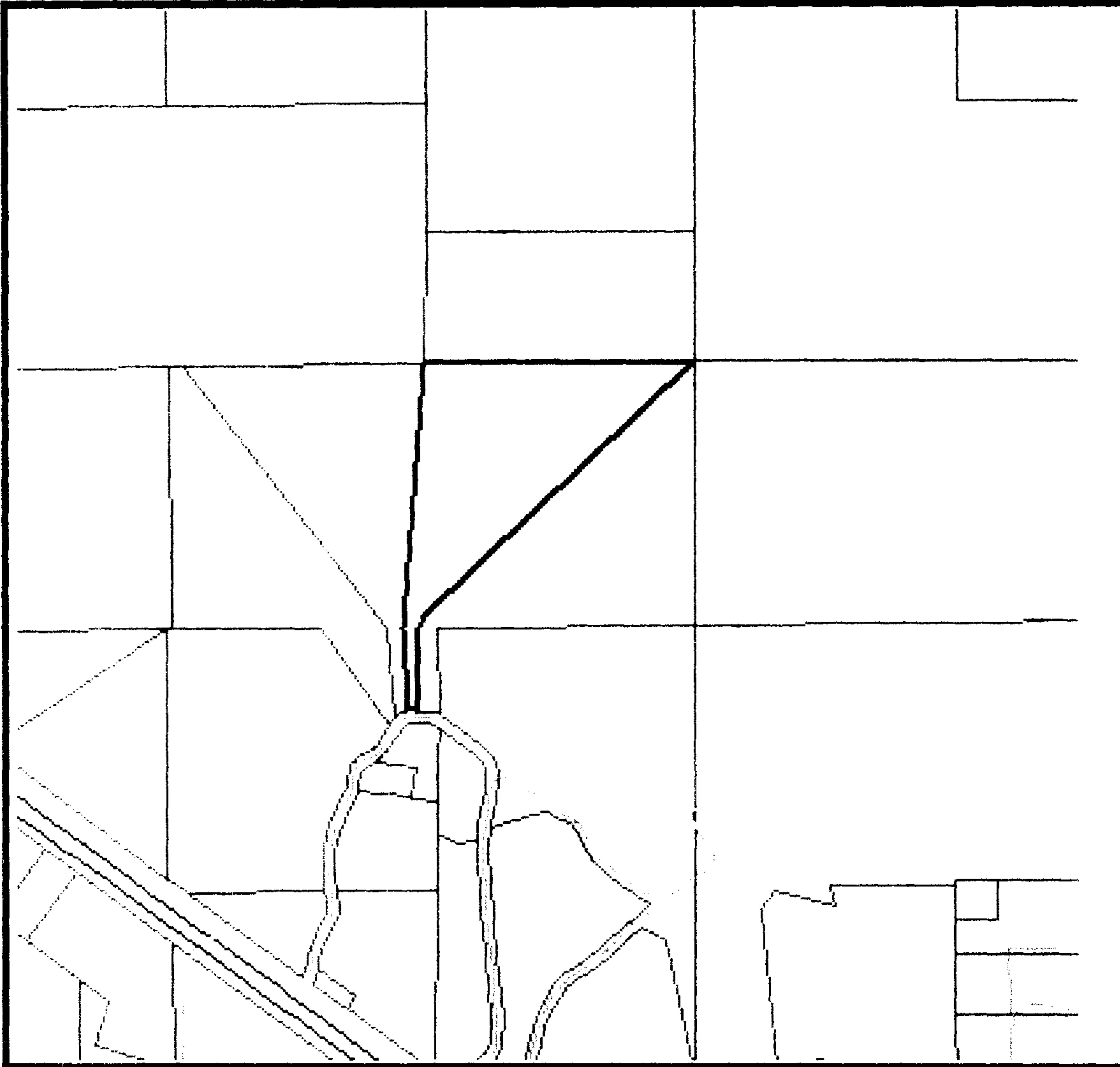

20060215000074880 5/7 \$29.00
Shelby Cnty Judge of Probate, AL
02/15/2006 09:07:49AM FILED/CERT

Property Information - 07 7 35 0 000 010.004**Owner Information**

Name 1	Name2	Address 1	Address 2	City	State	Zip Code
HOLCOMBE DEVELOPMENT LLC		2060 EAGLE RIDGE DRIVE		BIRMINGHAM	AL	35242
Subdivision	Primary Lot	Secondary Lot	Block	Section	Township	Range
STANDRIDGE DIVISION III	3			35	19S	02E
Map Book	Map Page	Lot Dimension 1	Lot Dimension 2	Number of Acres	Square Feet	
31	112	0	0	22.07	961369	

Description**Document Information**

Recorded Date	Recorded Number
20050520	20050526000255830
20000524	20000001779700000
19960116	19960000231900000
19951229	19960000125000000

20060215000074880 6/7 \$29.00
Shelby Cnty Judge of Probate, AL
02/15/2006 09:07:49AM FILED/CERT

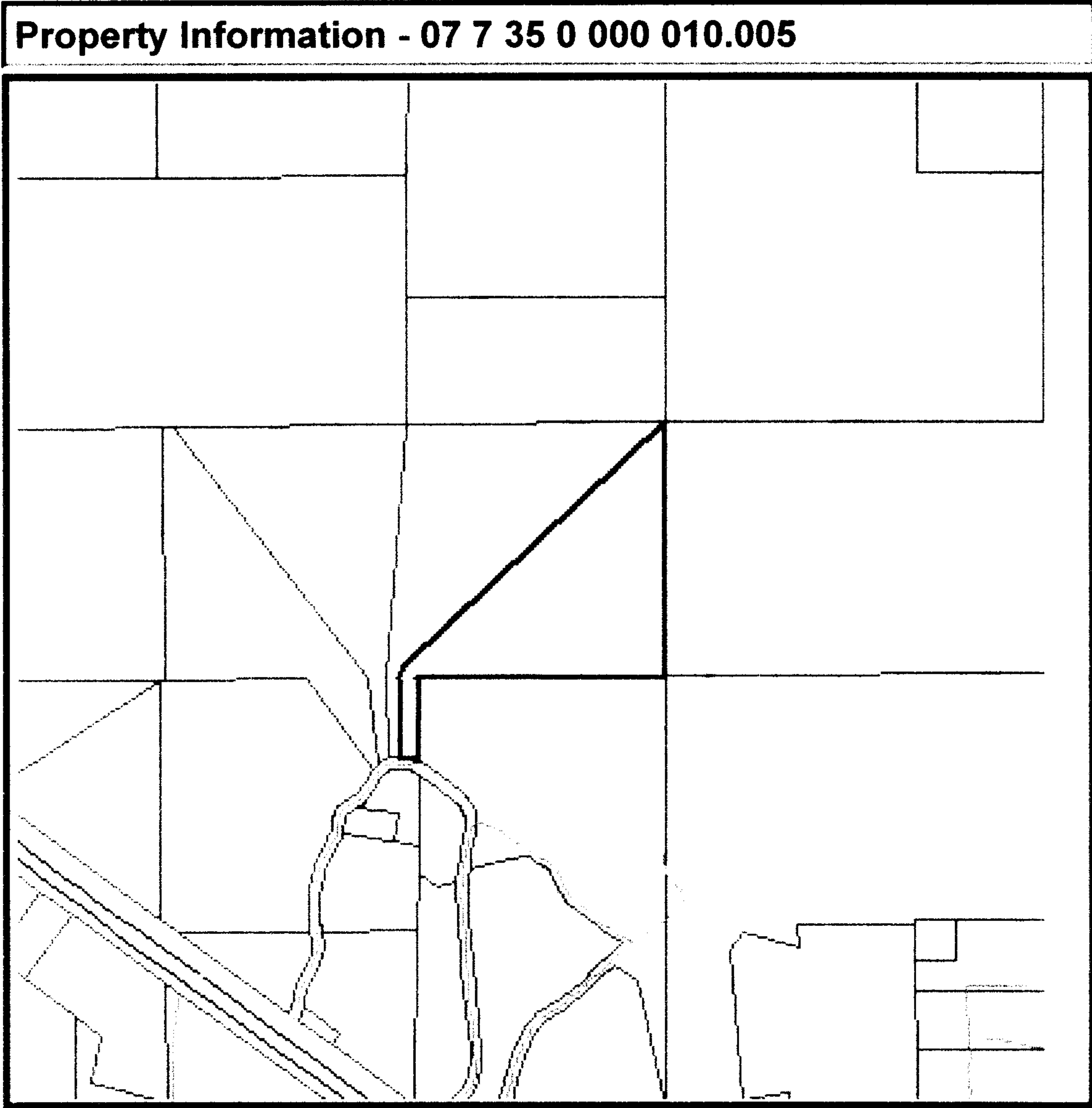

Owner Information						
Name 1	Name2	Address 1	Address 2	City	State	Zip Code
HOLCOMBE DEVELOPMENT LLC		2060 EAGLE RIDGE DRIVE		BIRMINGHAM	AL	35242
Subdivision	Primary Lot	Secondary Lot	Block	Section	Township	Range
STANDRIDGE DIVISION III	4			35	19S	02E
Map Book	Map Page	Lot Dimension 1	Lot Dimension 2	Number of Acres	Square Feet	
31	112	0	0	22.39	975308	
Description						

Document Information	
Recorded Date	Recorded Number
20050520	20050526000255830
20000524	20000001779700000
19960116	19960000231900000
19951229	19960000125000000

20060215000074880 7/7 \$29.00
Shelby Cnty Judge of Probate,AL
02/15/2006 09:07:49AM FILED/CERT