

**This instrument prepared by:**

Valerie J. Acocella  
Alabama Power Company  
P. O. Box 2641  
Birmingham, Alabama 35291

KNOW ALL MEN BY THESE PRESENTS, THAT Escalade Properties, LLC as (the "Grantor", whether one or more) for and in consideration of One and No/Dollars (\$1.00), and other good and valuable consideration, to Grantor in hand paid by Alabama Power Company (the "Company") a corporation, the receipt of which is hereby acknowledged, doers hereby grant to Company, its successors and assigns, the right from time to time to construct, install, operate and maintain, along a route not greater than ten feet (10') in width to be selected by the Company which is generally shown on the attached drawing, all conduits, cables, trans closures and other appliances and facilities useful or necessary in connection therewith (collectively, "Facilities"), for the underground transmission and distribution of electric power and also the right to clear and keep clear a strip of land extending five feet (5') to either side of the center line of said underground Facilities upon, over, under and across the following described real property situated in Shelby County, Alabama (the "Property"), to wit:

**Lot 2 of Cedar Hill Subdivision as recorded in Map Book 34, Page 108 and being situated in the Northwest Quarter of the Southwest Quarter of Section 7, Township 20 South, Range 1 West as recorded in Deed Record 20050607000275350 in the Office of the Judge of Probate in Shelby County, Alabama.**

Together with all the rights and privileges necessary or convenient for the full enjoyment or use thereof, including the right of ingress and egress to and from said facilities and the right to excavate for installation, replacement, repair and removal thereof; and also the right to cut and keep clear any and all obstructions or obstacles of whatever character on, under and above said facilities.

TO HAVE AND TO HOLD such easement to Company, its successors and assigns, forever.

IN WITNESS WHEREOF, \_\_\_\_\_ have set \_\_\_\_\_ hand(s) and seal(s) this the \_\_\_\_\_ day of \_\_\_\_\_, 2005.

**WITNESS:**

**GRANTOR(S):**

20060131000049920 1/3 \$17.50  
Shelby Cnty Judge of Probate,AL  
01/31/2006 02:37:30PM FILED/CERT

---

---

---

\_\_\_\_\_ (SEAL)

\_\_\_\_\_ (SEAL)

By: \_\_\_\_\_ (SEAL)  
As:

IN WITNESS WHEREOF, the said Grantor, has caused this instrument to be executed by BRADLEY Phillips its authorized representative, as of the 16<sup>th</sup> day of NOVEMBER, 2005.

**ATTEST (if corporation) or WITNESS:**

Escalade Properties, LLC  
(Grantor - Name of Corporation/Partnership/LLC)

Shelby County, AL 01/31/2006  
State of Alabama

By: \_\_\_\_\_ Deed Tax: \$.50

By: [Signature] (SEAL)

Its: \_\_\_\_\_

Its: 

[indicate President, General Partner, Member, etc.]



INDIVIDUAL NOTARIES

STATE OF ALABAMA }  
COUNTY OF \_\_\_\_\_ }

I, the undersigned, a Notary Public, in and for said County in said State, hereby certify that \_\_\_\_\_  
\_\_\_\_\_ whose name(s) is/are signed to the  
foregoing instrument and who is/are known to me, acknowledged before me on this day that being informed of the contents  
of the instrument, he/she/they executed the same voluntarily, on the day the same bears date.

Given under my hand and official seal this the \_\_\_\_\_ day of \_\_\_\_\_, 2005.

[SEAL]

\_\_\_\_\_  
Notary Public  
My commission expires: \_\_\_\_\_

STATE OF ALABAMA }  
COUNTY OF \_\_\_\_\_ }

I, the undersigned, a Notary Public, in and for said County in said State, hereby certify that \_\_\_\_\_  
\_\_\_\_\_ whose name(s) is/are signed to the  
foregoing instrument and who is/are known to me, acknowledged before me on this day that being informed of the contents  
of the instrument, he/she/they executed the same voluntarily, on the day the same bears date.

Given under my hand and official seal this the \_\_\_\_\_ day of \_\_\_\_\_, \_\_\_\_\_.

[SEAL]

\_\_\_\_\_  
Notary Public  
My commission expires: \_\_\_\_\_

TRUSTEE/CORPORATION/PARTNERSHIP/LLC NOTARY

STATE OF ALABAMA }  
COUNTY OF JEFFERSON }

  
20060131000049920 2/3 \$17.50  
Shelby Cnty Judge of Probate, AL  
01/31/2006 02:37:30PM FILED/CERT

I, the undersigned, a Notary Public, in and for said County in said State, hereby certify that BRADLEY PHILLIPS  
whose name as PRESIDENT of Escalade Properties, LLC a \_\_\_\_\_ [as \_\_\_\_\_  
\_\_\_\_\_] is signed to the foregoing instrument, and who is known to  
me, acknowledged before me on this day that being informed of the contents of the instrument, he/she, as such \_\_\_\_\_  
PRESIDENT and with full authority, executed the same voluntarily for and as the act of said Escalade Properties,  
LLC [acting in such capacity as aforesaid].

Given under my hand and official seal, this the 16<sup>th</sup> day of NOVEMBER, 2005.

[SEAL]

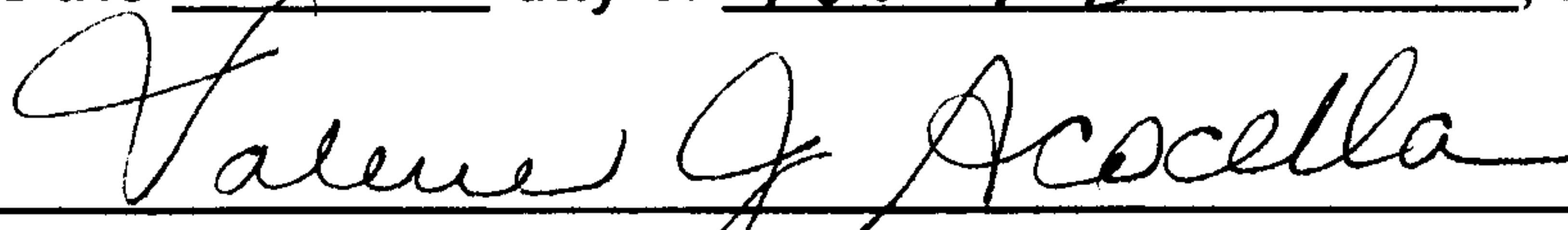
  
\_\_\_\_\_  
Notary Public  
My commission expires: Aug. 12, 2009

=====

**For Alabama Power Company Corporate Real Estate Department Use Only**

All facilities on Grantor: ☒

Station to Station: STA 1+00 to STA 1+150

## SKETCH OF PROPOSED WORK — SIMPLIFIED W. E.

Customer ESCALADE BUILDERS		Location LOT #2 Co RD 336		Agreed Serv. Date		Estimate No. 61700-00-05275	
Division POWER DELIVERY		District METRO-SOUTH		Town CHELSEA		Drawn by J. Frost	
County SHELBY		Section 7		Township 20 S		Range 01 W	
Acquisition Agent VALERIE ACOCELA		Date R/W Assigned 11-14-2005		Date R/W Cleared 11-16-2005		Map Reference	
						LOC	
						Transformer Loading	

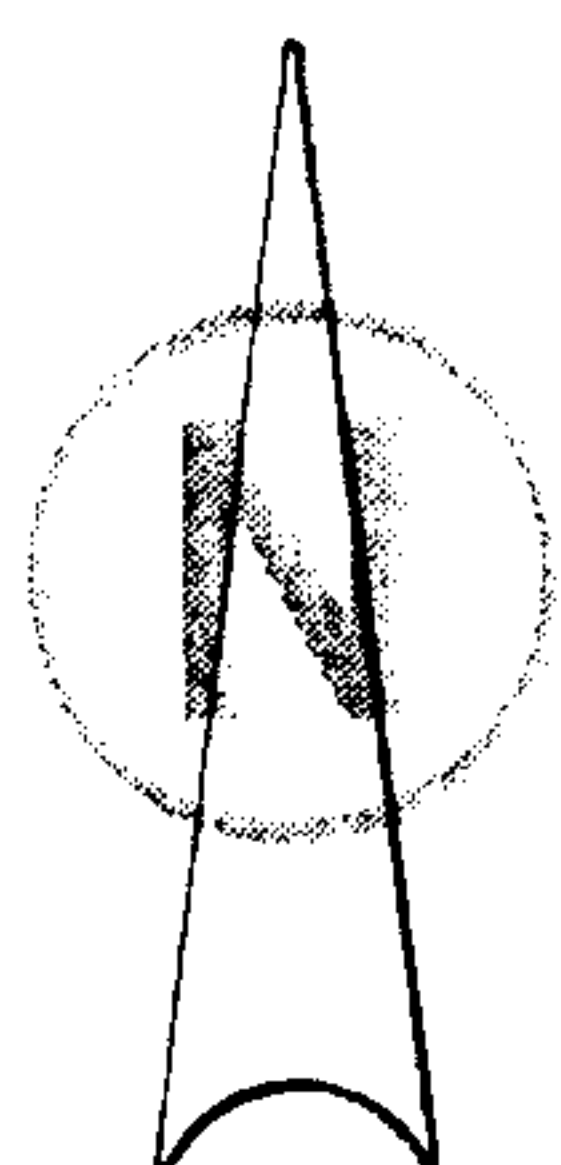

APCO CONTRACTOR TO PERFORM ALL TRENCHING  
APCO TO BILL CUSTOMER PER CSP

X	34724 CHELSEA DS#
Y	K6029

<b>Voltage</b>	
<b>Pri</b>	<b>Sec.</b>
<b>PHONE CO.</b>	
<b>Co. Name</b>	
<b>CATV CO.</b>	
<b>Co. Name</b>	
<b>ACCESSIBLE</b>	
<b>TREE CREW</b>	
<b>ROCK HOLE</b>	
<b>PERMITS REQ'D</b>	
<b>R/W</b>	
<b>CITY</b>	
<b>COUNTY</b>	
<b>STATE</b>	
<b>MISSALL</b>	
<b>#</b>	
<b>OTHER</b>	
<b>SCALE</b>	
<b>Ft. Per Inch</b>	

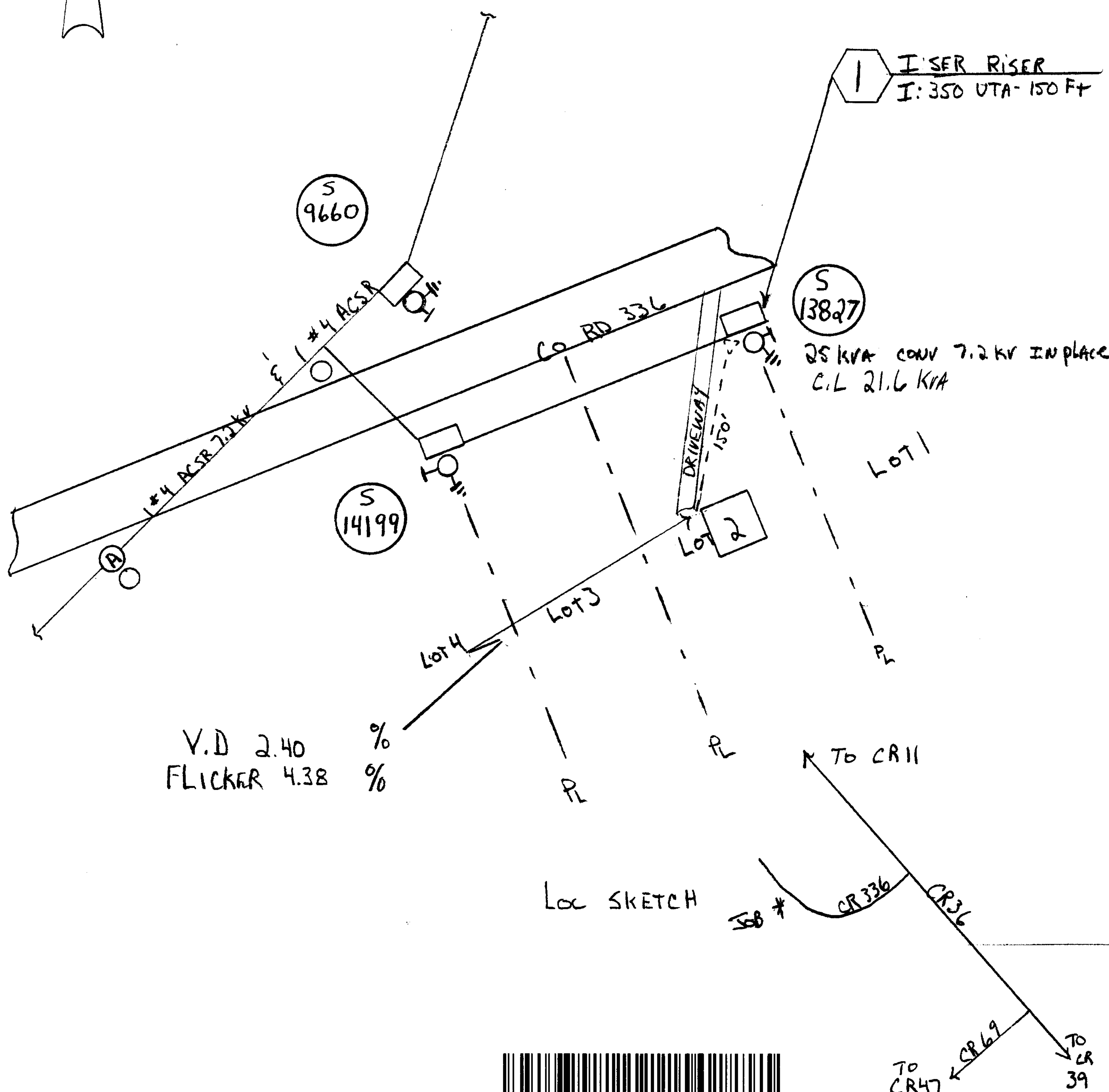

20060131000049920 3/3 \$17.50  
Shelby Cnty Judge of Probate, AL  
01/31/2006 02:37:30PM FILED/CER

**Cnst. Completed By**

**Date**