

This instrument prepared by:

Alabama Power Company
P. O. Box 2641
Birmingham, Alabama 35291

Form 5-5783 Rev. 4/05

IN WITNESS WHEREOF, the said Grantor, has caused this instrument to be executed by _____ is authorized
representative, as of the _____ day of _____, 20_____.

ATTEST (if corporation) or WITNESS:

(Grantor - Name of Corporation/Partnership/LLC)

By: _____
Its: _____

By: _____ (SEAL)
Its: _____

[indicate President, General Partner, Member, etc.]

INDIVIDUAL NOTARIES

STATE OF ALABAMA }
COUNTY OF _____ }

I, the undersigned, a Notary Public, in and for said County in said State, hereby certify that _____
_____ whose name(s) is/are signed to the foregoing instrument and who is/are known to me, acknowledged before me on
this day that being informed of the contents of the instrument, he/she/they executed the same voluntarily, on the day the same bears date.
Given under my hand and official seal this the _____ day of _____, _____.

[SEAL]

Notary Public
My commission expires: _____

STATE OF ALABAMA }
COUNTY OF _____ }

I, the undersigned, a Notary Public, in and for said County in said State, hereby certify that _____
_____ whose name(s) is/are signed to the foregoing instrument and who is/are known to me, acknowledged before me on
this day that being informed of the contents of the instrument, he/she/they executed the same voluntarily, on the day the same bears date.
Given under my hand and official seal this the _____ day of _____, _____.

[SEAL]

Notary Public
My commission expires: _____

TRUSTEE/CORPORATION/PARTNERSHIP/LLC NOTARY

STATE OF ALABAMA }
COUNTY OF _____ }

20051101000566640 2/4 \$20.50
Shelby Cnty Judge of Probate, AL
11/01/2005 11:58:59AM FILED/CERT

I, the undersigned, a Notary Public, in and for said County in said State, hereby certify that _____
_____, whose name as _____ of _____
_____ a _____ [as _____
_____] is signed to the foregoing instrument, and who is known to me, acknowledged before me on this day that
being informed of the contents of the instrument, he/she, as such _____ and with full authority, executed the same voluntarily for and as the
act of said _____ [acting in such capacity as aforesaid].
Given under my hand and official seal, this the _____ day of _____, _____.

[SEAL]

Notary Public
My commission expires: _____

For Alabama Power Company Corporate Real Estate Department Use Only

All facilities on Grantor: _____

Station to Station: Sta # 1450 to Sta # 2+00
Sta # 2+00 to Sta # 2+120 Udy

SKETCH OF PROPOSED WORK
SIMPLIFIED W.E.

Map Center UTM
1714878 12011624

Map Center LatLon
-86.756802 33.088734



Customer KERMIT ROBERSON		Location 2699 16TH STREET			Agreed Serv. Date 9-30-05		Estimate No. 61700-00-03015					
Region B-TAKU-SOUTH		Oper. Cntr. PELHAM		Town/City CALERA		UserID rejoan		Created: 6/29/2005				
County Shelby BE-24N-3-4	Section 3	Township 24N	Range 13E	Add'l Info PHONE # 668-2665								
Acquisition Agent L.P.J.		Date R/W Assigned 6-29-05		Date R/W Cleared 7-26-05		Spatial Reference		LOC	Transformer Loading			
Voltage 7.2	Phone Co YES	CATV Co YES	Accessible YES	Tree Crew NO	Rock Hole NO	Permits	R/W YES	City NO	County NO	State NO	Miss All YES	Other NO

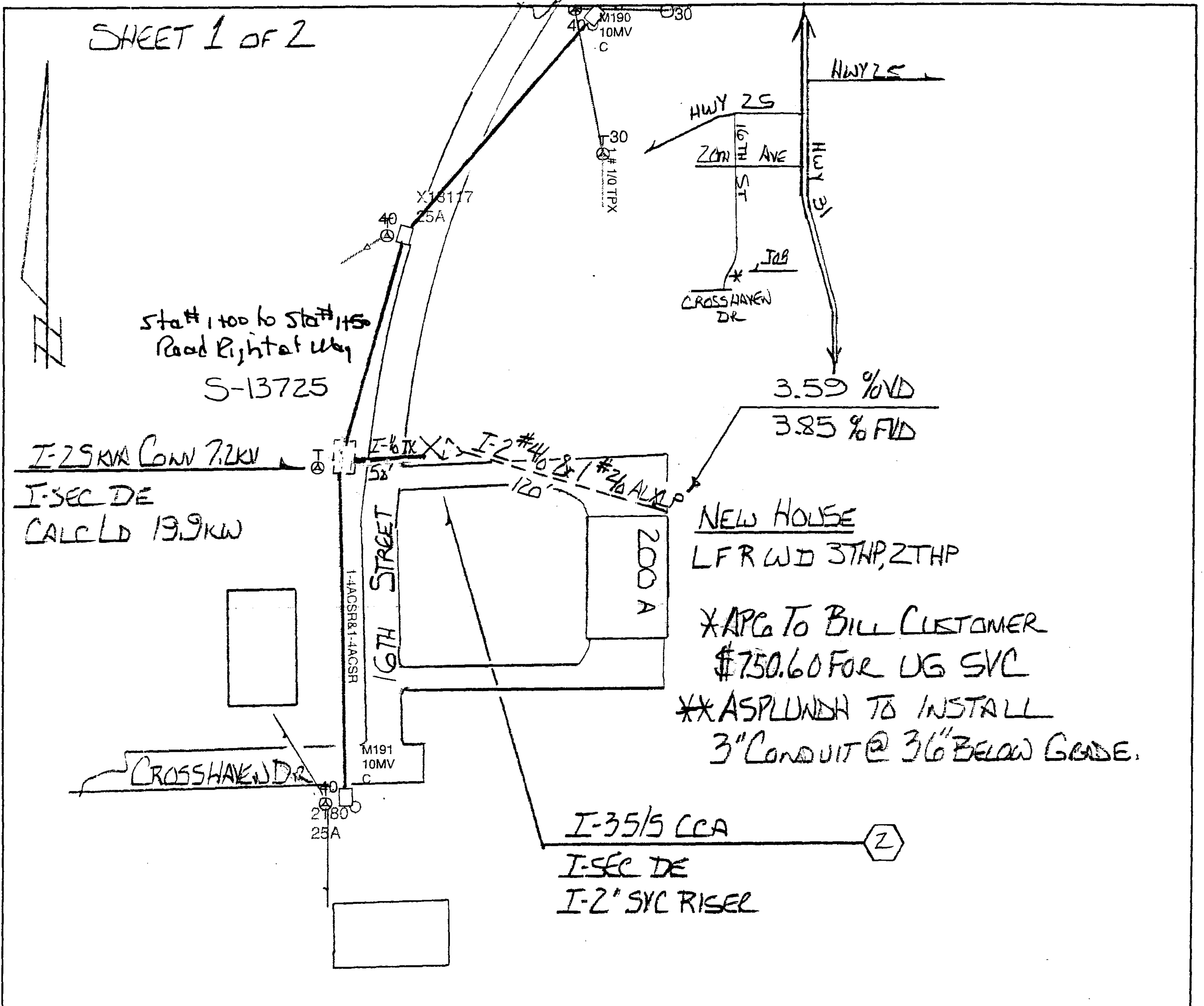

20051101000566640 3/4 \$20.50
Shelby Cnty Judge of Probate, AL
11/01/2005 11:58:59AM FILED/CERT

Cnst Completed By:

Date:

Scale: 1 inch equals 104 feet

66103
 RC885

