

EASEMENT - DISTRIBUTION FACILITIES
(Metes and Bounds)

TO BE RECORDED: YES X NO

STA 1400 TO STA 14155
This instrument prepared by:

Jeff J. Callicott

STATE OF ALABAMA }
COUNTY OF Shelby }
TAX ID # _____

W.E. No. 61730-00-00395
Parcel No. 70157001
Transformer No. S-2581

Alabama Power Company
P. O. Box 2641
Birmingham, Alabama 35291

A. GRANT KNOW ALL MEN BY THESE PRESENTS, That Jon Hildreth, and wife, Leah Hildreth

as grantors (s), (the "Grantor", whether one or more) for and in consideration of One and No/100 (\$1.00) and other good and valuable consideration, to Grantor in hand paid by Alabama Power Company, a corporation, the receipt and sufficiency of which are hereby acknowledged, does hereby grant to Alabama Power Company, its successors and assigns (the "Company"), the easements, rights and privileges described and designated in Section B below.

B. RIGHTS The easements, rights and privileges granted hereby are as follows:

- ✓ 1. ~~Overhead and/or~~ **Underground**. The right from time to time to construct, install, operate and maintain, upon, over, under and across the Property described in Section C below, along a route to be selected by the Company which is generally shown on the Company's final location drawing (which shows the general location of underground Facilities, if any, by cross-hatching indicating an area not greater than ten feet (10') in width), all poles, towers, wires, conduits, fiber optics, cables, trans closures, transformers, anchors, guy wires and other Facilities useful or necessary in connection therewith (collectively, "Facilities"), for the overhead and/or underground transmission and distribution of electric power, and also the right to clear and keep clear a strip of land extending five feet (5') to either side of the center line of underground Facilities and fifteen feet (15') to either side of the center line of overhead Facilities; further, the right in the future to install and utilize intermediate poles in line for overhead Facilities and the right to trim and cut and keep trimmed and cut all dead, weak, leaning or dangerous trees or limbs outside of the thirty foot (30') strip for overhead Facilities that, in the sole opinion of the Company, might now or may hereafter endanger, interfere with or fall upon any of the overhead Facilities.
2. Line Clearing. The right to trim and cut and keep trimmed and cut all dead, weak, leaning or dangerous trees or limbs that, in the sole opinion of the Company, might now or may hereafter endanger, interfere with or fall upon the electric transmission or distribution lines, poles, towers or other Facilities now or hereafter located adjacent to the Property described in Section C below along a route to be selected by the Company generally shown on the Company's final location drawing, and also the right to clear and keep clear all trees, undergrowth, and other obstructions on property in which Grantor has an interest within fifteen feet (15') of the center line of the lines of such poles, towers or other Facilities.
3. Guy Wires and Anchors. The right to implant, install and maintain anchor(s) of concrete, metal or other material on and under the Property described in Section C below, and to construct, extend and maintain guy wires from such anchor(s) to structures now or hereafter erected adjacent to such Property or property adjacent thereto (collectively, "Guy Wire Facilities") along a route to be selected by the Company generally shown on the Company's final location drawing; and also the right to trim and cut and keep trimmed and cut all dead, weak, leaning or dangerous trees or limbs that, in the sole opinion of the Company, might now or may hereafter endanger, interfere with or fall upon any of the Guy Wire Facilities.

Grantor hereby grants to the Company all easements, rights and privileges necessary or convenient for the full enjoyment and use thereof, including without limitation the right of ingress and egress to and from the Facilities and Guy Wire Facilities, as applicable, and the right to excavate for installation, replacement, repair and removal thereof; and also the right to cut, remove and otherwise keep clear any and all structures, obstructions or obstacles of whatever character, on, under and above said Facilities and Guy Wire Facilities, as applicable.

C. **PROPERTY DESCRIPTION** The easements, rights and privileges granted hereby shall apply to, and the word "Property" as used in this instrument shall mean, the following described real property situated in Shelby County, Alabama (the "Property"):

For legal description, see Exhibit "A" attached hereto and made a part hereof.



20050805000400440 1/3 \$17.50
Shelby Cnty Judge of Probate, AL
08/05/2005 12:39:34PM FILED/CERT

D. **ADDITIONAL PROVISIONS.** In the event it becomes necessary or desirable for the Company to move any of the Facilities in connection with the construction or improvement of any public road or highway in proximity to the Facilities, Grantor hereby grants to the Company the right to relocate the Facilities and, as to such relocated Facilities, to exercise the rights granted above; provided, however, the Company shall not relocate the Facilities on the Property at a distance greater than ten feet (10') outside the boundary of the right of way of any such public road or highway as established or re-established from time to time. This grant and agreement shall be binding upon and shall inure to the benefit of Grantor, the Company and each of their respective heirs, personal representatives, successors and assigns and the words "Company" and "Grantor" as used in this instrument shall be deemed to include the heirs, personal representatives, successors and assigns of such parties.

TO HAVE AND TO HOLD the same to the Company, its successors and assigns, forever.

IN WITNESS WHEREOF, the undersigned Grantor(s) has/have set h/s/her/their hand(s) and seal(s) this the 14th day of Feb., 2005.

Witness

(Grantor)

Witness

(Grantor)

Witness

By:

As:

Shelby County, AL 08/05/2005
State of Alabama

Deed Tax: \$.50

EXHIBIT "A"
61730-00-00395

Commence at the Southeast corner of the Northwest 1/4 of the Northwest 1/4 of Section 35, Township 20 South, Range 4 West; thence run Westerly along the South line of said 1/4-1/4 Section, a distance of 449.75 feet; thence turn an angle to the right of 90 degrees, 00 minutes, 00 seconds for a distance of 149.40 feet to the Point of Beginning; thence turn an angle to the left of 23 degrees 10 minutes 20 seconds for a distance of 195.0 feet; thence turn an angle to the right of 90 degrees 00 minutes 00 seconds for a distance of 225.0 feet; thence turn an angle to the right of 90 degrees, 00 minutes, 00 seconds for a distance of 195.0 feet; thence turn an angle to the right of 90 degrees 00 minutes 00 seconds for a distance of 225.0 feet to the Point of Beginning, Shelby County, Alabama.

Exhibit A to deed

Hildreth to Hildreth

October 27, 2004

20041029000599240 Pg 2/2 15.00
Shelby Cnty Judge of Probate, AL
10/29/2004 13:54:00 FILED/CERTIFIED

Initial

SH

Initial

SH



20050805000400440 2/3 \$17.50
Shelby Cnty Judge of Probate, AL
08/05/2005 12:39:34PM FILED/CERT

SKETCH OF PROPOSED WORK SIMPLIFIED W.E.

Map Center UTM
1661437 12072876

Map Center LatLon
-86.931213 33.257355



Customer LEAH HILDRETH			Location RIDGEWAY LN			Agreed Serv. Date			Estimate No. 61730-00-00395			
Region PD - BIRMINGHAM			Oper. Cntr. BHAM - SOUTH		Town/City HELENA		UserID jacofer		Created: 1/14/2005			
County Shelby		Section 35	Township 20S	Range 04W	Add'l Info 4W-20-35-2							
Acquisition Agent			Date R/W Assigned		Date R/W Cleared		Spatial Reference		LOC		Transformer Loading	
Voltage	Phone Co	CATV Co	Accessible	Tree Crew	Rock Hole		R/W	City	County	State	Miss All	Other
19.9KV	NO	NO	YES	NO	NO	Permits	YES	NO	NO	NO	YES	

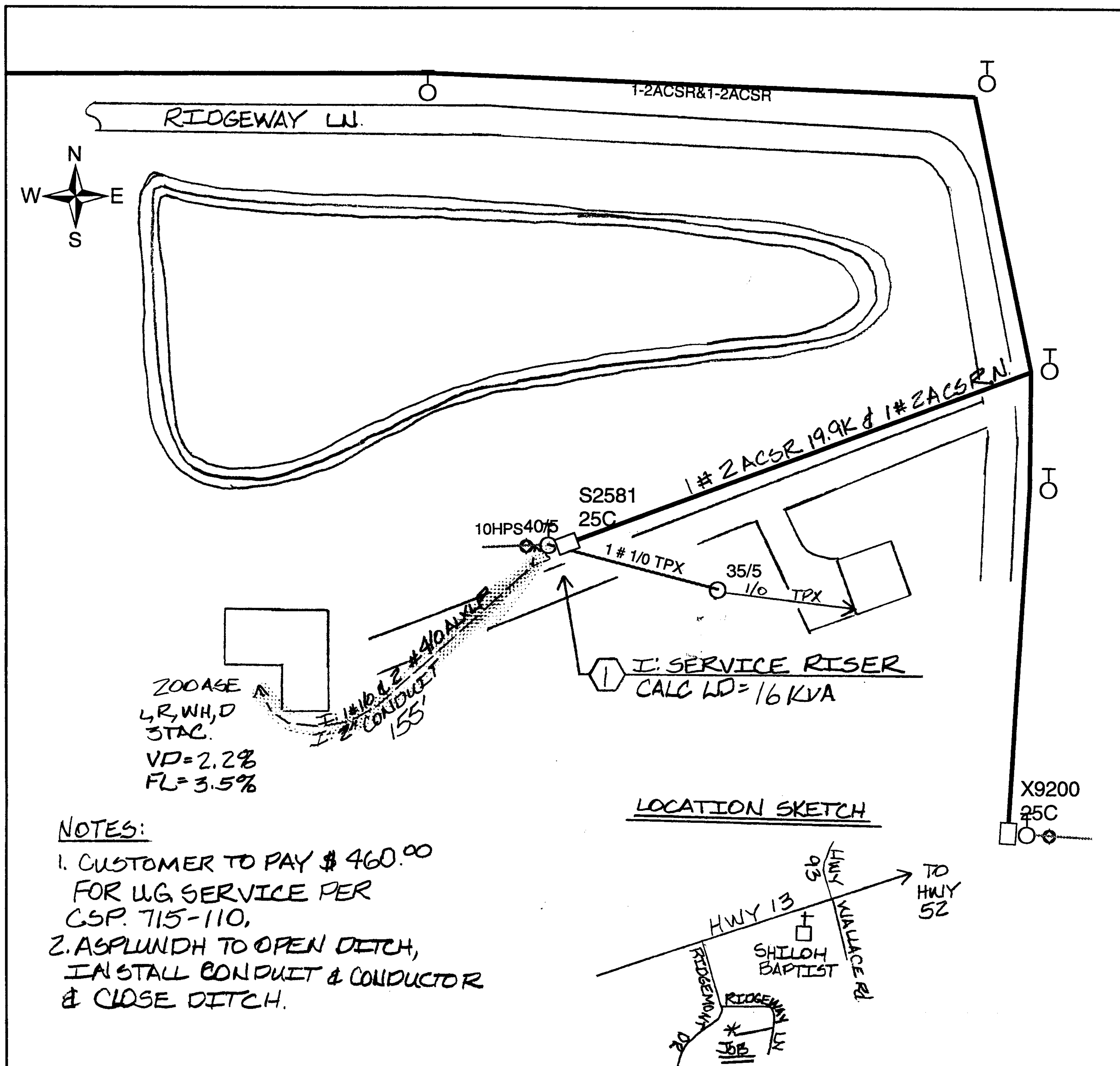

Cnst Completed By:



20050805000400440 3/3 \$17.50
Shelby Cnty Judge of Probate, AL
08/05/2005 12:39:34PM FILED/CERT

Date:

Scale: 1 inch equals 80 feet