

#1752  
EASEMENT - DISTRIBUTION FACILITIES  
(Metes and Bounds)

TO BE RECORDED: YES ☒ NO ☐

STN 2-40 To STA 2-68  
This instrument prepared by:

JEFF J. GALLICOTT

STATE OF ALABAMA }

W.E. No. 61700-00-03894

Alabama Power Company

COUNTY OF SHELBY }

Parcel No. 70137777

P. O. Box 2641

TAX ID # 13-8-34-3-002-003.005

Transformer No. \_\_\_\_\_

Birmingham, Alabama 35291

A. GRANT KNOW ALL MEN BY THESE PRESENTS, That SWEENEY HOMEBUILDERS, INC.

as grantors (s), (the "Grantor", whether one or more) for and in consideration of One and No/100 (\$1.00) and other good and valuable consideration, to Grantor in hand paid by Alabama Power Company, a corporation, the receipt and sufficiency of which are hereby acknowledged, does hereby grant to Alabama Power Company, its successors and assigns (the "Company"), the easements, rights and privileges described and designated in Section B below.

B. RIGHTS The easements, rights and privileges granted hereby are as follows:

- ✓ 1. **Overhead and/or Underground.** The right from time to time to construct, install, operate and maintain, upon, over, under and across the Property described in Section C below, along a route to be selected by the Company which is generally shown on the Company's final location drawing (which shows the general location of underground Facilities, if any, by cross-hatching indicating an area not greater than ten feet (10') in width), all poles, towers, wires, conduits, fiber optics, cables, trans closures, transformers, anchors, guy wires and other Facilities useful or necessary in connection therewith (collectively, "Facilities"), for the overhead and/or underground transmission and distribution of electric power, and also the right to clear and keep clear a strip of land extending five feet (5') to either side of the center line of underground Facilities and fifteen feet (15') to either side of the center line of overhead Facilities; further, the right in the future to install and utilize intermediate poles in line for overhead Facilities and the right to trim and cut and keep trimmed and cut all dead, weak, leaning or dangerous trees or limbs outside of the thirty foot (30') strip for overhead Facilities that, in the sole opinion of the Company, might now or may hereafter endanger, interfere with or fall upon any of the overhead Facilities.
2. **Line Clearing.** The right to trim and cut and keep trimmed and cut all dead, weak, leaning or dangerous trees or limbs that, in the sole opinion of the Company, might now or may hereafter endanger, interfere with or fall upon the electric transmission or distribution lines, poles, towers or other Facilities now or hereafter located adjacent to the Property described in Section C below along a route to be selected by the Company generally shown on the Company's final location drawing, and also the right to clear and keep clear all trees, undergrowth, and other obstructions on property in which Grantor has an interest within fifteen feet (15') of the center line of the lines of such poles, towers or other Facilities.
3. **Guy Wires and Anchors.** The right to implant, install and maintain anchor(s) of concrete, metal or other material on and under the Property described in Section C below, and to construct, extend and maintain guy wires from such anchor(s) to structures now or hereafter erected adjacent to such Property or property adjacent thereto (collectively, "Guy Wire Facilities") along a route to be selected by the Company generally shown on the Company's final location drawing; and also the right to trim and cut and keep trimmed and cut all dead, weak, leaning or dangerous trees or limbs that, in the sole opinion of the Company, might now or may hereafter endanger, interfere with or fall upon any of the Guy Wire Facilities.

Grantor hereby grants to the Company all easements, rights and privileges necessary or convenient for the full enjoyment and use thereof, including without limitation the right of ingress and egress to and from the Facilities and Guy Wire Facilities, as applicable, and the right to excavate for installation, replacement, repair and removal thereof; and also the right to cut, remove and otherwise keep clear any and all structures, obstructions or obstacles of whatever character, on, under and above said Facilities and Guy Wire Facilities, as applicable.

C. **PROPERTY DESCRIPTION** The easements, rights and privileges granted hereby shall apply to, and the word "Property" as used in this instrument shall mean, the following described real property situated in SHELBY County, Alabama (the "Property"):

LOT 3, ACCORDING TO THE SURVEY OF KAY LUCAS SUBDIVISION, AS RECORDED IN MAP  
BOOK 25, PAGE 92, IN THE OFFICE OF THE JUDGE OF PROBATE, SHELBY COUNTY,  
ALABAMA.  
(SE 1/4 OF SW 1/4 OF SECTION 34 TOWNSHIP 20 SOUTH RANGE 3 WEST)

D. **ADDITIONAL PROVISIONS.** In the event it becomes necessary or desirable for the Company to move any of the Facilities in connection with the construction or improvement of any public road or highway in proximity to the Facilities, Grantor hereby grants to the Company the right to relocate the Facilities and, as to such relocated Facilities, to exercise the rights granted above; provided, however, the Company shall not relocate the Facilities on the Property at a distance greater than ten feet (10') outside the boundary of the right of way of any such public road or highway as established or re-established from time to time. This grant and agreement shall be binding upon and shall inure to the benefit of Grantor, the Company and each of their respective heirs, personal representatives, successors and assigns and the words "Company" and "Grantor" as used in this instrument shall be deemed to include the heirs, personal representatives, successors and assigns of such parties.

TO HAVE AND TO HOLD the same to the Company, its successors and assigns, forever.

IN WITNESS WHEREOF, the undersigned Grantor(s) has/have set his/her/their hand(s) and seal(s) this the 22 day of Aug, 2004.

Witness \_\_\_\_\_

(Grantor) \_\_\_\_\_ (SEAL)

Witness \_\_\_\_\_

SWEENEY HOMEBUILDERS, INC. (SEAL)  
(Grantor)

Witness \_\_\_\_\_

By: [Signature] (SEAL)  
As: [Signature]



IN WITNESS WHEREOF, the said Grantor, has caused this instrument to be executed by \_\_\_\_\_ is authorized  
representative, as of the \_\_\_\_\_ day of \_\_\_\_\_, 20\_\_\_\_.

ATTEST (if corporation) or WITNESS:

\_\_\_\_\_  
(Grantor - Name of Corporation/Partnership/LLC)

By: \_\_\_\_\_  
Its: \_\_\_\_\_

By: \_\_\_\_\_ (SEAL)  
Its: \_\_\_\_\_

[indicate President, General Partner, Member, etc.]

**INDIVIDUAL NOTARIES**

STATE OF ALABAMA }  
COUNTY OF \_\_\_\_\_ }

I, the undersigned, a Notary Public, in and for said County in said State, hereby certify that \_\_\_\_\_  
\_\_\_\_\_ whose name(s) is/are signed to the foregoing instrument and who is/are known to me, acknowledged before me on  
this day that being informed of the contents of the instrument, he/she/they executed the same voluntarily, on the day the same bears date.

Given under my hand and official seal this the \_\_\_\_\_ day of \_\_\_\_\_, \_\_\_\_\_.

[SEAL]

\_\_\_\_\_  
Notary Public  
My commission expires: \_\_\_\_\_

STATE OF ALABAMA }  
COUNTY OF \_\_\_\_\_ }

I, the undersigned, a Notary Public, in and for said County in said State, hereby certify that \_\_\_\_\_  
\_\_\_\_\_ whose name(s) is/are signed to the foregoing instrument and who is/are known to me, acknowledged before me on  
this day that being informed of the contents of the instrument, he/she/they executed the same voluntarily, on the day the same bears date.

Given under my hand and official seal this the \_\_\_\_\_ day of \_\_\_\_\_, \_\_\_\_\_.

[SEAL]

\_\_\_\_\_  
Notary Public  
My commission expires: \_\_\_\_\_

**TRUSTEE/CORPORATION/PARTNERSHIP/LLC NOTARY**

STATE OF ALABAMA }  
COUNTY OF SHARBY }

I, the undersigned, a Notary Public, in and for said County in said State, hereby certify that EDWARD R. SWEENEY  
\_\_\_\_\_, whose name as PRES. of SWEENEY HOME BUILDINGS  
\_\_\_\_\_ a INC. [as \_\_\_\_\_]  
\_\_\_\_\_, is signed to the foregoing instrument, and who is known to me, SWEENEY acknowledged before me on this day that  
being informed of the contents of the instrument, he/she, as such PRES. and with full authority, executed the same voluntarily for and as the  
act of said \_\_\_\_\_ [acting in such capacity as aforesaid].

Given under my hand and official seal, this the 22<sup>ND</sup> day of AUGUST, 2004.

[SEAL]

A. J. Callahan  
\_\_\_\_\_  
Notary Public  
My commission expires: 11-17-07

**For Alabama Power Company Corporate Real Estate Department Use Only**

All facilities on Grantor: \_\_\_\_\_

Station to Station: \_\_\_\_\_

# SKETCH OF PROPOSED WORK — SIMPLIFIED W. E.

Customer <b>SWEENEY HOME BLDGS</b>		Location <b>W 1ST AV - ALA.</b>		Agreed Serv. Date		Estimate No. <b>61700-00-0389-4</b>	
Division <b>B' HAM</b>		District <b>SO. REGION</b>		Town <b>ALABASTER</b>		Drawn by <b>CROUCH</b>	
County <b>SHELBY</b>		Section <b>34</b>		Township <b>20S</b>		Range <b>3W</b>	
Acquisition Agent		Date R/W Assigned		Date R/W Cleared		Map Reference <b>55115</b>	
						Add'l Info <b>SWEENEY HOMEBUILDERS 3311 CO RD 2 MONTVALLO</b>	
						LOC <b>1</b>	
						Transformer Loading <b>29.3 kVA</b>	

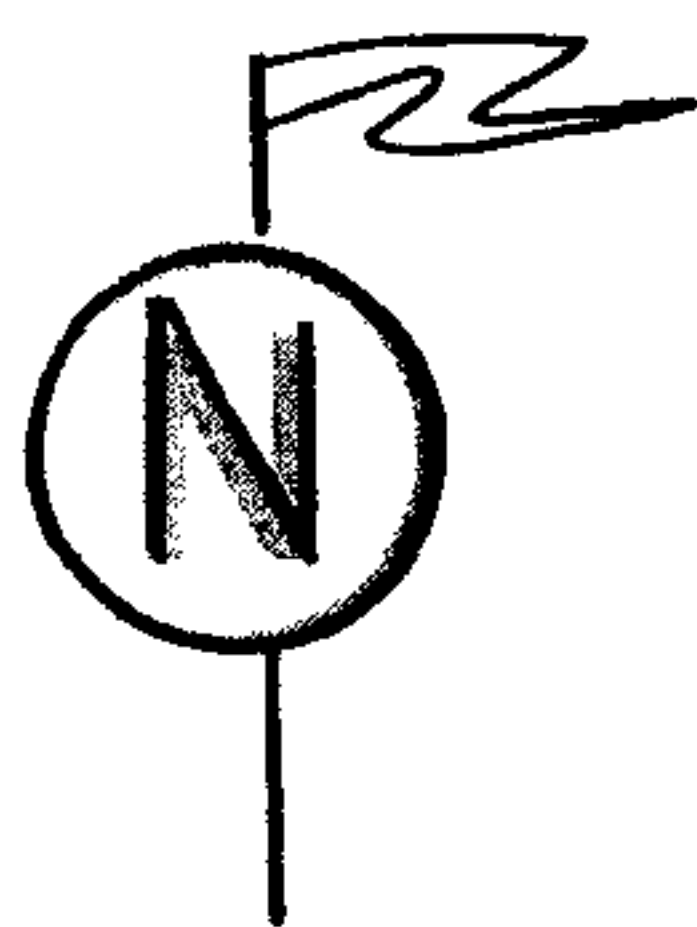

DEVELOPER COST  
\$ 150 FLAT FEE  
\$ 136 PER FOOT FOR ASP. TRENCHING  
\$ 286 TOTAL

I: 40<sup>5</sup> POLE JU  
IN B.S. TEL. LINE  
BILL TO BELL SO,

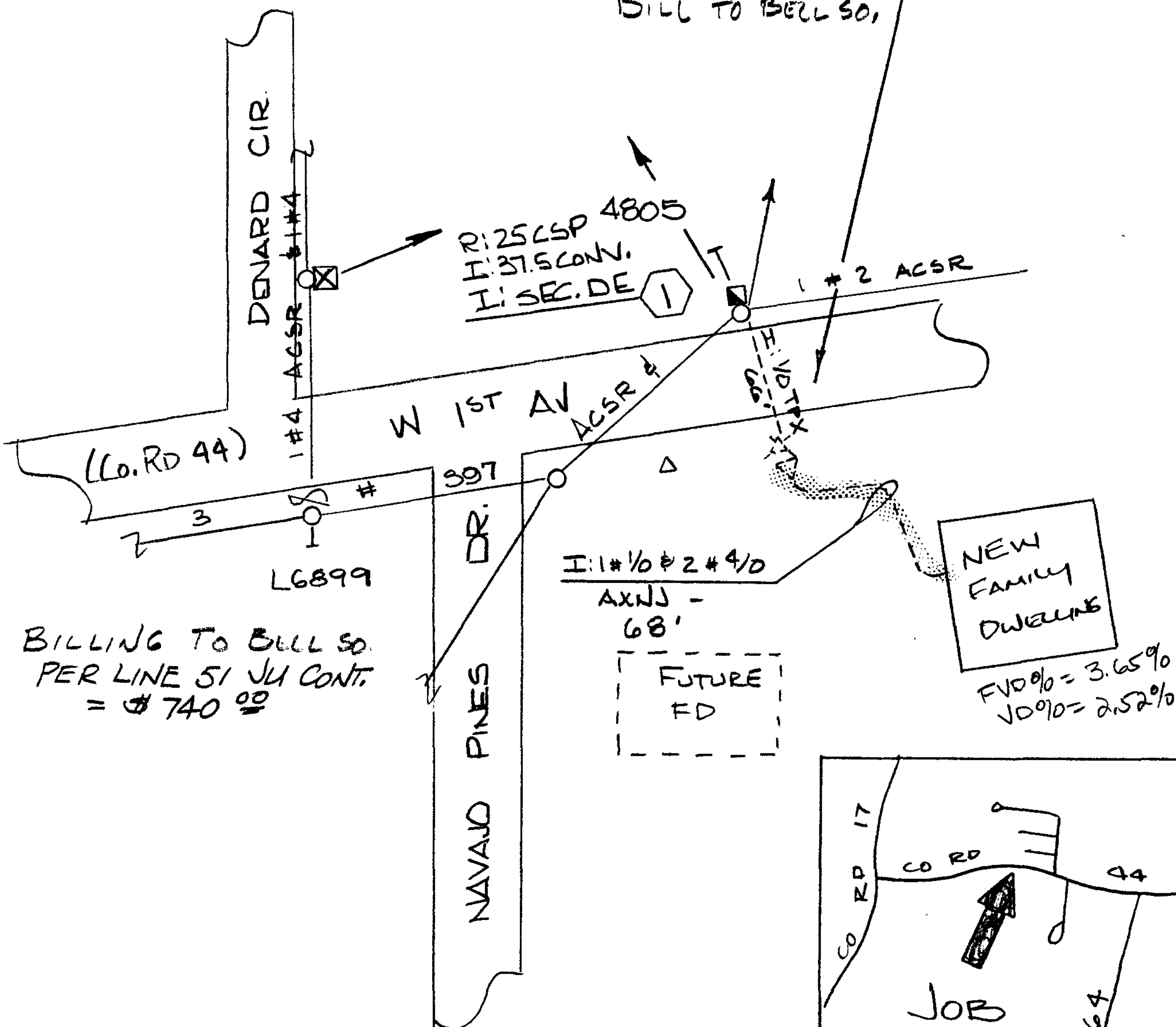

Voltage	
Pri	Sec.
PHONE CO.	
Co. Name	
CATV CO.	
Co. Name	
ACCESSIBLE	
TREE CREW	
ROCK HOLE	
PERMITS REQ'D	
R/W	
CITY	
COUNTY	
STATE	
MISSALL #	
OTHER	
SCALE	

Cnst. Completed By