

VARIANCE OF SET-BACK LINE

I, THE UNDERSIGNED, AM THE DEVELOPER UNDER THE DECLARATION OF PROTECTIVE COVENANTS, & RESTRICTIONS OF TOWNES AT BROOK HIGHLAND, RECORDED INSTRUMENT #2003-66365 AND AMENDED IN Inst # 2003-665710 IN THE PROBATE OFFICE OF SHELBY COUNTY, ALABAMA. UNDER SAID COVENANTS I HAVE THE POWER TO AMEND SET-BACK LINES AND RESTRICTIVE COVENANTS IN SAID SUBDIVISION.

I HAVE SEEN THE ATTACHED SURVEY DATED MAY 22, 2004 AND PREPARED BY HILL SURVEYING COMPANY ON LOT 20, TOWNES AT BROOK HIGHLAND AS RECORDED IN MAP BOOK 30 PAGE 133 A & B IN THE OFFICE OF THE JUDGE OF PROBATE IN SHELBY COUNTY, ALABAMA. UNDER THE TERMS OF THE COVENANTS, THE DEVELOPER HAS THE POWER AND DOES HEREBY GRANT A VARIANCE FOR THE DECK INTO THE BACK SET BACK LINE TO PERMIT THE IMPROVEMENTS ON SAID LOT TO BE LOCATED AS SHOWN IN THE ATTACHED SURVEY.

KEYSTONE BUILDING CO., INC.

DEVELOPER

CORY MASON, PRESIDENT

SWORN TO AND SUBSCRIBED BEFORE ME THIS THE 28 TH DAY OF MAY, 2004

NOTARY PUBLIC

COURTNEY H. MASON, JR.
COMMISSION EXPIRES MARCH 5, 2007

MY COMMISSION EXPIRES: 3/5/07

LEUNG
BARNES

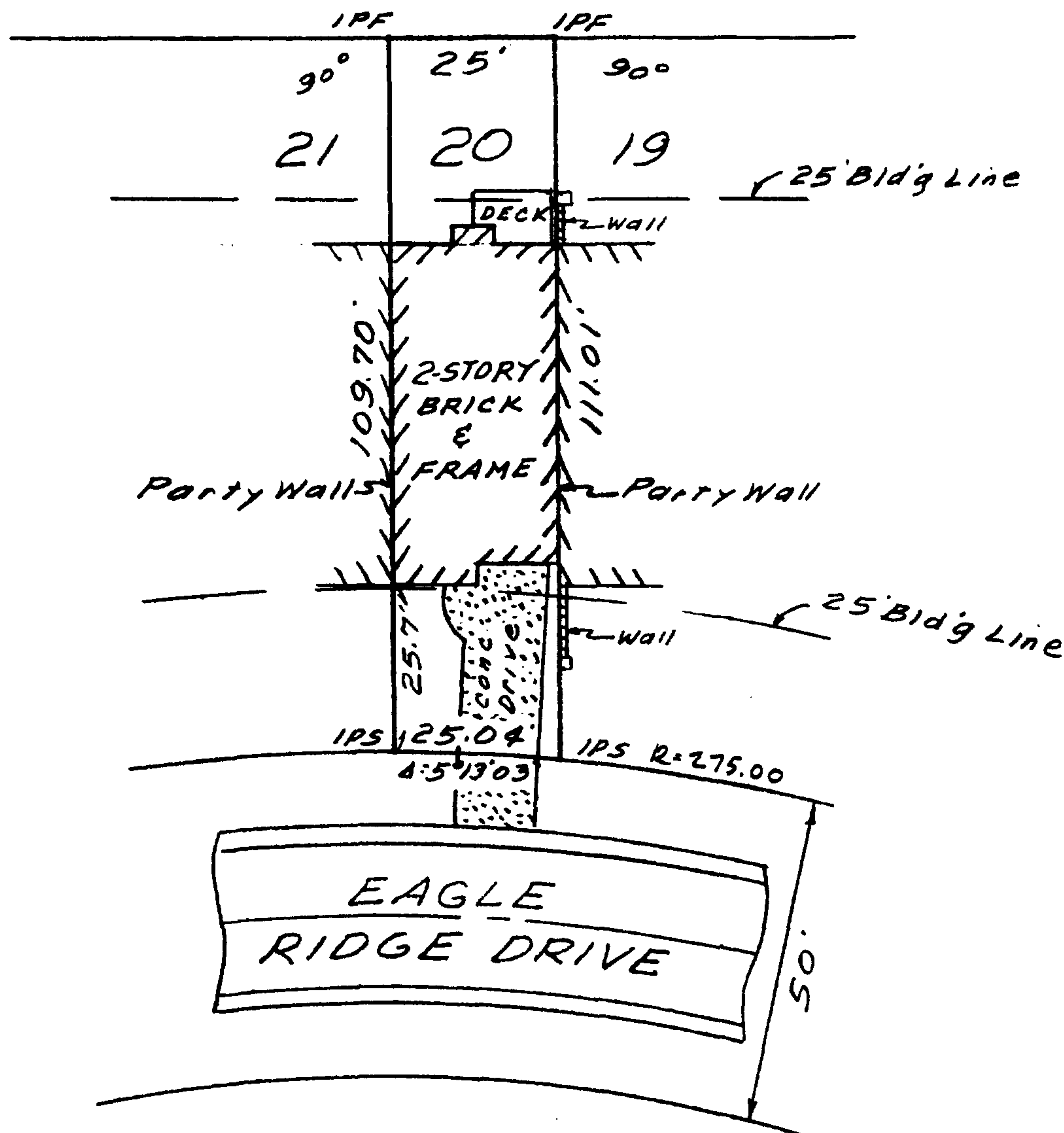

Note: Unless otherwise indicated by (P) - record plot dimension, (D) - deed call, or (M) - measured dimension by survey, all bearings, angles and distances shown hereon are actual. Furthermore this survey was performed without the benefit of an abstract of title. There may be other matters of public or private record not depicted on this survey. In addition, underground utilities or subsurface features were not measured as a part of this survey unless otherwise shown. (IPF) - Iron Pin Found, (IPS) - Iron Pin Set.

