

Mayor Roy introduced the following Ordinance:

ORDINANCE NO. 2004-13

WHEREAS, on or about the 23rd day of January 2004, George W. Roy, Mayor of the City of Calera filed a petition with the City Clerk of the City of Calera, Alabama as required by 11-42-20 and 11-42-21, Code of Alabama 1975, as amended, petitioning and requesting that the property hereinafter described be annexed to the municipality of the City of Calera, Alabama, which petition contained an accurate description of the property proposed to be annexed together with a map of the said property showing its relationship to the corporate limits of the City of Calera, Alabama, and the signature of the owner of the property described were signed thereto;

NOW, THEREFORE, BE IT ORDAINED BY THE CITY COUNCIL OF THE CITY OF CALERA, AS FOLLOWS:

1. That the City of Calera, Alabama does adopt this Ordinance assenting to the annexation of the property owned by the above referenced property owner, as described in:

Exhibit A

to the municipality of the City of Calera, Alabama.

2. That the corporate limits of the City of Calera, Alabama, be extended and rearranged so as to embrace and include such property, and such property shall become a part of the corporate area of such municipality upon the date of publication or posting of this Ordinance, as provided for in the Code of Alabama as cited above.

3. That the City Clerk be and she is hereby authorized and directed to file a copy of this ordinance, including an accurate description of the property being annexed, together with a map of the said property showing its relationship to the corporate limits of the City of Calera, Alabama, to which said property is being annexed in the office of the Judge of Probate of Shelby County, Alabama.

4. That the Zoning Map of the City of Calera, Alabama and any other official maps or surveys of the City shall be amended to reflect the annexation of the above described property, and that a copy of this Ordinance be transmitted to the City Planning Commission and the Zoning Administrator.

Council Member Phillips moved that unanimous consent of the Council be given for the immediate action upon said Ordinance. Council Member Jones seconded said motion and upon vote the results were:

AYES: Roy, Phillips, Jones, Morrison, Glasgow, Davis

NAYS: None

The Mayor declared said motion carried and unanimous consent given.

Council Member Glasgow moved that Ordinance No. 2004-13 be adopted, which motion was seconded by Council Member Davis and upon vote the results were as follows:

AYES: Roy, Glasgow, Davis, Jones, Morrison, Phillips

NAYS: None

Adopted this 2nd day of February 2004.

Mayor Roy declared Ordinance No. 2004-13 adopted.

Linda Steele, City Clerk

George W. Roy, Mayor

Mayor Roy introduced the following Resolution:

RESOLUTION NO. R-2003-37

BE IT RESOLVED, by the Mayor and Council of the City of Calera, Alabama as follows:

WHEREAS, George W. Roy, Mayor of the City of Calera, Alabama be authorized to request annexation into the corporate limits of the City of Calera, Alabama for the following City owned property:

Northend Waste Water Treatment Property

Existing Waste Water Treatment Property Addition

Council Member Phillips moved that unanimous consent of the Council be given for immediate action upon Resolution No. R-2003-37.

Council Member Davis seconded said motion and upon vote, the results were as follows:

AYES: Roy, Phillips, Davis, Glasgow, Jones

NAYS: None

Thereupon, the Mayor declared said motion carried and unanimous consent given for the consideration of said Resolution.

Council Member Davis moved that Resolution No. R-2003-37 be adopted. Council Member Glasgow seconded said motion and upon vote, the results were as follows:

AYES: Roy, Davis, Glasgow, Jones, Phillips

NAYS: None

Mayor Roy declared Resolution No. R-2003-37 adopted.

Adopted this 15th day of December 2003.

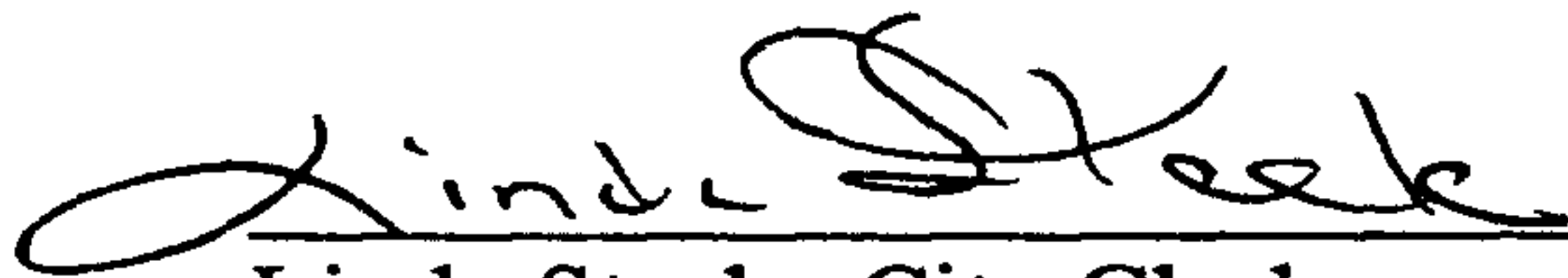
Linda Steele, City Clerk

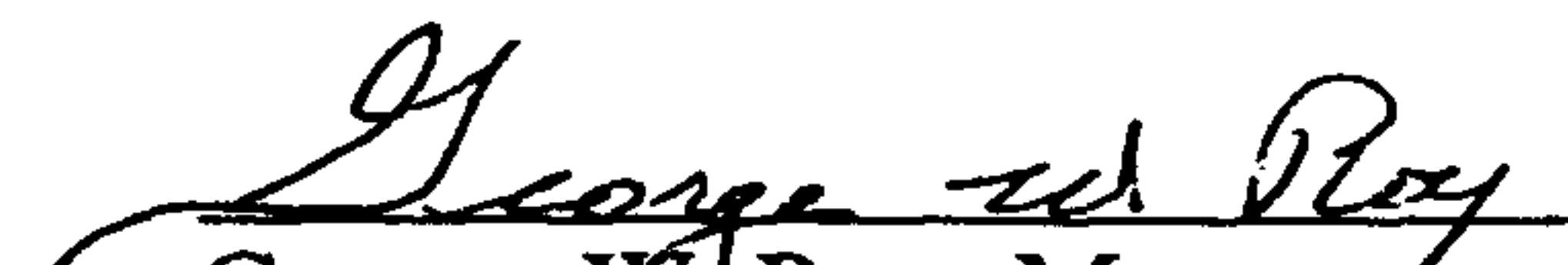
George W. Roy, Mayor

CERTIFICATION OF POSTING

I, Linda Steele, City Clerk of the City of Calera, Alabama do hereby certify that the foregoing Resolution a true and correct copy of the Resolution adopted by the City Council of the City of Calera, Alabama on the 1st day of December 2003, as the same appears in the official record of minutes of the City of Calera Council meeting.

Given under my hand this 15th day of December 2003.

Linda Steele, City Clerk

I, Linda Steele, City Clerk of the City of Calera, Alabama do hereby certify that the foregoing Resolution was duly posted at the following locations:

Calera City Hall
Calera Post Office
Calera Public Library
Associated Foods

Linda Steele, City Clerk

12/15/03
Date Posted

State of Alabama
County of Shelby

Date Filed 9-23-04

We, being the owner or owners of the following described property do hereby request annexation into the corporate limits of the City of Calera.

The property is located and contained within an area contiguous to the corporate limits of the City of Calera, Alabama, a city of more than 2000 population, and show(s) the City of Calera, Alabama that such property does not lie within the corporate limits or police jurisdiction of any other municipality than Calera, and hereby sign(s) written petition in accordance with 11-41-20 and 11-42-21, Code of Alabama 1975, as amended, requesting that such property described below be annexed to the City of Calera, Alabama. Also attached hereto is a map of the said property to be annexed showing its relationship to the corporate limits of the City of Calera, Alabama as in accordance with the provisions of the Code of Alabama as cited above.

Said property is described in the attached Exhibit A.

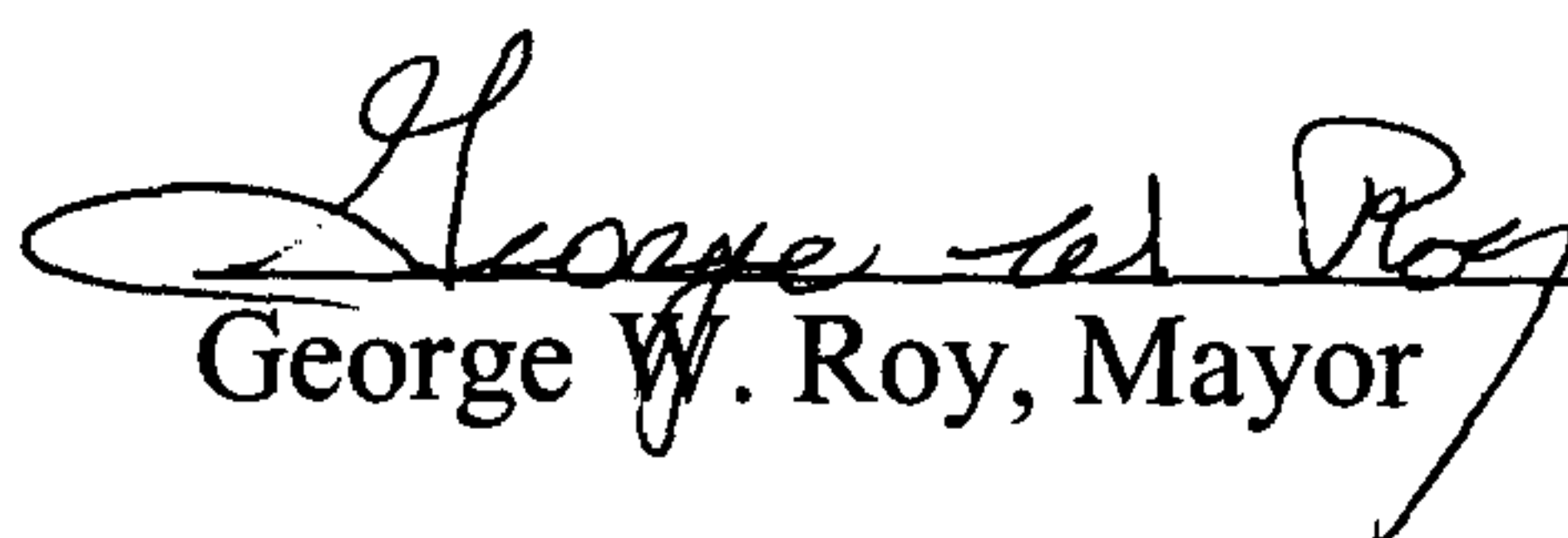
George W. Roy, Mayor

LEGAL DESCRIPTION

Exhibit A

CITY OF CALERA

Waste Water Treatment Plant Addition

A parcel of land located in the SW $\frac{1}{4}$ of the NE $\frac{1}{4}$ of Section 2, Township 24 North , Range 13 East, Shelby County, Alabama, more particularly described as follows:

Commence at the NE corner of Section 2, Township 24, Range 13 East, Shelby County, Alabama, thence run westerly along the North Section line 1889.64 feet to a point ; thence right 00 deg. 14 min. 19 sec. Westerly 629.32 feet to a point; thence left 89 deg. 15. min. 17 sec. Southerly 1613.15 feet to the point of beginning at the SW corner of the Calera Wastewater Treatment Plant; thence left 90 deg. 23 min. 43 sec. East 1300.04 feet along the south line of the plant; thence right 86 deg. 41 min. 00 sec. southerly 200.33 feet; thence right 93 deg. 19 min. 00 sec. westerly 1313.23 feet; thence right 90 deg. 26 min. 42 sec. northerly 200.00 feet to the point of beginning; being situated in Shelby County, Alabama.

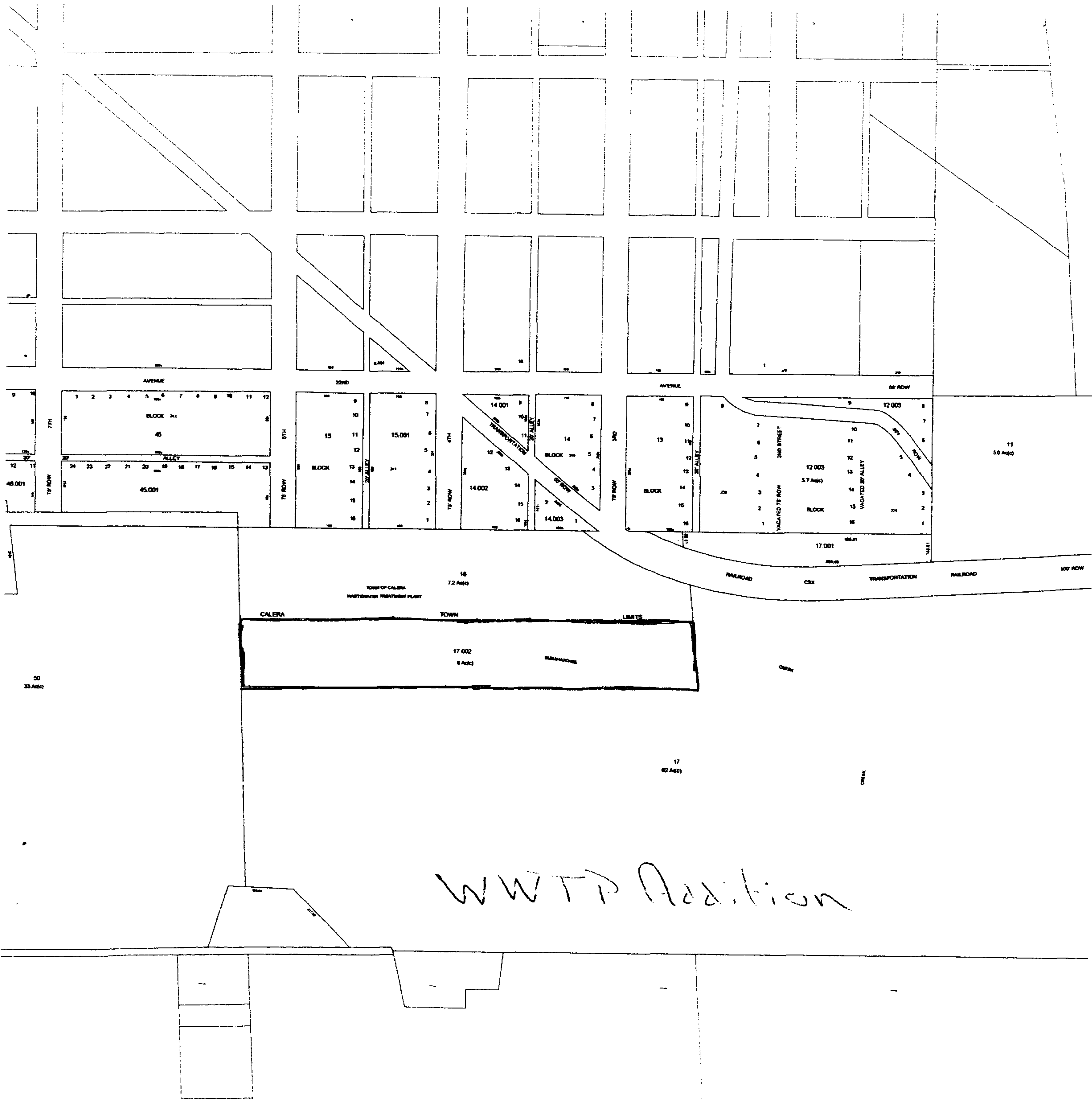

CERTIFICATION OF POSTING

I, Linda Steele, City Clerk of the City of Calera, Alabama do hereby certify that the foregoing Ordinance a true and correct copy of the Ordinance adopted by the City Council of the City of Calera, Alabama on the 2nd day of February 2004, as the same appears in the official record of minutes of the City of Calera Council meeting.

Given under my hand this 2nd day of February 2004.

Linda Steele, City Clerk

I, Linda Steele, City Clerk of the City of Calera, Alabama do hereby certify that the foregoing Ordinance was duly posted at the following locations:

Calera City Hall
Calera Post Office
Calera Public Library
Associated Foods

Linda Steele, City Clerk

02/03/04
Date Posted