

EASEMENT - DISTRIBUTION FACILITIES  
(Lot and Block)

TO BE RECORDED: YES ☒ NO ☐

20030612000367850 Pg 1/4 20.50  
Shelby Cnty Judge of Probate, AL  
06/12/2003 08:42:00 FILED/CERTIFIED  
KON

STATE OF ALABAMA }  
COUNTY OF SHELBY }  
TAX ID # \_\_\_\_\_

W.E. No. 61700-00-00143  
Parcel No. 70117211  
Transformer No. 5-10641

Alabama Power Company  
P. O. Box 2641  
Birmingham, Alabama 35291

A. GRANT KNOW ALL MEN BY THESE PRESENTS, That EDWARD STRONG & WIFE, CHRISTINE BAYLOR STRONG

as grantor(s), (the "Grantor", whether one or more) for and in consideration of One and No/100 Dollars (\$1.00), and other good and valuable consideration, to Grantor in hand paid by Alabama Power Company, a corporation, the receipt and sufficiency of which are hereby acknowledged, does hereby grant to Alabama Power Company, its successors and assigns (the "Company"), the easements, rights and privileges described and designated in Section B below.

B. RIGHTS The easements, rights and privileges granted hereby are as follows:

1. **Overhead and/or Underground.** The right from time to time to construct, install, operate and maintain, upon, over, under and across the Property described in Section C below, along a route to be selected by the Company which is generally shown on the Company's final location drawing (which shows the general location of underground Facilities, if any, by cross-hatching indicating an area not greater than ten feet (10') in width), all poles, towers, wires, conduits, fiber optics, cables, trans closures, transformers, anchors, guy wires and other Facilities useful or necessary in connection therewith (collectively, "Facilities"), for the overhead and/or underground transmission and distribution of electric power, and also the right to clear and keep clear a strip of land extending five feet (5') to either side of the center line of underground Facilities and fifteen feet (15') to either side of the center line of overhead Facilities; further, the right in the future to install and utilize intermediate poles in line for overhead Facilities and the right to trim and cut and keep trimmed and cut all dead, weak, leaning or dangerous trees or limbs outside of the thirty foot (30') strip for overhead Facilities that, in the sole opinion of the Company, might now or may hereafter endanger, interfere with or fall upon any of the overhead Facilities.

2. **Line Clearing.** The right to trim and cut and keep trimmed and cut all dead, weak, leaning or dangerous trees or limbs that, in the sole opinion of the Company, might now or may hereafter endanger, interfere with or fall upon the electric transmission or distribution lines, poles, towers or other Facilities now or hereafter located adjacent to the Property described in Section C below along a route to be selected by the Company generally shown on the Company's final location drawing, and also the right to clear and keep clear all trees, undergrowth, and other obstructions on property in which Grantor has an interest within fifteen feet (15') of the center line of the lines of such poles, towers or other Facilities.

3. **Guy Wires and Anchors.** The right to implant, install and maintain anchor(s) of concrete, metal or other material on and under the Property described in Section C below, and to construct, extend and maintain guy wires from such anchor(s) to structures now or hereafter erected adjacent to such Property or property adjacent thereto (collectively, "Guy Wire Facilities") along a route to be selected by the Company generally shown on the Company's final location drawing; and also the right to trim and cut and keep trimmed and cut all dead, weak, leaning or dangerous trees or limbs that, in the sole opinion of the Company, might now or may hereafter endanger, interfere with or fall upon any of the Guy Wire Facilities.

Grantor hereby grants to the Company all easements, rights and privileges necessary or convenient for the full enjoyment and use thereof, including without limitation the right of ingress and egress to and from the Facilities and Guy Wire Facilities, as applicable, and the right to excavate for installation, replacement, repair and removal thereof; and also the right to cut, remove and otherwise keep clear any and all structures, obstructions or obstacles of whatever character, on, under and above said Facilities and Guy Wire Facilities, as applicable.

C. **PROPERTY DESCRIPTION** The easements, rights and privileges granted hereby shall apply to, and the word "Property" as used in this instrument shall mean, the following described real property situated in SHELBY County, Alabama (the "Property"):

Lot \_\_\_\_\_ of Block \_\_\_\_\_ of \_\_\_\_\_ Subdivision as recorded in Map Book \_\_\_\_\_,  
page \_\_\_\_\_ and being located in the NE 1/4 of the SW 1/4 of Section 34, Township 20 South,  
Range 3 West and recorded in Deed Book 2002-1961, page 92 all being recorded in the Office of the Judge of Probate in said County.

D. **ADDITIONAL PROVISIONS.** In the event it becomes necessary or desirable for the Company to move any of the Facilities in connection with the construction or improvement of any public road or highway in proximity to the Facilities, Grantor hereby grants to the Company the right to relocate the Facilities and, as to such relocated Facilities, to exercise the rights granted above; provided, however, the Company shall not relocate the Facilities on the Property at a distance greater than ten feet (10') outside the boundary of the right of way of any such public road or highway as established or re-established from time to time. This grant and agreement shall be binding upon and shall inure to the benefit of Grantor, the Company and each of their respective heirs, personal representatives, successors and assigns and the words "Company" and "Grantor" as used in this instrument shall be deemed to include the heirs, personal representatives, successors and assigns of such parties.

TO HAVE AND TO HOLD the same to the Company, its successors and assigns, forever.

IN WITNESS WHEREOF, the undersigned Grantor(s) has/have set his/her/their hand(s) and seal(s) this the 12<sup>th</sup> day of DECEMBER, 2022

Paul P. Bennett  
Witness

Barbara A. Freeman  
Witness

\_\_\_\_\_  
Witness

Edward Strong (SEAL)  
(Grantor)

Christine Baylor/Strong (SEAL)  
(Grantor)

By: \_\_\_\_\_ (SEAL)  
As:

IN WITNESS WHEREOF, the said Grantor, has caused this instrument to be executed by \_\_\_\_\_,  
its authorized representative, as of the \_\_\_\_\_ day of \_\_\_\_\_, 20\_\_\_\_\_.

ATTEST (if corporation) or WITNESS:

By: \_\_\_\_\_  
Its: \_\_\_\_\_  
  
By: \_\_\_\_\_ (SEAL)  
Its: \_\_\_\_\_  
[indicate President, General Partner, Member, etc.]

INDIVIDUAL NOTARIES

STATE OF ALABAMA }  
COUNTY OF \_\_\_\_\_ }

I, the undersigned, a Notary Public, in and for said County in said State, hereby certify that \_\_\_\_\_  
\_\_\_\_\_ whose name(s) is/are signed to the foregoing instrument and who is/are known to me, acknowledged before me  
on this day that being informed of the contents of the instrument, he/she/they executed the same voluntarily, on the day the same bears date.  
Given under my hand and official seal this the \_\_\_\_\_ day of \_\_\_\_\_, \_\_\_\_\_.

[SEAL] Notary Public  
My commission expires: \_\_\_\_\_

STATE OF ALABAMA }  
COUNTY OF \_\_\_\_\_ }

I, the undersigned, a Notary Public, in and for said County in said State, hereby certify that \_\_\_\_\_  
\_\_\_\_\_ whose name(s) is/are signed to the foregoing instrument and who is/are known to me, acknowledged before me  
on this day that being informed of the contents of the instrument, he/she/they executed the same voluntarily, on the day the same bears date.  
Given under my hand and official seal this the \_\_\_\_\_ day of \_\_\_\_\_, \_\_\_\_\_.

[SEAL] Notary Public  
My commission expires: \_\_\_\_\_

TRUSTEE/CORPORATION/PARTNERSHIP/LLC NOTARY

STATE OF ALABAMA }  
COUNTY OF \_\_\_\_\_ }

I, the undersigned, a Notary Public, in and for said County in said State, hereby certify that \_\_\_\_\_  
\_\_\_\_\_, whose name as \_\_\_\_\_ of \_\_\_\_\_  
\_\_\_\_\_ a \_\_\_\_\_ [as \_\_\_\_\_  
\_\_\_\_\_] is signed to the foregoing instrument, and who is known to me, acknowledged before me on this day that  
being informed of the contents of the instrument, he/she, as such \_\_\_\_\_ and with full authority, executed the same voluntarily for and as  
the act of said \_\_\_\_\_ [acting in such capacity as aforesaid].  
Given under my hand and official seal, this the \_\_\_\_\_ day of \_\_\_\_\_, \_\_\_\_\_.

[SEAL] Notary Public  
My commission expires: \_\_\_\_\_

For Alabama Power Company Corporate Real Estate Department Use Only

All facilities on Grantor: \_\_\_\_\_ Station to Station: STA 2+00 To STA 1+100  
ALSO: GUY AT STA 1+00



# SKETCH OF PROPOSED WORK — SIMPLIFIED W. E.

Customer <b>EDWARD STRONG</b>		Location <b>INDEPENDENCE DR</b>		Agreed Serv. Date		Estimate No. <b>61700-00-0014-3</b>	
Division <b>B'HAM</b>		District <b>SO REGION</b>		Town <b>ALABASTER</b>		Date <b>12-10-02</b>	
County <b>SHELBY</b>	Section <b>34</b>	Township <b>20S</b>	Range <b>3W</b>	Add'l Info			
Acquisition Agent <b>DON BAILEY</b>	Date R/W Assigned <b>12-12-2002</b>	Date R/W Cleared <b>12-12-2002</b>	Map Reference		LOC	Transformer Loading	

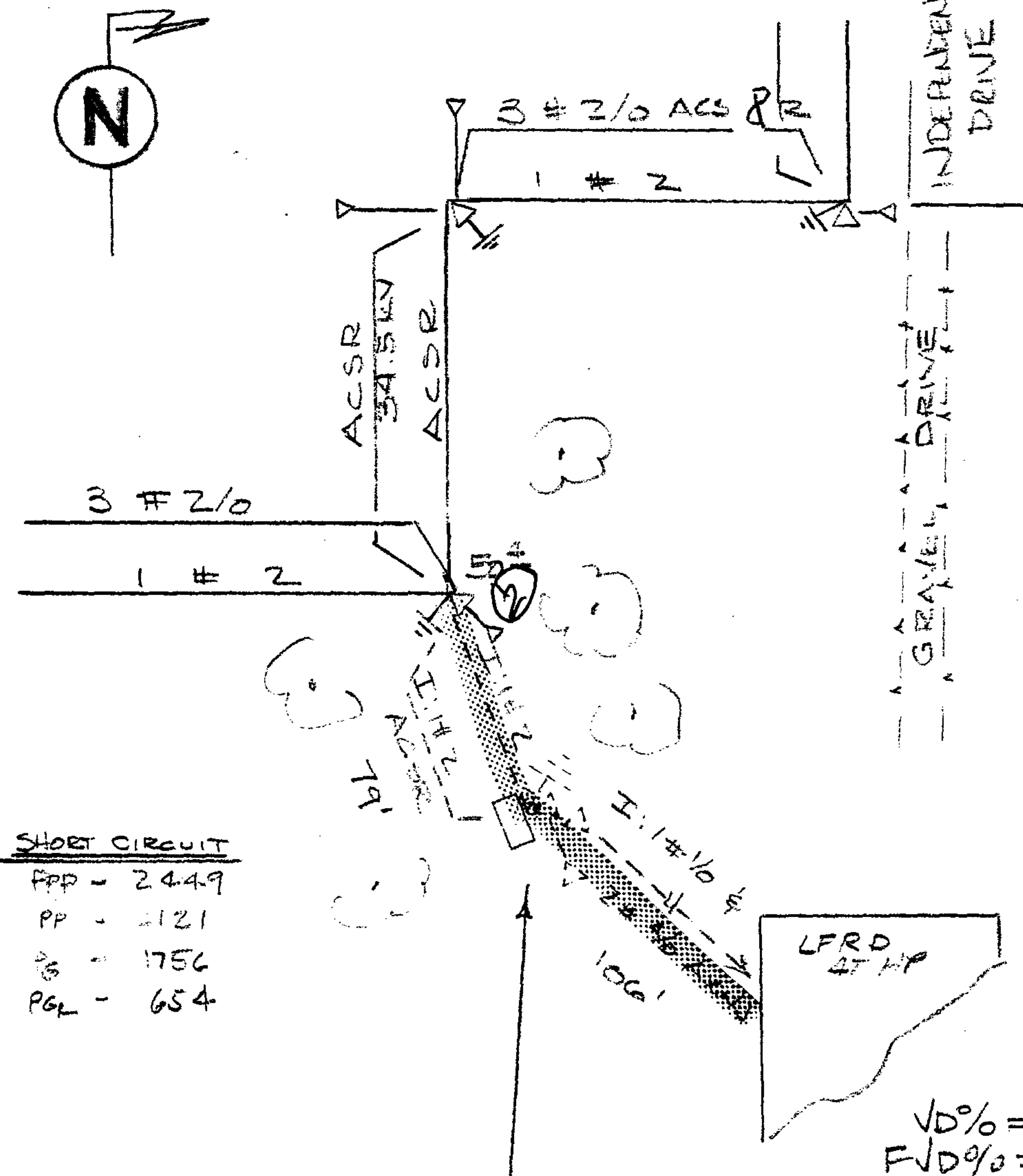

## SHORT CIRCUIT

FPP - 2449  
PP - 2121  
S - 1756  
PGL - 654

APCO TO I: 40<sup>5</sup> PBLE  
FOR BELL SO.  
I: PRI NEUT. 16 DE  
I: 25 KVA TMR.  
PROP LD = 19.1 KVA  
I: 8" H 5/8" R 5/16" SE.

**UNDERGROUND  
RIGHT OF WAY  
WIDTH IS 10 FEET**

$V_D\% = .8$   
 $FVD\% = 1.4$

NOTES:  
1) BELL SO. to PAY  
APCO \$374.00  
TO FURNISH, HAUL &  
SET POLE - ON  
JASPER PLAN

2) CUSTOMER  
TO PAY  
APCO \$362.00  
FOR UG SERVICE

3) CUSTOMER TO  
TRIM R.O.W.  
FOR APCO.

MISS ALL:  
332024

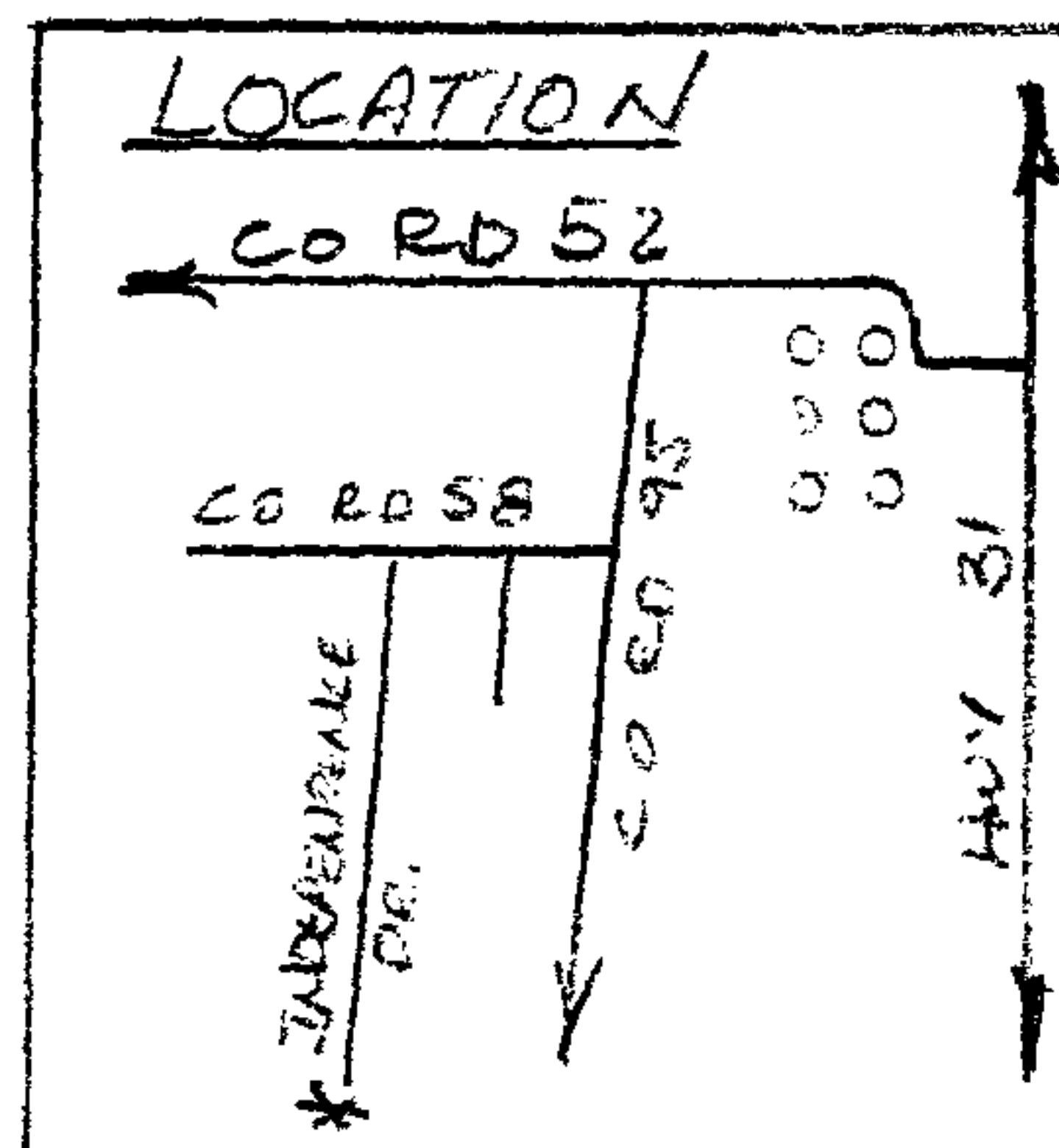

Voltage	
Pri	Sec.
PHONE CO.	
Co. Name	
CATV CO.	
Co. Name	
ACCESSIBLE	
TREE CREW	
ROCK HOLE	
PERMITS REQ'D	
R/W	
CITY	
COUNTY	
STATE	
MISSALL #	
OTHER	
SCALE	
Ft. Per Inch	

Cnst. Completed By

Date

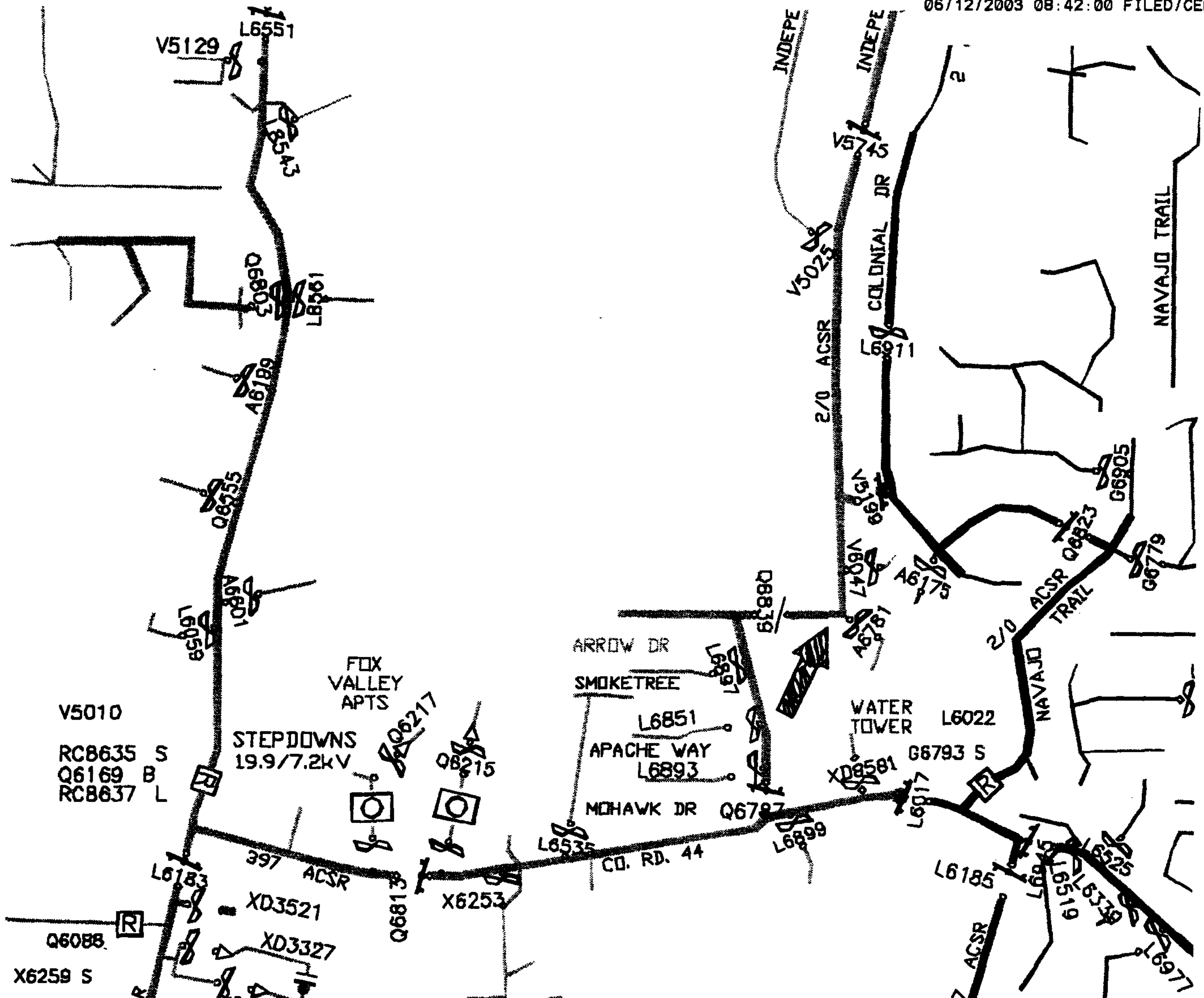

## HOTLINE INFORMATION

SUB: ELLIOTSVILLE

FDR #: 4

BREAKER #: 48476

PROTECTING SW \_\_\_\_\_

**FUSE SIZE:**.....

**BLUE PLATE?**\_\_\_\_\_

LOC. NO.(S) \_\_\_\_\_

Form 5-4790 4/82