



AN EASEMENT
 FOR THE CONSTRUCTION, OPERATION, AND MAINTENANCE
 OF A SANITARY SEWER MAIN BY THE CITY OF CALERA

This EASEMENT, executed this 5 day of APRIL, 2003, for the construction, operation, and maintenance of a sanitary sewer main with appurtenances, by The City of Calera, hereinafter called the OWNER across the property of the LANDOWNER, Karsons International, Inc., as shown on the attached sketch, is granted by the LANDOWNER to the OWNER for valuable considerations, the receipt and sufficiency of which are acknowledged by the LANDOWNER, for himself, and his heirs, executors, successors, and assigns.

One permanent easement, to go with the land to allow the OWNER, its employees and agents to construct, operate, repair, and maintain the OWNER'S sanitary sewer main including the right of access by the OWNER, its employees and agents, or officials, and necessary related equipment. Included is the right to uncover the sanitary sewer main, with the obligation to leave the LANDOWNER'S property in good repair after completion of any repair to the sanitary sewer main.

The easement is described as follows:

Located in the City of Calera, Shelby County, Alabama a easement lying 40 feet North of the centerline of Shelby County Highway No. 304 or 29 feet North of the edge of pavement of Shelby County Highway No. 304.

Executed the date shown above in four copies.

LANDOWNER:

By: [Signature]
 Representative of Karsons International, Inc.

WITNESS:

By: [Signature]

For The City of Calera

By: [Signature]
 George W. Roy, Mayor

WITNESS:

By: [Signature]
 Linda Steele, City Clerk

Recorded the _____ day of _____, 20____ in Deed Book
 _____ Page _____, of public records of Shelby County, Alabama.

City of Calera

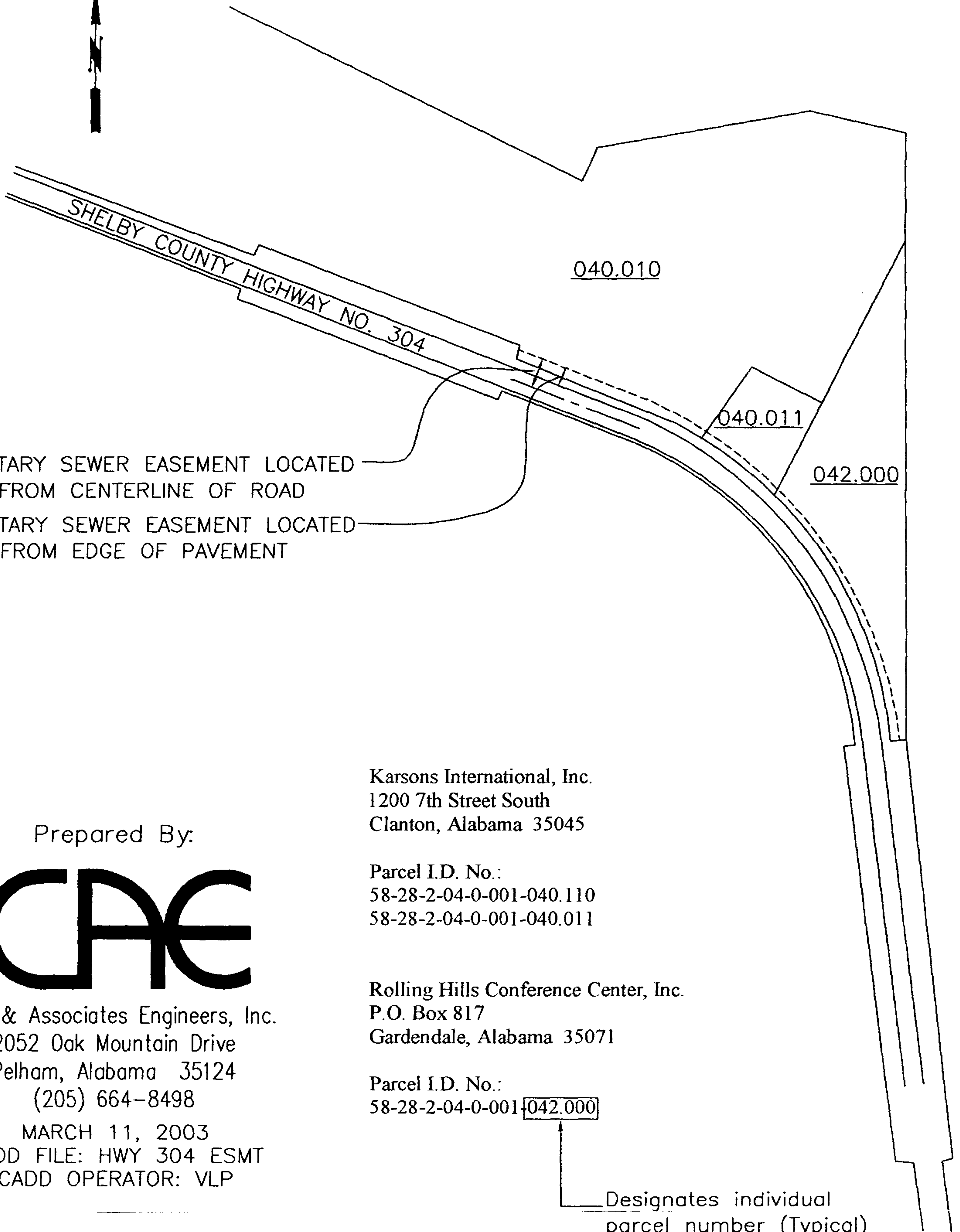

SANITARY SEWER EASEMENT LOCATED
40' FROM CENTERLINE OF ROAD

SANITARY SEWER EASEMENT LOCATED
29' FROM EDGE OF PAVEMENT

Prepared By:



Carr & Associates Engineers, Inc.
2052 Oak Mountain Drive
Pelham, Alabama 35124
(205) 664-8498

MARCH 11, 2003
CADD FILE: HWY 304 ESMT
CADD OPERATOR: VLP

Karsons International, Inc.
1200 7th Street South
Clanton, Alabama 35045

Parcel I.D. No.:
58-28-2-04-0-001-040.110
58-28-2-04-0-001-040.011

Rolling Hills Conference Center, Inc.
P.O. Box 817
Gardendale, Alabama 35071

Parcel I.D. No.:
58-28-2-04-0-001-042.000

Designates individual
parcel number (Typical)

020117

AN EASEMENT
FOR THE CONSTRUCTION, OPERATION, AND MAINTENANCE
OF A SANITARY SEWER MAIN BY THE CITY OF CALERA

This EASEMENT, executed this _____ day of _____, 20____, for the construction, operation, and maintenance of a sanitary sewer main with appurtenances, by The City of Calera, hereinafter called the OWNER across the property of the LANDOWNER, Karsons International, Inc., as shown on the attached sketch, is granted by the LANDOWNER to the OWNER for valuable considerations, the receipt and sufficiency of which are acknowledged by the LANDOWNER, for himself, and his heirs, executors, successors, and assigns.

One permanent easement, to go with the land to allow the OWNER, its employees and agents to construct, operate, repair, and maintain the OWNER'S sanitary sewer main including the right of access by the OWNER, its employees and agents, or officials, and necessary related equipment. Included is the right to uncover the sanitary sewer main, with the obligation to leave the LANDOWNER'S property in good repair after completion of any repair to the sanitary sewer main.

The easement is described as follows:

Located in the City of Calera, Shelby County, Alabama a easement lying 40 feet North of the centerline of Shelby County Highway No. 304 or 29 feet North of the edge of pavement of Shelby County Highway No. 304.

Executed the date shown above in four copies.

LANDOWNER:

WITNESS:

By: _____
Representative of Karsons International, Inc.

By: _____

For The City of Calera

WITNESS:

By: George W. Roy
George W. Roy, Mayor

By: Linda Steele
Linda Steele, City Clerk

Recorded the _____ day of _____, 20____ in Deed Book
_____ Page _____ of public records of Shelby County, Alabama.

20030409000217190 Pg 5/5 20.00
Shelby Cnty Judge of Probate, AL
04/09/2003 14:57:00 FILED/CERTIFIED

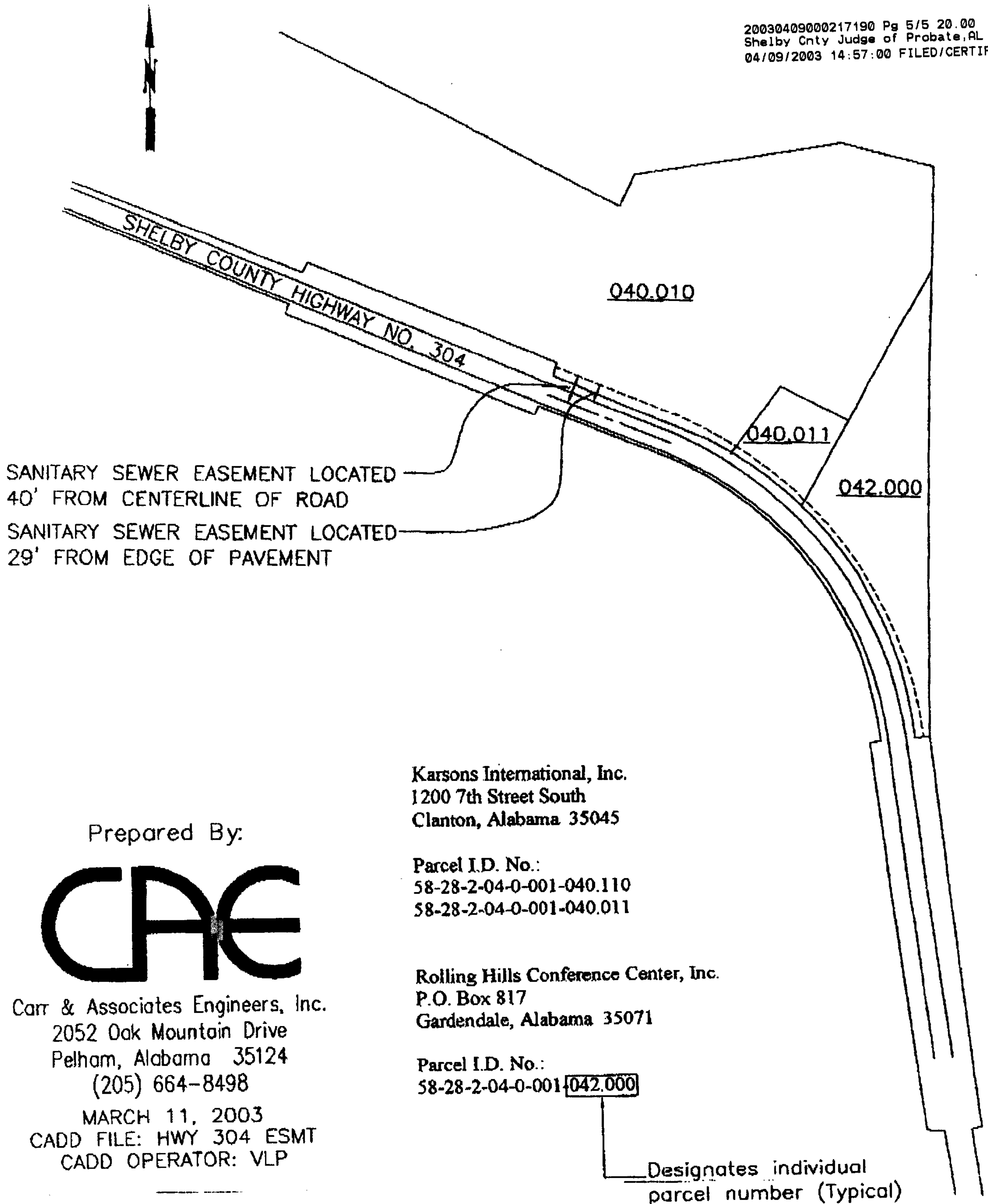

SANITARY SEWER EASEMENT LOCATED
40' FROM CENTERLINE OF ROAD

SANITARY SEWER EASEMENT LOCATED
29' FROM EDGE OF PAVEMENT

Prepared By:



Carr & Associates Engineers, Inc.
2052 Oak Mountain Drive
Pelham, Alabama 35124
(205) 664-8498

MARCH 11, 2003
CADD FILE: HWY 304 ESMT
CADD OPERATOR: VLP

Karsons International, Inc.
1200 7th Street South
Clanton, Alabama 35045

Parcel I.D. No.:
58-28-2-04-0-001-040.110
58-28-2-04-0-001-040.011

Rolling Hills Conference Center, Inc.
P.O. Box 817
Gardendale, Alabama 35071

Parcel I.D. No.:
58-28-2-04-0-001-042.000

Designates individual
parcel number (Typical)