

ORDINANCE NUMBER 615-03A

AN ORDINANCE TO ALTER, REARRANGE AND EXTEND THE CORPORATE LIMITS OF THE CITY OF HELENA, ALABAMA, SO AS TO EMBRACE AND INCLUDE WITHIN THE CORPORATE AREA OF SAID CITY ALL TERRITORY NOW WITHIN SUCH CORPORATE LIMITS AND ALSO CERTAIN OTHER TERRITORY CONTIGUOUS TO SAID CITY.

WHEREAS, a petition signed by the owners of all of the land within the territory therein described and proposed to be annexed to the City, together with a map of said territory showing its relationship to the corporate limits of the City, has been filed with the City Clerk of the City of Helena; and

WHEREAS, this Council has determined and found that the matters set forth and alleged in said petition are true, and that it is in the public interest that said property be annexed to the City of Helena;

NOW, THEREFORE, BE IT ORDAINED by the Council of the City of Helena as follows:

Section 1. That said Council and the City of Helena hereby assent to the annexation of said territory to the City of Helena, Alabama, the corporate limits of the City to be extended and rearranged pursuant to the provisions of Chapter 42, Article 2, Code of Alabama 1975 (Sections 11-42-20 through 11-42-23, as amended) so as to embrace and include said territory in addition to the territory already within its present corporate limits, within the corporate area of said City, which said territory is not within the corporate limits of another municipality and the new boundary line does not lie at any point more than half the distance between the old city boundary and the corporate boundary of any municipality. Said territory is described as follows:

Property located in Section 32, Township 20 South, Range 3 West, Shelby County, Alabama.

The remaining West 75 feet of the East 300 feet of the SE $\frac{1}{4}$ of the NW $\frac{1}{4}$ of Section 32. The remaining West 37.5 feet of the East 150 feet of the NW $\frac{1}{4}$ of the SW $\frac{1}{4}$ of Section 32.

This annexation shall comply with the State $\frac{1}{2}$ rule per Section 11-42-21, Code of Alabama 1975, as amended

Section 2. That the City Clerk shall file a certified copy of this ordinance containing an accurate description of said annexed territory with the Probate Judge of Shelby County, Alabama, and also cause a copy of this ordinance to be posted in three (3) public places in the City of Helena and this ordinance to be sent to the Justice Department for their approval.

CERTIFICATION

I, Peggy C. Dunaway, the duly appointed and acting Clerk of the City of Helena, Alabama, do hereby certify that the within Ordinance Number **615-03A** is a true copy as recited in the said City Clerk's Minute Book and posted by me as provided by law in three public places in said City, being on the bulletin board of the City Hall, in the United States Post Office in the City of Helena, and in the Helena Public Library in said City, that said Ordinance shall become a duly lawful Ordinance of said City on the 27 day of January, 2003, five or more days after the posting of the same as provided by law.

IN WITNESS WHEREOF, I have hereunto set my hand and seal on this the 21 day of January, 2003.

[SEAL]



Peggy C. Dunaway, City Clerk

**STATE OF ALABAMA
SHELBY COUNTY**

I, Peggy C. Dunaway, City Clerk of the City of Helena, do hereby certify that the above is a true correct copy of an ordinance duly adopted by the Council of the City of Helena at its meeting held January 21 2003, and as same appears of record in the ordinance records of said City, and approved by the Mayor on January 21, 2003.

Given under my hand and corporate seal of the City of Helena, this the 21 day of January, 2003.

[SEAL]

Peggy C. Dunaway, City Clerk

COUNTY OF SHELBY

PREPARED UNDER THE DIRECTION
OF THE
STATE OF ALABAMA
DEPARTMENT OF REVENUE
AD VALOREM TAX DIVISION

CONSULTING BY
INTERGRAPH CORPORATION
HUNTSVILLE, ALABAMA

PRODUCED BY
SHELBY COUNTY MAPPING DEPT



SCALE 1" = 400'

DATE OF PHOTOGRAPHY: MARCH 1974
DATE OF REVISION: MARCH 1993
DATE OF MAP: FEB 1 1979
DATE OF CIVIL COMPLETION: AVE 28 1934
DATE MAP REVISED: 32
MAP REVISED BY: SE



COUNTY LOCATOR

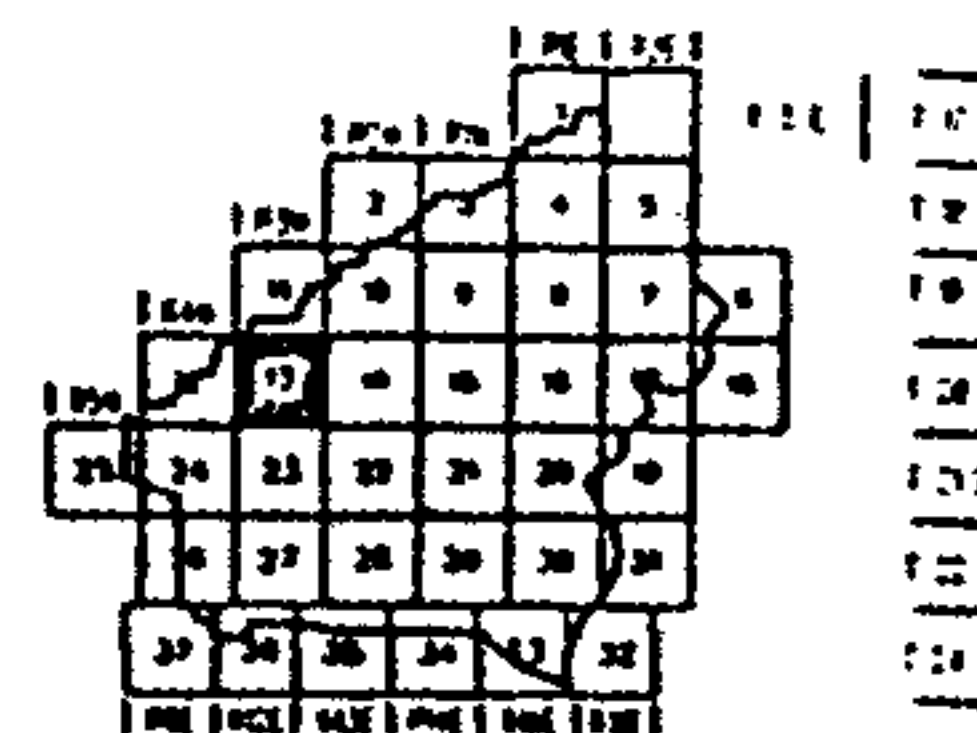

TOWNSHIP LOCATOR

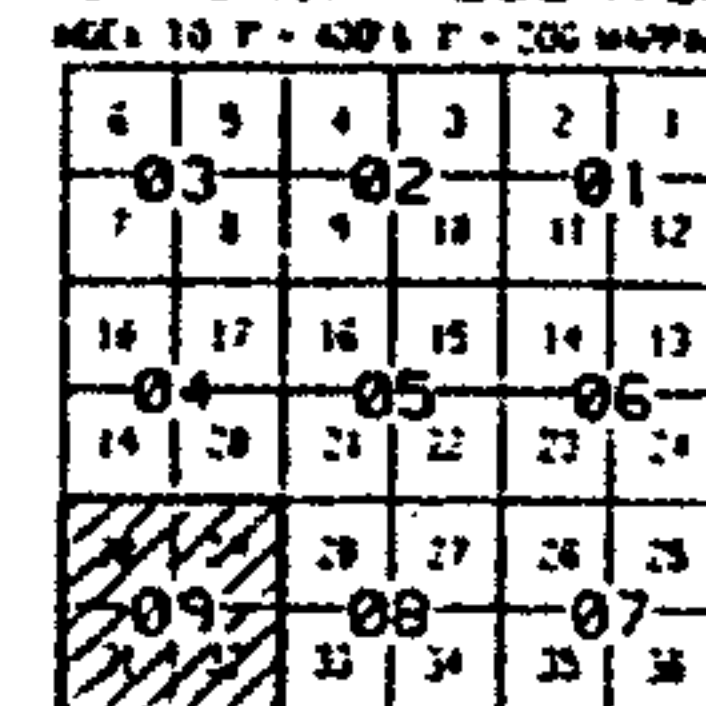

SUB-SHEET INDEX

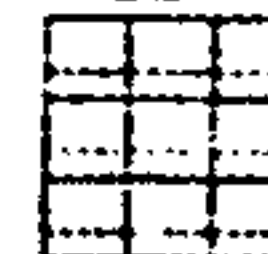

LEGEND

STATE LINE	---	AREA (FROM DEED)	10.5 AC
COUNTY LINE	---	AREA (CALCULATED)	10.5 AC(±)
CITY LIMIT LINE	---	DIMENSION (FROM DEED)	36
TOWNSHIP LINE	---	DIMENSION (SCALED)	1/2
SECTION LINE	---	INTERSTATE HIGHWAY	15
PROPERTY LINE	---	U.S. HIGHWAY	20
ROAD R/W	---	STATE HIGHWAY	15
ROAD TRAVEL PATH	---	COUNTY HIGHWAY	15
PRIVATE ROAD OR TRAIL	---	COUNTY HIGHWAY	15
RAILROAD R/W	---	ROADS OF STREETS BY NAME	15
WATER	---	PARCEL NUMBER	15.001
LANDHOOK	---	SUB LOT NUMBER	29
ORIGINAL SUB LOT LINE	---	MAP BLOCK NUMBER	2
MAJOR TRANSMISSION LINES	---	MAP BLOCK LIMIT	15.001
CONFLICT	---	MAP BLOCK WITH	15.001
		MAP BLOCK NUMBER	1
CITY LIMIT CODE	②	SECTION CORNERS	2 1
CHURCHES, SCHOOLS, CEM., AIRPORTS, GOVT. LAND, ETC.	BY NAME		11 12
		STATE PLANS	
		COORDINATED	

1	2	3	4	5	6	7	8	9	10	11	12
13	14	15	16	17	18	19	20	21	22	23	24
25	26	27	28	29	30	31	32	33	34	35	36

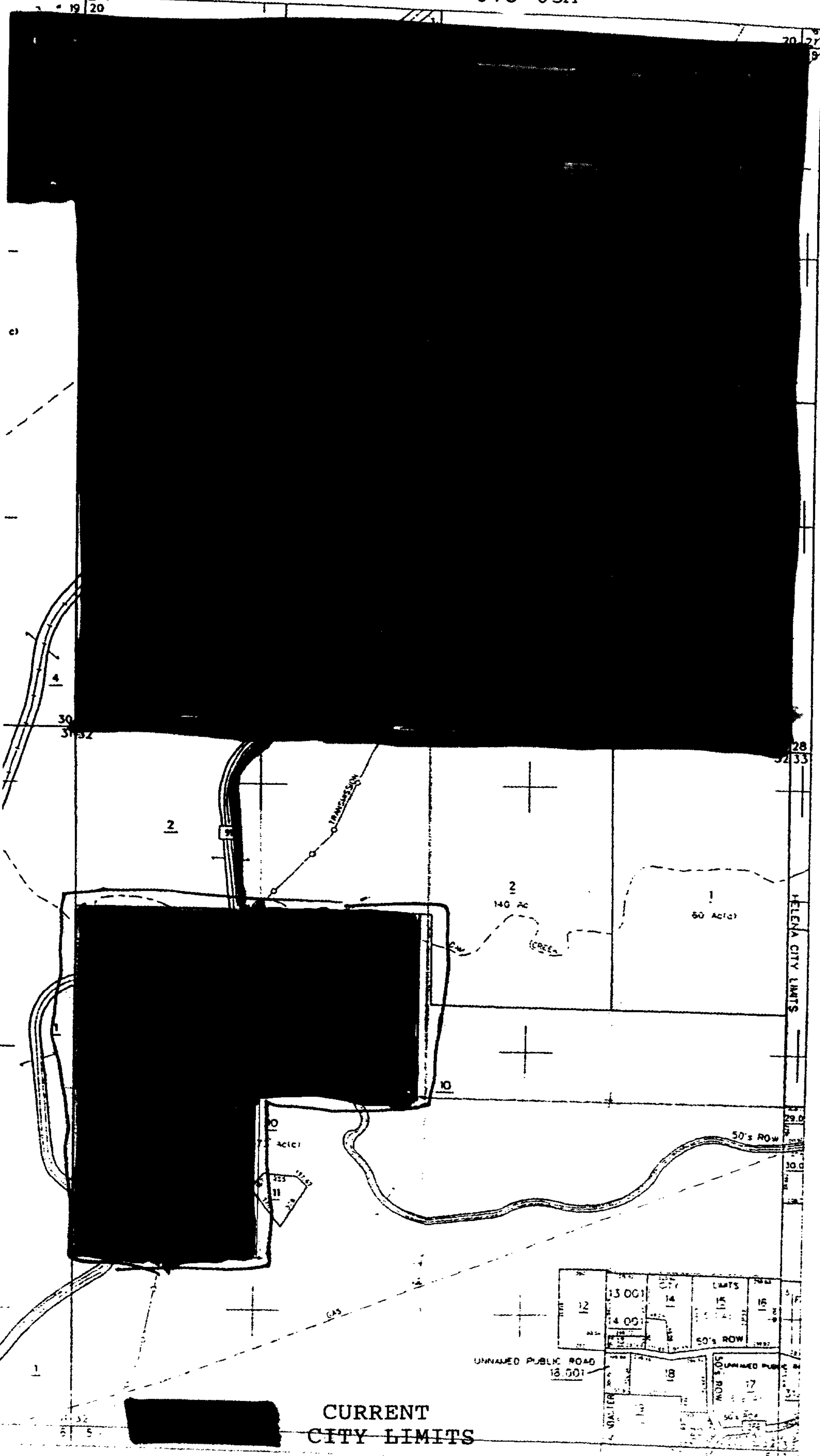

PROPOSED ANNEXATION