



IN WITNESS WHEREOF, the said Grantor, has caused this instrument to be executed by \_\_\_\_\_,  
its authorized representative, as of the \_\_\_\_\_ day of \_\_\_\_\_, 20\_\_\_\_\_.

ATTEST (if corporation) or WITNESS: \_\_\_\_\_  
(Grantor - Name of Corporation/Partnership/LLC)  
By: \_\_\_\_\_ (SEAL)  
Its: \_\_\_\_\_  
[indicate President, General Partner, Member, etc.]

INDIVIDUAL NOTARIES

STATE OF ALABAMA }  
COUNTY OF Shelby }

I, the undersigned, a Notary Public, in and for said County in said State, hereby certify that LYNN MONAGHAN-CURREN  
whose name(s) is/are signed to the foregoing instrument and who is/are known to me, acknowledged before me  
on this day that being informed of the contents of the instrument, he/she/they executed the same voluntarily, on the day the same bears date.  
Given under my hand and official seal this the 27 day of July, 2002.

[SEAL]

Lynn Monaghan-Curren  
Notary Public  
My commission expires: My Commission Expires 4-24-06

STATE OF ALABAMA }  
COUNTY OF Shelby }

I, the undersigned, a Notary Public, in and for said County in said State, hereby certify that Rickey Curren  
whose name(s) is/are signed to the foregoing instrument and who is/are known to me, acknowledged before me  
on this day that being informed of the contents of the instrument, he/she/they executed the same voluntarily, on the day the same bears date.  
Given under my hand and official seal this the 27 day of July, 2002.

[SEAL]

Lynn Monaghan-Curren  
Notary Public  
My commission expires: My Commission Expires 4-24-06

TRUSTEE/CORPORATION/PARTNERSHIP/LLC NOTARY

STATE OF ALABAMA }  
COUNTY OF \_\_\_\_\_ }

I, the undersigned, a Notary Public, in and for said County in said State, hereby certify that \_\_\_\_\_  
whose name as \_\_\_\_\_ of \_\_\_\_\_  
a \_\_\_\_\_ [as \_\_\_\_\_]  
], is signed to the foregoing instrument, and who is known to me, acknowledged before me on this day  
that being informed of the contents of the instrument, he/she, as such \_\_\_\_\_ and with full authority, executed the same voluntarily for and  
as the act of said \_\_\_\_\_ [acting in such capacity as aforesaid].  
Given under my hand and official seal, this the \_\_\_\_\_ day of \_\_\_\_\_.

[SEAL]

Notary Public  
My commission expires: \_\_\_\_\_

For Alabama Power Company Corporate Real Estate Department Use Only

All facilities on Grantor: \_\_\_\_\_

Station to Station: Sta# 1 + 75 to Sta# 1 + 225 (U45)



# SKETCH OF PROPOSED WORK — SIMPLIFIED W. E.

20020926000463690 Pg 3/3 18.00  
 Shelby Cnty Judge of Probate, AL  
 09/26/2002 09:44:00 FILED/CERTIFIED



Customer <b>Ricky Curren</b>		Location <b>9579 Hwy 51</b>		Agreed Serv. Date <b>61200-00-03432</b>	
Division <b>POWER DELIVERY</b>		District <b>B'ham - South</b>		Town <b>WESTOVER</b>	
County <b>Shelby</b>		Section <b>21</b>		Township <b>19S</b>	
Acquisition Agent <b>J.P.S.</b>		Date R/W Assigned <b>7-12-02</b>		Date R/W Cleared <b>8-6-02</b>	
Range <b>1 E</b>		Add'l Info <b>678-9766 — 913-9766</b>		Map Reference	
				LOC	Transformer Loading

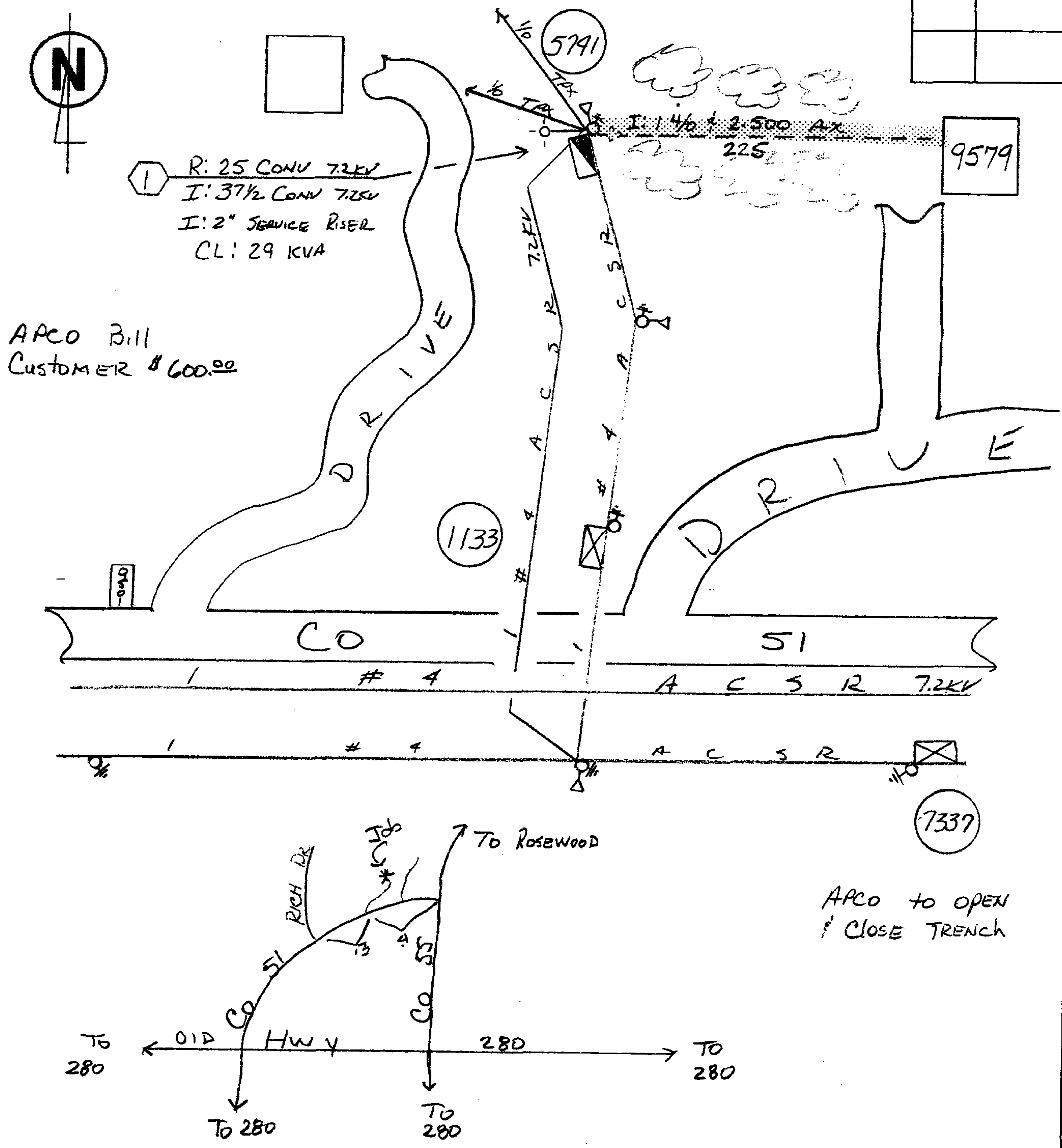

Voltage	
Pri	Sec.
PHONE CO.	
Co. Name	
CATV CO.	
Co. Name	
ACCESSIBLE	
TREE CREW	
ROCK HOLE	
PERMITS REQ'D	
R/W	
CITY	
COUNTY	
STATE	
MISSALL #	
OTHER	
SCALE	
Ft. Per Inch	

Cnst. Completed By	Date
--------------------	------