

# EASEMENT - DISTRIBUTION FACILITIES

TO BE RECORDED

YES NO

This Instrument prepared by:

DON D. BAILEY

STATE OF ALABAMA

County of SHELBY

TAX ID # 13-B-34-3-002-029.030

W.E. 61700-00-04350

Parcel # 70091747

Transformer # 5-2694

Alabama Power Company  
Post Office Box 2641  
Birmingham, Alabama 35291-1980

A. GRANT KNOW ALL MEN BY THESE PRESENTS, That JAMES N. CARROLL, A MARRIED MAN  
IS SOLE OWNER

as grantor(s), (the "Grantor", whether one or more) for and in consideration of the sum of One and No/100 (\$1.00), and other good and valuable considerations, to Grantor in hand paid by Alabama Power Company (the Company), a corporation, the receipt and sufficiency of which is hereby acknowledged, does hereby grant to Alabama Power Company, (the Company) its successors and assigns, the easements, rights and privileges described and designated in Section B below.

B. RIGHTS The easements, rights and privileges granted hereby are as follows:

1. **Overhead and/or Underground.** The right from time to time to construct, install, operate and maintain, upon, over, under and across the Property described in Section C below, along a route to be selected by the Company which is generally shown on the Company's final location drawing (which shows the general location of underground Facilities, if any, by cross-hatching indicating an area not greater than ten feet (10') in width), all poles, towers, wires, conduits, fiber optics, cables, translosures, transformers, anchors, guy wires and other Facilities useful or necessary in connection therewith (collectively, "Facilities"), for the overhead and/or underground transmission and distribution of electric power, and also the right to clear and keep clear a strip of land extending five feet (5') to either side of the center line of underground Facilities and fifteen feet (15') to either side of the center line of overhead Facilities; further, the right in the future to install and utilize intermediate poles in line for overhead Facilities and the right to trim and cut and keep trimmed and cut all dead, weak, leaning or dangerous trees or limbs outside of the thirty foot (30') strip for overhead Facilities that, in the sole opinion of the Company, might now or may hereafter endanger, interfere with or fall upon any of the overhead Facilities.

2. **Line Clearing.** The right to trim and cut and keep trimmed and cut all dead, weak, leaning or dangerous trees or limbs that, in the sole opinion of the Company, might now or may hereafter endanger, interfere with or fall upon the electric transmission or distribution lines, poles, towers or other Facilities now or hereafter located adjacent to the Property described in Section C below along a route to be selected by the Company generally shown on the Company's final location drawing, and also the right to clear and keep clear all trees, undergrowth, and other obstructions on property in which Grantor has an interest within fifteen feet (15') of the center line of the lines of such poles, towers or other Facilities.

3. **Guy Wires and Anchors.** The right to implant, install and maintain anchor(s) of concrete, metal or other material on and under the Property described in Section C below, and to construct, extend and maintain guy wires from such anchor(s) to structures now or hereafter erected adjacent to such Property or property adjacent thereto (collectively, "Guy Wire Facilities") along a route to be selected by the Company generally shown on the Company's final location drawing; and also the right to trim and cut and keep trimmed and cut all dead, weak, leaning or dangerous trees or limbs that, in the sole opinion of the Company, might now or may hereafter endanger, interfere with or fall upon any of the Guy Wire Facilities.

Grantor hereby grants to the Company all easements, right and privileges necessary or convenient for the full enjoyment and use thereof, including without limitations the right of ingress and egress to and from the Company's Facilities and Guy Wire Facilities, as applicable, and the right to excavate for installation, replacement, repair and removal thereof; and also the right to cut, remove and otherwise keep clear any and all structures, obstructions or obstacles of whatever character, on under and above said Facilities and Guy Wire Facilities, as applicable.

C. **PROPERTY DESCRIPTION.** The easement, rights and privileges granted hereby shall apply to, and the word "Property" as used in the instrument shall mean, the following described real property situated in SHELBY County, Alabama (the "Property"):

Lot 43 of Block - of NORWICK FOREST 34 SECTOR Subdivision

as recorded in Map Book 23, page 121 and being located in the SE 1/4 of the SW 1/4 of

Section 34, Township 20S, Range 3W and recorded in Deed Book 1346 page 254

all being recorded in the Office of the Judge of Probate in said County.

D. **ADDITIONAL PROVISIONS.** In the event it becomes necessary or desirable for the Company to move any of its Facilities in connection with the construction or improvement of any public road or highway in proximity to its Facilities, Grantor hereby grants to the Company the right to relocate its Facilities and, as to such relocated Facilities, to exercise the rights granted above; provided, however, the Company shall relocate its Facilities at a distance no greater than ten (10) feet outside the boundary of the right of way of any public road or highway as established or re-established from time to time. This grant and agreement shall be binding upon and inure to the benefit of Grantor, the Company and each or their respective heirs, personal representatives, successors and assigns and the words "Company" and "Grantor" as used in this instrument shall be deemed to include the heirs, personal representatives, successors and assigns of such parties.

TO HAVE AND TO HOLD the foregoing easements, rights and privileges to the Company, its successors and assigns, forever.

IN WITNESS WHEREOF, the undersigned Grantor(s) has/have set his/her/their hand(s) and seal(s) this the 9 day of August, 20 20.

WITNESSES:

GRANTOR(S)

Daphne L. Howard

James N. Carroll  
(Husband)

(Seal)

(Seal)

02/06/2002-06385

10:30 AM CERTIFIED  
SHELBY COUNTY JUDGE OF PROBATE

20 50 - 004-mgr 20.50

58370-2002 Inst # 1541

IN WITNESS WHEREOF, the said Grantor, has caused this instrument to be executed \_\_\_\_\_, its authorized representative, as of \_\_\_\_\_ day of \_\_\_\_\_, 20\_\_\_\_\_.

GRANTOR

\_\_\_\_\_  
(Name of Corporation/Partnership)

ATTEST:

\_\_\_\_\_  
(Witness/Secretary)

\_\_\_\_\_  
(Signature of Officer/Partner)

\_\_\_\_\_  
(Indicate title of Officer or Partner)

**INDIVIDUALS NOTARY**

STATE OF ALABAMA }

County of \_\_\_\_\_ }

I, the undersigned, a Notary Public, in and for said County in said State, hereby certify that \_\_\_\_\_ whose names is/are signed to the foregoing instrument and is/are known to me, acknowledged before me on this day that being informed of the contents of the instrument, he/she/they executed the same voluntarily on the day the same bears date.

Given under my hand and official seal, this the \_\_\_\_\_ day of \_\_\_\_\_, 20\_\_\_\_\_.

\_\_\_\_\_  
Notary Public

My commission expires \_\_\_\_\_.

**CORPORATION/PARTNERSHIP/LLC'S NOTARY**

STATE OF ALABAMA }

County of \_\_\_\_\_ }

I, the undersigned, a Notary Public, in and for said County in said State, hereby certify that \_\_\_\_\_ whose name as \_\_\_\_\_ of \_\_\_\_\_, is signed to the foregoing instrument, and who is known to me, acknowledged before me on this day that being informed of the contents of the instrument, he/she, as such officer/partner and with full authority, executed the same voluntarily for and as the act of said Corporation/Partnership.

Given under my hand and official seal, this the \_\_\_\_\_ day of \_\_\_\_\_, 20\_\_\_\_\_.

\_\_\_\_\_  
Notary Public

My commission expires \_\_\_\_\_.

For Alabama Power Company Corporate Real Estate Department use only.

All facilities on Grantor: \_\_\_\_\_

Station to Station: STA 2+00 TO STA 2+100

# NOTES:

- 1) POLE STAKED AT LOC. 2 FOR MISSALL LOCATION
- 2) APCO TO BILL CUSTOMER \$350 PER CSP 715-110.
- 3) CONTACT: JIM CARROLL 663-2969
- 4) FOR XY: CUSTOMER UNDER V6817, DCR 18214, BKR 48466 (FEEDER #3 ELLIOTSVILLE 35KV)

OVERHEAD  
RIGHT OF WAY  
WIDTH IS 30 FEET

UNDERGROUND  
RIGHT OF WAY  
WIDTH IS 10 FEET

## LOCATION SKETCH

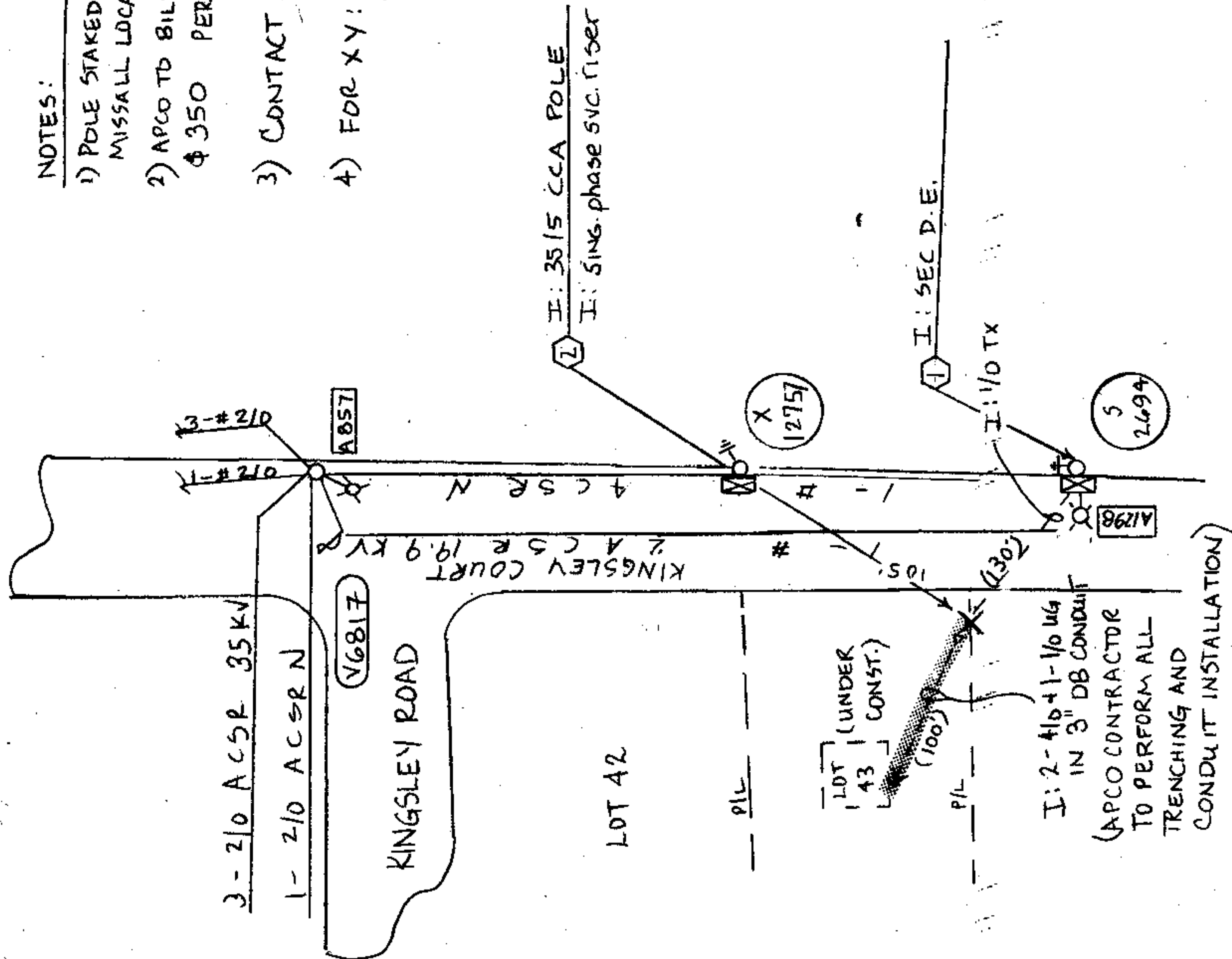

APPROVED BY: JIM CARROLL

ALABAMA POWER COMPANY

LOT 43 (NORWICK FOREST)

LOT 44 (NORWICK FOREST)

LOT 45 (NORWICK FOREST)

LOT 46 (NORWICK FOREST)

LOT 47 (NORWICK FOREST)

LOT 48 (NORWICK FOREST)

LOT 49 (NORWICK FOREST)

LOT 50 (NORWICK FOREST)

LOT 51 (NORWICK FOREST)

LOT 52 (NORWICK FOREST)

LOT 53 (NORWICK FOREST)

LOT 54 (NORWICK FOREST)

LOT 55 (NORWICK FOREST)

LOT 56 (NORWICK FOREST)

LOT 57 (NORWICK FOREST)

LOT 58 (NORWICK FOREST)

LOT 59 (NORWICK FOREST)

LOT 60 (NORWICK FOREST)

LOT 61 (NORWICK FOREST)

LOT 62 (NORWICK FOREST)

LOT 63 (NORWICK FOREST)

LOT 64 (NORWICK FOREST)

LOT 65 (NORWICK FOREST)

LOT 66 (NORWICK FOREST)

LOT 67 (NORWICK FOREST)

LOT 68 (NORWICK FOREST)

LOT 69 (NORWICK FOREST)

LOT 70 (NORWICK FOREST)

LOT 71 (NORWICK FOREST)

LOT 72 (NORWICK FOREST)

LOT 73 (NORWICK FOREST)

LOT 74 (NORWICK FOREST)

LOT 75 (NORWICK FOREST)

LOT 76 (NORWICK FOREST)

LOT 77 (NORWICK FOREST)

LOT 78 (NORWICK FOREST)

LOT 79 (NORWICK FOREST)

LOT 80 (NORWICK FOREST)

LOT 81 (NORWICK FOREST)

LOT 82 (NORWICK FOREST)

LOT 83 (NORWICK FOREST)

LOT 84 (NORWICK FOREST)

LOT 85 (NORWICK FOREST)

LOT 86 (NORWICK FOREST)

LOT 87 (NORWICK FOREST)

LOT 88 (NORWICK FOREST)

LOT 89 (NORWICK FOREST)

LOT 90 (NORWICK FOREST)

LOT 91 (NORWICK FOREST)

LOT 92 (NORWICK FOREST)

LOT 93 (NORWICK FOREST)

LOT 94 (NORWICK FOREST)

LOT 95 (NORWICK FOREST)

LOT 96 (NORWICK FOREST)

LOT 97 (NORWICK FOREST)

LOT 98 (NORWICK FOREST)

LOT 99 (NORWICK FOREST)

LOT 100 (NORWICK FOREST)

SECTIONALIZING SKETCH  
(FOR XY INFO ONLY)

