

2050
RESTRICTIVE COVENANTS and
GRANT OF LAND EASEMENT for
Underground facilities in Subdivision

WE Number: 61700-08-0048-8-00

PARCEL Number: 70080872

STATE OF ALABAMA)
County of Shelby)

THIS PERMIT COVERS ALL COMPANY FACILITIES
LOCATED ALONG THE ROUTE SHOWN
ON THE ATTACHED DRAWING WITHIN
THE SUBDIVISION IDENTIFIED HEREIN.

KNOW ALL MEN BY THESE PRESENTS, THAT: WHEREAS, the "Grantor", (whether one or more) are owners of record of the following described real estate in Shelby County, Alabama, to wit: **Eagle Point - 11th Sector** (the "Subdivision") as shown on the plat recorded in Map Book 24, page 124, in the Office of the Judge of Probate of Shelby County, Alabama (the "Property") and, **NE 1/4, Sec. 7, T19S, R1W**

WHEREAS, the said Grantor is desirous of granting Alabama Power Company, (the Company) an easement for underground electrical facilities and of establishing or placing the heretofore described subdivision under certain restrictive covenants to insure the use of the property for attractive residential purposes and thereby to secure to each lot owner the same advantages insured to other lot owners.

NOW, THEREFORE, The Grantor, for and in consideration of *One and No/100 Dollars (\$1.00)*, and other good and valuable consideration, to Grantor in hand paid by the Company, the receipt of which is hereby acknowledged, does hereby grant to Company, its successors and assigns, the right to construct, install, operate, maintain and replace, and the right to permit other corporations and persons to construct, install, operate, maintain and replace, along a route to be selected by the Company, (generally shown hatched on the attached drawing) its successors or assigns, all conduits, cables, translosures and other appliances and facilities (above ground and below ground) useful or necessary in connection therewith, for the underground transmission and distribution of electric power and for underground communication service upon, under and across the Property.

Together with all the rights and privileges necessary or convenient for the full enjoyment or use thereof, including the right of ingress and egress to and from said facilities and the right to excavate for installation, replacement, repair and removal thereof; and also the right to cut and keep clear any and all obstructions or obstacles of whatever character on, under and above said facilities.

TO HAVE AND TO HOLD such easement to the Company, its successors and assigns, forever.

And, the undersigned Grantors further does hereby adopt the following conditions, restrictions, covenants and limitations which shall apply in their entirety to all lots in the said Subdivision and shall run with the title to said property, and which shall be included in any conveyance of title to any or all of said lots in said subdivision:

1. The owners of lots within the Subdivision will not erect or grant to any person, firm or corporation the right, license or privilege to erect or use or permit the use of overhead wires, poles or overhead facilities of any kind for electrical, telephone, or cable television service on said real estate (except such poles and overhead facilities as may be required at those places where distribution facilities enter and leave said subdivision, or existing and/or future overhead transmission or communication facilities on existing Alabama Power Company rights of way) Nothing herein shall be construed to prohibit overhead street lighting, or ornamental yard lighting, where serviced by underground wires or cables.

2. In order to beautify said Subdivision for the benefit of all lot owners and permit Alabama Power Company to install underground electric service to each house in said Subdivision for the mutual benefit of all lot owners therein, no owner of any lot within said Subdivision will commence construction of any house on any lot until such owner (1) notifies Alabama Power Company that such construction is proposed, (2) grants in writing to Alabama Power Company such rights and easements as Alabama Power Company deems necessary in connection with its construction, operation, maintenance, replacement and removal of underground service laterals of each lot, and (3) otherwise complies with the Rules and Regulations for Underground Residential Distribution on file with and approved by the Alabama Public Service Commission. Further, no plants, shrubs, fences, walls or other obstructions shall be placed in front of or within three (3) feet of any side of any pad-mounted equipment and Alabama Power Company shall not be liable for any damages to or destruction of any shrubs, trees, flowers, grass or other plants caused by the equipment or employees of the Company or its contractors engaged in the construction, operation, maintenance, replacement or removal of the Company's facilities. Appropriate meter locations must be obtained from Alabama Power Company prior to installing or relocating service entrance facilities and associated internal wiring. Owners must install meter sockets provided by Alabama Power Company to the Company's specifications and provide and install two (2) inch (for 200 amp) or three (3) inch (for 400 amp) schedule 40 PVC or equivalent galvanized conduit from the meter socket to two (2) feet below finished grade.

3. Alabama Power Company, its successors and assigns, will retain title to all underground facilities installed by the Company or its contractors, including but not limited to the service lateral and outdoor metering socket serving each said house, and said service entrance facilities provided by Alabama Power Company will not in any way be considered a fixture or fixtures and thereby a part of said real estate, but will remain personal property belonging to Alabama Power Company, its successors and assigns, and will be subject to removal by Alabama Power Company, its successors and assigns, in accordance with applicable Rules and Regulations filed with and approved by the Alabama Public Service Commission.

4. These covenants and restrictions touch and concern and benefit the land and shall run with the land and shall be binding on Alabama Power Company, the undersigned, their respective heirs, successors and assigns. Invalidation of any one of the foregoing covenants and restrictions shall in no way affect any other provision contained herein.

Inst. # 2001-18568

05/09/2001-18568
10:57 AM CERTIFIED
SHELBY COUNTY JUDGE OF PROBATE
004 MB 20.50

IN WITNESS WHEREOF, this instrument has been executed this day 7th of MAY, 19 98.

GRANTOR:

Witness/Attest:

[Signature]

John G. Reamer Jr.
Name of Individual/Company/Partnership
[Signature]
Signature of Individual/Officer/Partner
PRESIDENT

Note: This agreement to be recorded in the Office of the Judge of Probate in the county as indicated above.

CORPORATE/PARTNERSHIP ACKNOWLEDGMENT

STATE OF ALABAMA)

County of Jefferson)

I, Mary Jane Dillard, a Notary Public, in and for said County in said State, hereby
certify that John G. Reamer, Jr., whose name as President
of Reamer Development Corporation a corporation/partnership, is signed to the
foregoing instrument, and who is known to me, acknowledged before me on this day that being informed of the contents of the instrument, he, as such
officer/partner and with full authority, executed the same voluntarily for and as the act of said corporation/partnership.

Given under my hand and official seal, this the 7th day of May, 19 98.

My commission expires: 5-29-99

Mary Jane Dillard
Notary Public

INDIVIDUAL ACKNOWLEDGMENT

STATE OF ALABAMA)

County of _____)

I, _____, a Notary Public in and for said County, in said State,
hereby certify that _____, whose name (s) (is/are) signed to the
foregoing instrument, and who (is/are) known to me, acknowledged before me on this date that, being informed of the contents of the agreement,
(has/have) executed the same voluntarily on the day the same bears date.

Given under my hand and official seal, this the _____ day of _____, 19 _____.

My commission expires _____

Notary Public

THIS INSTRUMENT PREPARED BY:

Don D. Bailey

Alabama Power Company
Corporate Real Estate
P. O. Box 2641
Birmingham, AL 35291-1980

DO NOT RECORD WITHOUT ATTACHED DRAWING!

LOCATION SKETCH

- 1) RISER LOADINGS BASED ON 10KVA PER LOT.
- 2) TRANSFORMER LOADINGS BASED ON FL.R.D. 27 & 31 A/C.
- 3) FLEXER CALCULATED ON A 3T A/C.
- 4) PRIMARY CABLE TO BE #1/0 35KV XHHW BURIED 48" BELOW GRADE.
- 5) ALL ROAD CROSSINGS WILL COMPLY WITH SHELBY COUNTY'S REQUIREMENTS.
- 6) INSTALL 200 AMP FAULT INDICATORS IN EACH TRANSFORMER.
- 7) ALL SECONDARY TO BE 1#/0 & 2#/0 AL XLPE 600 VOLT CABLE UNLESS OTHERWISE SPECIFIED. SECONDARY TO BE IN 36" DITCH.
- 8) ALL CONDUCTORS WILL BE INSTALLED IN 3" CONDUIT.
- 9) MAXIMUM VOLTAGE DROP CALCULATED AL LOT #___-___X
- 10) MAXIMUM FLEXER CALCULATED AT LOT #___-___X
- 11) APCO CONTRACTORS TO PERFORM ALL DITCHING, INSTALL ALL THE CABLE, CONDUITS, TRANSFORMER PADS AND GROUND RODS.

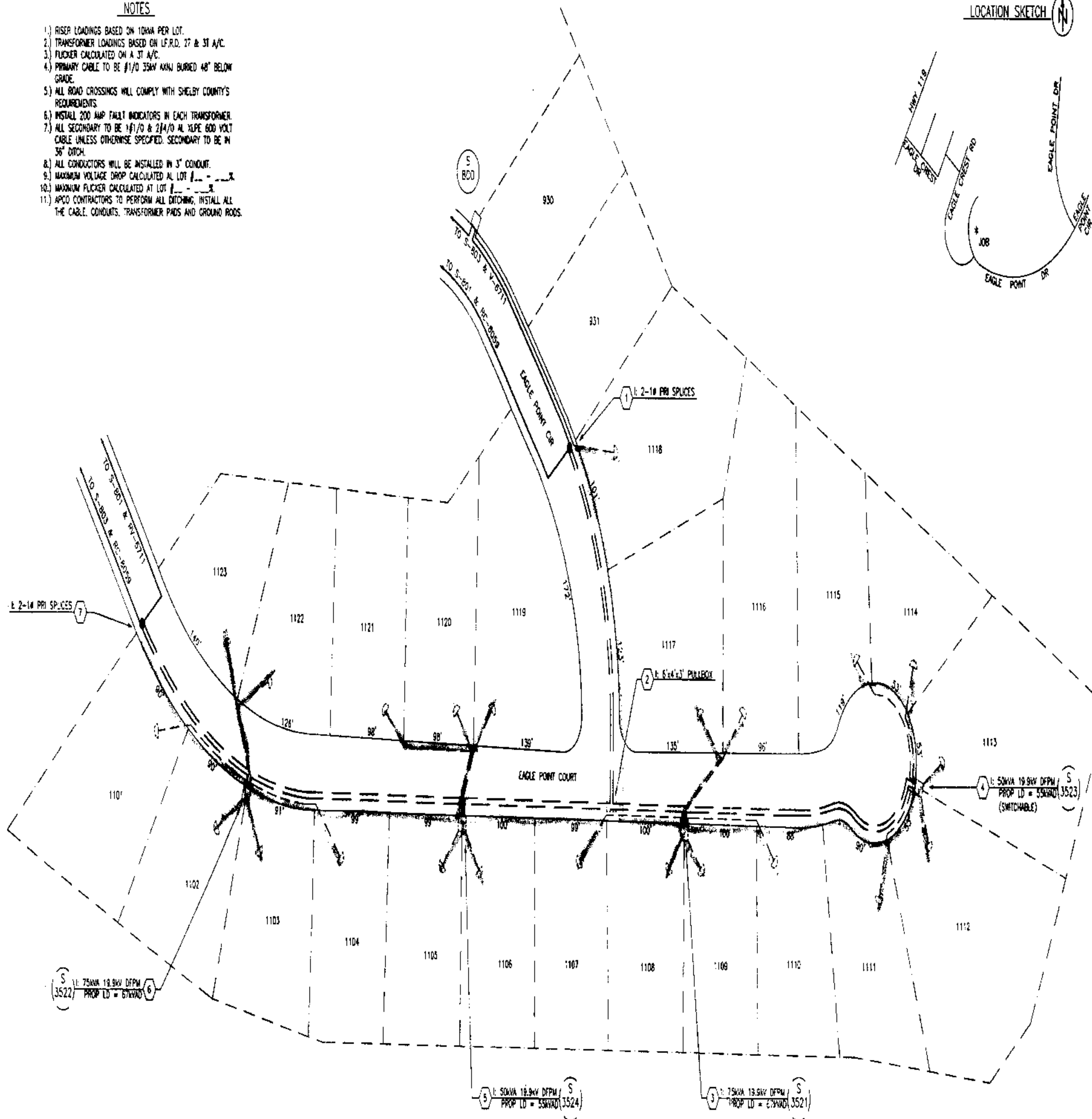

RESEARCH
DEPT OF THE
NAVY

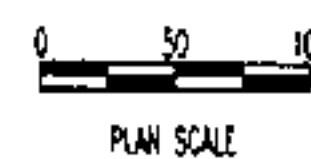

ALABAMA POWER CO

ALABAMA POWER CO

1	2	3	4	5	6	7	8	9	10	11	12	13	14	15	16	17	18	19	20	21	22	23	24	25	26	27	28	29	30	31	32	33	34	35	36	37	38	39	40	41	42	43	44	45	46	47	48	49	50	51	52	53	54	55	56	57	58	59	60	61	62	63	64	65	66	67	68	69	70	71	72	73	74	75	76	77	78	79	80	81	82	83	84	85	86	87	88	89	90	91	92	93	94	95	96	97	98	99	100	101	102	103	104	105	106	107	108	109	110	111	112	113	114	115	116	117	118	119	120	121	122	123	124	125	126	127	128	129	130	131	132	133	134	135	136	137	138	139	140	141	142	143	144	145	146	147	148	149	150	151	152	153	154	155	156	157	158	159	160	161	162	163	164	165	166	167	168	169	170	171	172	173	174	175	176	177	178	179	180	181	182	183	184	185	186	187	188	189	190	191	192	193	194	195	196	197	198	199	200	201	202	203	204	205	206	207	208	209	210	211	212	213	214	215	216	217	218	219	220	221	222	223	224	225	226	227	228	229	230	231	232	233	234	235	236	237	238	239	240	241	242	243	244	245	246	247	248	249	250	251	252	253	254	255	256	257	258	259	260	261	262	263	264	265	266	267	268	269	270	271	272	273	274	275	276	277	278	279	280	281	282	283	284	285	286	287	288	289	290	291	292	293	294	295	296	297	298	299	300	301	302	303	304	305	306	307	308	309	310	311	312	313	314	315	316	317	318	319	320	321	322	323	324	325	326	327	328	329	330	331	332	333	334	335	336	337	338	339	340	341	342	343	344	345	346	347	348	349	350	351	352	353	354	355	356	357	358	359	360	361	362	363	364	365	366	367	368	369	370	371	372	373	374	375	376	377	378	379	380	381	382	383	384	385	386	387	388	389	390	391	392	393	394	395	396	397	398	399	400	401	402	403	404	405	406	407	408	409	410	411	412	413	414	415	416	417	418	419	420	421	422	423	424	425	426	427	428	429	430	431	432	433	434	435	436	437	438	439	440	441	442	443	444	445	446	447	448	449	450	451	452	453	454	455	456	457	458	459	460	461	462	463	464	465	466
---	---	---	---	---	---	---	---	---	----	----	----	----	----	----	----	----	----	----	----	----	----	----	----	----	----	----	----	----	----	----	----	----	----	----	----	----	----	----	----	----	----	----	----	----	----	----	----	----	----	----	----	----	----	----	----	----	----	----	----	----	----	----	----	----	----	----	----	----	----	----	----	----	----	----	----	----	----	----	----	----	----	----	----	----	----	----	----	----	----	----	----	----	----	----	----	----	----	----	-----	-----	-----	-----	-----	-----	-----	-----	-----	-----	-----	-----	-----	-----	-----	-----	-----	-----	-----	-----	-----	-----	-----	-----	-----	-----	-----	-----	-----	-----	-----	-----	-----	-----	-----	-----	-----	-----	-----	-----	-----	-----	-----	-----	-----	-----	-----	-----	-----	-----	-----	-----	-----	-----	-----	-----	-----	-----	-----	-----	-----	-----	-----	-----	-----	-----	-----	-----	-----	-----	-----	-----	-----	-----	-----	-----	-----	-----	-----	-----	-----	-----	-----	-----	-----	-----	-----	-----	-----	-----	-----	-----	-----	-----	-----	-----	-----	-----	-----	-----	-----	-----	-----	-----	-----	-----	-----	-----	-----	-----	-----	-----	-----	-----	-----	-----	-----	-----	-----	-----	-----	-----	-----	-----	-----	-----	-----	-----	-----	-----	-----	-----	-----	-----	-----	-----	-----	-----	-----	-----	-----	-----	-----	-----	-----	-----	-----	-----	-----	-----	-----	-----	-----	-----	-----	-----	-----	-----	-----	-----	-----	-----	-----	-----	-----	-----	-----	-----	-----	-----	-----	-----	-----	-----	-----	-----	-----	-----	-----	-----	-----	-----	-----	-----	-----	-----	-----	-----	-----	-----	-----	-----	-----	-----	-----	-----	-----	-----	-----	-----	-----	-----	-----	-----	-----	-----	-----	-----	-----	-----	-----	-----	-----	-----	-----	-----	-----	-----	-----	-----	-----	-----	-----	-----	-----	-----	-----	-----	-----	-----	-----	-----	-----	-----	-----	-----	-----	-----	-----	-----	-----	-----	-----	-----	-----	-----	-----	-----	-----	-----	-----	-----	-----	-----	-----	-----	-----	-----	-----	-----	-----	-----	-----	-----	-----	-----	-----	-----	-----	-----	-----	-----	-----	-----	-----	-----	-----	-----	-----	-----	-----	-----	-----	-----	-----	-----	-----	-----	-----	-----	-----	-----	-----	-----	-----	-----	-----	-----	-----	-----	-----	-----	-----	-----	-----	-----	-----	-----	-----	-----	-----	-----	-----	-----	-----	-----	-----	-----	-----	-----	-----	-----	-----	-----	-----	-----	-----	-----	-----	-----	-----	-----	-----	-----	-----	-----	-----	-----	-----	-----	-----	-----	-----	-----	-----	-----	-----	-----	-----	-----	-----	-----	-----	-----	-----	-----	-----	-----	-----	-----	-----	-----	-----	-----	-----	-----	-----

[illegible]

S/C-61700.

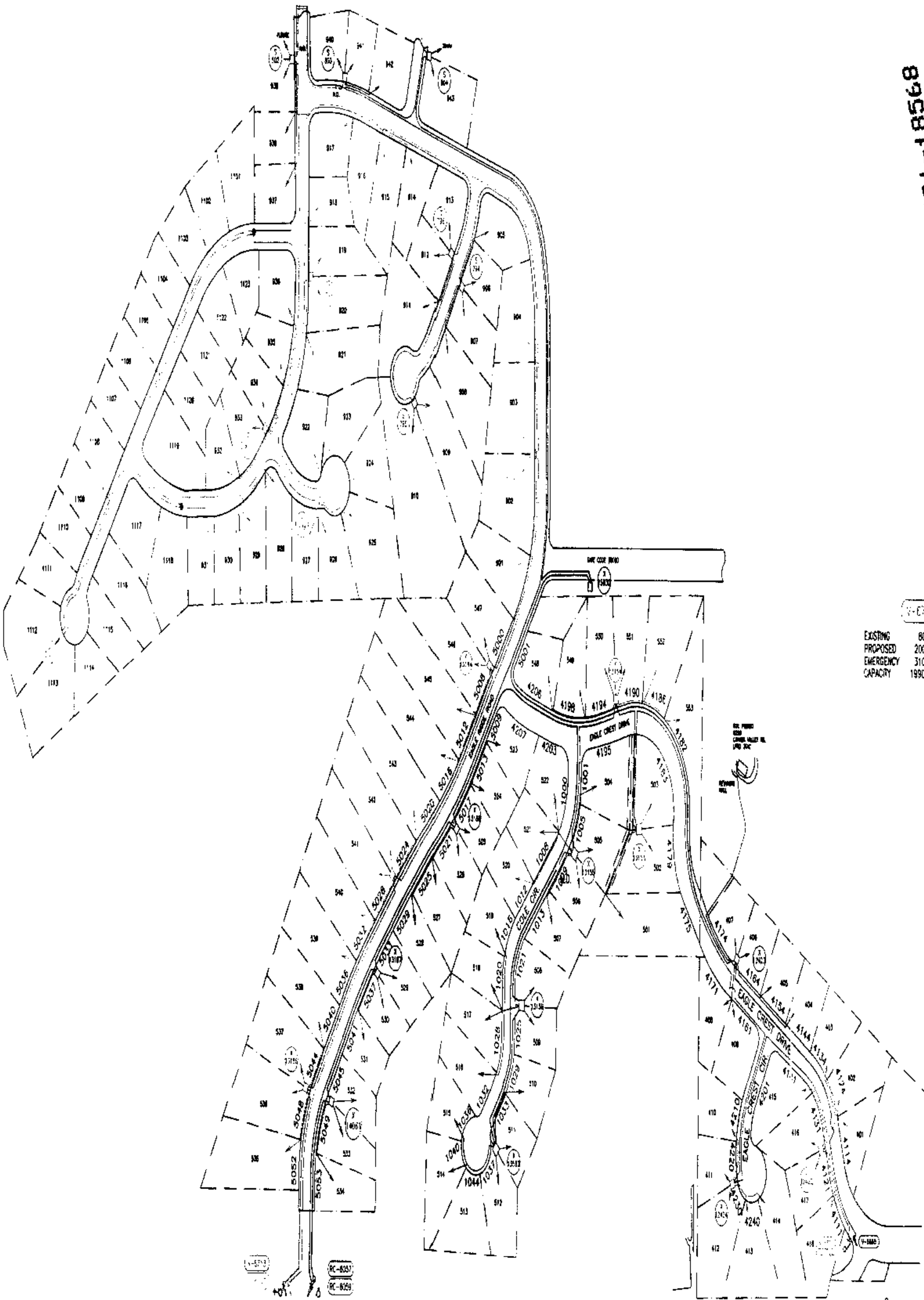

Inst # 2001-18568

05/09/2001-18568
10:57 AM CERTIFIED
SHELBY COUNTY JUDGE OF PROBATE
004 MB 20.50

	RISER LOADING (KVA)					
	V-6713	RC-8057	RC-8059	V-6661	V-6665	
EXISTING	80	50	230	20	280	79
PROPOSED	200	320	230	30	280	110
EMERGENCY	310	350	510	350	510	310
CAPACITY	1990	1990	1990	1990	1990	1990

0 NTS
PLAN SCALE

AUTOMATED DRAWING - MAKE NO MANUAL F

ALABAMA POWER COMP

TOWN:	COUNTY: SHELBY	JOB: SOUTH REGION DISTRIBUTION
VAP REF:	SEC- 7, TP-195, R-1W	DETAIL: PROVIDE URD SERVICE TO 23 IN EAGLE POINT - 11TH SEC
DRAWN: APW ENGR J. CALICOTZ DATE 03/13/98	SCALE: NTS	PLOTTED: 03/1
APPROVED: _____ DATE: _____	SHEET 2 OF 2 SHEETS	C-61700-08
APPROVED: _____ DATE: _____	SUPERSEDES	