

1400

1700

EASEMENT - DISTRIBUTION FACILITIES (Metes and Bounds)

TO BE RECORDED: YES NO

This instrument prepared by:

STATE OF ALABAMA } COUNTY OF Shelby } TAX ID #

W.E. No. 61700-00-0290-000 Parcel No. 70080460 Transformer No.

Alabama Power Company P. O. Box 2641 Birmingham, Alabama 35291

18660-1002 Inst

A. GRANT KNOW ALL MEN BY THESE PRESENTS, That Morlo F. Robey and husband Richard R. Robey

as grantor(s), (the "Grantor", whether one or more) for and in consideration of One and No/100 Dollars (\$1.00), and other good and valuable consideration, to Grantor in hand paid by Alabama Power Company, a corporation, the receipt and sufficiency of which are hereby acknowledged, does hereby grant to Alabama Power Company, its successors and assigns (the "Company"), the easements, rights and privileges described and designated in Section B below.

B. RIGHTS The easements, rights and privileges granted hereby are as follows:

- 1. Overhead and/or Underground. The right from time to time to construct, install, operate and maintain, upon, over, under and across the Property described in Section C below, along a route to be selected by the Company which is generally shown on the Company's final location drawing...
2. Line Clearing. The right to trim and cut and keep trimmed and cut all dead, weak, leaning or dangerous trees or limbs that, in the sole opinion of the Company, might now or may hereafter endanger, interfere with or fall upon the electric transmission or distribution lines...
3. Guy Wires and Anchors. The right to implant, install and maintain anchor(s) of concrete, metal or other material on and under the Property described in Section C below, and to construct, extend and maintain guy wires from such anchor(s) to structures now or hereafter erected adjacent to such Property or property adjacent thereto...

Grantor hereby grants to the Company all easements, rights and privileges necessary or convenient for the full enjoyment and use thereof, including without limitation the right of ingress and egress to and from the Facilities and Guy Wire Facilities, as applicable, and the right to excavate for installation, replacement, repair and removal thereof; and also the right to cut, remove and otherwise keep clear any and all structures, obstructions or obstacles of whatever character, on, under and above said Facilities and Guy Wire Facilities, as applicable.

C. PROPERTY DESCRIPTION The easements, rights and privileges granted hereby shall apply to, and the word "Property" as used in this instrument shall mean, the following described real property situated in Shelby County, Alabama (the "Property"): A parcel of land in the NE 1/4 of the NW 1/4 of Section 19, Township 19S, Range 2E, as is recorded in 1999 at 21946 in the office of the Judge of Probate of Shelby County, Alabama

D. ADDITIONAL PROVISIONS. In the event it becomes necessary or desirable for the Company to move any of the Facilities in connection with the construction or improvement of any public road or highway in proximity to the Facilities, Grantor hereby grants to the Company the right to relocate the Facilities and, as to such relocated Facilities, to exercise the rights granted above; provided, however, the Company shall not relocate the Facilities on the Property at a distance greater than ten feet (10') outside the boundary of the right of way of any such public road or highway as established or re-established from time to time. This grant and agreement shall be binding upon and shall inure to the benefit of Grantor, the Company and each of their respective heirs, personal representatives, successors and assigns and the words "Company" and "Grantor" as used in this instrument shall be deemed to include the heirs, personal representatives, successors and assigns of such parties.

TO HAVE AND TO HOLD the same to the Company, its successors and assigns, forever.

IN WITNESS WHEREOF, the undersigned Grantor(s) has/have set hereon their hand(s) and seal(s) this the 8th day of May, 2000.

Witness signatures: Gary D. Bland

Grantor signatures: Morlo F. Robey (SEAL), Richard R. Robey (SEAL)

Witness line

By: (SEAL) As:

\$ 570.00

03/20/2001-03981 09:40 AM CERTIFIED SHELBY COUNTY JUDGE OF PROBATE 003 MEL 17.50

IN WITNESS WHEREOF, the said Grantor, has caused this instrument to be executed by _____
its authorized representative, as of the _____ day of _____, 20_____.

ATTEST (if corporation) or WITNESS:

(Grantor - Name of Corporation/Partnership/LLC)

By: _____

By: _____ (SEAL)

Its: _____

Its: _____

[indicate President, General Partner, Member, etc.]

INDIVIDUAL NOTARIES

STATE OF ALABAMA }

COUNTY OF _____ }

I, the undersigned, a Notary Public, in and for said County in said State, hereby certify that _____
_____ whose name(s) is/are signed to the foregoing instrument and who is/are known to me, acknowledged before me
on this day that being informed of the contents of the instrument, he/she/they executed the same voluntarily, on the day the same bears date.

Given under my hand and official seal this the _____ day of _____, _____.

[SEAL]

Notary Public
My commission expires: _____

STATE OF ALABAMA }

COUNTY OF _____ }

I, the undersigned, a Notary Public, in and for said County in said State, hereby certify that _____
_____ whose name(s) is/are signed to the foregoing instrument and who is/are known to me, acknowledged before me
on this day that being informed of the contents of the instrument, he/she/they executed the same voluntarily, on the day the same bears date.

Given under my hand and official seal this the _____ day of _____, _____.

[SEAL]

Notary Public
My commission expires: _____

TRUSTEE/CORPORATION/PARTNERSHIP/LLC NOTARY

STATE OF ALABAMA }

COUNTY OF _____ }

I, the undersigned, a Notary Public, in and for said County in said State, hereby certify that _____
_____, whose name as _____ of _____
_____ a _____ [as _____
_____] is signed to the foregoing instrument, and who is known to me, acknowledged before me on this day that
being informed of the contents of the instrument, he/she, as such _____ and with full authority, executed the same voluntarily for and as
the act of said _____ [acting in such capacity as aforesaid].

Given under my hand and official seal, this the _____ day of _____, _____.

[SEAL]

Notary Public
My commission expires: _____

For Alabama Power Company Corporate Real Estate Department Use Only

All facilities on Grantor: X

Station to Station: _____

SKETCH OF PROPOSED WORK — SIMPLIFIED W. E.



Customer <i>Craig Ogard</i>	Location <i>89 Deerwood Lake Dr.</i>	Agreed Serv. Date	Estimate No. <i>61700-00-02900</i>
Division <i>Birmingham</i>	District <i>Metro-South</i>	Town <i>Harpersville</i>	Drawn by <i>B. Cofer</i>
County <i>Shelby</i>	Section <i>19</i>	Township <i>19S</i>	Range <i>2E</i>
Acquisition Agent <i>L.D.S.</i>	Date R/W Assigned <i>4-28-00</i>	Date R/W Cleared <i>5-11-00</i>	Map Reference <i>C-61703 #16</i>
			LOC
			Transformer Loading

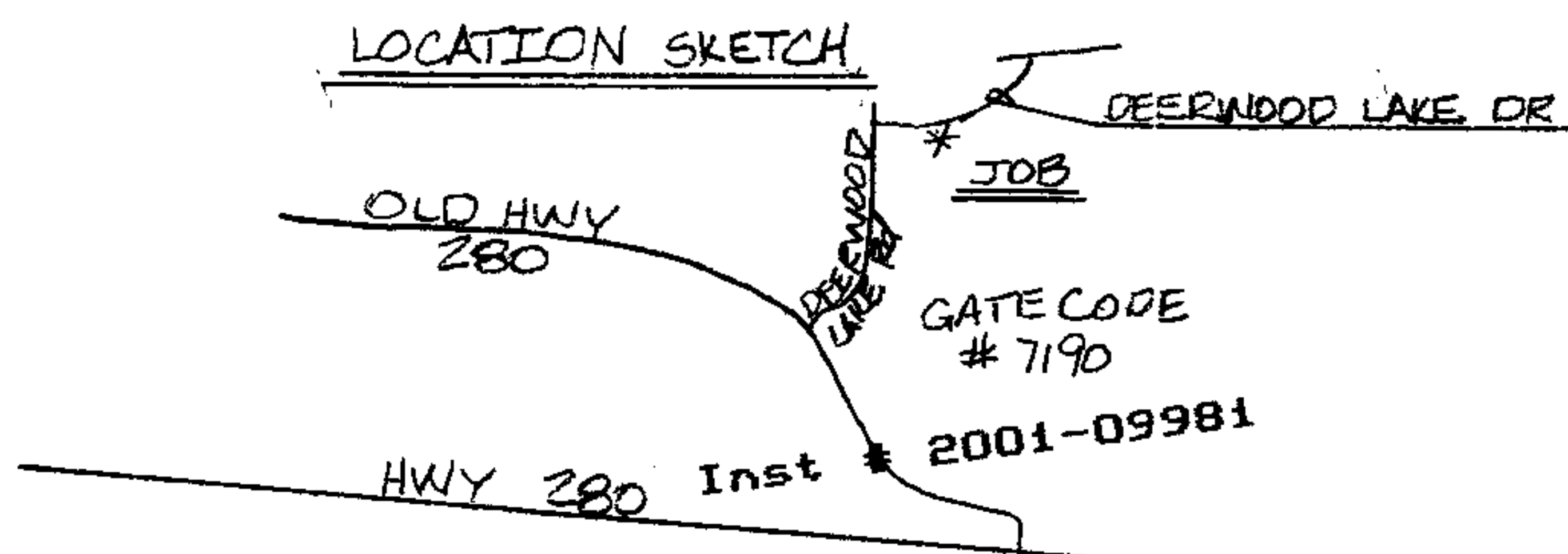
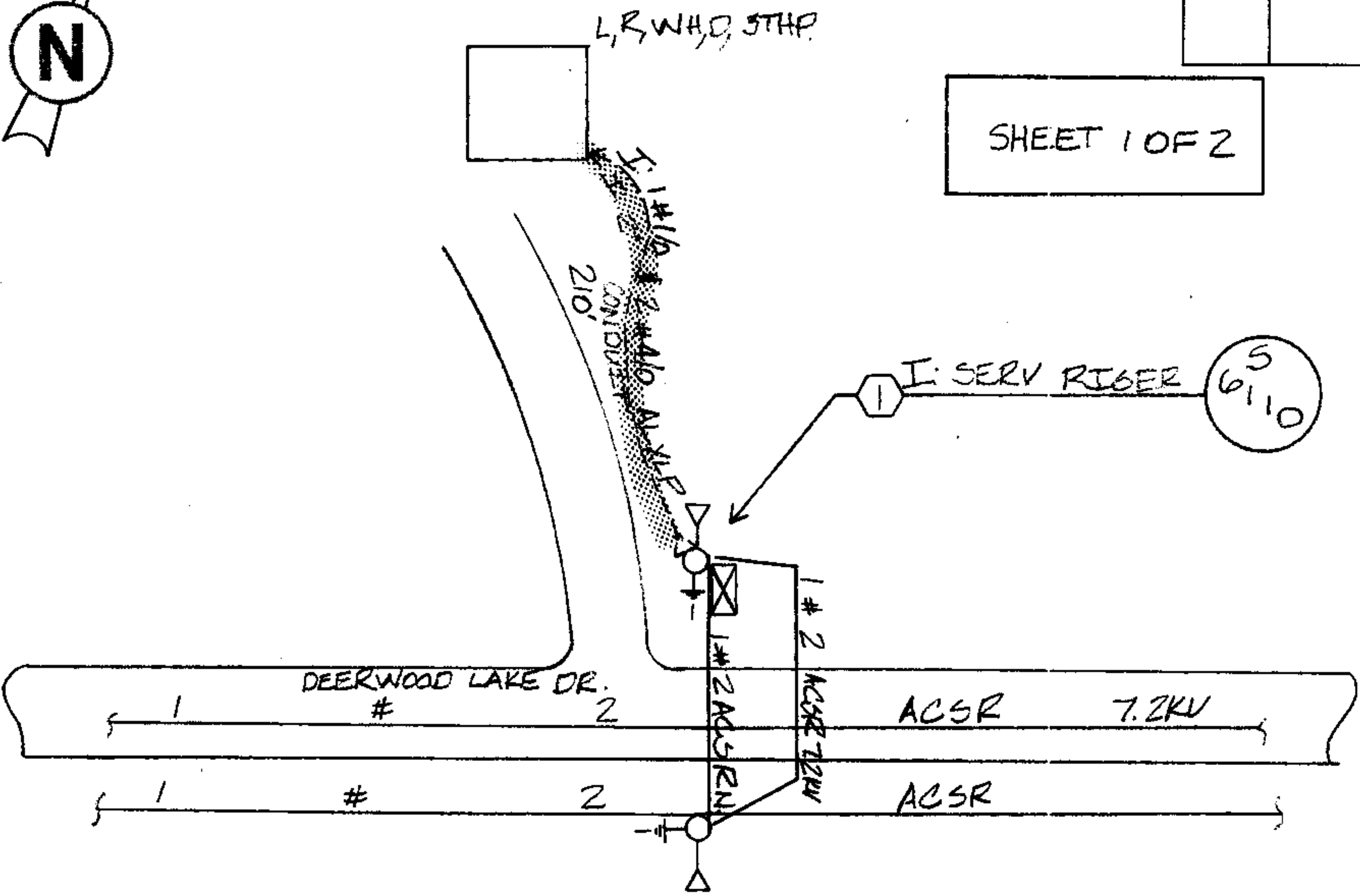

Voltage	
Pri	Sec.
7.2 KV	120 / 240 V
PHONE CO.	
Co. Name	
CATV CO.	
Co. Name	
ACCESSIBLE	
TREE CREW	
ROCK HOLE	
PERMITS REQ'D	
R/W	X
CITY	
COUNTY	
STATE	
MISSALL #	X
OTHER	
SCALE	
N.T.S	
Fl. Per Inch	

03/20/2001-09981
 09:40 AM CERTIFIED
 SHELBY COUNTY JUDGE OF PROBATE
 003 HEL 12:50

Cnst. Completed By _____ Date _____