

1400

**RESTRICTIVE COVENANTS and
GRANT OF LAND EASEMENT for
Underground facilities in Subdivision**

WE Number: 61700-08-0052-8-00

PARCEL Number: _____

STATE OF ALABAMA)

County of Shelby)

**THIS PERMIT COVERS ALL COMPANY FACILITIES
LOCATED ALONG THE ROUTE SHOWN
ON THE ATTACHED DRAWING WITHIN
THE SUBDIVISION IDENTIFIED HEREIN.**

KNOW ALL MEN BY THESE PRESENTS, THAT: WHEREAS, the "Grantor", (whether one or more) are owners of record of the following described real estate in Shelby County, Alabama, to wit: Cedar Cove @ Sterling Gate - Ph2, *Sector 2* (the "Subdivision") as shown on the plat recorded in Map Book 26, page 30, in the Office of the Judge of Probate of Shelby County, Alabama (the "Property") and, *Sec. 4, T 21 S, R 3 W*

WHEREAS, the said Grantor is desirous of granting Alabama Power Company, (the Company) an easement for underground electrical facilities and of establishing or placing the heretofore described subdivision under certain restrictive covenants to insure the use of the property for attractive residential purposes and thereby to secure to each lot owner the same advantages insured to other lot owners.

NOW, THEREFORE, The Grantor, for and in consideration of *One and No/100 Dollars (\$1.00)*, and other good and valuable consideration, to Grantor in hand paid by the Company, the receipt of which is hereby acknowledged, does hereby grant to Company, its successors and assigns, the right to construct, install, operate, maintain and replace, and the right to permit other corporations and persons to construct, install, operate, maintain and replace, along a route to be selected by the Company, (generally shown hatched on the attached drawing) its successors or assigns, all conduits, cables, translosures and other appliances and facilities (above ground and below ground) useful or necessary in connection therewith, for the underground transmission and distribution of electric power and for underground communication service upon, under and across the Property.

Together with all the rights and privileges necessary or convenient for the full enjoyment or use thereof, including the right of ingress and egress to and from said facilities and the right to excavate for installation, replacement, repair and removal thereof, and also the right to cut and keep clear any and all obstructions or obstacles of whatever character on, under and above said facilities.

TO HAVE AND TO HOLD such easement to the Company, its successors and assigns, forever.

And, the undersigned Grantors further does hereby adopt the following conditions, restrictions, covenants and limitations which shall apply in their entirety to all lots in the said Subdivision and shall run with the title to said property, and which shall be included in any conveyance of title to any or all of said lots in said subdivision:

1. The owners of lots within the Subdivision will not erect or grant to any person, firm or corporation the right, license or privilege to erect or use or permit the use of overhead wires, poles or overhead facilities of any kind for electrical, telephone, or cable television service on said real estate (except such poles and overhead facilities as may be required at those places where distribution facilities enter and leave said subdivision, or existing and/or future overhead transmission or communication facilities on existing Alabama Power Company rights of way). Nothing herein shall be construed to prohibit overhead street lighting, or ornamental yard lighting, where serviced by underground wires or cables.
2. In order to beautify said Subdivision for the benefit of all lot owners and permit Alabama Power Company to install underground electric service to each house in said Subdivision for the mutual benefit of all lot owners therein, no owner of any lot within said Subdivision will commence construction of any house on any lot until such owner (1) notifies Alabama Power Company that such construction is proposed, (2) grants in writing to Alabama Power Company such rights and easements as Alabama Power Company deems necessary in connection with its construction, operation, maintenance, replacement and removal of underground service laterals of each lot, and (3) otherwise complies with the Rules and Regulations for Underground Residential Distribution on file with and approved by the Alabama Public Service Commission. Further, no plants, shrubs, fences, walls or other obstructions shall be placed in front of or within three (3) feet of any side of any pad-mounted equipment and Alabama Power Company shall not be liable for any damages to or destruction of any shrubs, trees, flowers, grass or other plants caused by the equipment or employees of the Company or its contractors engaged in the construction, operation, maintenance, replacement or removal of the Company's facilities. Appropriate meter locations must be obtained from Alabama Power Company prior to installing or relocating service entrance facilities and associated internal wiring. Owners must install meter sockets provided by Alabama Power Company to the Company's specifications and provide and install two (2) inch (for 200 amp) or three (3) inch (for 400 amp) schedule 40 PVC or equivalent galvanized conduit from the meter socket to two (2) feet below finished grade.
3. Alabama Power Company, its successors and assigns, will retain title to all underground facilities installed by the Company or its contractors, including but not limited to the service lateral and outdoor metering socket serving each said house, and said service entrance facilities provided by Alabama Power Company will not in any way be considered a fixture or fixtures and thereby a part of said real estate, but will remain personal property belonging to Alabama Power Company, its successors and assigns, and will be subject to removal by Alabama Power Company, its successors and assigns, in accordance with applicable Rules and Regulations filed with and approved by the Alabama Public Service Commission.
4. These covenants and restrictions touch and concern and benefit the land and shall run with the land and shall be binding on Alabama Power Company, the undersigned, their respective heirs, successors and assigns. Invalidity of any one of the foregoing covenants and restrictions shall in no way affect any other provision contained herein.

Inst # 2000-11844
14/11/2000-11844
09:39 AM CERTIFIED
SHELBY COUNTY JUDGE OF PROBATE
003 MMS 14.00

IN WITNESS WHEREOF, this instrument has been executed this day 26th of JANUARY, 19 99.

Witness/Attest:

GRANTOR:

GREEN BRIAR LTD

Name of Individual/Company/Partnership

Mary F. Roensch
Signature of Individual/Officer/Partner

Note: This agreement to be recorded in the Office of the Judge of Probate in the county as indicated above.

CORPORATE/PARTNERSHIP ACKNOWLEDGMENT

STATE OF ALABAMA)

County of Shelby)

I, _____, a Notary Public, in and for said County in said State, hereby
certify that Mary F. Roensch, whose name as PRESIDENT
of FARRIS MGMTG, INC Managing General Partner of GREENBRIAR LTD corporation/partnership, is signed to the
foregoing instrument, and who is known to me, acknowledged before me on this day that being informed of the contents of the instrument, he, as such
officer/partner and with full authority, executed the same voluntarily for and as the act of said corporation/partnership.

Given under my hand and official seal, this the 26 day of Jan, 19 99.

NOTARY PUBLIC STATE OF ALABAMA AT LARGE

MY COMMISSION EXPIRES: Nov. 11, 2001.

My commission expires ENDED THRU NOTARY PUBLIC UNDERWRITERS.

Shonda K. Roensch
Notary Public

INDIVIDUAL ACKNOWLEDGMENT

STATE OF ALABAMA)

County of _____)

I, _____, a Notary Public in and for said County, in said State,
hereby certify that _____, whose name (s) (is/are) signed to the
foregoing instrument, and who (is/are) known to me, acknowledged before me on this date that, being informed of the contents of the agreement,
(has/have) executed the same voluntarily on the day the same bears date.

Given under my hand and official seal, this the _____ day of _____, 19 _____.

Notary Public

My commission expires _____.

THIS INSTRUMENT PREPARED BY:

Don D. Bailey

Alabama Power Company
Corporate Real Estate
P. O. Box 2641
Birmingham, AL 35291-1980

DO NOT RECORD WITHOUT ATTACHED DRAWING!

Inst # 2000-11814

09:39 AM LER 11

SEELY COUNTY PROBATE - 00

RISER LOADINGS		
S/N	NORMAL LOAD	EMERGENCY LOAD
A-4346	28.4A	54.4A
A-4339	30.0A	52.4A
A-4341	7.4A	18.0A
A-4343	7.4A	18.0A

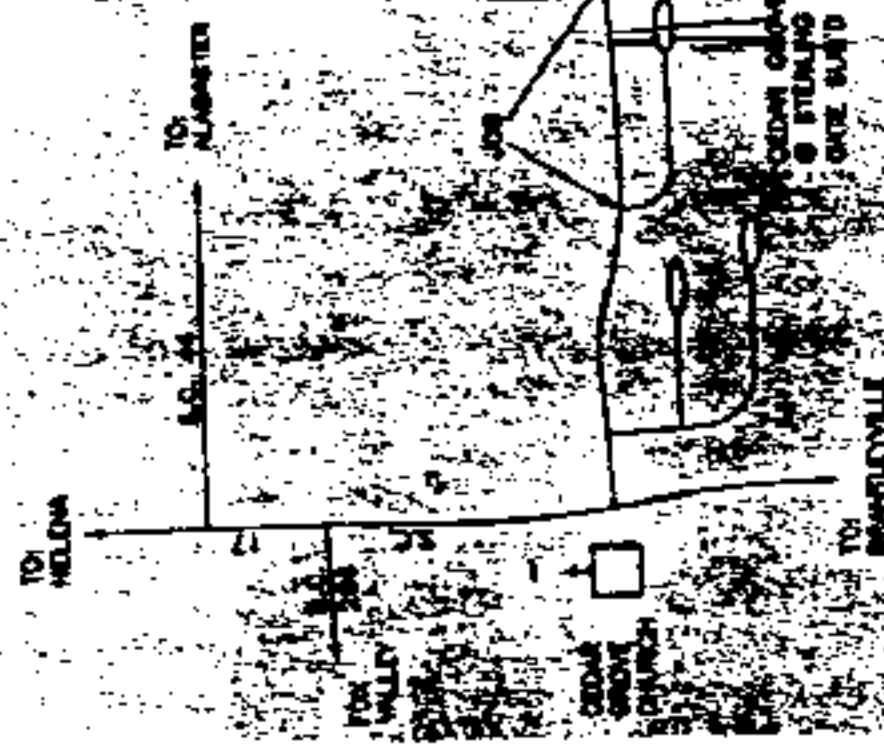
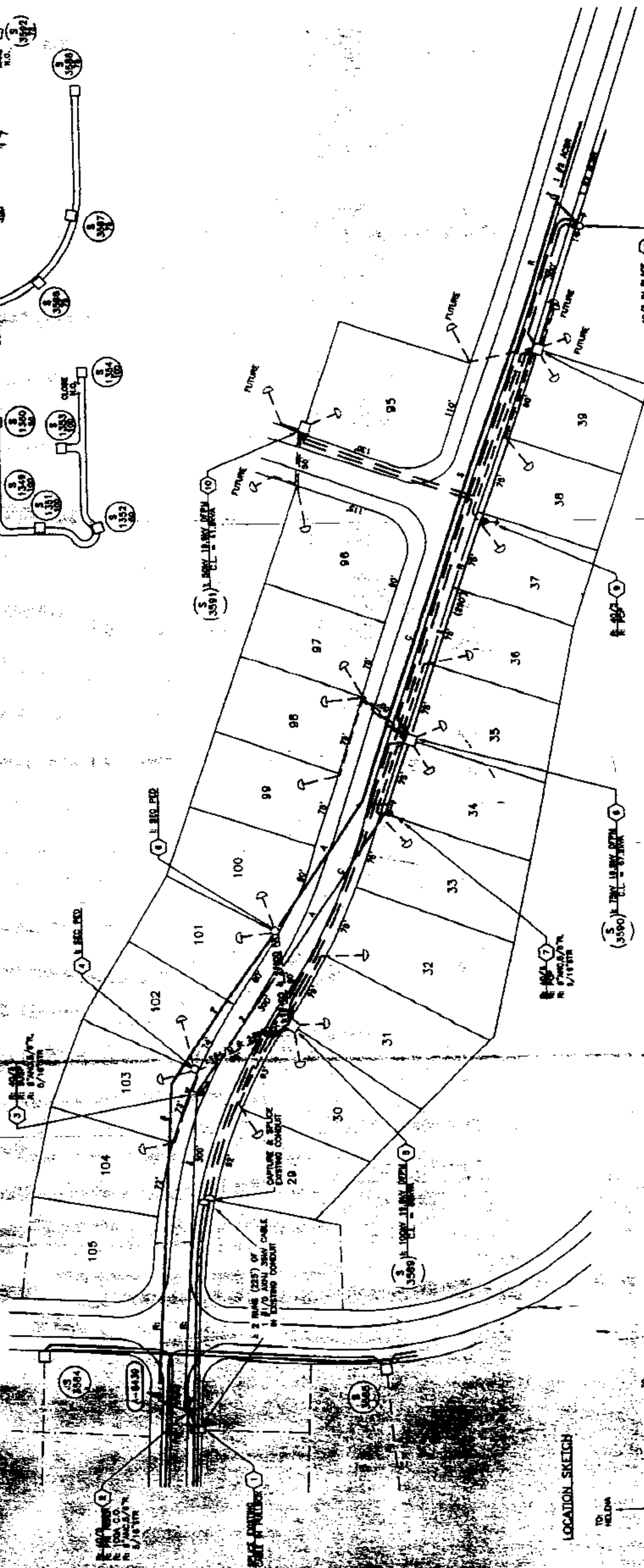
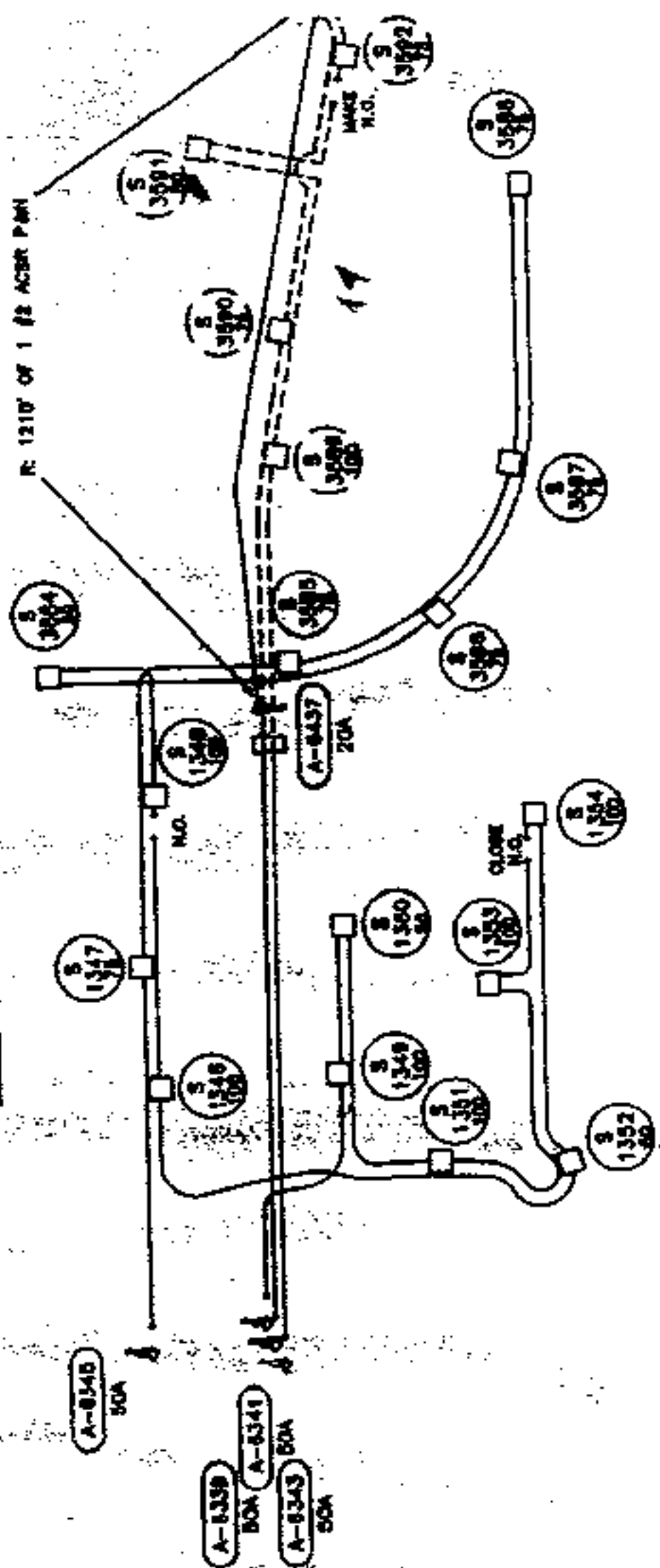
[illegible]

INCHES

TOWN:	COUNTY:	SHELLEY
MAP REF:	3W-21-4-1	SEC- 4, TP-21S, R-3W
DRAWN:	MPM	ENGR. E. HENDON
APPROVED:	DATE:	03/31/88
	CHECK	

ALABAMA POWER CO
NORTH REGION DISTRICT
CENTRAL OFFICE
PLANT 1000 1000 1000
SCALE 1000
PLOT
C-1000