

**IN THE PROBATE COURT OF SHELBY COUNTY,
ALABAMA**

STATE OF ALABAMA,
Plaintiff,

v.

STATE OF ALABAMA,
Plaintiff,

v.

DEWEY V. GLASS and GREGORY B.
GLASS, owners of the fee, and
ANNETTE D. SKINNER, SHELBY
COUNTY TAX COLLECTOR;
and any and all unknown persons, firms,
entities or corporations holding or claiming
any right, title, interest in, lien or
encumbrance in and to the property
described in this Complaint,

Defendants.

CASE NO. 39-040

Inst # 1999-52039

12/28/1999-52039
01:30 PM CERTIFIED
SHELBY COUNTY JUDGE OF PROBATE
003 CJI 13.50

NOTICE of LIS PENDENS

**TO THE HON. PATRICIA YEAGER FURMEISTER, JUDGE OF PROBATE OF
SHELBY COUNTY, ALABAMA:**

COMES NOW, the State of Alabama, by and through its Deputy Attorney General, and files herewith notice to all persons concerned that on the 13th day of September, 1999, condemnation proceedings were commenced in the probate Court of Shelby County, Alabama, whereby said State of Alabama seeks to obtain certain public rights-of-way and other rights, and said proceedings are now pending.

The name of the property owner concerned together with the property sought to be condemned is set forth below:

Property Owners: Dewey V. Glass and Gregory B. Glass

Property described on Exhibit "A" attached hereto and made a part hereof as if fully set forth herein.

Description of above described property is taken from right of way map of Project STPAA-458 (1) of record in the Alabama Department of Transportation, and in the Office of the Judge of Probate of Shelby County, Alabama.

The title of the action and the case number thereof are as hereinabove designated.

STATE OF ALABAMA

BY:

AYN TRAYLOR-SADBERRY
DEPUTY ATTORNEY GENERAL

STATE OF ALABAMA)
JEFFERSON COUNTY)

IN THE PROBATE COURT OF SHELBY COUNTY, ALABAMA

I hereby certify that the within Lis Pendens was filed in this office for record on the ____ day of _____, 1999, at _____ o'clock ____ m. and duly recorded as Instrument No. _____, and examined.

Judge of Probate

EXHIBIT "A"

A part of East 1/2 of the Northwest 1/4, Section 11, Township 21 South, Range 3 West, identified as Tract No. 31, Project No. STPAA-458 (1), Shelby County, Alabama, and being more fully described as follows:

Commence at the Southwest corner said Southeast 1/4 of the Northwest 1/4; thence east along the South line of said Southeast 1/4 of Northwest 1/4 a distance of 1034 feet, more or less, the present East right of way line of Alabama Highway 119; thence southerly along said right of way line a distance of 580 feet, more or less, to the South property line and the point of beginning of the property herein to be conveyed; thence continue northerly along said right of way line a distance of 43 feet, more or less, to an offset in said right of way line; thence an angle of 90 degrees to the left a distance of 10 feet; thence an angle of 90 degrees to the right along said present East right of way line a distance of 391 feet, more or less, to an offset in said right of way line; thence an angle of 90 degrees to the left a distance of 5 feet; thence angle to the right along said present East right of way line a distance 350 feet, more or less, to the North property line; thence East along said property line a distance of 102 feet, more or less, to a point that is 65 feet southeasterly of and at right angles to the centerline of said Project No. STPAA-458 (1); thence southwesterly, parallel with said centerline, along a curve to the left (concave southeasterly), a distance of 126 feet, more or less, to a point that is 65 feet southerly of and at right angles to said centerline at P.C. Station 508+27.41; thence southerly, parallel with said centerline, a distance of 656 feet, more or less, to the South property line; thence west along said property line a distance of 46 feet, more or less, to the point of beginning, being situated in Shelby County, Alabama.

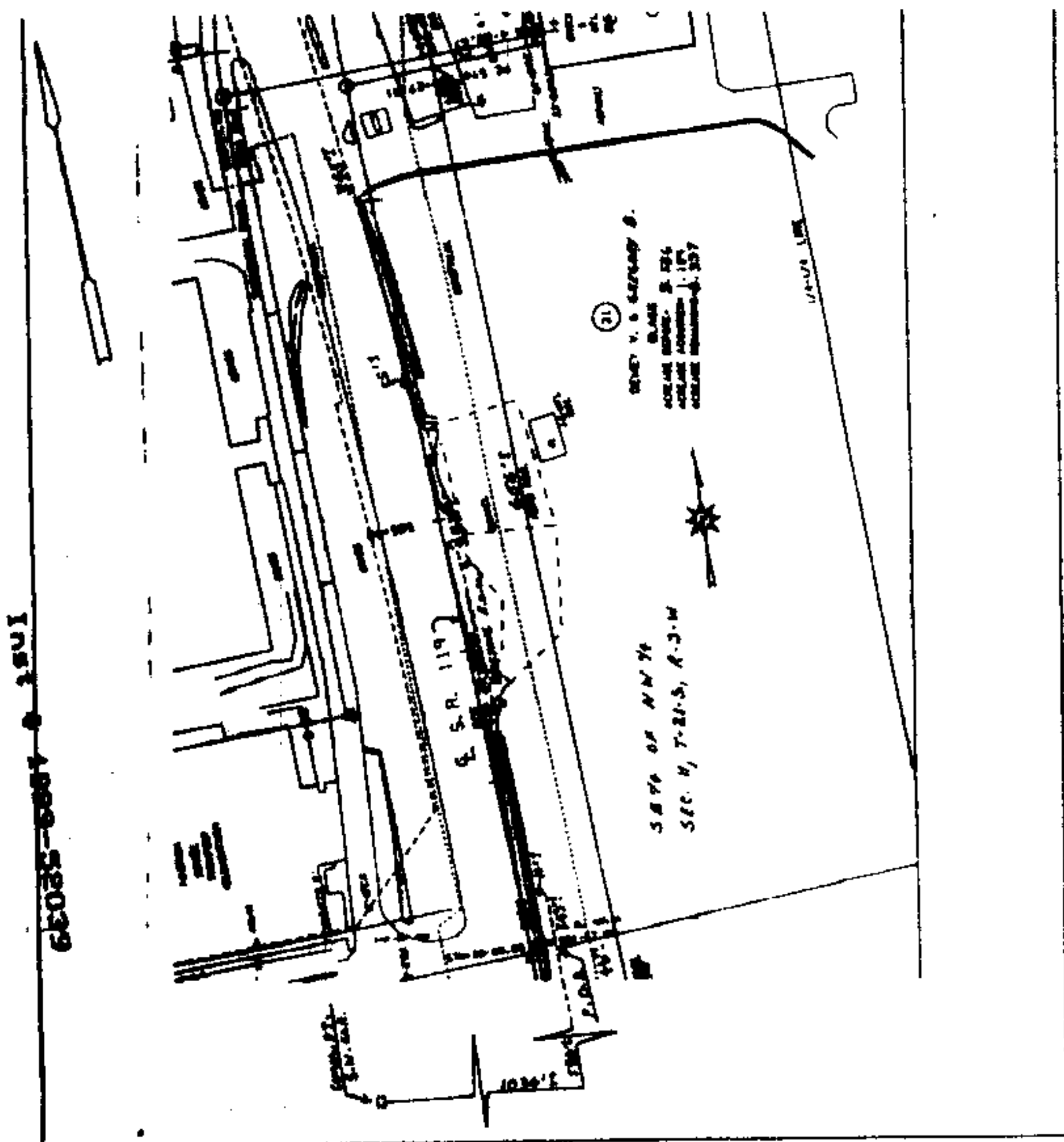

12/28/1999-52039
01:30 PM CERTIFIED
SHELBY COUNTY JUDGE OF PROBATE
003 C31 12:30

TRACT NUMBER <u>31</u>	ALABAMA DEPARTMENT OF TRANSPORTATION
OWNER: <u>DEWEY V. AND GREGORY B. GLASS</u>	PROJECT NO. STPAA-458 (1)
TOTAL ACERAGE: <u>2.586</u>	SHELBY COUNTY
R/W REQUIRED: <u>1.189</u>	SCALE: 1" = <u>100'</u>
REMAINDER: <u>8.397</u>	DATE: <u>12-12-97</u>
	REVISED: <u>7-21-98, 11-10-98, 6-20-99</u>