

EASEMENT - DISTRIBUTION FACILITIES

STATE OF ALABAMA }
COUNTY OF Shelby }

12/00
Stn #2+75 to Stn #3+00
Also, Stn #3+00 to Stn #3+20 (ldg.)
All facilities on Grantor: ☐

W. E. No. 61700-00-0695-800

Parcel No. _____

A. GRANT KNOW ALL MEN BY THESE PRESENTS, That Shelby County Board of Education

as grantor(s), (the "Grantor", whether one or more) for and in consideration of One and No/100 Dollars (\$1.00), and other good and valuable consideration, to Grantor in hand paid by Alabama Power Company (the "Company"), a corporation, the receipt and sufficiency of which are hereby acknowledged, does hereby grant to the Company, the easements, rights and privileges described and designated in Section B below, together with the right to permit other persons, partnerships and corporations to use and exercise such easements, rights and privileges in common with the Company.

B. RIGHTS The easements, rights and privileges granted hereby are as follows (if less than all of 1-3 are granted, then check and initial applicable paragraphs):

1. **Overhead and/or Underground.** The right from time to time to construct, install, operate and maintain, upon, over, under and across the Property described in Section C below, along a route to be selected by the Company which is generally shown on the attached drawing (which shows the general location of underground facilities, if any, by cross-hatching indicating an area not greater than ten feet (10') in width), all poles, towers, wires, conduits, fiber optics, cables, translosures, transformers, anchors of concrete, metal or other material, guy wires and other materials, appliances, facilities and other apparatuses of whatever type, whether now or in the future existing or known which are useful or necessary in connection therewith (collectively, "Facilities"), for the overhead and/or underground transmission and distribution of electric power and for overhead and/or underground communication service, and also the right to clear a strip extending fifteen feet (15') to either side of the center line of the lines of poles and keep it cleared of all trees, undergrowth or other obstructions; further, the right to trim and cut and keep trimmed and cut all dead, weak, leaning or dangerous trees or limbs outside of the thirty foot (30') strip which, in the sole opinion of the Company, might endanger, interfere with or fall upon the poles, lines, or other appliances of the Company.

2. **Line Clearing.** The right to cut and trim and to keep cut and trimmed, and remove all dead, weak, leaning or dangerous trees or limbs, which, in the Company's sole discretion, now or may hereafter endanger or interfere with the electric transmission lines, telephone lines, poles, towers or other facilities of the Company or others now constructed, or which may hereafter be constructed, on or adjacent to the Property described in Section C below, and also the right to clear a strip extending fifteen feet (15') to either side of the center line of the lines of poles and keep it cleared of all trees, undergrowth or other obstructions.

3. **Guy Wire and Anchor.** The right to implant, install and maintain anchor(s) of concrete, metal or other material at point(s) on the Property described in Section C below, and to construct, extend and maintain guy wires from such anchor(s) to structures now erected or hereafter to be erected on such Property or property adjacent thereto (collectively, "Guy Wire Facilities").

In addition to the easements, rights and privileges granted in all or any of 1, 2, or 3 above, Grantor hereby grants to the Company all easements, rights and privileges necessary or convenient for the full enjoyment and use thereof, including without limitation the right of ingress and egress to and from the Company's Facilities and Guy Wire Facilities, as applicable, and the right to excavate for installation, replacement, repair and removal thereof; and also the right to cut, remove and otherwise keep clear any and all structures, obstructions or obstacles of whatever character, on, under and above said Facilities and Guy Wire Facilities, as applicable.

C. **PROPERTY DESCRIPTION** The easements, rights and privileges granted hereby shall apply to, and the word "Property" as used in this instrument shall mean, the following described real property situated in Shelby County, Alabama (the "Property"):

A parcel of land in the SW1/4 of Section 21, Township 22 South,
Range 2 West as is recorded in Deed Book 316 at Page 298 and
Real Book 231 at Page 115 in the office of the Judge of Probate
of Shelby County, Alabama.

D. **GENERAL** In the event it becomes necessary or desirable for the Company to move any of its Facilities in connection with the construction or improvement of any public road or highway in proximity to its Facilities, Grantor hereby grants to the Company the right to relocate its Facilities on said Property, provided, however, the Company shall relocate its Facilities at a distance no greater than ten feet (10') outside the boundary of the right of way of any such public road or highway as established or re-established from time to time. In the event that none of options 1 through 3 in Section B above are marked, then Grantor hereby grants all easements, rights and privileges described in such option 1. This grant and agreement shall be binding upon and shall inure to the benefit of Grantor, the Company and each of their respective heirs, personal representatives, successors and assigns and the words "Company" and "Grantor" as used in this instrument shall be deemed to include the heirs, personal representatives, successors and assigns of such parties.

THIS INSTRUMENT PREPARED
BY Larry Gravitt

ALABAMA POWER COMPANY

P. O. BOX 2641

BIRMINGHAM, AL 35291

TO HAVE AND TO HOLD the foregoing easements, rights and privileges to the Company, its successors and assigns, forever.

Inst # 1999-12680

SHELBY COUNTY JUDGE OF PROBATE
003 HEL
14.00
03/26/1999-12680
AM CERTIFIED

[individuals and parties in representative capacity -- indicate capacity]

IN WITNESS WHEREOF, the undersigned Grantor(s) has/have set his/her/their hand(s) and seal(s) this the _____ day of _____, 199____.

Witness

(Grantor)

Witness

(Grantor)

Witness

By: _____ (SEAL)
As:

Witness

By: _____ (SEAL)
As:

Witness

By: _____ (SEAL)
As:

Witness

By: _____ (SEAL)
As:

[corporations, partnerships, L.L.C.'s, etc. -- including in representative capacity]

IN WITNESS WHEREOF, the said Grantor, has caused this instrument to be executed by _____, its authorized representative, as of November 6th, 1998.

ATTEST (if corporation) or WITNESS:

By: Dickie Jordan
Its: Secretary

Shelby County Board of Education
(Grantor)

By: Allen Fulton (SEAL)
Its: Director of Operations
[indicate President, General Partner, Member, etc.]

ATTEST (if corporation) or WITNESS:

By: _____
Its: Secretary

By: _____ (SEAL)
Its: _____
[indicate President, General Partner, Member, etc.]

[individuals and parties in representative capacity]

STATE OF ALABAMA }

COUNTY OF Shelby }

I, the undersigned, a Notary Public, in and for said County in said State, hereby certify that Allen Fulton whose name(s) [as Director of Operations respectively] is/are signed to the foregoing instrument and who is/are known to me, acknowledged before me on this day that being informed of the contents of the instrument, he/she/they [in such capacity as aforesaid] executed the same voluntarily, on the day the same bears date.

Given under my hand and official seal, this the 9 day of November, 1998.

[SEAL]

Sharon A. Taylor
Notary Public
My commission expires: 11/26/99

[corporations, partnerships, L.L.C.'s, etc. -- including in representative capacity]

STATE OF ALABAMA }

COUNTY OF _____ }

I, the undersigned, a Notary Public, in and for said County in said State, hereby certify that _____, whose name as _____ of _____ [as _____], is signed to the foregoing instrument, and who is known to me, acknowledged before me on this day that being informed of the contents of the instrument, he/she, as such _____ and with full authority, executed the same voluntarily for and as the act of said _____ [acting in such capacity as aforesaid].

Given under my hand and official seal, this the _____ day of _____, 199____.

[SEAL]

Notary Public
My commission expires: _____

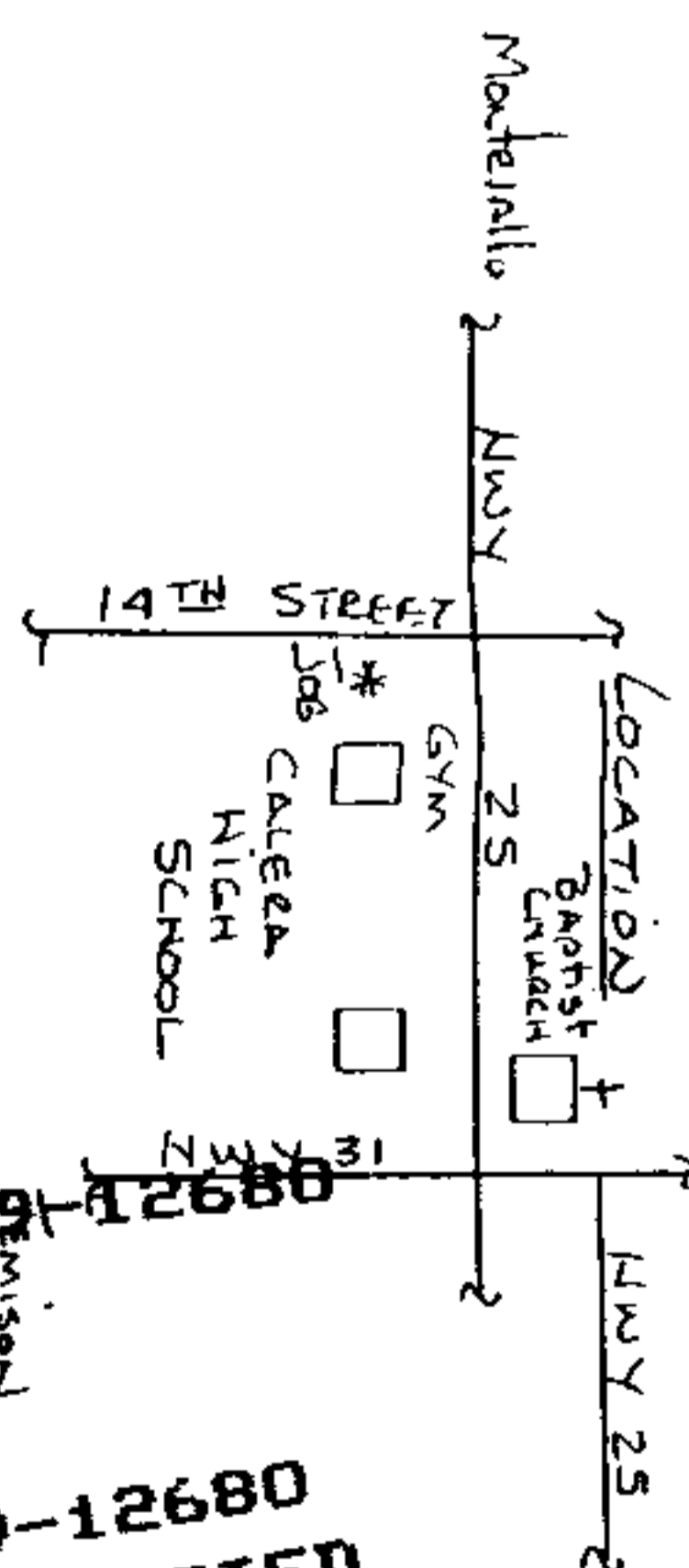

Case #1
25970
08/26/1999-12680
09:16 AM CERTIFIED
SHELBY COUNTY JUDGE OF PROBATE
003 MEL 14.00



MAP - Reference 95850 #11
Section 21 T - 22 S R - 2W cleared 11-11-95
ALABAMA POWER COMPANY

ALABAMA POWER COMPANY

CALERA HIGH SCHOOL GYM

PROVIDE 120/208 3Ø D-FPM UG

Service To Added Load in GYM

SCALE 2-5 B/M.

SHEET 1 OF 1 SHEETS

SUPREMACIES
AA - 61700-00-0658