

1150
Grant Of Land Easement By Landowner
For Use Of Alabama Power Company
In Providing Electric Service To Landowner's Premises
And Adjacent Property Of Others
To Which Service Is Being Simultaneously Extended

THIS INSTRUMENT PREPARED
BY Don Bailey
ALABAMA POWER COMPANY
P. O. BOX 2641
BIRMINGHAM, AL 35291

W.E.# 61700-00-04107

Parcel #
STA 1400 TO STA 14150

STATE OF ALABAMA

COUNTY OF SHELBY

1. KNOW ALL MEN BY THESE PRESENTS, That Landowner(s) GERALD W. Bush & WIFE,
DEBBRAH A. Bush

(the "Grantor", whether one or more) hereby applies to Alabama Power Company, a corporation (the "Company") for electrical service at 1200 CAMP BRANCH ROAD, ALABASTER, AL 35007
Grantor is the owner of the land and premises located at the above address, which by the parties are deemed to be legally described herein precisely as described and mapped in Grantor's ad valorem tax assessment for such land and premises in the office of the Tax Assessor of SHELBY County, Alabama, as if herein set out in full detail (the "Property"), and generally described as located in the following described parcel:

LOT # 7 - CAMP BRANCH ESTATES
AS RECORDED IN MAP BOOK 9,
PAGE 76

A parcel of land in the NE of the NW of Section 9,
Township 21S, Range 2W, as is recorded in 12 at 642
in the office of the Judge of Probate of SHELBY County, Alabama

2. To provide the requested electric service to Grantor (and adjacent premises of others to which service is being simultaneously extended), Company must, and may, install on the Property from time to time, some or all of the following: electric poles, electric distribution lines, service laterals, metering equipment, transformers, guys, anchors, and equipment related thereto, both above and below ground, and must, and may, accomplish the cutting and trimming of trees both now and in the future to accommodate such facilities.

3. Grantor, in consideration of (a) the construction of the necessary service facilities, (b) the furnishing of electric service at Company's published rates, and, (c) the payment of one dollar and other good and valuable consideration, the receipt of which is hereby acknowledged, hereby grants, (for himself, his heirs, successors and assigns) to Company the right to install, improve, remove, maintain, and replace, upon, over, and under the Property such of the above electric facilities as are appropriate in the opinion of Company, to provide such requested service or services, at locations on Grantor's land (and adjacent premises of others to which service is simultaneously being extended), deemed appropriate for such service or services by Company, and agreed to by Grantor at time of original extension of service or services (together with necessary and reasonable changes therein and extensions thereto to serve the property and premises of Grantor and adjacent premises described above, if any) together with all rights and privileges necessary or convenient for the full enjoyment or use thereof, including the right to clear and keep cleared all trees, undergrowth, growth on, and other obstructions, within a strip of land extending fifteen feet (15') on either side of the center line of the facilities as constructed, that would in the opinion of Company interfere with such facilities, and the right to cut all dead, weak, leaning or dangerous trees or limbs outside the said thirty foot (30') strip which, in the sole opinion of the Company, might endanger, interfere with or fall upon the poles, lines or other appliances of said Company.

Facilities to be installed under this agreement may be utilized in providing electric service to the Grantor and other Company customers located on property adjacent to the Property and with such service to adjacent property being extended and constructed simultaneously with the building of service facilities to Grantor.

The precise location on the property where the facilities are installed shall be conclusively deemed to be the location described in this grant for the placement of all such facilities. It is the intention of the parties that this grant shall be an easement on, under and over Grantor's land and shall be binding in the future on Grantor's successors, heirs and assigns.

4. Company shall have the rights of ingress and egress to and from the easement and the Property of Grantor for the purpose of installing, constructing, operating and maintaining its facilities in accordance with accepted industry standards.

In the event it becomes necessary or desirable for Company to move its lines of poles and appliances in connection with the construction or improvement of any public road or highway in proximity to its said power lines, Company is hereby granted the right to relocate its said lines of poles and appliances on lands of Grantor hereinabove described, provided, however, the said Company shall relocate its said lines of poles at a distance not greater than ten feet (10') outside the boundary of the right of way of any such public road or highway as established or re-established from time to time.

TO HAVE AND TO HOLD such easement to Company, its successors and assigns, forever.

IN WITNESS WHEREOF, WE have set OUR hand(s) and seal(s) this the 06 day of OCTOBER,
19 97.

WITNESS:

X [Signature]
X [Signature]

GRANTOR(S)

X Gerald W. Bush (SEAL)

X Deborah A. Bush (SEAL)

(SEAL)

109292/1998-34318
AN CERTIFIED

(SEAL)

SHELBY COUNTY JUDGE OF PROBATE
002 HCD 11.50

SKETCH OF PROPOSED WORK - SIMPLIFIED W.E.

Alabama Power 

Customer WAYNE BUSH		Location 1200 CAMP BRANCH RD.		Agreed Serv. Date		Estimate No. 61700-00-04107-00	
Division BIRMINGHAM		Region SOUTH		Town CAMP BRANCH		Engineer COFER	
County SHELBY		Section 9		Township 21S		Range 2W	
Acquisition Agent DDN D. BAILEY		Date R/W Assigned 7/8/97		Date R/W Cleared 10-6-97		Map Reference 2W-21-9-2	
						Contact Numbers	
						PRI	257-2005
						ALT	

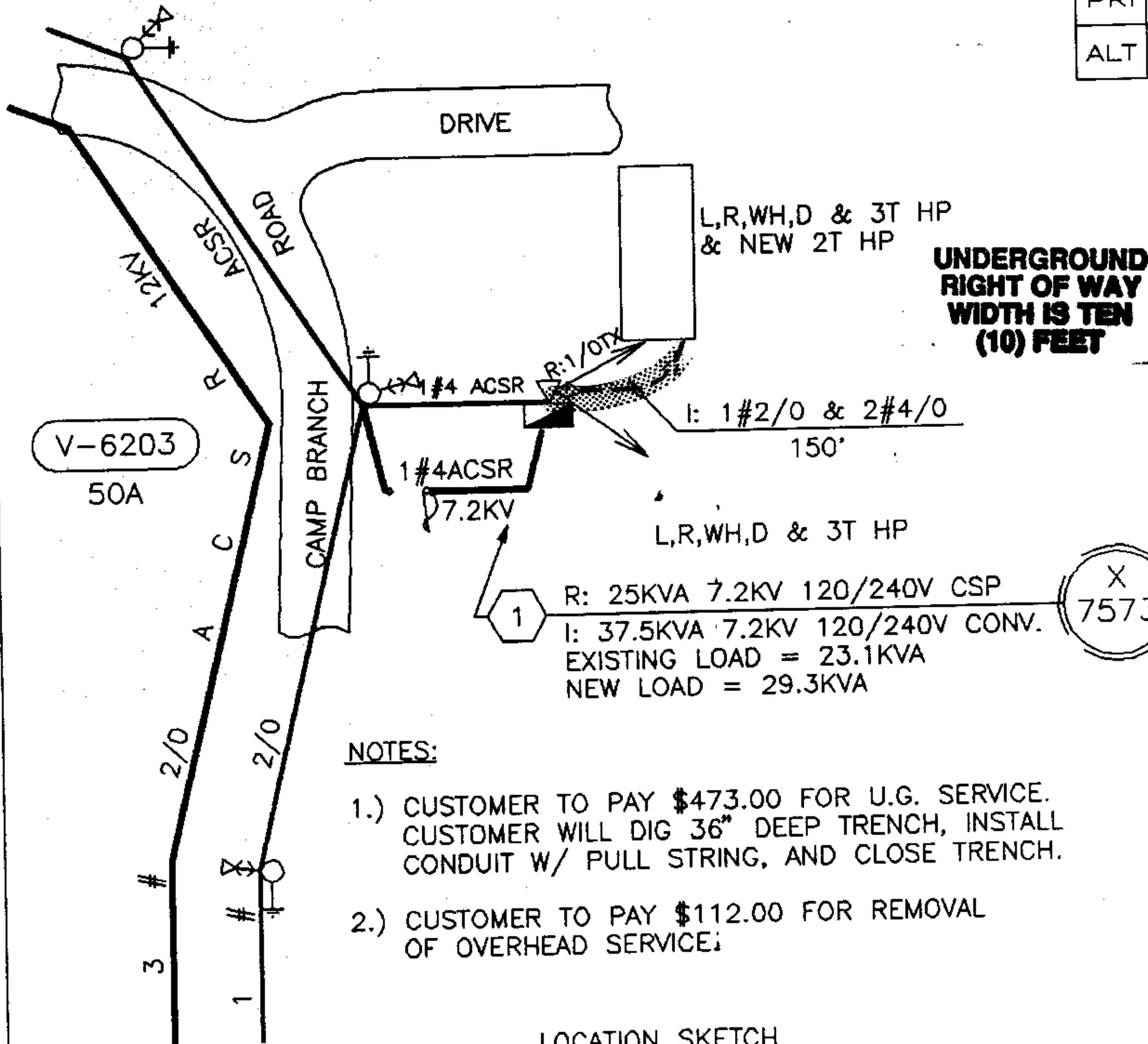

NOTES:

- 1.) CUSTOMER TO PAY \$473.00 FOR U.G. SERVICE. CUSTOMER WILL DIG 36" DEEP TRENCH, INSTALL CONDUIT W/ PULL STRING, AND CLOSE TRENCH.
- 2.) CUSTOMER TO PAY \$112.00 FOR REMOVAL OF OVERHEAD SERVICE.

LOCATION SKETCH

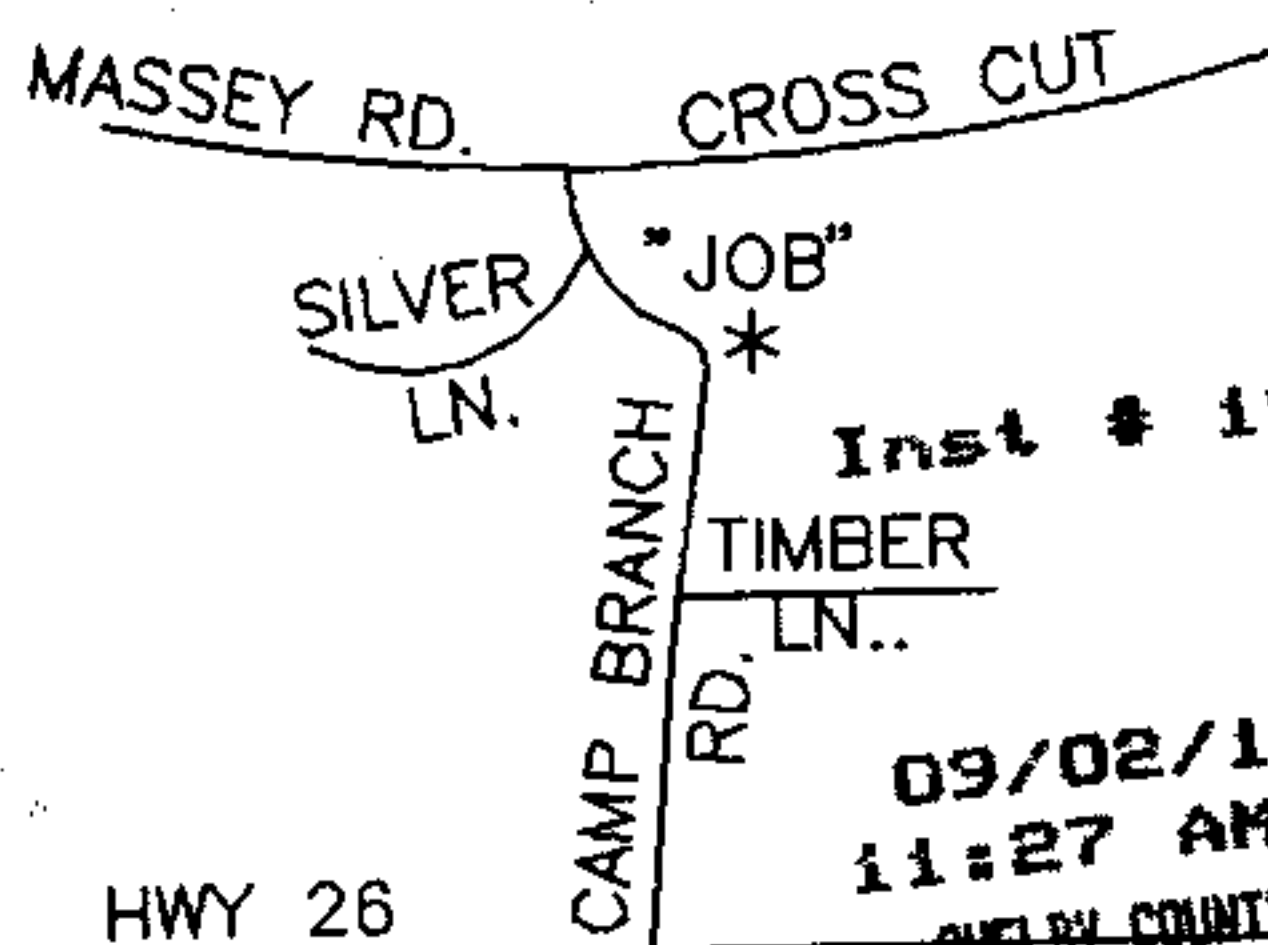

09/02/1998-34318
11:27 AM CERTIFIED
SHELBY COUNTY JUDGE OF PROBATE
002 NCD 11.50

Voltage	
Pri.	Sec.
12KV	120
	240
Phone Co.	
CATV Co.	
ACCESSIBLE	
TREW CREW	
ROCK HOLE	
PERMITS REQ'D	
R/W	
CITY	
COUNTY	
STATE	
MISSALL	
MISSALL BY DATE:	
DRAWN BY: RONN	
SCALE N.T.S. (Ft. Per Inch)	
NORTH ARROW	
	
Date:	