



COUNTY COMMISSION  
SHELBY COUNTY  
P. O. Box 467  
COLUMBIANA, AL 35051

MEMBERS  
DIST. 1. BILLY THOMPSON  
2. GEORGE DAILEY  
3. MICHELE GEORGE  
4. DANIEL M. ACKER  
5. W. PAUL YEAGER  
6. LARRY DILLARD  
7. LINDSEY ALLISON  
8. TED CROCKETT  
9. DON ARMSTRONG

June 4, 1998

Mayor Steve Rauch  
Alabaster City Hall  
P.O. Box 277  
Alabaster, AL 35007

RE: Annexation of SWCP

Dear Mayor Rauch:

The Shelby County Commission petitions the City of Alabaster for the annexation of the following property:

All County owned land North of the 19, 30 Section Line; Township 21 South Range 2 West and West of I-65. This is an area of approximately 44 acres and containing future industrial sites in the Shelby West Corporate Park and future hanger sites on the Shelby County Airport.

With this annexation, all property in Shelby West Corporate Park will be within the corporate limits of the City of Alabaster.

Enclosed is a legal description of the same and a map showing the property in question. Please call either me or Todd McDonald at 620-6620 if you have any questions.

Sincerely,

*Alex Dudchock*  
Alex Dudchock,  
County Manager

AD/rc

Enclosures

cc: Shelby County Commission  
Butch Ellis, Shelby County Attorney  
Jeff Pruitt, Director of Planning and Development  
Todd L. McDonald, Chief Planner  
Jimmy Gould, City Administrator  
Johnny Sarris, Council President

Inst # 1998-29225

07/31/1998-29225  
10:56 AM CERTIFIED

ALEX DUDCHOCK ♦ COUNTY MANAGER ♦ TELEPHONE (205) 669-3864  
SHELBY COUNTY IS AN EQUAL OPPORTUNITY EMPLOYER

JUDGE OF PROBATE  
13.50

*Ordinance  
98-008  
Adopted  
6-18-98  
Councilman  
Dennis Risher*

Inst # 1998-29225

**SHELBY WEST CORPORATE PARK  
ANNEXATION LEGAL DESCRIPTION**

**STATE OF ALABAMA  
SHELBY COUNTY**

COMMENCE AT THE SOUTHEAST CORNER OF SECTION 19, TOWNSHIP 21 SOUTH, RANGE 2 WEST AND RUN IN A WESTERLY DIRECTION ALONG THE SOUTH LINE OF SAID SECTION A DISTANCE OF 1157.53 FEET TO THE POINT OF INTERSECTION OF SAID SECTION LINE WITH THE WESTERLY RIGHT-OF-WAY OF INTERSTATE 65 AND THE POINT OF BEGINNING OF THE HEREIN DESCRIBED PARCEL; THENCE CONTINUE ALONG THE LAST DESCRIBED COURSE ALONG SAID SECTION LINE IN A WESTERLY DIRECTION A DISTANCE OF 1507.07 FEET TO A POINT AT THE INTERSECTION OF SAID SECTION LINE WITH THE CITY LIMIT LINE OF THE TOWN OF ALABASTER, ALABAMA; THENCE DEFLECT  $90^{\circ}36'29''$  TO THE RIGHT AND RUN IN A NORTHERLY DIRECTION ALONG SAID CITY LIMIT LINE A DISTANCE OF 397.25 FEET TO A POINT; THENCE DEFLECT  $30^{\circ}36'29''$  TO THE LEFT AND RUN IN A NORTHWESTERLY DIRECTION ALONG SAID CITY LIMIT LINE A DISTANCE OF 1087.66 FEET TO A POINT; THENCE DEFLECT  $120^{\circ}00'00''$  TO THE RIGHT AND RUN IN AN EASTERLY DIRECTION ALONG SAID CITY LIMIT LINE A DISTANCE OF 1523.77 FEET TO A POINT AT THE INTERSECTION OF SAID CITY LIMIT LINE AND THE WESTERLY RIGHT-OF-WAY OF INTERSTATE 65; THENCE DEFLECT  $70^{\circ}54'59''$  TO THE RIGHT TO THE TANGENT OF A CURVE OF SAID RIGHT-OF-WAY HAVING A CENTRAL ANGLE OF  $2^{\circ}36'40''$  AND A RADIUS OF 8744.37 FEET, AND CONTINUE ALONG THE ARC OF SAID RIGHT-OF-WAY CURVE A DISTANCE OF 398.52 FEET TO THE ENDING POINT OF SAID CURVE; THENCE FROM THE TANGENT OF THE LAST DESCRIBED CURVE DEFLECT  $00^{\circ}00'18''$  TO THE RIGHT TO CONTINUE ALONG SAID RIGHT-OF-WAY A DISTANCE OF 1039.23 FEET, MORE OR LESS, TO THE POINT OF BEGINNING, CONTAINING 43.94 ACRES, MORE OR LESS.

**SHELBY WEST CORPORATE PARK LEGAL**

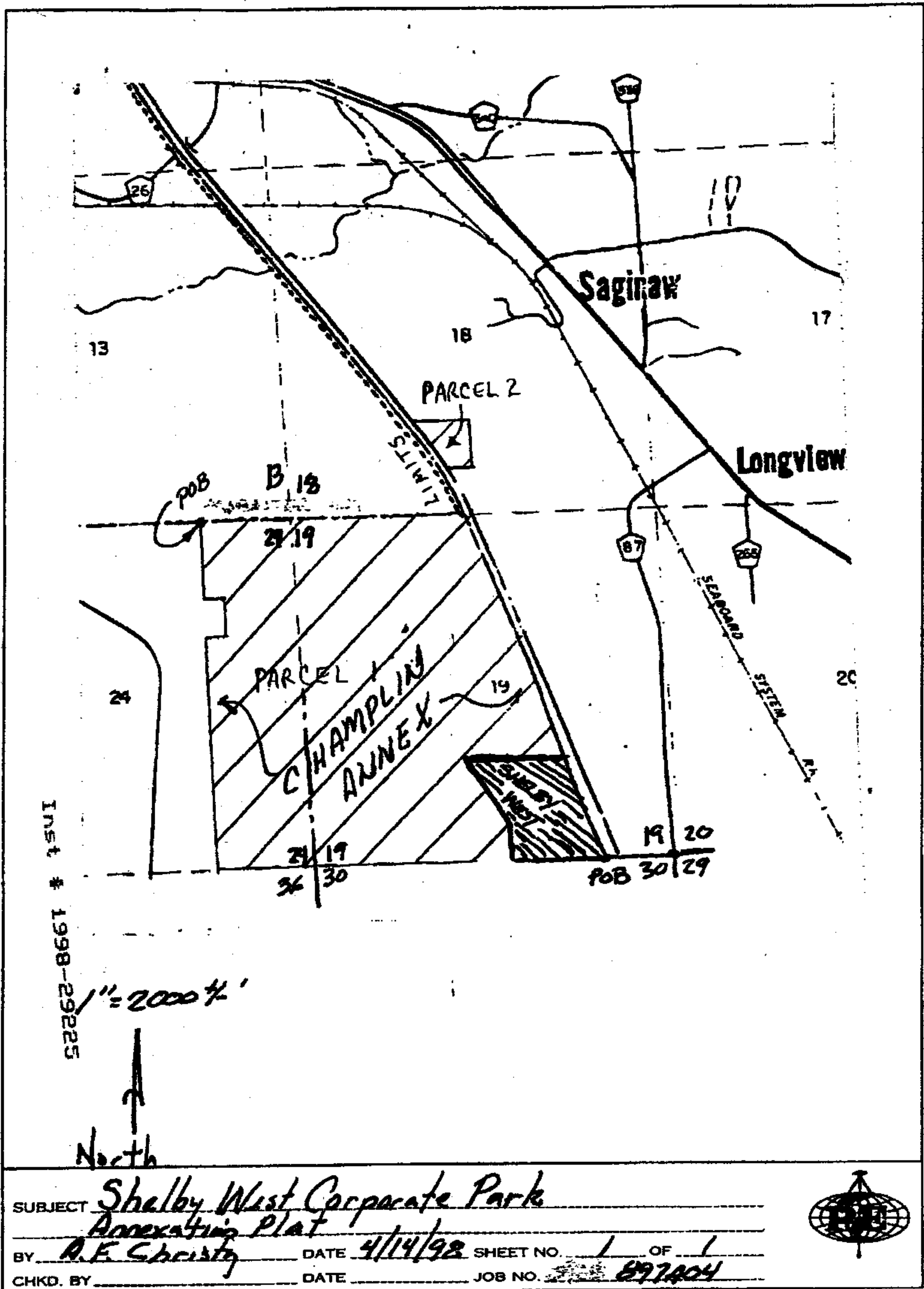

Inst # 1998-29225

07/31/1998-29225  
10:56 AM CERTIFIED  
SHELBY COUNTY JUDGE OF PROBATE  
003 MCD 13.50

SUBJECT Shelby West Corporate Park  
Annexation Plat  
BY R.E. Christy DATE 4/14/98 SHEET NO. 1 OF 1  
CHKD. BY \_\_\_\_\_ DATE \_\_\_\_\_ JOB NO. 897404

