

STATE OF ALABAMA
COUNTY OF SHELBY

X
X
X

THIS INDENTURE made and entered into on this the _____ day of _____, 19 __, by and between _____ Robert E. & Janet A. Kirkland P.O. Box 212 Alabaster, AL 35007 hereinafter called Grantors; and the _____ City of Alabaster, _____ Alabama hereinafter called the Grantee.

Inst # 1998-29201
07/31/1998-29201
10:56 AM CERTIFIED
SHELBY COUNTY JUDGE OF PROBATE
004 MCD 17.00

W I T N E S S E T H:

WHEREAS, it has been found to provide the necessary utilities to certain areas lying within the _____ City of Alabaster _____ service area, _____ Shelby _____ County, Alabama; that it has been found necessary to cross certain lands owned by the Grantors for the purpose of installing all necessary pipelines and other such integral parts of the utility;

WHEREAS, it has been found advantageous and to the best interest of Grantors and Grantee that an easement for such utility be conveyed to the _____ City of Alabaster _____.

THEREFORE, in consideration of the sum of _____ and the mutual benefits accruing to the Grantors and to the _____ City of Alabaster _____, _____ Shelby _____ County, Alabama, the Grantors have this day bargained and conveyed and by these presents do hereby grant and convey unto the _____ City of Alabaster _____, _____ Shelby _____ County, Alabama, the following right, privilege and easement, in, to, along, over, through, under and across the hereinafter described lands:

The right and privilege to construct, erect, install, operate and maintain a _____ sanitary sewer line _____, on, upon, along, over, through, under and across the hereinafter described lands;

The right, privilege and easement to cut, trim and remove any brush, trees, or other obstructions upon the hereinafter described lands, together with the right of ingress and egress to and from, over and above the hereinafter described lands, for the purpose of the installation and upkeep of the utility.

(DESCRIPTION)

Shelby County Property Tax Records

=====

13-7-35-1-001-032.001

KIRKLAND ROBERT L & JANET A

A 20' WIDE PERMANENT SANITARY SEWER EASEMENT LYING 10' EACH SIDE OF THE CENTERLINE OF THE SANITARY SEWER PIPELINE, LOCATED AS SHOWN ON ATTACHED DRAWING OR AS SANITARY SEWER PIPELINE IS CONSTRUCTED.

ALSO, 20' WIDE TEMPORARY CONSTRUCTION EASEMENTS LYING ADJACENT TO AND PARALLEL WITH BOTH SIDES OF THE ABOVE DESCRIBED PERMANENT EASEMENT.

THE ABOVE DESCRIBED TEMPORARY CONSTRUCTION EASEMENTS SHALL REVERT TO THE OWNER OF THE ABOVE SAID PARCEL OF LAND UPON COMPLETION OF CONSTRUCTION AND ACCEPTANCE OF THE SANITARY SEWER PIPELINE BY THE CITY OF ALABASTER.

OK if TAP is left for Lot

TO HAVE AND TO HOLD the above described right, privilege and easements unto the City of Alabaster, Alabama and to its assigns, together with the right of entry and reentry from time to time as occasion may require for the purpose of exercising its said rights, privileges and easements, hereinabove described.

IN WITNESS WHEREOF, we, _____

have hereunto set our hands and seals on this day and year first above written.

Robert E. Kirkland

(WITNESS) (SEAL) X

Janet A. Kirkland

(WITNESS) (SEAL) X

(WITNESS) (SEAL)

(WITNESS) (SEAL)

(WITNESS) (SEAL)

(WITNESS) (SEAL)

STATE OF ALABAMA

X

X

COUNTY OF SHELBY

X

I, the undersigned Notary Public, in and for said County in
said State, hereby certify that Robert E. & Janet A. Kirkland

whose names are signed to the foregoing Easement and who are known
to me, acknowledged before me on this day, that being informed of
the contents of this Easement, have executed the same
voluntarily on the day the same bears date.

GIVEN under my hand this the 22nd day of December,
1997.

Andrea L. Jones

NOTARY PUBLIC

(SEAL)

MY COMMISSION EXPIRES MAY 22, 2000

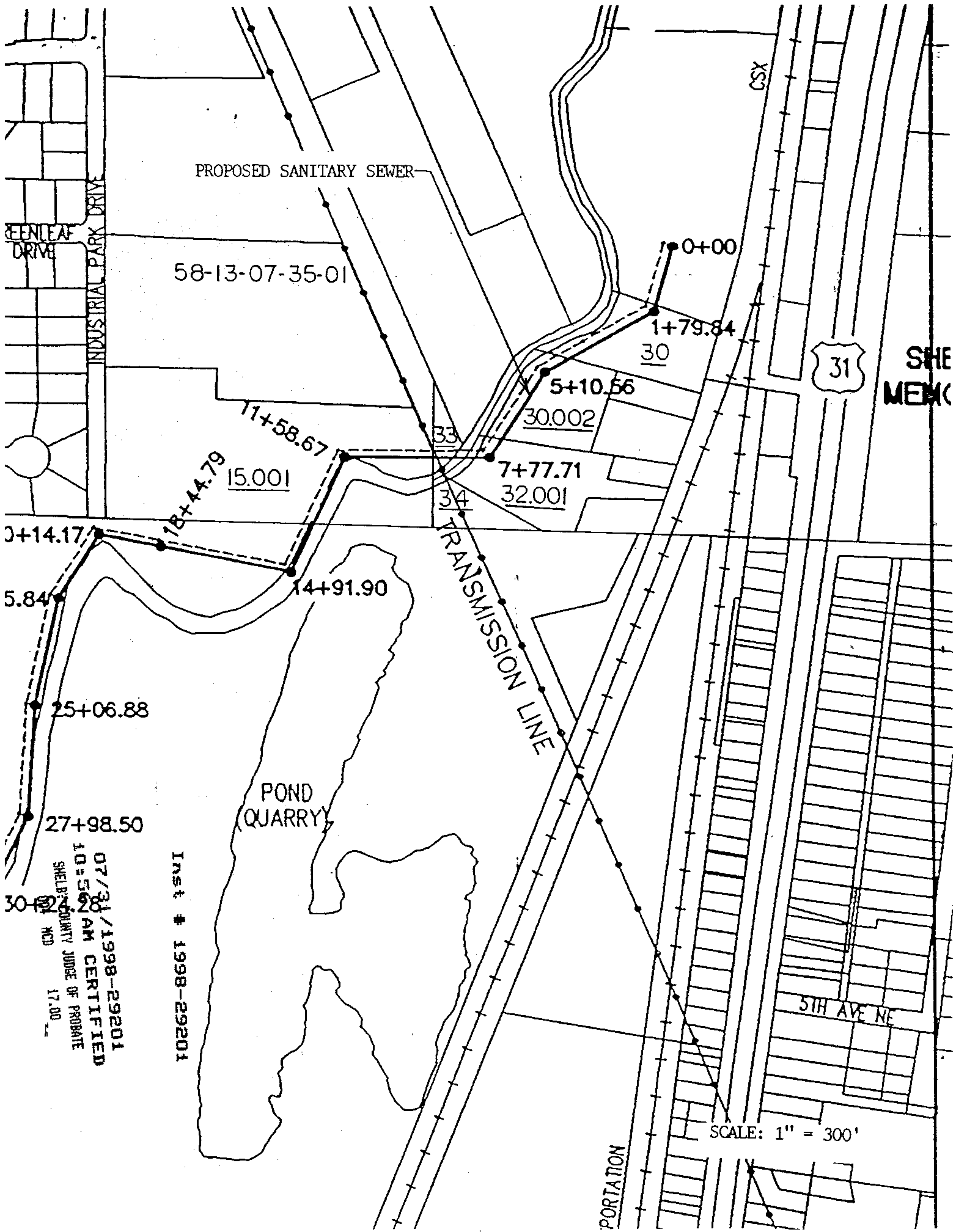

PROPOSED SANITARY SEWER

58-13-07-35-01

CSX

31

SHE
MEM

TRANSMISSION LINE

POND
(QUARRY)

5TH AVE NE

SCALE: 1" = 300'

PORTATION

Inst # 1998-29201

07/31/1998-29201
10:56 AM CERTIFIED
SHELBY COUNTY JUDGE OF PROBATE
NCD 17.00