

Inst # 1998-21395

06/09/1998 21395

03:26 PM CERTIFIED  
A UTILITY EASEMENT OF PROBATE  
SHELBY COUNTY, ALABAMA

002 SNA 12.00

FOR THE CONSTRUCTION, OPERATION, AND MAINTENANCE

OF UTILITIES

BY THE CITY OF CALERA, ALABAMA

This Easement, executed this 1st day of June, 1998, for the construction, operation, and maintenance of utilities, with appurtenances by the City of Calera, across the property of the LANDOWNER, I-65 INVESTMENT PROPERTY, located in Section 31, Township 21 South, Range 2 West, in Shelby County, Alabama, as shown on the Attached Sketch, is granted by the LANDOWNER to the City of Calera (the "City") for valuable considerations, the receipt and sufficiency of which are acknowledged by the LANDOWNER, for itself, and its successors and assigns.

A permanent easement, to go with land, to allow the CITY, its employees and agents to construct, operate, repair, and maintain the CITY's utility lines, including the right of access by the CITY, its employees and agents, or officials, and necessary related equipment. Included is the right to uncover the utility lines, with the obligation to leave the LANDOWNER'S property in substantially the same condition after completion of construction or repair to the utility lines.

The easement is described, as follows:

DESCRIPTION

Commence at an iron pin found at the Southwest corner of the Southeast quarter of the Northeast quarter of Section 31 Township 21 South, Range 2 West, Shelby County, Alabama; thence Northerly along the quarter-quarter line 329.51 feet to an iron pin; thence right 92° 53' 49", 1579.93 feet to the point of beginning and the center line of a 25 feet wide utility easement; thence 126° 19' 38", left, 62.24 feet; thence right 38° 15' 54", 916.96 feet; thence right 33° 12' 49", 177.00 feet plus or minus to the Southern Right-of-way of Shelby County Highway 12 and the end of said easement.

*Landowner reserves the right to relocate sewer lines at Landowners expense.*

Executed the date shown above in four copies.

LANDOWNER:

By: Mark Clayton

Title: owner

For the City of Calera

By: George W. Roy

George W. Roy, Mayor

WITNESS:

By: [Signature]

Title: \_\_\_\_\_

ATTEST: \_\_\_\_\_

By: Linda Steele

Linda Steele City Clerk

Recorded the \_\_\_\_\_ day of \_\_\_\_\_, 19\_\_\_\_, in Deed Book \_\_\_\_\_ Page \_\_\_\_\_, of public records of Shelby County, Alabama.

Inst # 1998-21395

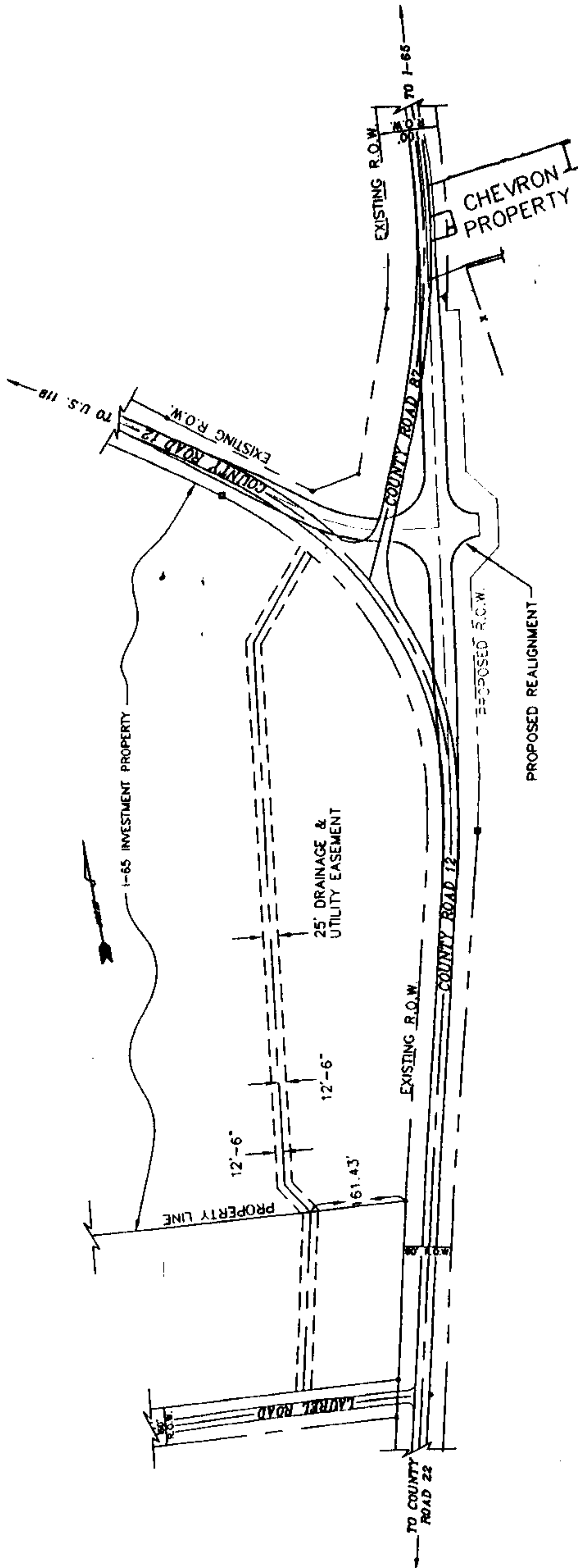

06/09/1998-21395  
03:26 PM CTRIFIED  
SHELBY COUNTY JUDGE OF PROBATE  
PAGE 2