

STATE OF ALABAMA

SHELBY COUNTY

KNOW ALL MEN BY THESE PRESENTS, that for and in consideration of the sum of One Dollar (\$1.00) and other good and valuable consideration, in hand paid by the City of Pelham, Alabama, a municipal corporation, to the undersigned grantor(s), the receipt whereof is hereby acknowledged, I (we) the undersigned do hereby grant, bargain, sell and convey to the City of Pelham, Alabama a utility easement thirty feet (30') in width.

Easement is shown on attached Exhibit "A".

The City of Pelham agrees that following any construction within the easement, the City will restore the ground to its original contour and seed with grass. In lawn areas, restoration will be done with the same type grass as removed.

The City further agrees that a sewer tap will be placed in the gravity flow line at a location chosen by the property owner. The property shall be exempt from any sewer tap charge. ~~4.25~~ No monthly service charges shall be applicable until a structure is connected to the sewer line. The City's mandatory connection and payment regulation is hereby waived.

TO HAVE AND TO HOLD the said easement hereinafter granted to the said City of Pelham, Alabama, its successors and assigns.

IN WITNESS WHEREOF, we have hereunto set our hands and seal(s) this 5 day of September, 1997.

For the City of Pelham, Alabama

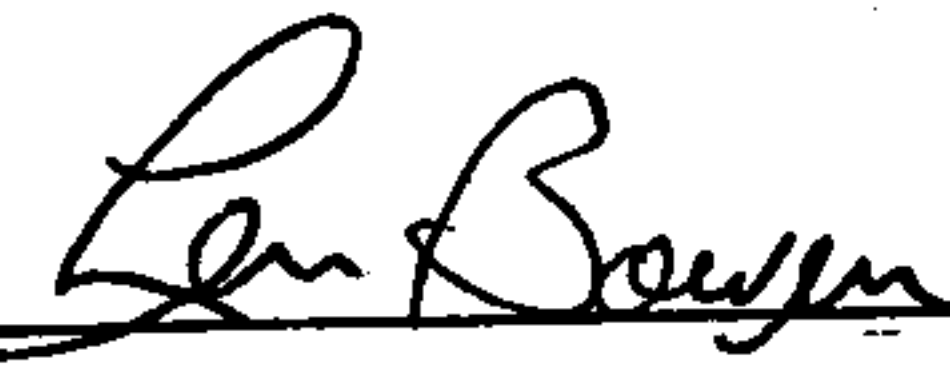

LEN BOWEN
104 Brookshire Lane
Pelham, AL 35124

Inst # 1997-37731

11/19/1997-37731
11:14 AM CERTIFIED
SHELBY COUNTY JUDGE OF PROBATE
003 MCD 14.50

Inst # 1997-37731

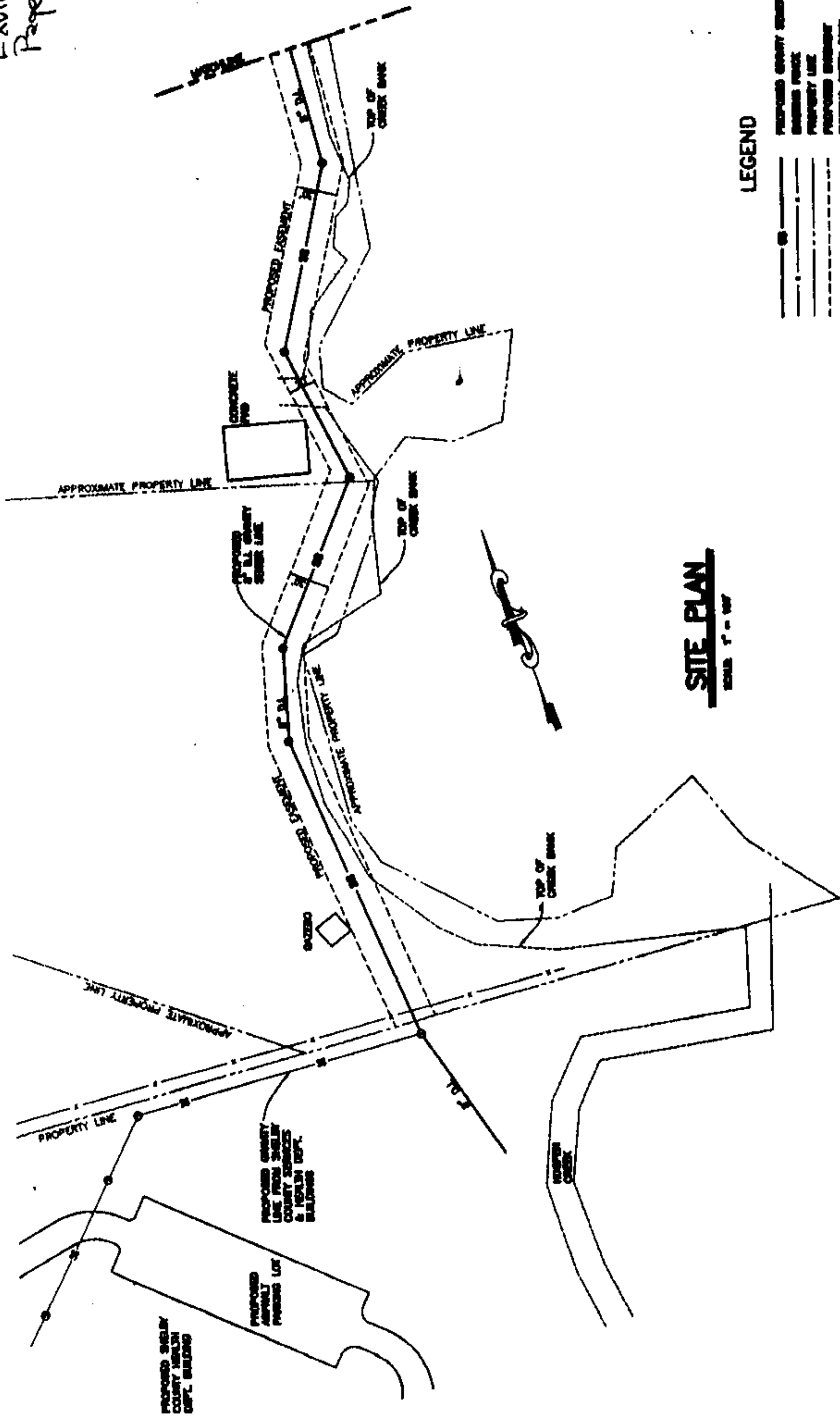
Exhibit A
Page 1 of 2



LEGEND

 •

POLICE COUNTY STATE
SHERIFFS OFFICE
PROPERTY LINE
POLICE DEPARTMENT
COUNTY CLERK'S OFFICE
STATE ATTORNEY

SITE PLAN

**DRAWING FOR EASEMENT
PURPOSES ONLY**

[illegible]

PAYROLL SECURITY TAX

EMPLOYER SHARE

PROPERTY TAX

PAYROLL DEDUCTION

STANDARD COST BOOK

SOME SAMPLES

**DRAWING FOR EASEMENT
PURPOSES ONLY**

Inst # 1997-37731

11/19/1997-37731
11:14 AM CERTIFIED
JELLY COUNTY JUDGE OF PROBATE
14.50