

ORDINANCE NO. 97-1551

An ordinance to alter, rearrange and extend the corporate limits of the City of Hoover, Alabama, so as to embrace and include within the corporate limits of said City all territory now within such corporate limits and also certain other territory contiguous to said City.

WHEREAS, a petition signed by Henry H. and Freida Louise Caldwell requesting that certain territory described therein be annexed to the City of Hoover, and

WHEREAS, there is attached to the said petition a map of said territory showing its relationship to the corporate limits of the City; and

WHEREAS, this Council has determined and found that the matters set forth and alleged in the said petition are true and that it is in the public interest that said property be annexed into the City of Hoover;

NOW, THEREFORE, be it ordained by the Council of the City of Hoover as follows:

SECTION 1: That said Council hereby assents to the annexation of said territory to the City of Hoover, Alabama, and the corporate limits of the City of Hoover are hereby extended and rearranged pursuant to the provisions of Chapter 42, Article 2, Code of Alabama, 1975 (Sections 11-42-20 through 11-42-23, as amended) so as to embrace and include said territory, in addition to the territory already within its present corporate limits, within the corporate area of said City, which said territory is not within the corporate limits or municipal boundaries of another municipality and does not lie at any point more than one-half the distance between the present corporate limits or municipal boundaries of another municipality and does not lie at any point more than one-half the distance between the present corporate limits and the corporate limits of any other municipality. Said property is described in Exhibit "A" attached hereto and made a part hereof.

SECTION 2: The City Clerk shall file a certified copy of this ordinance containing an accurate description of said annexed territory with the Probate Judge of Shelby County, Alabama, and also cause a copy of this ordinance to be published in a newspaper of general circulation in the City of Hoover.

ADOPTED this the 21st day of April, 1997.

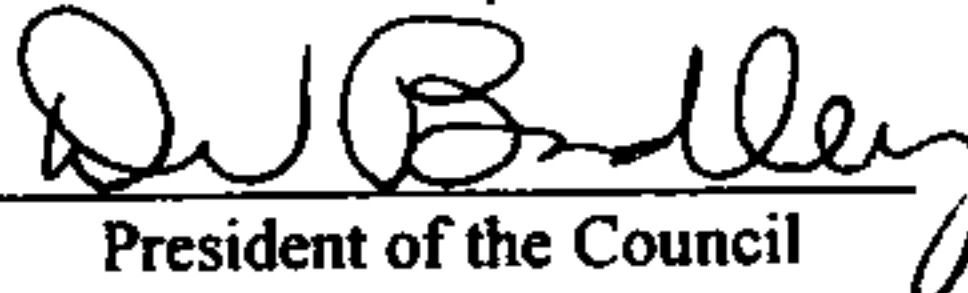
President of the Council

APPROVED BY:

Mayor

ATTESTED BY:

City Clerk

Inst # 1997-31212

09/29/1997-31212
08:28 AM CERTIFIED
SHELBY COUNTY JUDGE OF PROBATE
006 MCD 21.00

Inst # 1997-31212

EXHIBIT "A"

1005 Riverchase Parkway West

Begin 840 feet west of NE corner of NE 1/4 of the NE 1/4 of Section 35, Township 19 South, Range 3 West, thence East on Section Line 200 feet, thence South 254.6 feet, thence West 147.4 feet, thence Northwesterly on road 260 feet to the Point of Beginning.

CLERK'S CERTIFICATION

I, Linda Crump, City Clerk for the City of Hoover, Alabama, hereby certify that the attached is a true and correct copy of Ordinance No. 97-1551 which was adopted by the City Council of the City of Hoover, Alabama, on the 21st day of April, 1997.

Linda Crump
City Clerk

RECEIVED

MAR 20 1997

CITY OF HOOVER

STATE OF ALABAMA

SHELBY COUNTY

We, the undersigned, hereby request and petition the City of Hoover to take whatever action is necessary to cause our property to be annexed into the corporate limits of the City of Hoover.

NAME

ADDRESS

(Signature of Owners)

Henry H. Caldwell
Frederic Lawrence Caldwell

1005 Riverchase PKWY - W
1005 Riverchase PKWY - W

Number of occupants: 3 Ages of all children _____

Phone No. (H) 988-3993 ~~xxx~~ 669-6615

LEGAL DESCRIPTION:

BEG 840' W/O NE COR NE 1/4 NE 1/4 SEC 35
T19S R3W TH E ON SEC LN 200' TH S
254.6' W 147.4' TH NWLY ON RD 260'
TO POB S35 T19S R03W
DIM 260.00 x 200.00

CLERK'S CERTIFICATION

I hereby certify that the attached is a true and correct copy of a petition(s) presented to the City Council of the City of Hoover by persons whose Name(s) appear thereon, requesting that their property be annexed to the City of Hoover.

Linda Crump, CMC
City Clerk

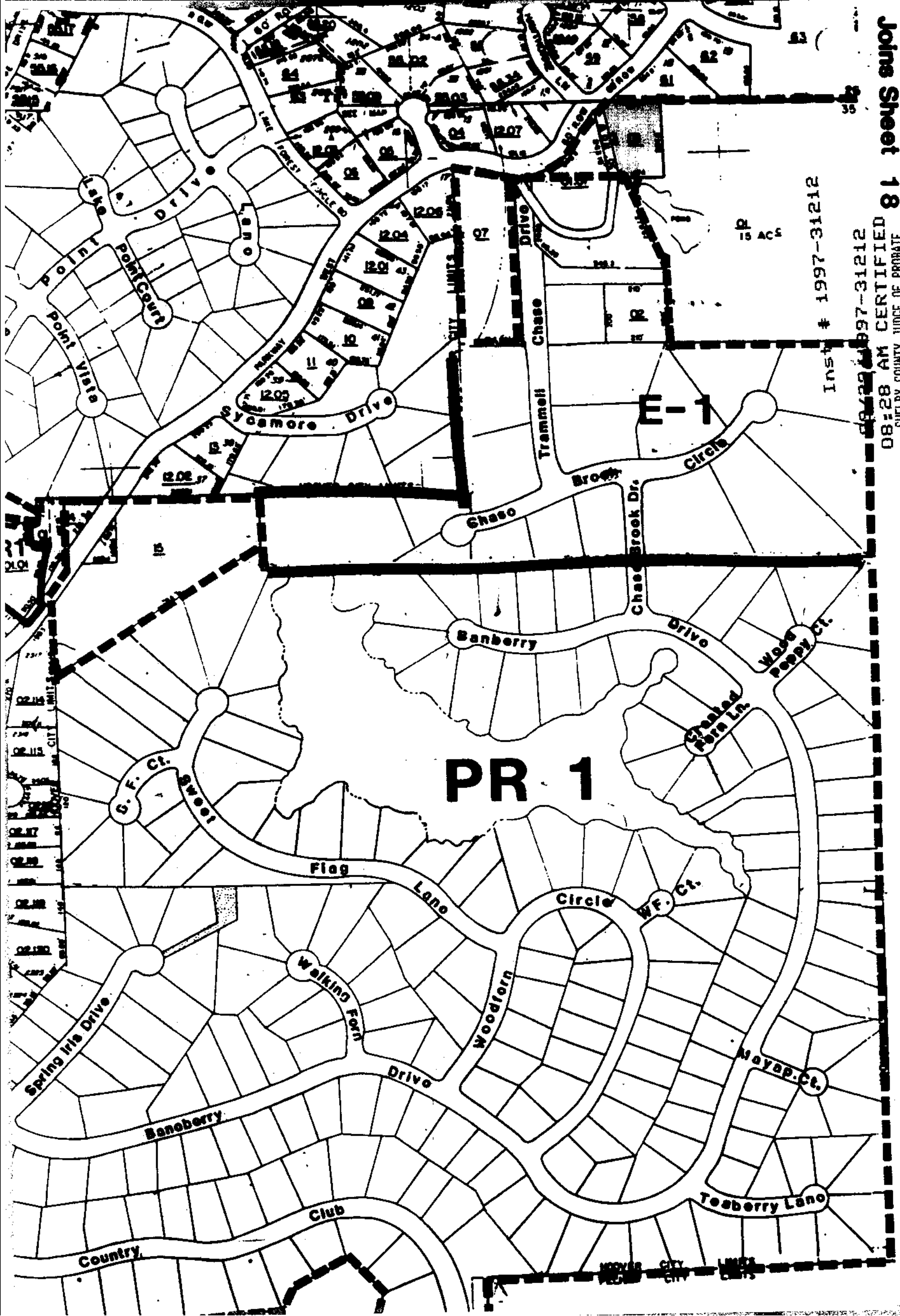

Inst # 1997-31212

PR 1997-31212

08:28 AM CERTIFIED
SHELBY COUNTY JUDGE OF PROBATE

• 006 MCD 21.00

Join Sheet 18 81 Joiner