

ORDINANCE NUMBER 518-96

**AN ORDINANCE TO ALTER, REARRANGE AND EXTEND
THE CORPORATE LIMITS OF THE CITY OF HELENA,
ALABAMA, SO AS TO EMBRACE AND INCLUDE WITHIN
THE CORPORATE AREA OF SAID CITY ALL TERRITORY
NOW WITHIN SUCH CORPORATE LIMITS AND ALSO
CERTAIN OTHER TERRITORY CONTIGUOUS TO SAID CITY.**

Inst # 1997-16010

WHEREAS, a petition signed by the owners of all of the land within the territory therein described and proposed to be annexed to the City, together with a map of said territory showing its relationship to the corporate limits of the City, has been filed with the City Clerk of the City of Helena; and

WHEREAS, this Council has determined and found that the matters set forth and alleged in said petition are true, and that it is in the public interest that said property be annexed to the City of Helena;

NOW, THEREFORE, BE IT ORDAINED by the Council of the City of Helena as follows:

Section 1. That said Council and the City of Helena hereby assent to the annexation of said territory to the City of Helena, Alabama, the corporate limits of the City to be extended and rearranged pursuant to the provisions of Chapter 42, Article 2, Code of Alabama 1975 (Sections 11-42-20 through 11-42-23, as amended) so as to embrace and include said territory in addition to the territory already within its present corporate limits, within the corporate area of said City, which said territory is not within the corporate limits of another municipality and the new boundary line does not lie at any point more than half the distance between the old city boundary and the corporate boundary of any municipality. Said territory is described as follows:

The East 37-1/2 feet of the West 75 feet of Parcel Number 06.01 (16 ac.) situated in the SW 1/4 of the NE 1/4 of Section 19, Township 20 South, Range 3 West, Shelby County, Alabama

(See Attached Exhibit A)

The East 330 feet of the West 660 feet of the NE 1/4 of the NE 1/4 of Section 27, Township 20 South, Range 4 West, Shelby County, Alabama.

(See Attached Exhibit B)

Section 2. That the City Clerk shall file a certified copy of this ordinance containing an accurate description of said annexed territory with the Probate Judge of Shelby County, Alabama, and also cause a copy of this ordinance to be posted in three (3) public places in the City of Helena.

Inst # 1997-16010

05/22/1997-16010
11:12 AM CERTIFIED
SHELBY COUNTY JUDGE OF PROBATE
005 MEL 18.50

STATE OF ALABAMA
SHELBY COUNTY

I, Frances Parrish, City Clerk of the City of Helena, do hereby certify that the above is a true correct copy of an ordinance duly adopted by the Council of the City of Helena at its meeting held November 18 1996, and as same appears of record in the ordinance records of said City, and approved by the Mayor on November 18, 1996.

Given under my hand and corporate seal of the City of Helena, this the 18 day of November, 1996.

Frances Parrish
City Clerk

CERTIFICATION

I, Frances Parrish, the duly appointed and acting Clerk of the City of Helena, Alabama, do hereby certify that the within Ordinance Number 518-96 is a true copy as recited in the said City Clerk's Minute Book and posted by me as provided by law in three public places in said City, being on the bulletin board of the City Hall, in the United States Post Office in the City of Helena, and in the Helena Public Library in said City, that said Ordinance shall become a duly lawful Ordinance of said City on the 25 day of November, 1996, five or more days after the posting of the same as provided by law.

IN WITNESS WHEREOF, I have hereunto set my hand and seal on this the 18 day of November, 1996.

City Clerk

EXHIBIT A

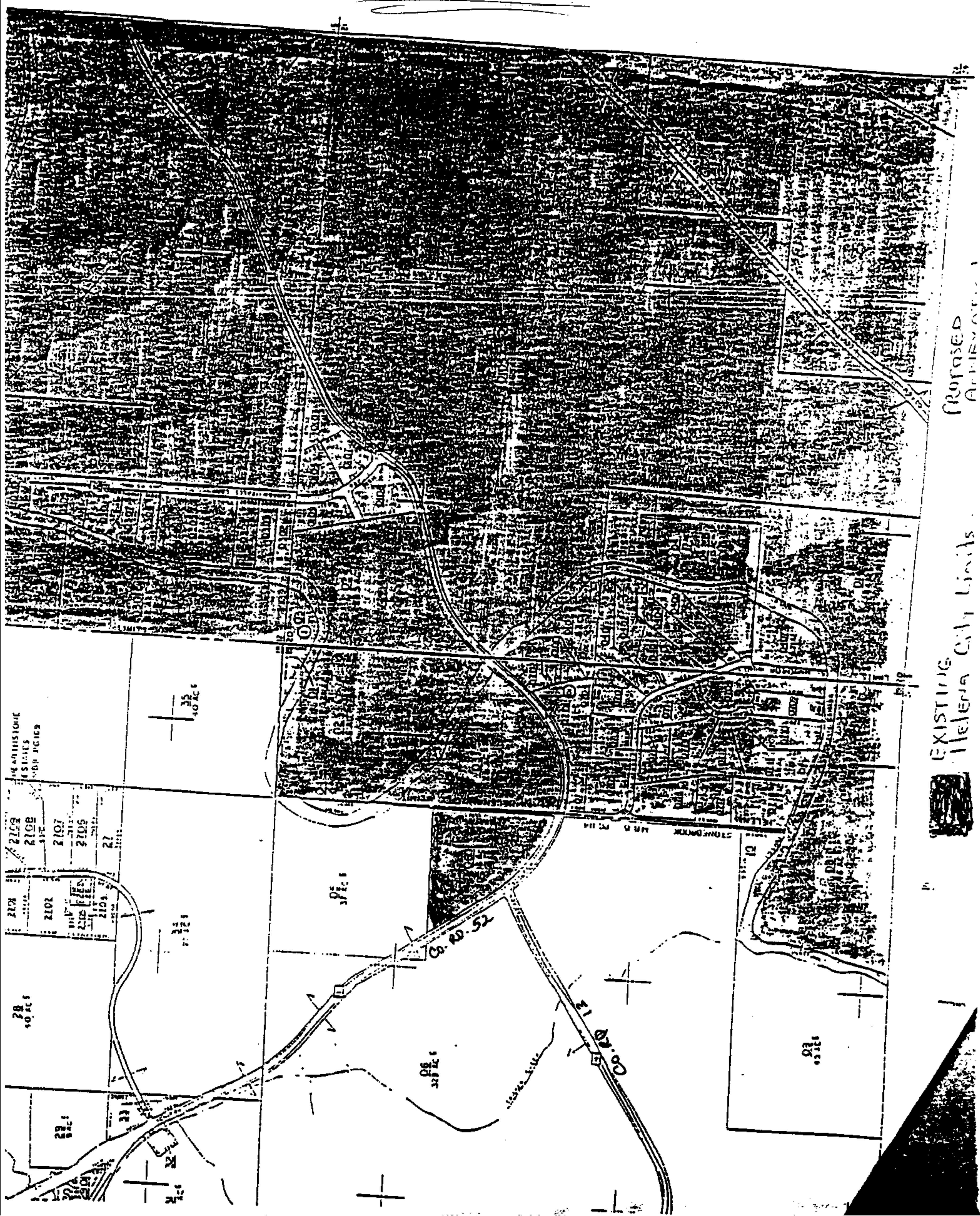

EXISTING
HELENA CITY
LIMITS

PROPOSED ANNEXATION



1

E

005 MEL 10:20