

ORDINANCE NO.96-11

WHEREAS, on the 28th day of August, 1996, Concord Baptist Church filed a petition with the City Clerk of the City of Calera, Alabama, as required by 11-42-20 and 11-42-21, Code of Alabama 1975, as amended, petitioning and requesting that the property hereinafter described be annexed to the municipality of the City of Calera, Alabama, which petition contained an accurate description of the property proposed to be annexed together with a map of the said property showing its relationship to the corporate limit of the City of Calera, Alabama, and the signatures;

NOW, THEREFORE, BE IT ORDAINED BY THE CITY COUNCIL OF THE CITY OF CALERA, AS FOLLOWS:

Commence at the Northwest corner of the NE1/4 of Section 4, Township 22 South, Range 2 West; thence Easterly along the North section line to the northerly Right-of-Way of County Road 22 and point of beginning; thence Northeasterly along the Right-of-Way 1066.26 feet; thence left 150 deg. 21 feet 59 inches, 308.88 feet; thence left 16 deg. 15 ft 00 inches, 478.00 feet; thence right 20 deg. 24 ft. 20 inches to the Eastern Right-of-Way line of the CSX Railroad; thence Southerly along the Right-of-Way to the North Right-of-Way of County Road 22; thence Northeasterly along the Right-of-Way to the point of beginning.

1. That the City of Calera, Alabama, does adopt this Ordinance assenting to the annexation of the following described property to the municipality of the City of Calera:

2. That the corporate limits of the City of Calera, Alabama, be extended and rearranged so as to embrace and include such property, and such property shall become a part of the corporate area of such municipality upon the date of publication or posting of this Ordinance, as provided for in the Code of Alabama as cited above.

09/11/1996-29907
09:03 AM CERTIFIED
SHELBY COUNTY JUDGE OF PROBATE
006 HEL 21.00

3. That the City Clerk be and she is hereby authorized and directed to file a copy of this ordinance, including an accurate description of the property being annexed, together with a map of the said property showing its relationship to the corporate limits of the City of Calera, Alabama, to which said property is being annexed in the office of the Judge of Probate of Shelby County, Alabama

4. That the Zoning Map of the City of Calera, Alabama, and any other official maps or surveys of the City shall be amended to reflect the annexation of the above described property, and that a copy of this Ordinance be transmitted to the City Planning commission and the Zoning Administrator.

5. That this property is a part of Election District 2.

This ordinance was adopted and passed by the City Council of the City of Calera, Alabama, this 3rd day of September, 1996

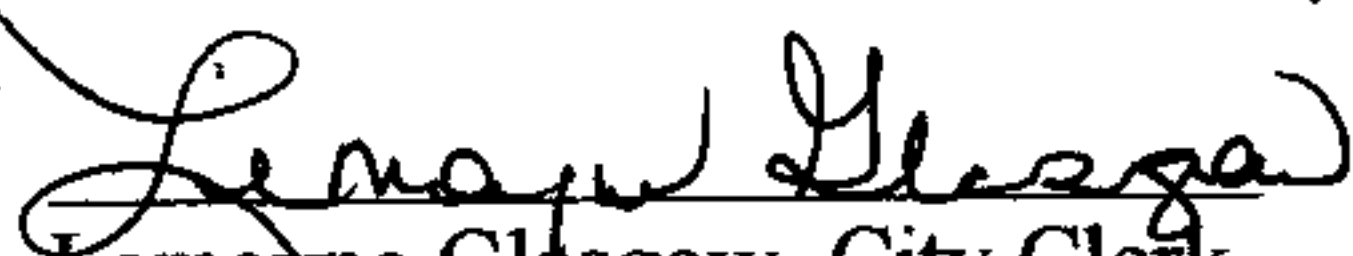
Lemoyne Glasgow, City Clerk

George W. Roy, Mayor

STATE OF ALABAMA
COUNTY OF SHELBY

DATE FILED 8-28-96

Come(s) Concord Baptist Church, being the owner or owners of the property described as follows:

Commence at the Northwest corner of the NE 1/4 of the NW 1/4 of Section 4, Township 22 South, Range 2 West; thence Easterly along the North section line to the Northerly Right-of-Way of County Road 22 and point of Beginning; thence Northeasterly along the Right-of-Way 1066.26 feet; thence left 150 deg. 21 feet 59 inches, 308.88 feet; thence left 16 deg. 15 ft. 00 inches, 478.00 feet; thence right 20 deg. 24 ft. 20 inches to the Eastern Right-of-Way line of the CSX Railroad; thence Southerly along the Right-of-Way to the North Right-of-Way of County Road 22; thence Northeasterly along the Right-of-Way to the Point of Beginning.

which property is located and contained within an area contiguous to the corporate limits of the City of Calera, Alabama, a city of more than 2000 population, and show(s) the City of Calera, Alabama that such property does not lie within the corporate limits or police jurisdiction of any other municipality than Calera, and hereby signs (s) this written petition in accordance with 11-42-20 and 11-42-21, Code of Alabama 1975, as amended, requesting that such property described above be annexed to the City of Calera, Alabama. Also attached hereto is a map of the said property to be annexed showing its relationship to the corporate limits of the City of Calera, Alabama, all in accordance with the provisions of the Code of Alabama as cited above.

CONCORD BAPTIST CHURCH

By Bill Baugher

Bill Baugher, Trustee

By Bo Blankenship

Bo Blankenship, Trustee

By Richard Posey

Richard Posey, Trustee

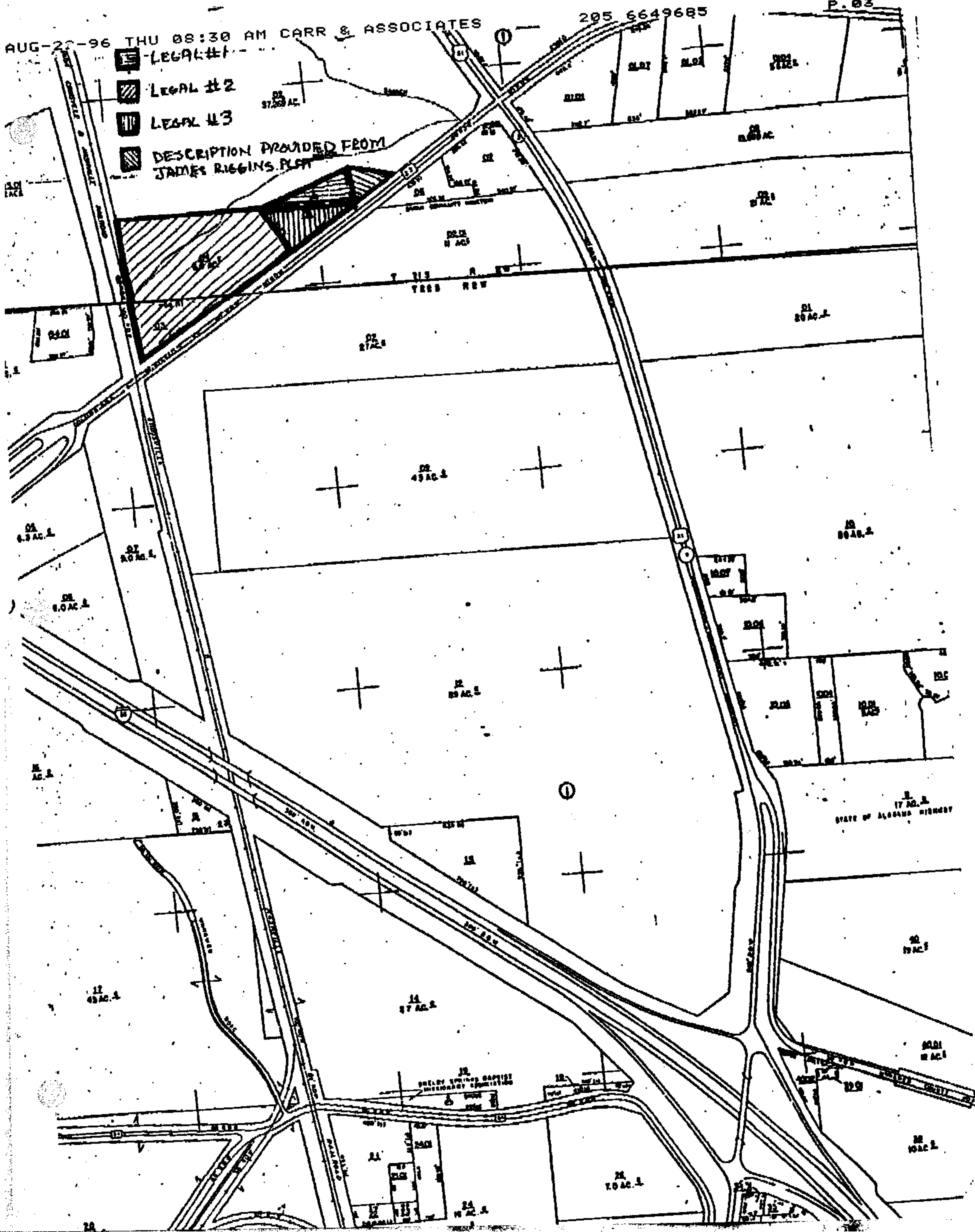

CERTIFICATION OF POSTING

I, Lemoyne Glasgow, City Clerk of the City of Calera do hereby certify that
a copy of the attached ordinance was posted in the following locations in the City of
Calera, Alabama: (Ordinance No. 96-11 Adopted September 3, 1996

Done this 9 day of Sept 1996

Calera City Hall
Calera Public Library
U. S. Post Office

Lemoyne Glasgow, City Clerk

Inst # 1996-29907

09/11/1996-29907
09:03 AM CERTIFIED
SHELBY COUNTY JUDGE OF PROBATE
006 MEL 21.00