

STATE OF ALABAMA)

COUNTY OF SHELBY)

IN PROBATE COURT

ORDER OF ANNEXATION
CHELSEA

WHEREAS, annexation into Chelsea has been requested by residents of the territory shown on the attached map and set forth in the attached metes and bounds description; and

WHEREAS, said territory is contiguous to the corporate limits to the town of Chelsea; and

WHEREAS, the petition signed by said residents contains the signatures of at least two (2) qualified electors who reside on each quarter of each quarter section, or part thereof, of said territory for which annexation into Chelsea is proposed; and

WHEREAS, the petition signed by said residents contains the signatures of landowners of more than sixty percent (60%) of said territory for which annexation into Chelsea is proposed, and

WHEREAS, pursuant to Section 11-42-2, Code of Alabama (1975), the Chelsea mayor and town council have, on June 18, 1996, passed a resolution to the effect that the public good requires that said territory shall be brought within the corporate limits of Chelsea; and

WHEREAS, in accordance with said state law, the mayor of Chelsea has, on June 19, 1996, certified a copy of said resolution to the Shelby County judge of probate; and

WHEREAS, pursuant to Section 11-42-2 (9), Code of Alabama (1975), each of the qualified electors who reside in said territory for which annexation into Chelsea is proposed has, within ten (10) days from the filing of the resolution on June 19, 1996, appeared before the Shelby County judge of probate and consented in writing to said annexation.

It is **ORDERED AND DECREED** that the corporate limits of the town of Chelsea be extended to embrace the said territory described in the resolution, designated on the map and set forth in the metes and bounds description attached to the resolution.

DONE AND ORDERED this 25 day of June, 1996

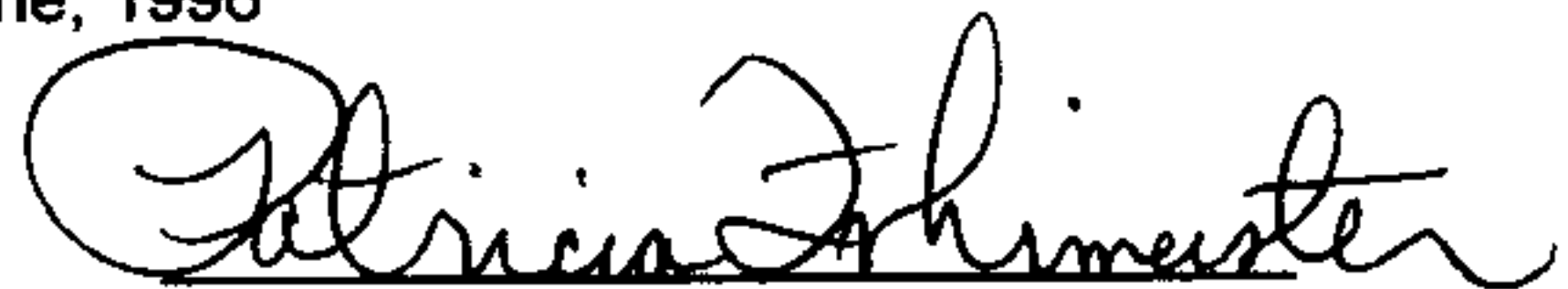

Patricia Yeager Fuhrmeister
Judge of Probate

06/25/1996-20451
09:32 AM CERTIFIED
SHELBY COUNTY JUDGE OF PROBATE
003 NCB 13.50

Back to Pat

Inst # 1996-20451

ANNEXATION BY ELECTION

Part of Map
#58-09-08-27

TOWN
LIMIT

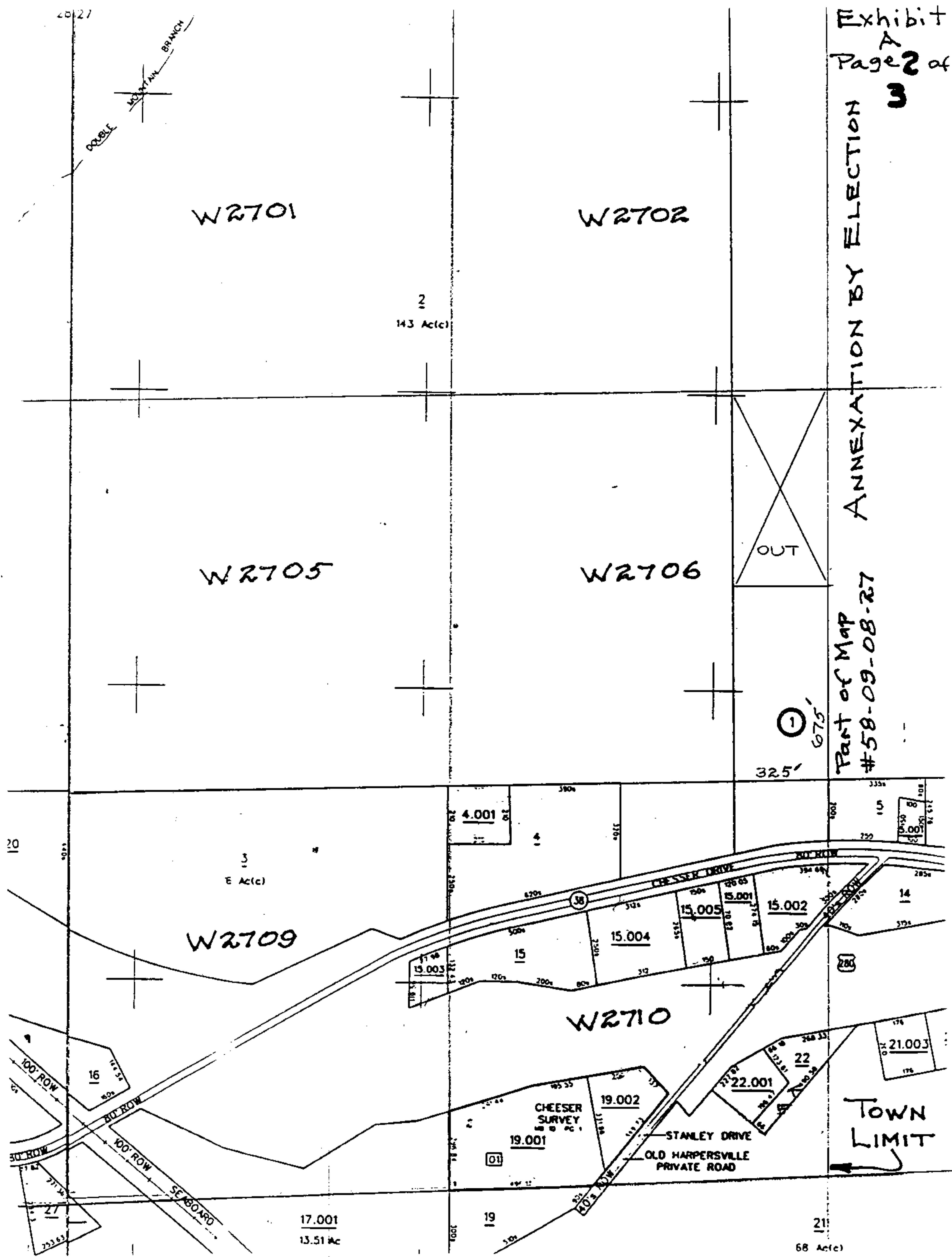

A metes and bounds description prepared for Town of Chelsea, Alabama on 6-13-96

Commence at the Northwest corner of Section 27, Township 19 South, Range 1 West; thence run Southerly along the West line of said Section a distance of 1320 feet, more or less, to the Southwest corner of the NW 1/4 of NW 1/4 of said Section; thence run in an Easterly direction along the South line of said 1/4-1/4 1320 feet, more or less, to the Southeast corner of said 1/4-1/4 Section, said point also being the Northwest corner of the SE 1/4 of the NW 1/4 of said Section, being the point of beginning; thence continue in an Easterly direction 995 feet along the North line of the SE 1/4 of the NW 1/4 to a point; thence run Southerly parallel to the West line of said Section 27, a distance of 645 feet to a point; thence run Easterly parallel to the North line of said Section 27, a distance of 325 feet to a point being on the East line of said SE 1/4 of NW 1/4; thence run in a Southerly direction along the East line of said 1/4-1/4 Section 675 feet to the SE corner of said 1/4-1/4 Section; thence continue in a Southerly direction along the East line of the NE 1/4 of the SW 1/4 a distance of 1320 feet, more or less, to the Southeast corner of the NE 1/4 of the SW 1/4; thence run Westerly along the South line of said 1/4-1/4 Section a distance of 1320 feet, more or less, to the SW corner of said 1/4-1/4 Section; thence run in a Northerly direction along the West line of said NE 1/4 of SW 1/4 Section and the West line of the SE 1/4 of the NW 1/4 a distance of 2640 feet, more or less, to the point of beginning.

prepared by Mike Alchison 6-13-96

Inst # 1996-20451

06/25/1996-20451
09:32 AM CERTIFIED
SHELBY COUNTY JUDGE OF PROBATE
003 NCD 13.50