

Grant Of Land Easement By Landowner
For Use Of Alabama Power Company
In Providing Electric Service To Landowner's Premises,
And Adjacent Property Of Others
To Which Service Is Being Simultaneously Extended

All facilities on
Lands of Grantor

W.E.# 61720-00-0184-500

Parcel #

STATE OF ALABAMA

COUNTY OF Shelby

GRANTEE'S ADDRESS
ALABAMA POWER CO.
P.O. BOX 2641
BIRMINGHAM, AL 35291-1980

1. KNOW ALL MEN BY THESE PRESENTS, That Landowner(s) Joe N. Horsley and wife; Timma J. Horsley

(the "Grantor", whether one or more) hereby applies to Alabama Power Company, a corporation (the "Company") for electrical service at 20 Yellowleaf Circle Chelsea, Alabama 35043

Grantor is the owner of the land and premises located at the above address, which by the parties are deemed to be legally described herein precisely as described and mapped in Grantor's ad valorem tax assessment for such land and premises in the office of the Tax Assessor of Shelby County, Alabama, as if herein set out in full detail (the "Property"), and generally described as located in the following described parcel:

A parcel of land in the NW 1/4 of the NE 1/4 of Section 35,
Township 19S, Range 1W, as is recorded in 1992 at 15619
in the office of the Judge of Probate of Shelby County, Alabama

2. To provide the requested electric service to Grantor (and adjacent premises of others to which service is being simultaneously extended), Company must, and may, install on the Property from time to time, some or all of the following: electric poles, electric distribution lines, service laterals, metering equipment, transformers, guys, anchors, and equipment related thereto, both above and below ground, and must, and may, accomplish the cutting and trimming of trees both now and in the future to accommodate such facilities.

3. Grantor, in consideration of (a) the construction of the necessary service facilities, (b) the furnishing of electric service at Company's published rates, and, (c) the payment of one dollar and other good and valuable consideration, the receipt of which is hereby acknowledged, hereby grants, (for himself, his heirs, successors and assigns) to Company the right to install, improve, remove, maintain, and replace, upon, over, and under the Property such of the above electric facilities as are appropriate in the opinion of Company, to provide such requested service or services, at locations on Grantor's land (and adjacent premises of others to which service is simultaneously being extended), deemed appropriate for such service or services by Company, and agreed to by Grantor at time of original extension of service or services (together with necessary and reasonable changes therein and extensions thereto to serve the property and premises of Grantor and adjacent premises described above, if any) together with all rights and privileges necessary or convenient for the full enjoyment or use thereof, including the right to clear and keep cleared all trees, undergrowth, growth on, and other obstructions, within a strip of land extending fifteen feet (15') on either side of the center line of the facilities as constructed, that would in the opinion of Company interfere with such facilities, and the right to cut all dead, weak, leaning or dangerous trees or limbs outside the said thirty foot (30') strip which, in the sole opinion of the Company, might endanger, interfere with or fall upon the poles, lines or other appliances of said Company.

Facilities to be installed under this agreement may be utilized in providing electric service to the Grantor and other Company customers located on property adjacent to the Property and with such service to adjacent property being extended and constructed simultaneously with the building of service facilities to Grantor.

The precise location on the property where the facilities are installed shall be conclusively deemed to be the location described in this grant for the placement of all such facilities. It is the intention of the parties that this grant shall be an easement on, under and over Grantor's land and shall be binding in the future on Grantor's successors, heirs and assigns.

4. Company shall have the rights of ingress and egress to and from the easement and the Property of Grantor for the purpose of installing, constructing, operating and maintaining its facilities in accordance with accepted industry standards.

In the event it becomes necessary or desirable for Company to move its lines of poles and appliances in connection with the construction or improvement of any public road or highway in proximity to its said power lines, Company is hereby granted the right to relocate its said lines of poles and appliances on lands of Grantor hereinabove described, provided, however, the said Company shall relocate its said lines of poles at a distance not greater than ten feet (10') outside the boundary of the right of way of any such public road or highway as established or re-established from time to time.

TO HAVE AND TO HOLD such easement to Company, its successors and assigns, forever.

IN WITNESS WHEREOF, We have set Our hand(s) and seal(s) this the 1st day of August

WITNESS:

Donnie Henley
Donnie Henley

GRANTOR(S)

Joe N. Horsley (SEAL)
Timma J. Horsley (SEAL)

This instrument prepared in
Birmingham Div. Real Estate
Dept. of Alabama Power Co.
Birmingham, Al

By Sarry Grant

05/03/1996-14487 (SEAL)
10:21 AM CERTIFIED (SEAL)
SHELBY COUNTY JUDGE OF PROBATE
002 MEL 11.50

SKETCH OF PROPOSED WORK — SIMPLIFIED W. E.

Alabama Power

-1845-00

Customer JOE HORSLEY		Location 20 YELLOWLEAF CIR		Agreed Serv. Date		Estimate No. 61720-00-00245-00	
Division BHAM		District COLUMBIANA		Town CHELSEA		Drawn by J SIMMONS	
County SHELBY		Section 35		Township 19S		Range 1W	
Acquisition Agent L. P. G.		Date R/W Assigned 6-20-95		Date R/W Cleared 8-1-95		Map Reference JTS # 158908	
						LOC 1	Transformer Loading 29 KVA

NOTE: CUSTOMER TO PAY
\$473.00 FOR UG SERVICE
CUST. DUG OWN DITCH &

INSTALLED CONDUIT.

AS PLUNDH TO PULL
CONDUCTORS.

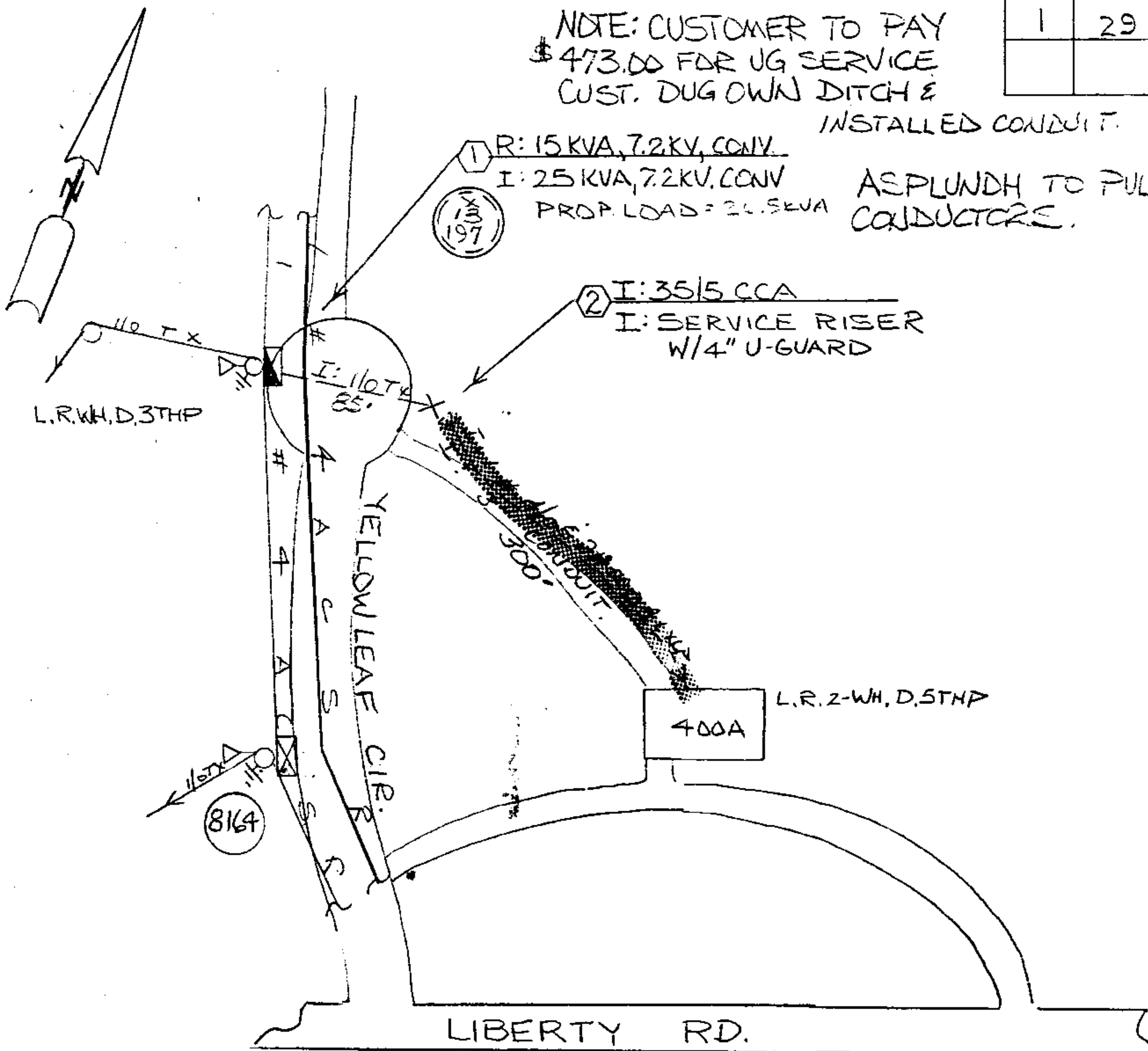

Voltage	
Pri	Sec.
7.2KV	100V
	240V
PHONE CO.	
Co. Name	
CATV CO.	
Co. Name	
ACCESSIBLE	
TREE CREW	
ROCK HOLE	
PERMITS REQ'D	
R/W	
CITY	
COUNTY	
STATE	
MISSALL #	
OTHER ASPLUNDH	
PULL CABLE - N.Y.	
SCALE	
N.T.S.	
Ft. Per Inch	

LOCATION



Cnst. Completed By

05/03/1996-14487
10:21 AM CERTIFIED
SHELBY COUNTY JUDGE OF PROBATE
002 MEL 11.50

Date