

ORDINANCE NUMBER 476

AN ORDINANCE TO ALTER, REARRANGE AND EXTEND  
THE CORPORATE LIMITS OF THE CITY OF HELENA,  
ALABAMA, SO AS TO EMBRACE AND INCLUDE WITHIN  
THE CORPORATE AREA OF SAID CITY ALL TERRITORY  
NOW WITHIN SUCH CORPORATE LIMITS AND ALSO  
CERTAIN OTHER TERRITORY CONTIGUOUS TO SAID CITY.

WHEREAS, a petition signed by the owners of all of the land within the territory therein described and proposed to be annexed to the City, together with a map of said territory showing its relationship to the corporate limits of the City, has been filed with the City Clerk of the City of Helena; and

WHEREAS, this Council has determined and found that the matters set forth and alleged in said petition are true, and that it is in the public interest that said property be annexed to the City of Helena;

NOW, THEREFORE, BE IT ORDAINED by the Council of the City of Helena as follows:

Section 1. That said Council and the City of Helena hereby assent to the annexation of said territory to the City of Helena, Alabama, the corporate limits of the City to be extended and rearranged pursuant to the provisions of Chapter 42, Article 2, Code of Alabama 1975 (Sections 11-42-20 through 11-42-23, as amended) so as to embrace and include said territory in addition to the territory already within its present corporate limits, within the corporate area of said City, which said territory is not within the corporate limits of another municipality and the new boundary line does not lie at any point more than half the distance between the old city boundary and the corporate boundary of any municipality. Said territory is described as follows:

The East 1 foot of the West 2-1/4 feet of the North 1/2 of the SE 1/4 of the SW 1/4 of Section 26, Township 20 South, Range 4 West, Shelby County, Alabama.

That parcel of land East of Ridgemont Drive (being part of Parcel #03.03), the West 18 feet of the East 37-1/2 feet being part of the NE 1/2 of the NW 1/4 of the NW 1/4 of Section 35, Township 20 South, Range 4 West, Shelby County, Alabama.

The East 8-1/2 feet of the West 17-1/2 feet of the West 1/2 of the NE 1/4 of the NE 1/4 of Section 34, Township 20 South, Range 4 West, Shelby County, Alabama.

The West 9 inches of the East 1-1/2 feet of the SE 1/4 of the SW 1/4 of Section 24, Township 20 South, Range 4 West, Shelby County, Alabama.

The West 2-1/4 feet of the East 4-1/2 feet of the East 1/2 of the NE 1/4 of the NW 1/4 of Section 25, Township 20 South, Range 4 West, Shelby County, Alabama.

The South 1/2 of the West 1/2 of Parcel #07 Shelby County Tax Map Number 58-12-06, Township 20 South, Range 4 west, Shelby County, Alabama (situated in Section 23).

The East 1/2 of the West 1/2 of the South 1/2 of the SE 1/4 of the NE 1/4 of Section 34, Township 20 South, Range 4 West, Shelby County, Alabama.

That parcel of land situated in the NW 1/4 of the NW 1/4 of Section 35, Township 20 South, Range 4 West, Shelby County, Alabama. Parcel #03.04

The South 1/2 of Parcel Number 08 Shelby County Tax Map Number 58-12-06, Section 23, Township 20 South, Range 4 West, Shelby County, Alabama. (Parcel situated in the SW 1/4 of the SW 1/4 of Section 23). Parcel Number 09 included.

Inst # 1996-01586

01/17/1996-01586  
10:18 AM CERTIFIED  
SHELBY COUNTY JUDGE OF PROBATE  
005 MCD 18.50

Inst # 1996-01586

**PARCEL I**

A tract of land situated in the Northeast 1/4 of the Northeast 1/4 of Section 34, Township 20 South, Range 4 West, Shelby County, Alabama and more particularly described as follows:

Commence at the Southeast corner of said Northeast 1/4 of Northeast 1/4; thence in a Westerly direction along the South line thereof a distance of 75.0 feet to the point of beginning; thence continue in a Westerly direction along said South line a distance of 35.28 feet; thence an angle right of 74 degrees 45' and run in a Northwesterly direction a distance of 545.91 feet; thence an angle right of 105 degrees 11' and run in an Easterly direction a distance of 257.09 feet to a point on the East line of said Northeast 1/4 of Northeast 1/4; thence an angle right of 90 degrees 25' and run in a Southerly direction along said East line a distance of 402.0 feet; thence an angle right of 30 degrees 57'-50" and run in a Southwesterly direction a distance of 146.31 feet to the point of beginning. Situated in Shelby County, Alabama.

**PARCEL II**

From the Southwest corner of the Northwest 1/4 of the Northwest 1/4; run North along the West boundary of said 1/4-1/4 a distance of 125.00 feet to the point of beginning; thence continue a distance of 228.73 feet; thence right 97 degrees 50'00" a distance of 50.72 feet; thence right 87 degrees 11'-00" a distance of 156.77 feet; thence right 24 degrees 00'-00" a distance of 75.32 feet to the point of beginning, lying in Section 35, Township 20 South, Range 4 West, Shelby County, Alabama.

Section 2. That the City Clerk shall file a certified copy of this ordinance containing an accurate description of said annexed territory with the Probate Judge of Shelby County, Alabama, and also cause a copy of this ordinance to be posted in three (3) public places in the City of Helena.

STATE OF ALABAMA  
SHELBY COUNTY

I, Frances Parrish, City Clerk of the City of Helena, do hereby certify that the above is a true correct copy of an ordinance duly adopted by the Council of the City of Helena at its meeting held January 8 1996, and as same appears of record in the ordinance records of said City, and approved by the Mayor on January 8, 1996.

Given under my hand and corporate seal of the City of Helena, this the 8 day of January, 1996.

Frances Parrish  
City Clerk

# CERTIFICATION

I, Frances Parrish, the duly appointed and acting Clerk of the City of Helena, Alabama, do hereby certify that the within Ordinance Number 476 is a true copy as recited in the said City Clerk's Minute Book and posted by me as provided by law in three public places in said City, being on the bulletin board of the City Hall, in the Helena Police Dept. in the City of Helena, and in the Helena Public Library in said City, that said Ordinance shall become a duly lawful Ordinance of said City on the 15 day of January, 1996, five or more days after the posting of the same as provided by law.

IN WITNESS WHEREOF, I have hereunto set my hand and seal on this the 8 day of January, 1996.

Frances Parrish  
City Clerk

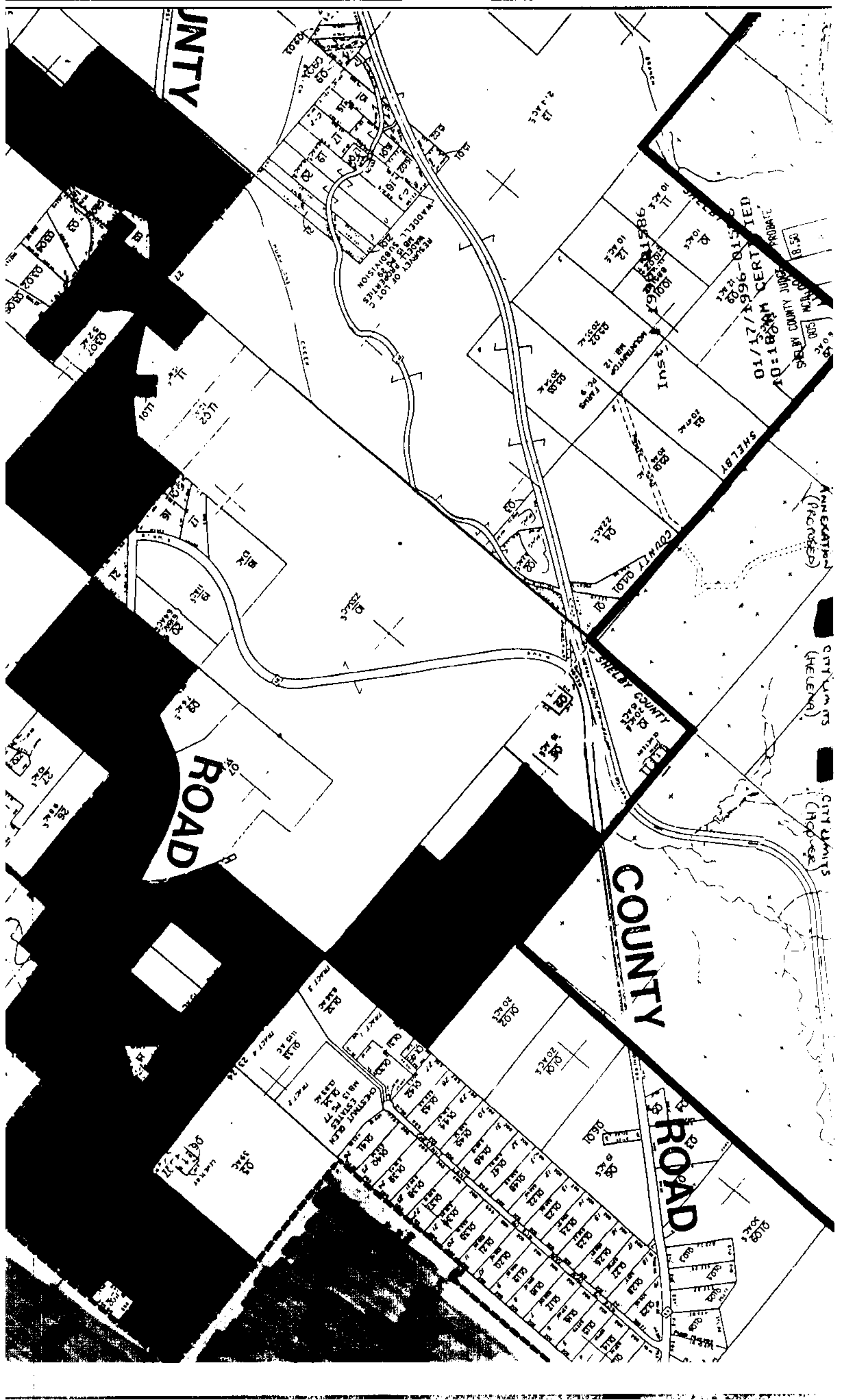

JNTY

ROAD

COUNTY

ROAD

01/17/1996-0151  
10:18:34M CERTIFIED  
SHELBY COUNTY JUDGE PROBATE

ANNEXATION  
(PROPOSED)

CITY LIMITS  
(HELENA)

CITY LIMITS  
(HOOPER)

RESURVEY OF LOT C  
WADSWORTH SUBDIVISION

SHELBY COUNTY 0401

TRACT 1  
TRACT 2  
TRACT 3  
TRACT 4  
TRACT 5  
TRACT 6  
TRACT 7  
TRACT 8  
TRACT 9  
TRACT 10  
TRACT 11  
TRACT 12  
TRACT 13  
TRACT 14  
TRACT 15  
TRACT 16  
TRACT 17  
TRACT 18  
TRACT 19  
TRACT 20  
TRACT 21  
TRACT 22  
TRACT 23  
TRACT 24  
TRACT 25  
TRACT 26  
TRACT 27  
TRACT 28  
TRACT 29  
TRACT 30  
TRACT 31  
TRACT 32  
TRACT 33  
TRACT 34  
TRACT 35  
TRACT 36  
TRACT 37  
TRACT 38  
TRACT 39  
TRACT 40  
TRACT 41  
TRACT 42  
TRACT 43  
TRACT 44  
TRACT 45  
TRACT 46  
TRACT 47  
TRACT 48  
TRACT 49  
TRACT 50  
TRACT 51  
TRACT 52  
TRACT 53  
TRACT 54  
TRACT 55  
TRACT 56  
TRACT 57  
TRACT 58  
TRACT 59  
TRACT 60  
TRACT 61  
TRACT 62  
TRACT 63  
TRACT 64  
TRACT 65  
TRACT 66  
TRACT 67  
TRACT 68  
TRACT 69  
TRACT 70  
TRACT 71  
TRACT 72  
TRACT 73  
TRACT 74  
TRACT 75  
TRACT 76  
TRACT 77  
TRACT 78  
TRACT 79  
TRACT 80  
TRACT 81  
TRACT 82  
TRACT 83  
TRACT 84  
TRACT 85  
TRACT 86  
TRACT 87  
TRACT 88  
TRACT 89  
TRACT 90  
TRACT 91  
TRACT 92  
TRACT 93  
TRACT 94  
TRACT 95  
TRACT 96  
TRACT 97  
TRACT 98  
TRACT 99  
TRACT 100