

AN EASEMENT

FOR THE CONSTRUCTION, OPERATION, AND MAINTENANCE

OF A WATER LINE BY THE WATER WORKS BOARD OF THE CITY OF CALERA

This EASEMENT, executed this 5th day of March, 1993, for the construction, operation, and maintenance of a water line, with appurtenances, by the City of Calera, across the property of the LANDOWNER, Harvey G. & Paula M. Coker which property is located in Section 1, Township 22 S, Range 3 W, in SHELBY COUNTY, Alabama, is granted by the LANDOWNER to the BOARD for valuable considerations, the receipt and sufficiency of which are acknowledged by the LANDOWNER, for himself, and his heirs, executors, successors, and assigns. The easement is described on the attachment.

Executed the date shown above in three copies

LANDOWNER:

By: Harvey G. Coker Jr
By: Paula M. Coker

WITNESS:

By: Luille Morrison
By: Luille Morrison

FOR the WATER WORKS BOARD OF
THE CITY OF CALERA:

By: J. C. Rowe
J. C. Rowe, Chairman

WITNESS:

By: _____

Recorded the _____ day of _____, 1992, in
Deed Book _____ Page _____, of the public records of
SHELBY COUNTY, Alabama.

Inst # 1995-09791

04/17/1995-09791
08:19 AM CERTIFIED
SHELBY COUNTY JUDGE OF PROBATE
002 NCD 11.50

NORTHEAST CORNER
SW 1/4 - SE 1/4
SEC. 1, T 22 S, R 3 W
SHELBY COUNTY, ALABAMA

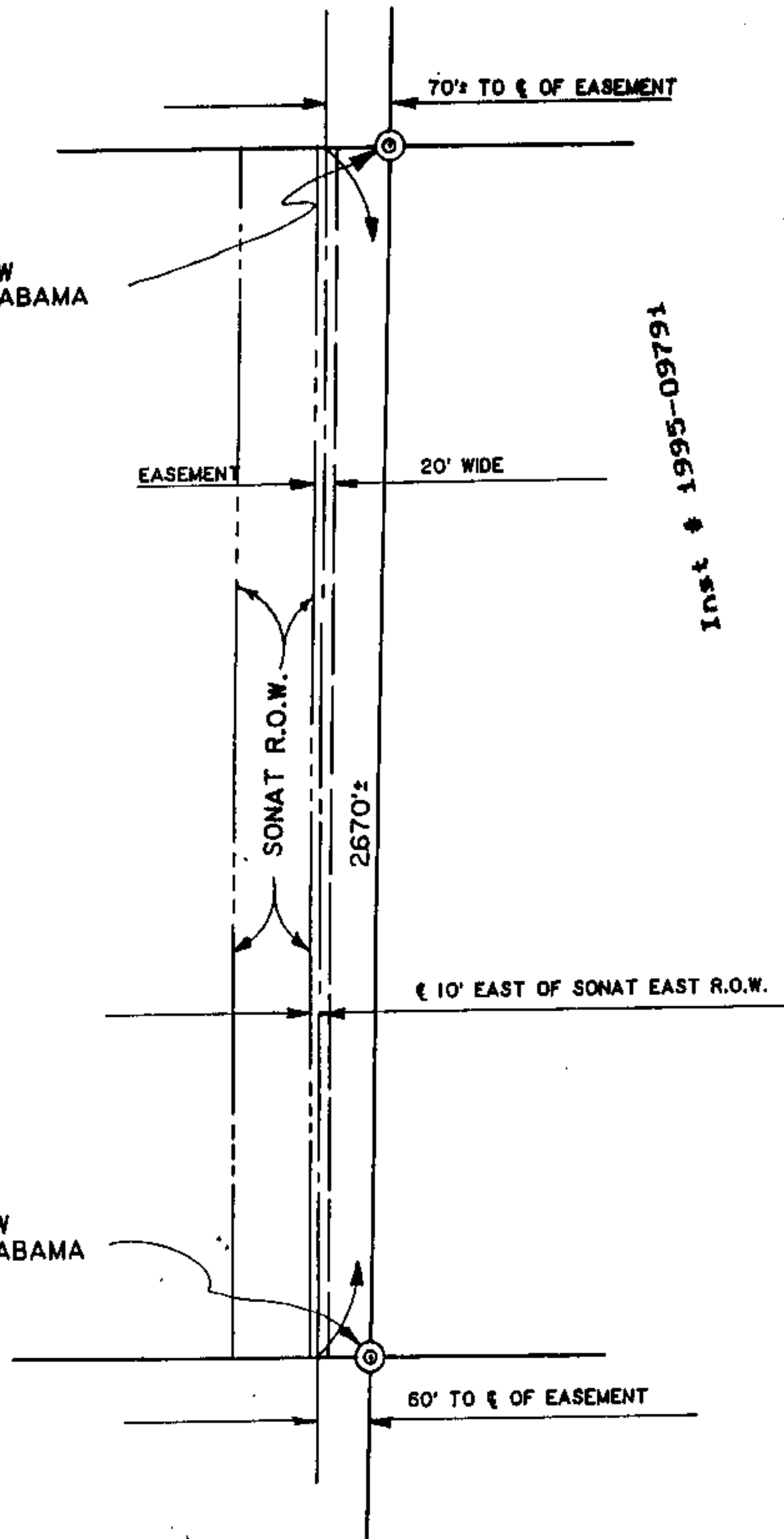

SOUTHEAST CORNER
SW 1/4 - SE 1/4
SEC. 1, T 22 S, R 3 W
SHELBY COUNTY, ALABAMA

Inst # 1995-09791

04/17/1995-09791 - 200'
08:19 AM CERTIFIED
SHELBY COUNTY JUDGE OF PROBATE
002 NCJ 11.50

DESCRIPTION

A twenty foot wide easement East of and parallel to a Southern Natural Gas Company Right-of-Way, the centerline of which is described as follows:

Commence at the Southeast Corner of the Southwest Quarter of the Southeast Quarter of Section 1, Township 22 South, Range 3 West, Shelby County, Alabama; thence run West along the South Quarter line a distance of 60 feet more or less to a point being 10 feet East of the East SONAT R.O.W. line and being the Point of Beginning; thence North 10 feet East of and parallel to the SONAT R.O.W. East line a distance of 2670 feet more or less to the North Quarter line of the Southwest Quarter of the Southeast Quarter of Section 1 being the Point of Ending, being 70 feet more or less West of the Northeast Corner of the Southwest Quarter of the Southeast Quarter of Section 1 and 10 feet East of the East R.O.W. SONAT line.