

STATE OF ALABAMA
SHELBY COUNTY

X
X
X

THIS INDENTURE made and entered into on this the _____
day of _____, 19 __, by and between WILLIE MAE BISHOP
P.O. BOX 1187 ALABASTER, ALABAMA
hereinafter called Grantors; and the CITY OF ALABASTER, ALABAMA
hereinafter called the Grantee;

W I T N E S S E T H:

WHEREAS, it has been found to provide the necessary utilities to
certain areas lying within the CITY OF ALABASTER
service area, SHELBY County, Alabama; that it has been found
necessary to cross certain lands owned by the Grantors for the purpose of
installing all necessary PIPELINES, and other such integral
parts of the UTILITY;

WHEREAS, it has been found advantageous and to the best interest
of Grantors and Grantee that an easement for such UTILITY be
conveyed to the CITY OF ALABASTER

THEREFORE, in consideration of the sum of _____
and the mutual benefits accruing to the Grantors and to the CITY OF
ALABASTER, SHELBY County, Alabama, the
Grantors have this day bargained and conveyed and by these presents do hereby
grant and convey unto the CITY OF ALABASTER, SHELBY
County, Alabama, the following right, privilege and easement, in, to, along,
over, through, under and across the hereinafter described lands:

The right and privilege to construct, erect, install,
operate and maintain A SANITARY SEWER, on, upon, along,
over, through, under and across the hereinafter described
lands;

The right, privilege and easement to cut, trim and remove
any brush, trees, or other obstructions upon the hereinafter
described lands, together with the right of ingress and
egress to and from, over and above the hereinafter described
lands, for the purpose of the installation and upkeep of the
SANITARY SEWER.

03/17/1995-07080
02:07 PM CERTIFIED
SHELBY COUNTY JUDGE OF PROBATE
004 MCD 17.00

Inst # 1995-07080

(DESCRIPTION)

AN EASEMENT 20' IN WIDTH LYING 10' EITHER SIDE OF THE CENTERLINE OF THE SANITARY SEWER AS SHOWN ON SHEET 7 OF THE PLANS OF CITY OF ALABASTER, SANITARY SEWER EXTENSIONS, COUNTY ROAD 263 AND GOLDWIRE CIRCLE AREA, DATED DECEMBER, 1992, OR AS CONSTRUCTED, SAID EASEMENT BEING LOCATED IN THE SW 1/4 OF SECTION 1, TOWNSHIP 21, RANGE 3 WEST, SHELBY COUNTY, ALABAMA, AND MORE PARTICULARLY IN THE NORTHEASTERN PORTION OF PARCEL 99.05, OWNERSHIP MAP, BLOCK 2 AS SHOWN IN SHELBY COUNTY TAX MAP NO. 58-23-01-01-3, SAID PARCEL BEING OWNED BY WILLIE MAE BISHOP AS RECORDED IN REAL PROPERTY BOOK 241, PAGE 866, SHELBY COUNTY, ALABAMA.

SAID EASEMENT CONTAINS 0.07 ACRES MORE OR LESS.

IT IS AGREED BY AND BETWEEN THE GRANTORS AND GRANTEES THAT GRANTORS GRANT TO THE CITY OF ALABASTER A TEMPORARY EASEMENT FORTY (40) FEET IN WIDTH, THIS DIMENSION BEING 10 FEET ON THE NE SIDE AND 30 FEET ON THE NW SIDE OF THE PROPOSED SANITARY SEWER AND A TWENTY (20) FOOT WIDE PERMANENT EASEMENT, THIS DIMENSION BEING 10 FEET ON EITHER SIDE OF THE PROPOSED SANITARY SEWER, AS CONSTRUCTED AND / OR AS DESCRIBED ABOVE.

TO HAVE AND TO HOLD the above described right, privilege, and easements unto the CITY OF ALABASTER, ALABAMA and to its assigns, together with the right of entry and reentry from time to time as occasion may require for the purpose of exercising its said rights, privileges and easements, hereinabove described.

IN WITNESS WHEREOF, we, Mrs Willie Mae Bishop

have hereunto set our hands and seals on this the day and year first above written.

Robert F. Adams
(Witness)

(SEAL)

(Witness)

(SEAL)

(Witness)

(SEAL)

(Witness)

(SEAL)

(Witness)

(SEAL)

(Witness)

(SEAL)

STATE OF ALABAMA

X

SHELBY COUNTY

X

X

I, the undersigned Notary Public, in and for said County in said State, hereby certify that Willie Mae Bishop

whose names are signed to the foregoing Easement and who are known to me, acknowledged before me on this day, that being informed of the contents of this Easement, Mr. Bishop executed the same voluntarily on the day the same bears date.

GIVEN under my hand this the 4th day of May, 1993.

Marsha L. Massey
NOTARY PUBLIC

(SEAL)

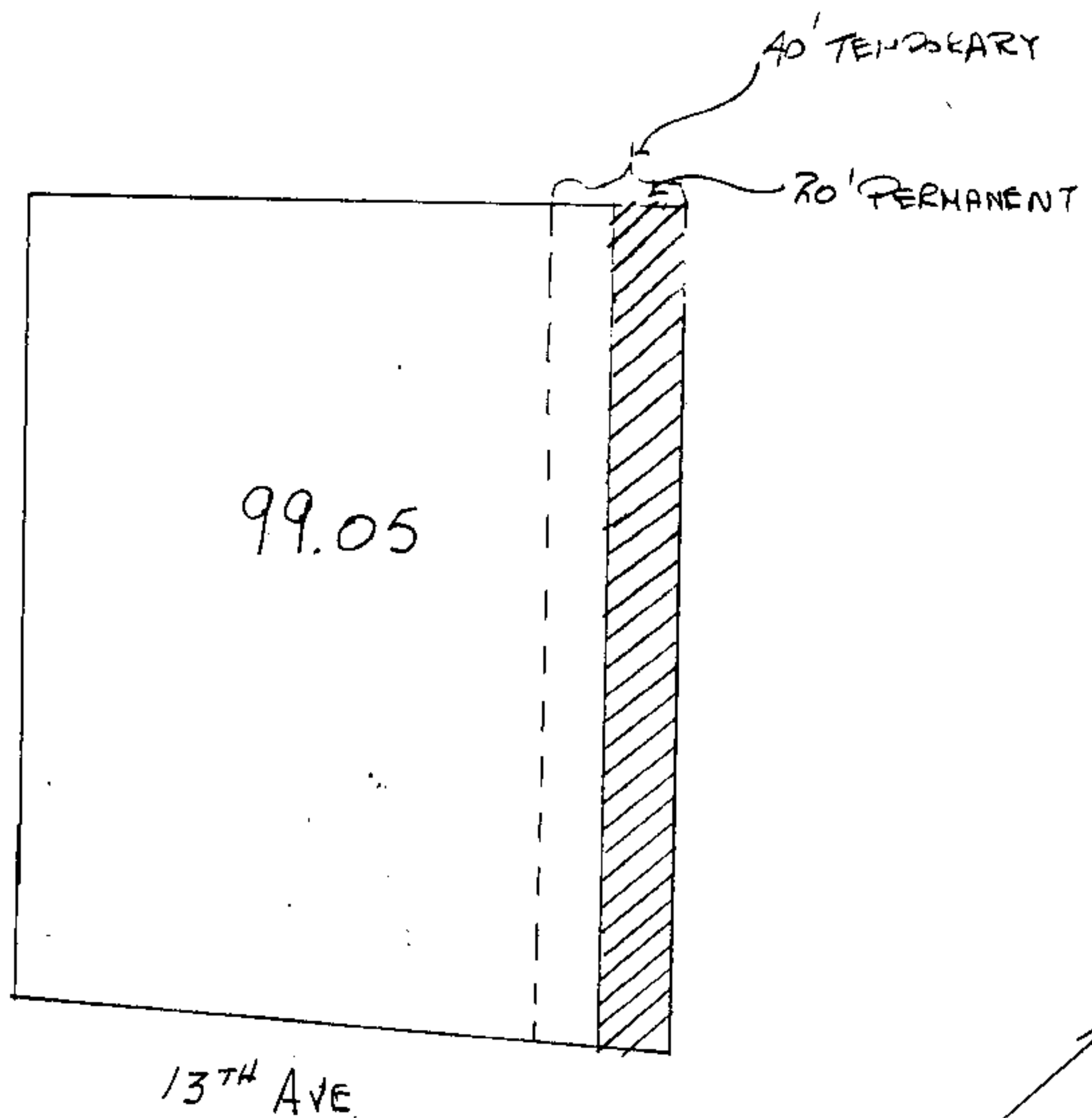

TAX MAP 58-23-01-01-3

Inst # 1995-07080

03/17/1995-07080
02:07 PM CERTIFIED
SHELBY COUNTY JUDGE OF PROBATE
004 MCD 17.00