

Councilmember Pres. Steve Rauch introduced the following Ordinance:

ORDINANCE NO. 95-350

WHEREAS, on the 14th day of December, 1994, Sarah N. Snow and Leslie M. Snow filed a petition with the City Clerk of the City of Alabaster, Alabama, as required by §§ 11-42-20 and 11-42-21, Code of Alabama 1975, as amended, petitioning and requesting that the property hereinafter described be annexed to the municipality of the City of Alabaster, Alabama, which petition contained an accurate description of the property proposed to be annexed together with a map of the said property showing its relationship to the corporate limits of the City of Alabaster, Alabama, and the signatures of the owners of the property described were signed thereto;

NOW, THEREFORE, BE IT ORDAINED BY THE CITY COUNCIL OF THE CITY OF ALABASTER, ALABAMA, AS FOLLOWS:

1. That the City of Alabaster, Alabama, does adopt this Ordinance assenting to the annexation of the following described property to the municipality of the City of Alabaster:

Commence at the NE corner of the NE $\frac{1}{4}$ of the SE $\frac{1}{4}$ of Section 18, Township 21 South, Range 2 West, and run S 38° 15' W to the SW line of U.S. Highway No. 31; then continue along last described course a distance of 832.6 feet, more or less, to the Alabaster City Limit line; then turn left and run along the Alabaster City Limit line a distance of 12 feet to the point of beginning; then turn left and run N 38° 15' E along the Alabaster City Limit line a distance of 832.6 feet, more or less, to the SE line of the Snow residence lot; then turn right and run S 38° 15' E a distance of 200.4 feet; then turn left 128°

Inst # 1995-07067

Inst # 1995-07067

03/17/1995-07067
01:53 PM CERTIFIED
SHELBY COUNTY JUDGE OF PROBATE
DOB MCB 26.00

48' and run a distance of 72.7 feet; then turn right 34° 25' and run a distance of 68.58 feet; then turn right 94° 23' and run a distance of 30 feet; then turn left 94° 23' and run a distance of 108.87 feet, more or less, to the SW line of said Highway No. 31; then continue along the last described course to the NE line of said Highway No. 31; then turn right and run along the NE line of said Highway No. 31 a distance of 1354.51 feet; then turn right and run S 55° 00' W to the SW line of said Highway No. 31; then continue along last described course a distance of 903.65 feet; then continue along last described course to the SW line of L & N Railroad right of way; then turn right and run along the railroad right of way to the point of beginning.

2. That the corporate limits of the City of Alabaster, Alabama, be extended and rearranged so as to embrace and include such property, and such property shall become a part of the corporate area of such municipality upon the date of publication or posting of this Ordinance, as provided for in the Code of Alabama as cited above.

3. That the City Clerk be and she is hereby authorized and directed to file a copy of this Ordinance, including an accurate description of the property being annexed, together with a map of the said property showing its relationship to the corporate limits of the City of Alabaster, Alabama, to which said property is being annexed in the office of the Judge of Probate of Shelby County, Alabama.

4. That the Zoning Map of the City of Alabaster, Alabama, and any other official maps or surveys of the City shall be amended to reflect the annexation of the above-described property, and that a copy of this Ordinance be transmitted to the City Planning

Commission and the Zoning Administrator.

5. That this property is temporarily zoned MR as provided in the Zoning Ordinance of the City of Alabaster, Alabama.

6. That this property is part of election Ward ____.

This ordinance was adopted and passed by the City Council of the City of Alabaster, Alabama, this the 19th day of January, 1995.

CITY OF ALABASTER, ALABAMA

by Steven K. Rauch
Council President Steve Rauch

Attest:

Andrea L. Jones
Clerk

Approved:

Roger N. Wheeler
Mayor
ANNEX. ORD

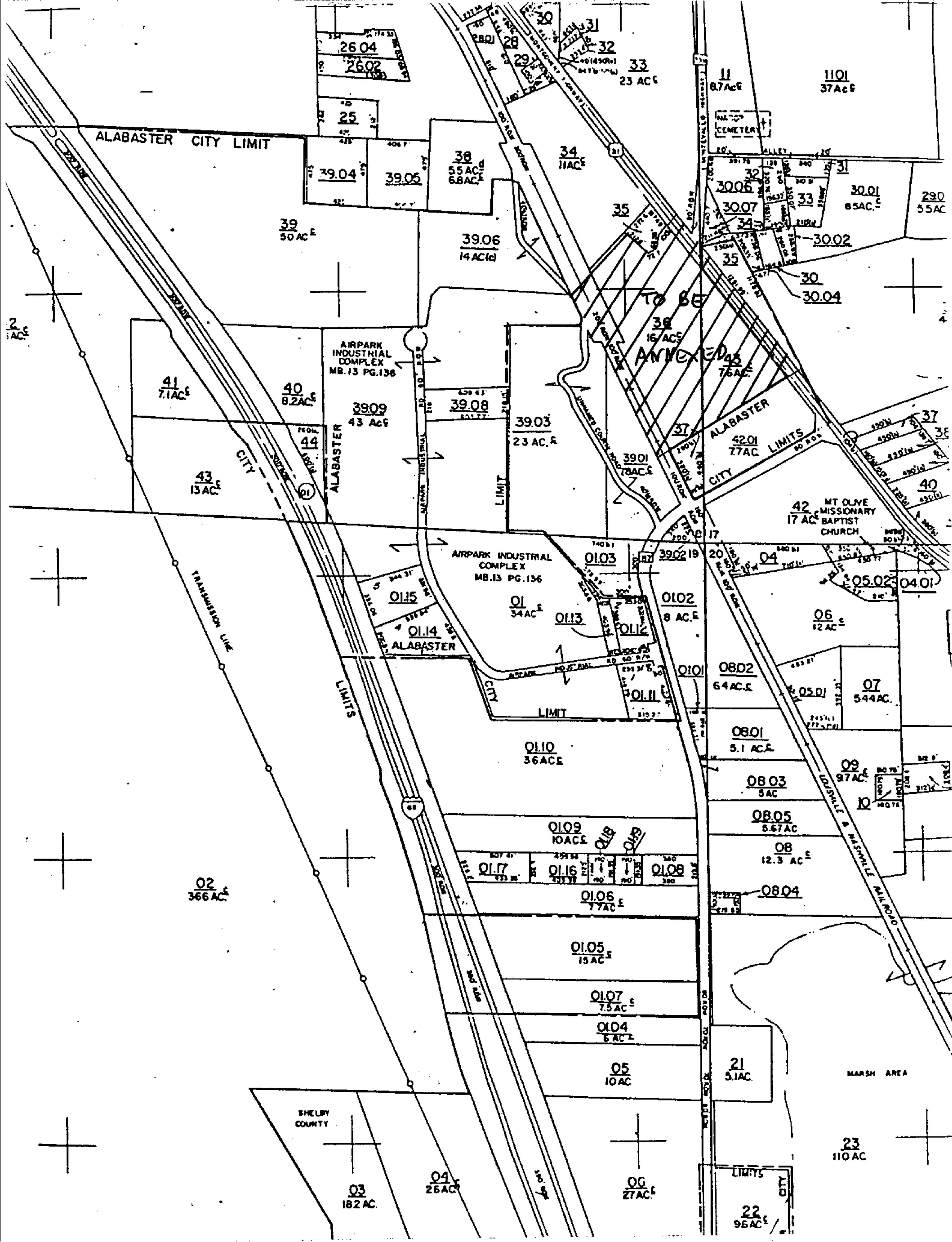

I, Andrea L. Jones, Acting Clerk for the City of Alabaster,
Alabama, hereby certify that I have posted a copy of the foregoing
Ordinance in the following places within the City of Alabaster:

Alabaster City Hall

Alabaster Water & Gas Board

Albert L. Scott Library

U. S. Post Office in Alabaster

This the 26th day of January 19 95 .

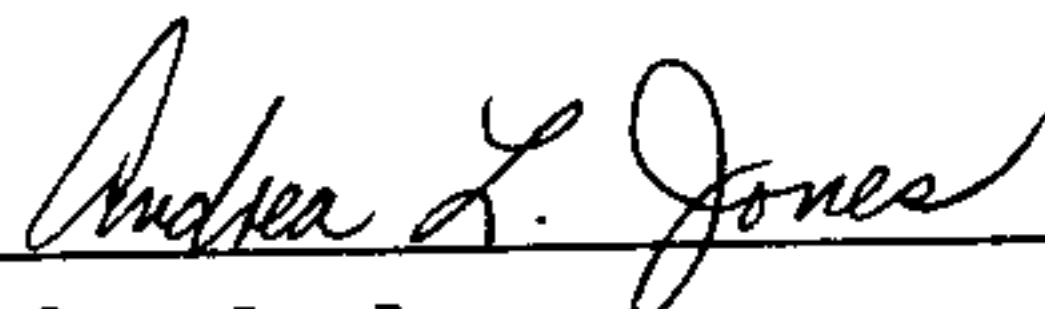

Andrea L. Jones
Acting Clerk

STATE OF ALABAMA

DATE FILED: 12-14-94

COUNTY OF SHELBY

Come(s) Sarah N. Snow and Leslie M. Snow, being the owner or owners of the property described as follows:

Commence at the NE corner of the NE $\frac{1}{4}$ of the SE $\frac{1}{4}$ of Section 18, Township 21 South, Range 2 West, and run S 38° 15' W to the SW line of U.S. Highway No. 31; then continue along last described course a distance of 832.6 feet, more or less, to the Alabaster City Limit line; then turn left and run along the Alabaster City Limit line a distance of 12 feet to the point of beginning; then turn left and run N 38° 15' E along the Alabaster City Limit line a distance of 832.6 feet, more or less, to the SE line of the Snow residence lot; then turn right and run S 38° 15' E a distance of 200.4 feet; then turn left 128° 48' and run a distance of 72.7 feet; then turn right 34° 25' and run a distance of 68.58 feet; then turn right 94° 23' and run a distance of 30 feet; then turn left 94° 23' and run a distance of 108.87 feet, more or less, to the SW line of said Highway No. 31; then continue along the last described course to the NE line of said Highway No. 31; then turn right and run along the NE line of said Highway No. 31 a distance of 1354.51 feet; then turn right and run S 55° 00' W to the SW line of said Highway No. 31; then continue along last described course a distance of 903.65 feet; then continue along last described course to the SW line of L & N Railroad right of way; then turn right and run along the railroad right of way to the point of beginning.

which property is located and contained within an area contiguous to the corporate limits of the City of Alabaster, Alabama, a city of more than 2000 population, and show(s) the City of Alabaster, Alabama, that such property does not lie within the corporate limits or police jurisdiction of any other municipality than Alabaster, and do hereby sign this written petition in accordance

with §§ 11-42-20 and 11-42-21, Code of Alabama 1975, as amended, requesting that such property described above be annexed to the City of Alabaster, Alabama. Also attached hereto is a map of the said property to be annexed showing its relationship to the corporate limits of the City of Alabaster, Alabama, all in accordance with the provisions of the Code of Alabama as cited above.

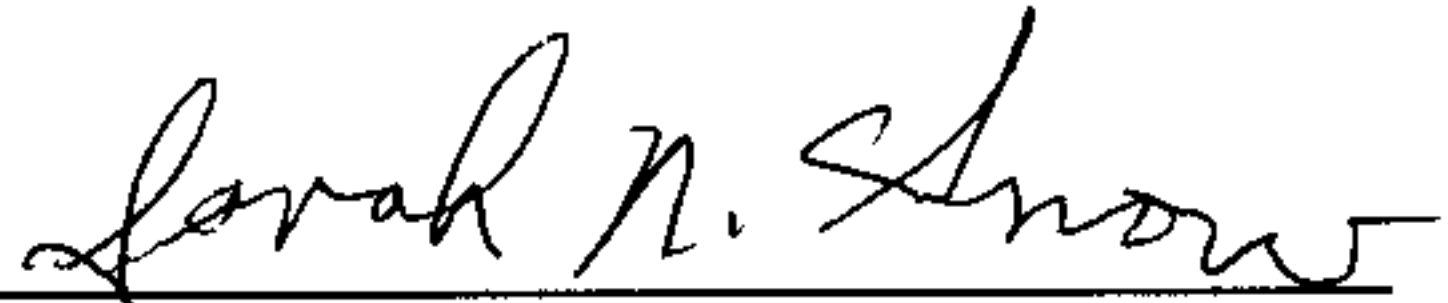

Sarah N. Snow

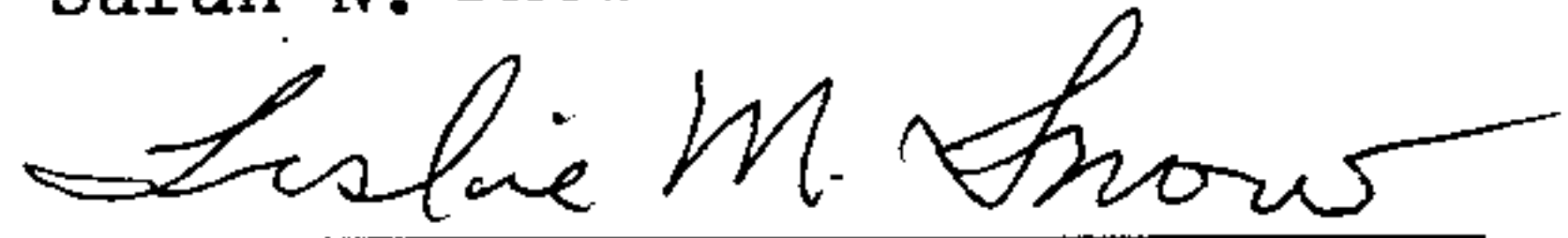

Leslie M. Snow

ANNEX. PET

