

COUNTY OF Jefferson

W. E. No.

61700-000675-300

Parcel No.

Also, sta# 1+00 to sta# 4+00
sta# 4+00 to sta# 4+175 (wds.)
Also, Guy on sta# 1, 2, 4

Freida Brown Leitman; a single woman, and 1/4 sole owner, and Eddie Leitman; a married man and 1/8 sole

KNOW ALL MEN BY THESE PRESENTS, That ^{12/16/93}
owner and Jerry ~~Leitner~~ ^{Leitman}; a married man and 1/8 sole owner and John S. Odess;
a married man and 1/2 sole owner

as grantor(s), (the "Grantor", whether one or more) for and in consideration of One and No/100 Dollars (\$1.00), and other good and valuable consideration, to Grantor in hand paid by Alabama Power Company (the "Company"), a corporation, the receipt of which is hereby acknowledged, do hereby grant to Company, its successors and assigns, the right to construct, install, operate and maintain, and the right to permit other corporations and persons to construct, install, operate and maintain, along a route to be selected by the grantee, (generally shown hatched on the attached drawing) its successors or assigns, all poles, wires, conduits, cables, trans closures and other appliances and facilities useful or necessary in connection therewith, for the overhead and underground transmission and distribution of electric power and for overhead and underground communication service upon, over, under and across the following described real property situated in Shelby County, Alabama (the "Property"), to wit:

The North 1/2 of the Northeast 1/4 of Section 2, Township 20 South,
Range 2 West.

BIRMINGHAM, AL 35291-1980

This instrument prepared in
Birmingham Div. Real Estate
Dept. of Alabama Power Co.
Birmingham, AL

BY Sara Park

Together with all the rights and privileges necessary or convenient for the full enjoyment or use thereof, including the right of ingress and egress to and from said facilities and the right to excavate for installation, replacement, repair and removal thereof; and also the right to cut and keep clear any and all obstructions or obstacles of whatever character on, under and above said facilities.

TO HAVE AND TO HOLD such easement to Company, its successors and assigns, forever.

IN WITNESS WHEREOF, We have set our hand(s) and seal(s) this the 15th day of December, 19 93.

WITNESS:

WITNESS:
Linda M. Datz
Linda M. Datz
Linda M. Datz
Catherine Gustin

GRANTOR(S):

GRANTOR(S):
 Frieda Braun Lehtinen (SEAL)
 Eddie Lehtinen (SEAL)
 Jerry Lehtinen (SEAL)
 [Signature] (SEAL)

IN WITNESS WHEREOF, the said Grantor, has caused this instrument to be executed by its President,
_____, who is authorized to execute this conveyance, has hereto set its
signature and seal on this the _____ day of _____, 19____.

ATTEST:

Bv:

Its: Secretary.

09/29/1994-29753
02:05 PM CERTIFIED
By: SHIRLEY COUNTY JUDGE OF PROBATE
002 MCD 13.50

NOTE: LOCATIONS 2-4 ARE
INACCESSIBLE BY TRUCK

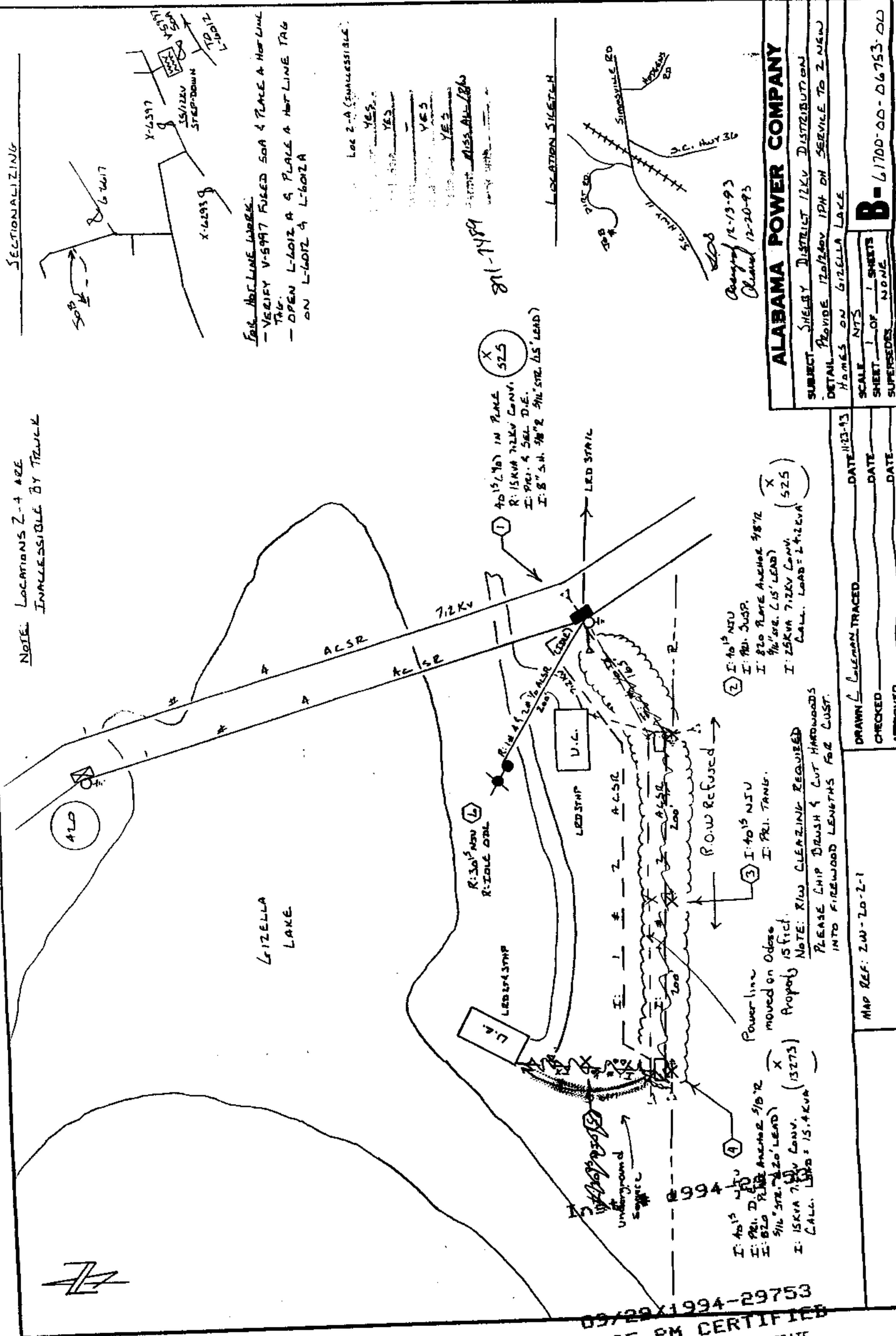

09/29/1994-29753
02:05 PM CERTIFIED
SHELBY COUNTY JUDGE OF PROBATE
002 MCD 13.50