

An ordinance to alter, rearrange and extend the corporate limits of the City of Hoover, Alabama, so as to embrace and include within the corporate limits of said City all territory now within such corporate limits and also certain other territory contiguous to said City.

WHEREAS, a petition signed by Highland Lake Property Limited, requesting that certain territory described therein be annexed to the City of Hoover; and

WHEREAS, there is attached to the said petition a map of said territory showing its relationship to the corporate limits of the City; and

WHEREAS, this Council has determined and found that the matters set forth and alleged in the said petition are true and that it is in the public interest that said property be annexed into the City of Hoover;

NOW THEREFORE, be it ordained by the Council of the City of Hoover as follows:

Section 1: That said Council hereby assents to the annexation of said territory to the City of Hoover, Alabama, and the corporate limits of the City of Hoover are hereby extended and rearranged pursuant to the provisions of Chapter 42, Article 2, Code of Alabama, 1975 (Sections 11-42-20 through 11-42-23, as amended) so as to embrace and include said territory, in addition to the territory already within its present corporate limits, within the corporate area of said City, which said territory is not within the corporate limits or municipal boundaries of another municipality and does not lie at any point more than one-half the distance between the present corporate limits and the corporate limits of any other municipality. Said property is described in Exhibit A attached hereto and made a part hereof.

Section 2: The City Clerk shall file a certified copy of this ordinance containing an accurate description of said annexed territory with the Probate Judge of Shelby County, Alabama, and also cause a copy of this ordinance to be published in a newspaper of general circulation in the City of Hoover.

06/21/1993-17990
10:04 AM CERTIFIED
SHELBY COUNTY JUDGE OF PROBATE
007 MCD 21.50

P.O. Box 360628
Hoover, AL 35236

ADOPTED by the Council of the City of Hoover, Alabama, on the

7th day of June, 199 .

W. H. Kelly
President of the Council

APPROVED:

[Signature]
Mayor

ATTESTED:

[Signature]
City Clerk

Exhibit "A"

Parcel I. Commence at a 3" capped iron locally accepted to be the northeast corner of said Section 5; thence run south along the east line of said Section 5 for a distance of 662.13 feet to an iron pin found at the point of beginning; thence turn an angle to the right of 89 degrees 01 minute 03 seconds and run in a westerly direction along the north line of the south one half of the northeast quarter of the northeast quarter of said Section 5 for a distance of 1,334.51 feet to an iron pin found; thence turn an angle to the left of 88 degrees 20 minutes 48 seconds and run in a southerly direction along the east line of said south one half for a distance of 656.30 feet an iron pin found; thence turn an angle to the left of 91 degrees 10 minutes 21 seconds and run in an easterly direction along the south line of said south one half for a distance of 675.42 feet to an iron pin found; thence turn an angle to the right of 90 degrees 27 minutes 45 seconds and run in a southerly direction for a distance of 2,188.82 feet to an iron pin set; thence turn an angle to the left of 147 degrees 45 minutes 14 seconds and run in a northeasterly direction for a distance of 3,440.60 feet to an iron pin set; thence turn an angle to the left of 124 degrees 36 minutes 53 seconds and run in a westerly direction for a distance of 1,169.70 feet to the point of beginning. Said Parcel I containing 70.00 acres more or less.

Parcel II:

Begin at a 3" capped iron locally accepted to be the northwest corner of said Section 4; thence run south along the west line of said Section 4 for a distance of 662.13 feet to an iron pin found; thence turn an angle to the left of 92 degrees 24 minutes 27 seconds and run in an easterly direction for a distance of 1,169.70 feet to an iron pin set; thence turn an angle to the left of 55 degrees 23 minutes 07 seconds and run in a northeasterly direction for a distance of 736.26 feet to an iron pin set on the north line of said Section 4; thence turn an angle to the left of 122 degrees 34 minutes 24 seconds and run in a westerly direction along the north line of said Section 4 for a distance of 1,561.11 feet to the point of beginning. Said Parcel II containing 20.00 acres more or less.

CLERK'S CERTIFICATION

I, Linda Crump, City Clerk for the City of Hoover, Alabama, hereby certify that the attached is a true and correct copy of Ordinance No. 93-1128 which was passed and adopted by the City Council of the City of Hoover on the 7th day of June, 1993, and that it has been published in a newspaper of general circulation and is now in full force and effect.

Linda Crump
City Clerk

STATE OF ALABAMA

SHELBY COUNTY

We, the undersigned, hereby request and petition the City of Hoover
to take whatever action is necessary to cause our property to be annexed
into the corporate limits of the City of Hoover.

NAME
(SIGNATURE OF OWNER(S))

ADDRESS

<u>HIGHLAND LAKES PROPERTIES, LTD</u>	<u>Suite 305 2700 Hwy 280</u>
<u>By: EDDLEMAN PROPERTIES INC</u>	<u>BIRMINGHAM</u>
<u>GENERAL PARTNER</u>	<u>AL 35223</u>
<u>Billy D Edleman CHARMAN/CEO</u>	<u>820 Shades Creek Parkway</u>
<u>Charles W. Daniel</u>	<u>B'ham, AL, 35209</u>
<u>Dantrant, Inc.</u>	



LEGAL DESCRIPTION:

CLERK'S CERTIFICATE

I herby certify that the attached is a true and correct copy of a petition(s) presented to the City Council of the City of Hoover by persons whose name(s) appear thereon, requesting that their property be annexed to the City of Hoover.

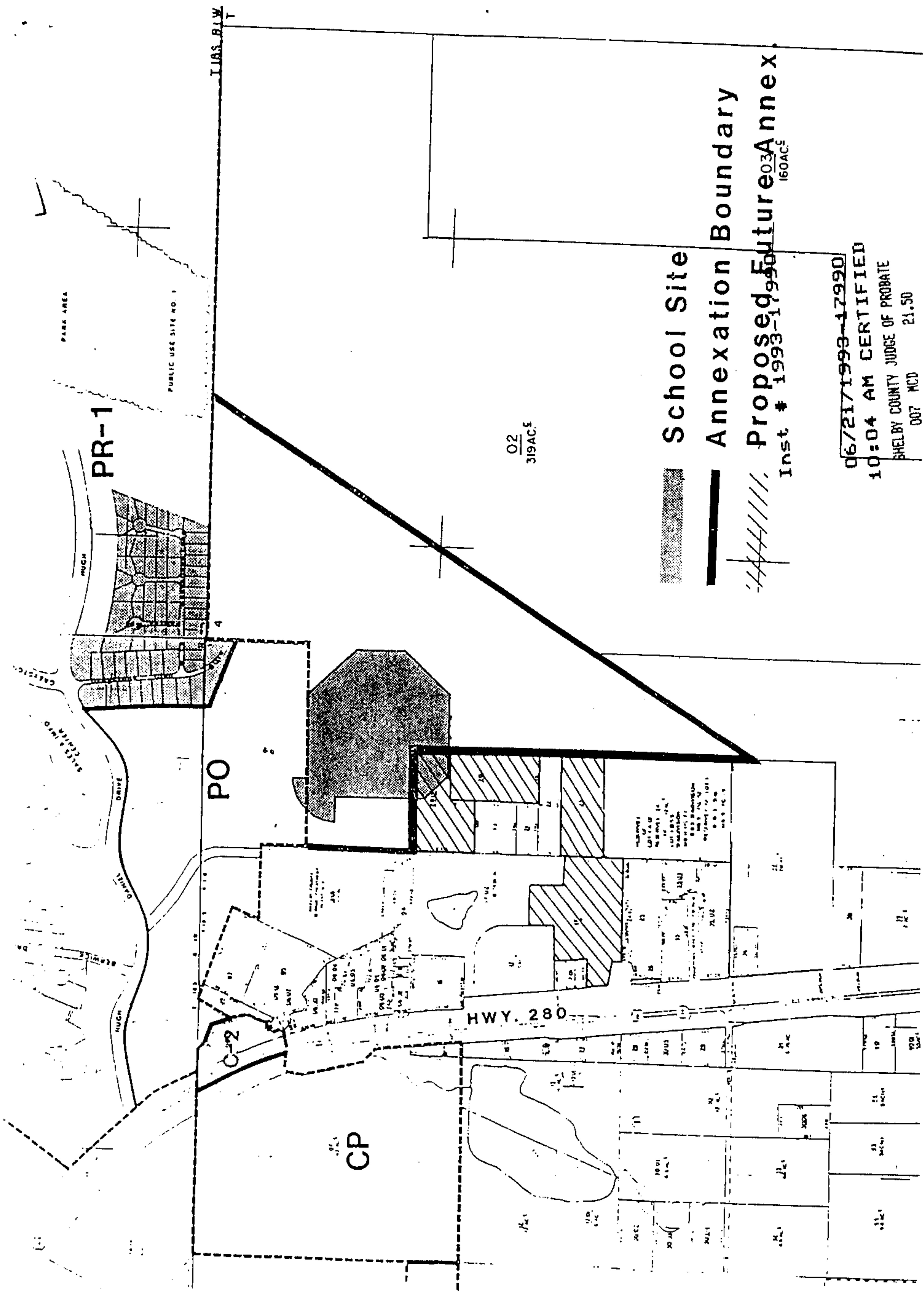
City Clerk



 School Site
 Annexation Boundary
 Proposed Future

Inst # 1993-17990

06/21/1993-17990
 10:04 AM CERTIFIED
 SHELBY COUNTY JUDGE OF PROBATE
 007 MCD 21.50