

TO WHOM IT MAY CONCERN:

RE: NORTHWEST CORNER OF SECTION 18,
TOWNSHIP 18 SOUTH, RANGE 1 EAST

On the 19th day of December 1973, I, C. Molton Williams (Grantee), acquired from Caldwell Marks and wife, Jeanne V. Marks; William M. Spencer, III and wife, Evalina B. Spencer; Carson G. Inscho, Jr. and wife, Dorothy H. Inscho; and Evelyn J. Haynes and husband, W. H. Haynes (Grantors), property (copy of deed attached as Exhibit #1) part of whose public access was by way of the chert roads known as Adams Road and Adams Lane in the northwest quarter of Section 18, Township 18 South, Range 1 East, Shelby County, immediately north of Shelby County Highway 41, otherwise known as Dunnivant Valley Road. The property I acquired from the above Grantors was acquired by them from S. W. Smyer, Jr. on December 15, 1967.

At the time I acquired said acreage from the above Grantors and since that time, Adams Road and Adams Lane were in place and were being maintained by Shelby County. During the time that said acreage was owned by S. W. Smyer, Jr. and continuously since that time, said Adams Road and Adams Lane were, to the best of my knowledge, maintained as public roads by the Shelby County Public Works Department. I attach the following exhibits to verify the above:

1. Copy of deed dated December 19, 1973, conveying said property to me.
2. Statement in letter form of June 4, 1992, from Kenneth R. Cole, P.E., County Engineer, Shelby County Public Works Department, stating that Adams Road for approximately 2,800 feet and Adams Lane for approximately 300 feet are presently maintained by the Shelby County Public Works Department.
3. Map from the Shelby County Highway Department showing the exact location of Adams Road and Adams Lane with reference to Shelby County Highway 41 and other landmarks.
4. Original letter from me to Marshall Alexander of Sterrett, Alabama, confirmed by him, that as a blade operator for Shelby County, he currently maintains said right-of-way for Shelby County. See the reverse side of said letter for his location map of Adams Lane (running in front of and to the west of the home of Paul and Betty Adams) and Adams Road.
5. Original letter from me to Mr. J. D. Davis of Chelsea, Alabama, dated April 21, 1992, confirmed by him, that he worked for many years for Shelby County as a blade operator until his retirement a few years ago, and that during the time of his employment for Shelby County he did maintain said Adams Road and Adams Lane as rights-of-way for Shelby County.
6. Statement by S. W. Smyer, Jr. that from 1950 to the time when he sold the property on December 15, 1967, that Adams Road and Adams Lane were maintained by Shelby County.

C. MOLTON WILLIAMS

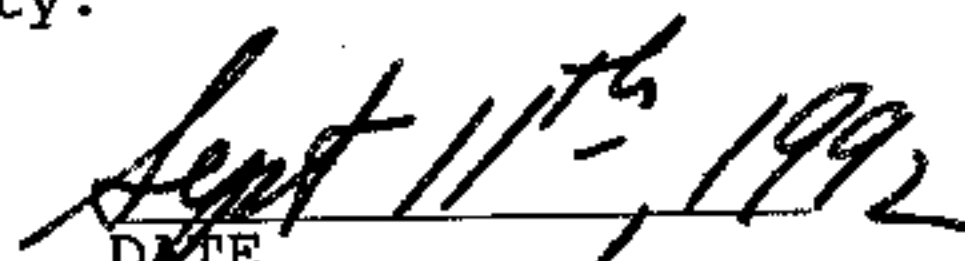
DATE

STATE OF ALABAMA)
COUNTY OF JEFFERSON)

I, Sandra D. Woolsteen, a Notary Public in and for said County, in said State, hereby certify that C. Molton Williams, who is known to me, executed the foregoing document.

Given under my hand and official seal this 11th day of September, 1992.

Notary Public

My Commission Expires: 12/05/92

Inst # 1992-22119

September 8, 1992

TO WHOM IT MAY CONCERN:

Re: Adams Road & Adams Lane
in Section 18, Township 18 South, Range 1 East.

I owned property adjacent to the above roads from approximately 1950 until
is sold same on December 15, 1967.

It is my best memory that these roads were continually maintained by
Shelby County during my ownership of this property.

Dated September 9, 1992.

S. W. Smyer, Jr.

337-2

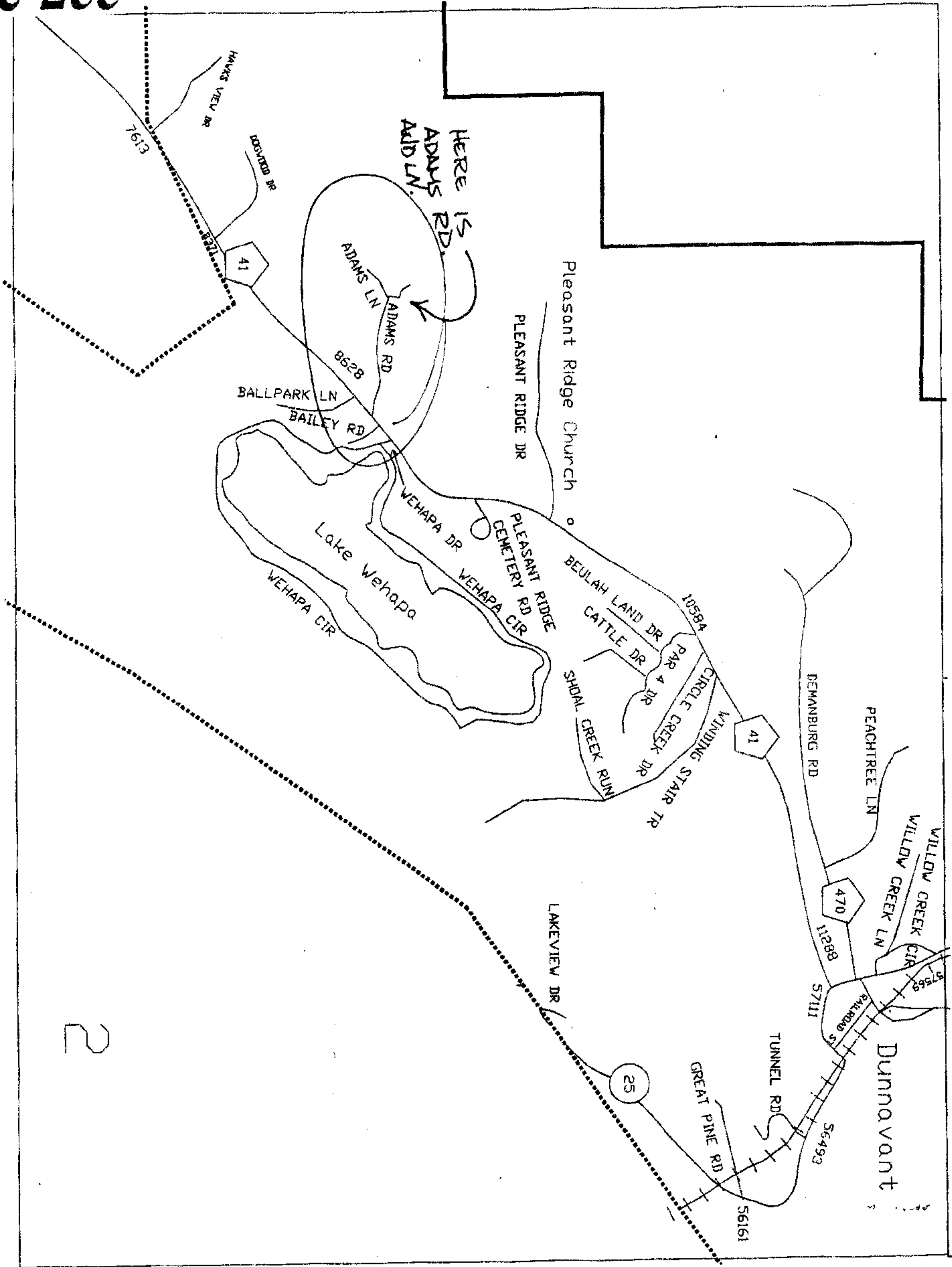

MOLTON, ALLEN & WILLIAMS CORPORATION

MORTGAGE BANKING • INSURANCE

Suite 500, 1000 Urban Center Parkway
P.O. Box 10025
Birmingham, AL 35202-0025 Phone (205) 967-0074

April 21, 1992

Mr. Marshall L. Alexander
P. O. Box 121
Sterrett, Alabama 35147

Dear Mr. Alexander:

Confirming our telephone conversation of this morning, it is my understanding that you work for the Highway Department of Shelby County as a blade operator.

In response to my question regarding Shelby County maintaining Adams Road, I want to first identify Adams Road. It is sometimes referred to as Lonnie Adams Road, deadends into the north side of Shelby County Highway 41 between the entrances to Holly Brook Lake and Wehapa Lake, and runs approximately to the north from Highway 41 to the top of the hill, passing through the approximately 15 acres owned by Mike Satterwhite, then the 10 acres owned by Lawrence and Lena Brasher, then the 10 acres owned by Mr. and Mrs. George, and in front of the house where old Mr. Adams lived shortly before he died at the approximate age of 103. Then the road continues a short distance until it forks, with the fork to the left going in front of Paul and Betty Adams' house and on up to the road on which Wayne Adams' trailer fronts at the top of the hill.

Your statement to me was that you, as a blade operator for Shelby County, currently maintain this Adams Road right-of-way for Shelby County.

I would like for you to confirm this information by dating and signing your name at the bottom of this letter so that I will have something in my file to confirm the maintenance work you currently do on Adams Road.

Thank you for this information and your help.

Very truly yours,



C. MOLTON WILLIAMS

CMW/sw

THE INFORMATION CONTAINED IN THIS LETTER IS CORRECT.

MARSHALL L. ALEXANDER

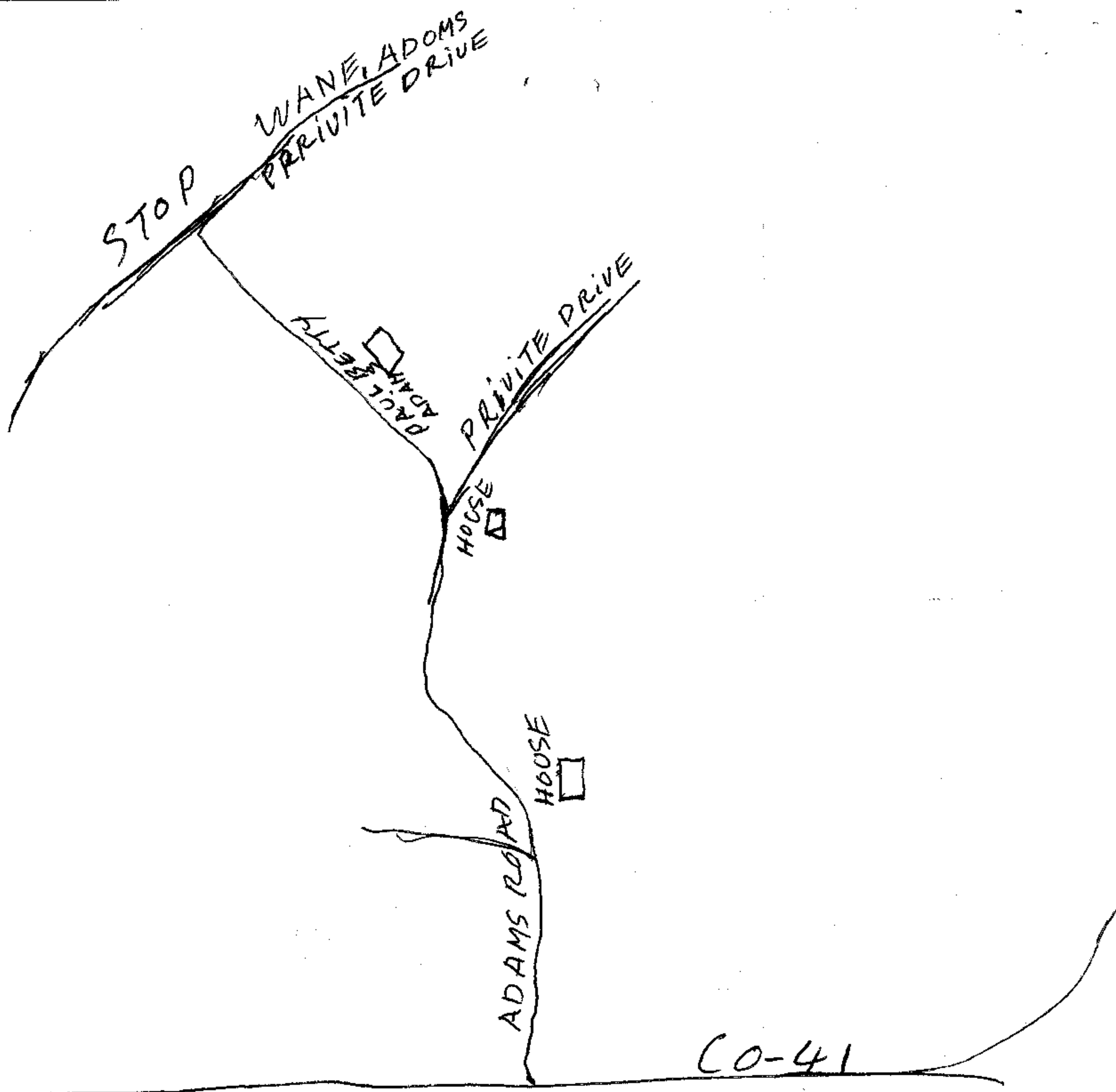
4-23-92
DATE



MOLTON, ALLEN & WILLIAMS CORPORATION

MORTGAGE BANKING • INSURANCE

Suite 500, 1000 Urban Center Parkway
P.O. Box 10025
Birmingham, AL 35202-0025 Phone (205) 967-0074

April 21, 1992

Mr. J. D. Davis
479 County Road 440
Chelsea, Alabama 35043

Dear Mr. Davis:

Confirming our telephone conversation of yesterday, it is my understanding that you recently retired from the Highway Department of Shelby County as a blade operator for many years.

In response to my question regarding Shelby County maintaining Adams Road, I want to first identify Adams Road. It is sometimes referred to as Lonnie Adams Road, deadends into the north side of Shelby County Highway 41 between the entrances to Holly Brook Lake and Wehapa Lake, and runs approximately to the north from Highway 41 to the top of the hill, passing through the approximately 15 acres owned by Mike Satterwhite, then the 10 acres owned by Lawrence and Lena Brasher, then the 10 acres owned by Mr. and Mrs. George, and in front of the house where old Mr. Adams lived shortly before he died at the approximate age of 103. Then the road continues a short distance until it forks, with the fork to the left going in front of Paul and Betty Adams' house and on up to the road on which Wayne Adams' trailer fronts at the top of the hill.

Your statement to me was that during the many years you worked for Shelby County as a blade operator, you did maintain this Adams Road right-of-way for Shelby County.

I would like for you to confirm this information by dating and signing your name at the bottom of this letter so that I will have something in my file to confirm the maintenance work you did on Adams Road for Shelby County.

Thank you for this information and your help.

Very truly yours,

C. MOLTON WILLIAMS

CMW/sw

THE INFORMATION CONTAINED IN THIS LETTER IS CORRECT.

J. D. DAVIS

DATE

Inst # 1992-22119

1992-22119
Inst #
10/08/1992-22119
AM CERTIFIED
08:06 AM
SHELBY COUNTY JUDGE OF PROBATE
19.00
006 NJS