

EASEMENT — OVERHEAD AND UNDERGROUND

W. E. No. 61700-08-0031-1-00

STATE OF ALABAMA

COUNTY OF SHELBY

Parcel No.

STA 3+00 TO STA 6+60  
ALSO: ALL SERVICES

KNOW ALL MEN BY THESE PRESENTS, That

Stephen H. Lee, a married man  
is SOLE OWNER dba Lee, Inc.

as grantor(s), (the "Grantor", whether one or more) for and in consideration of One and No/100 Dollars (\$1.00), and other good and valuable consideration, to Grantor in hand paid by Alabama Power Company (the "Company"), a corporation, the receipt of which is hereby acknowledged, do hereby grant to Company, its successors and assigns, the right to construct, install, operate and maintain, and the right to permit other corporations and persons to construct, install, operate and maintain, along a route to be selected by the grantee, (generally shown hatched on the attached drawing) its successors or assigns, all poles, wires, conductors, cables, trans closures and other appliances and facilities useful or necessary in connection therewith, for the overhead and underground transmission and distribution of electric power and for overhead and underground communication service

over, under and across the following described real property situated in SHELBY County, Alabama (the "Property"), to wit:

PARK PLACE - FIRST Addition - PHASE I AS RECORDED  
IN MAP BOOK 15, PAGE 47 IN THE OFFICE OF  
THE JUDGE OF PROBATE.

Sec 10, TWP 21 S, R 3 W

Inst # 1992-08-41  
05/15/1992-08-41  
02:17 PM CERTIFIED  
SHELBY COUNTY JUDGE  
003 HED

Together with all the rights and privileges necessary or convenient for the full enjoyment or use thereof, including the right of ingress and egress to and from said facilities and the right to excavate for installation, replacement, repair and removal thereof; and also the right to cut and keep clear any and all obstructions or obstacles of whatever character on, under and above said facilities.

TO HAVE AND TO HOLD such easement to Company, its successors and assigns, forever.

IN WITNESS WHEREOF, have set hand(s) and seal(s) this the day of , 19

WITNESS:

GRANTOR(S):

GRANTEE'S ADDRESS  
ALABAMA POWER CO.  
15 SOUTH 20TH STREET  
BIRMINGHAM, AL 35233

This instrument prepared in  
Birmingham Div. Real Estate (SEAL)  
Dept. of Alabama Power Co. (SEAL)  
Birmingham, AL (SEAL)  
By Sam Parks (SEAL)

IN WITNESS WHEREOF, the said Grantor, has caused this instrument to be executed by its President,

Stephen H. Lee, who is authorized to execute this conveyance, has hereto set its signature and seal on this the 10 day of November, 1991.

ATTEST:

By:

Its: Secretary.

By:

Its: President

STATE OF ALABAMA

COUNTY OF SHELBY

I, the undersigned, a Notary Public, in and for said County in said State, hereby certify that Stephen H. Lee, a  
married man & sole owner dba Lee, Inc.

whose name(s) IS signed to the foregoing instrument and who IS known to me, acknowledged before me on this day that being informed  
of the contents of the instrument, he executed the same voluntarily, on the day the same bears date.

Given under my hand and official seal, this the 10<sup>th</sup> day of December, 19 91.

[SEAL]

Don D. Bailey  
Notary Public

My commission expires: 4-1-95

STATE OF ALABAMA

COUNTY OF \_\_\_\_\_

I, the undersigned, a Notary Public, in and for said County in said State, hereby certify that \_\_\_\_\_

whose name(s) \_\_\_\_\_ signed to the foregoing instrument and who \_\_\_\_\_ known to me, acknowledged before me on this day that being informed  
of the contents of the instrument, \_\_\_\_\_ executed the same voluntarily, on the day the same bears date.

Given under my hand and official seal, this the \_\_\_\_\_ day of \_\_\_\_\_, 19 \_\_\_\_\_.

[SEAL]

\_\_\_\_\_  
Notary Public

My commission expires: \_\_\_\_\_

STATE OF ALABAMA

COUNTY OF SHELBY

I, the undersigned Don D. Bailey, a Notary Public, in and for said County in said State, hereby certify that  
Stephen H. Lee, whose name as President of  
Lee, Inc.

a corporation, is signed to the foregoing instrument, and who is known to me, acknowledged before me on this day that being informed of the  
contents of the instrument, he, as such officer and with full authority, executed the same voluntarily for and as the act of said corporation.

[SEAL]

Don D. Bailey  
Notary Public

My commission expires: 4-1-95



NOTES

1. THE PRIMARY CONDUCTOR WILL BE 1 #1/0 ALUM. 35KV CABLE IN A 48" TRENCH UNLESS NOTED OTHERWISE.
2. THE SECONDARY AND SERVICE CONDUCTORS WILL BE 1 #2/0 & 2 #4/0 ALUM. 600V CABLE. THE SECONDARY WILL BE IN A 48" TRENCH AND THE SERVICE IN A 36" TRENCH.
3. THE PRIMARY CONDUCTOR WILL BE INSTALLED IN 3" DB PVC CONDUIT ON ALL ROAD CROSSINGS. THE SECONDARY WILL BE INSTALLED IN 2" DB PVC CONDUIT ON ALL ROAD CROSSINGS.
4. APCO CONTRACTOR WILL PERFORM ALL TRENCHING AND INSTALL TRANSFORMER PADS, GROUND RODS, CONDUIT, PRIMARY, SECONDARY AND SERVICE CONDUCTOR.
5. THE TRANSFORMER LOADING IS BASED ON L.R.D. 4T A/C.
6. THE RISER LOADING IS BASED ON 10KVA PER LOT.
7. THE AVERAGE SERVICE LENGTH IS 70 FEET.
8. A 200A FAULT INDICATOR WILL BE INSTALLED IN EACH TRANSFORMER.
9. THE VOLTAGE DROP AND FLICKER PERCENTAGES ARE THE WORST CASE FOR EACH TRANSFORMER LOCATION.

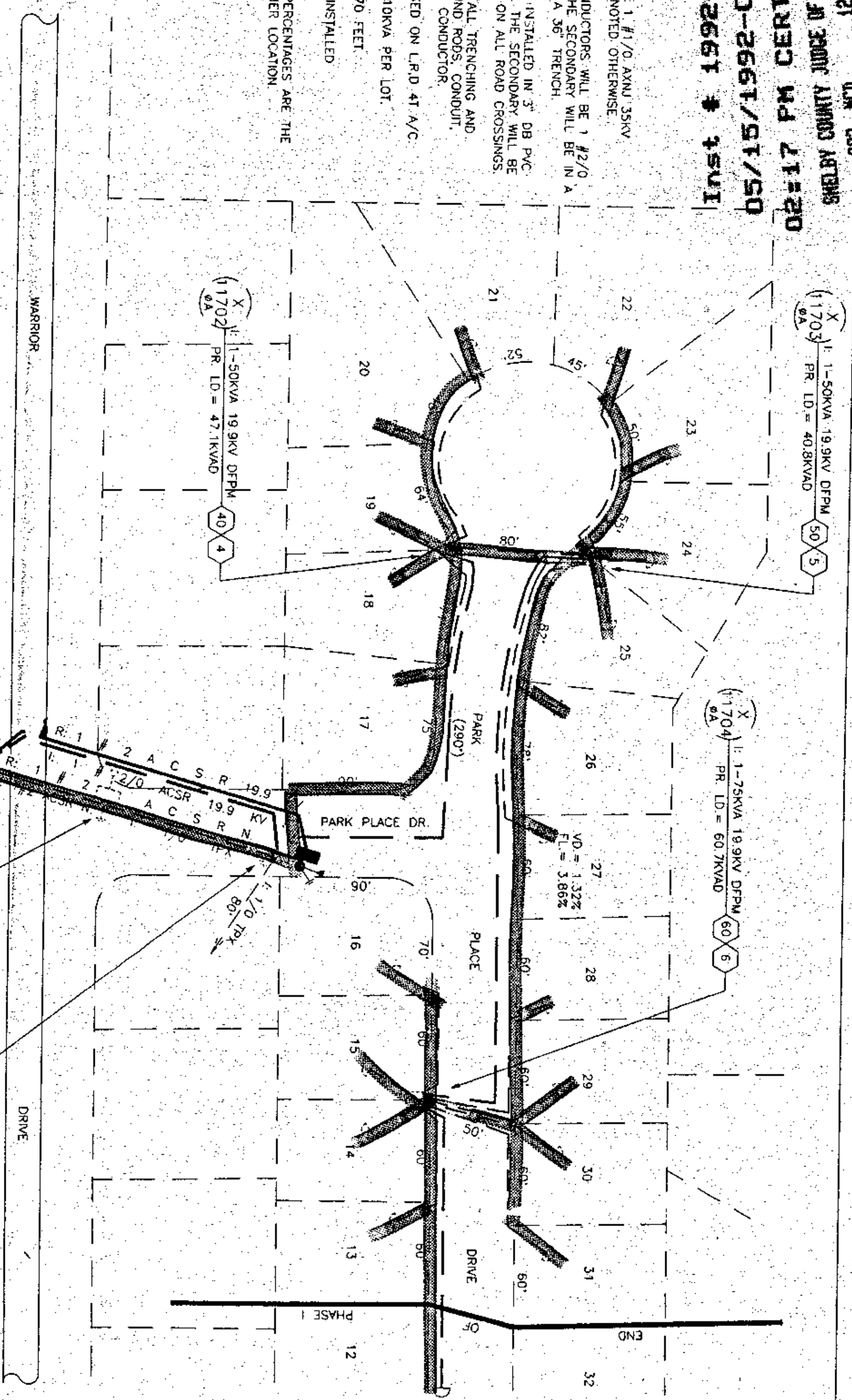

SECTIONALIZING SKETCH

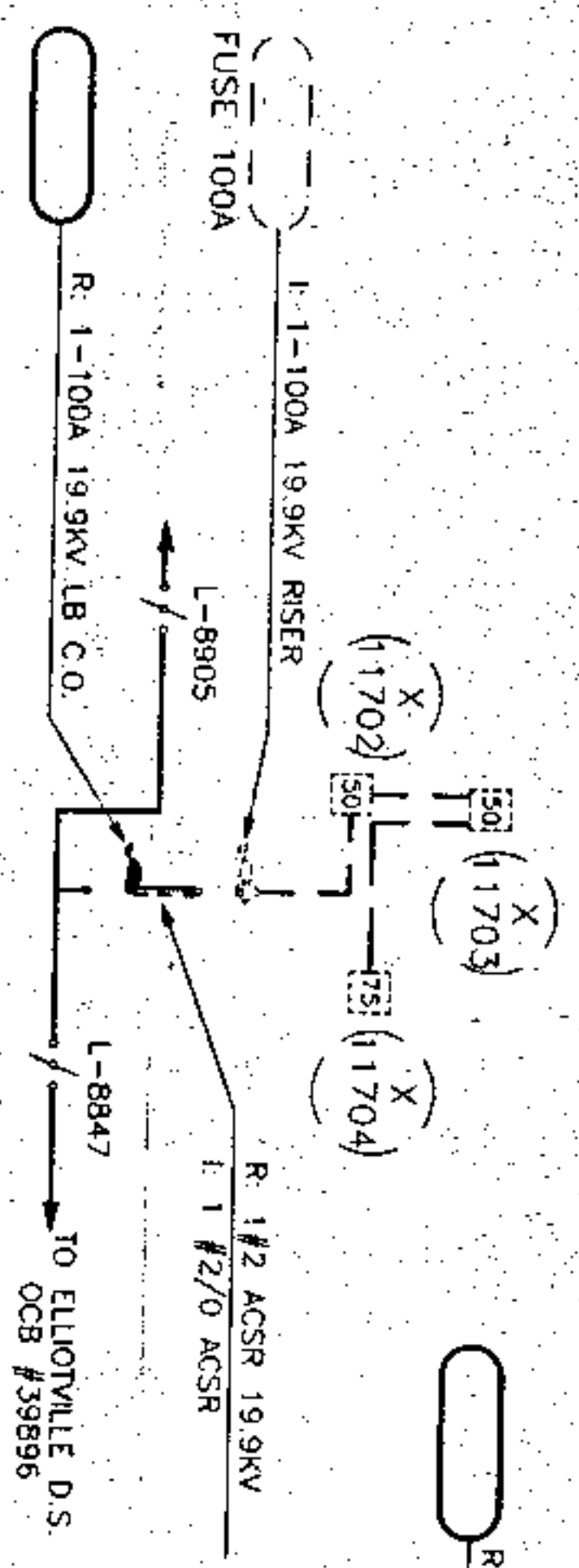

LOCATION SKETCH

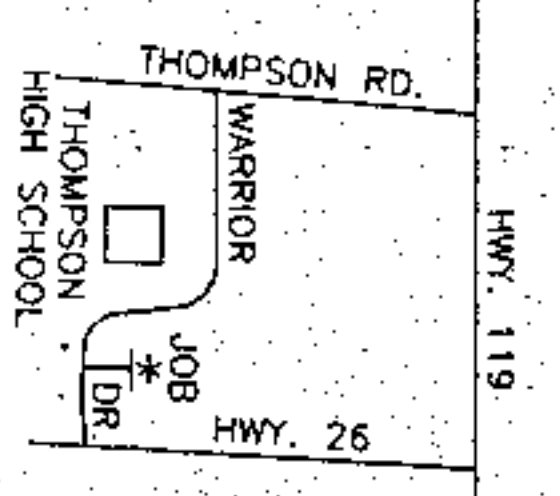

HOT LINE INFO

1. OPEN 39896A & PLACE A HOT LINE TAG ON OCB #39896 & 39896A AT ELLIOTTSVILLE D.S.

PLAN SCALE 1" = 50'

STATION TO STATION  
AS SHOWN AT STATION 2000+

OVERHEAD  
RIGHT OF WAY  
WIDTH IS THIRTY  
(30) FEET

UNDERGROUND  
RIGHT OF WAY  
WIDTH IS TEN  
(10) FEET

MAP REF: SW-21-10-4 SEC-10-1P-215R-3W	ALABAMA POWER COMPANY
DRAWN: ROBIN CHEN, E. BIDET, DATE: 05/21/91	JOB: NORTH SHELBY 34.5KV DISTRIBUTION
APPROVED: DATE: _____	DETAIL: PROVIDE PARK PLACE FIRST ADDITION
SHEET 1 OF 1 SHEETS	SCALE: 1" = 50' PLOTTED: 6-20-91
SUPERVISOR: _____	DATE: _____
	F-61700-08-00311-00