

Grant Of Land Easement By Landowner
For Use Of Alabama Power Company
In Providing Electric Service To Landowner's Premises,
And Adjacent Property Of Others
To Which Service Is Being Simultaneously Extended

STATE OF ALABAMA

COUNTY OF SHELBY

61700-40-0014-1-00
W.E. 61700-06-0001-0-00

Parcel # 554317

STA 3100 To STA 4100
STA 1100 To STA 2100

61700-06-0010-007

61700-40-001417

STA 1100 (SOUTH) To STA 6100
STA 2100 (WEST) To STA 8100
STA 1100 (WEST) To STA 12100

1. KNOW ALL MEN BY THESE PRESENTS, That Landowner(s)

ROSC ASSOCIATES JOINT VENTURE

(By: Metropolitan Contractors, Inc., sole general partner of Riverchase Office Park, L.L.C. a joint venture of Rosc Associates Joint Venture)
(the "Grantor", whether one or more) hereby applies to Alabama Power Company, a corporation (the "Company") for electrical service at 2300 RIVERCHASE OFFICE CIRCLE, BIRMINGHAM, AL 35244

Grantor is the owner of the land and premises located at the above address, which by the parties are deemed to be legally described herein precisely as described and mapped in Grantor's ad valorem tax assessment for such land and premises in the office of the Tax Assessor of SHELBY County, Alabama, as if herein set out in full detail (the "Property"), and generally described as located in the following described parcel:

LOT 1-B OF THE RESURVEY OF LOT 1
OF RIVERCHASE OFFICE PARK, PHASE II
AS RECORDED IN MAP BOOK 14, PAGE
99.

NE 1/4 - SE 1/4
SEC. 19, T19S, R2W

2. To provide the requested electric service to Grantor (and adjacent premises of others to which service is being simultaneously extended), Company must, and may, install on the Property from time to time, some or all of the following: electric poles, electric distribution lines, service laterals, metering equipment, transformers, guys, anchors, and equipment related thereto, both above and below ground, and must, and may, accomplish the cutting and trimming of trees both now and in the future to accommodate such facilities.

3. Grantor, in consideration of (a) the construction of the necessary service facilities, (b) the furnishing of electric service at Company's published rates, and, (c) the payment of one dollar and other good and valuable consideration, the receipt of which is hereby acknowledged, hereby grants, (for himself, his heirs, successors and assigns) to Company the right to install, improve, remove, maintain, and replace, upon, over, and under the Property such of the above electric facilities as are appropriate in the opinion of Company, to provide such requested service or services, at locations on Grantor's land (and adjacent premises of others to which service is simultaneously being extended), deemed appropriate for such service or services by Company, and agreed to by Grantor at time of original extension of service or services (together with necessary and reasonable changes therein and extensions thereto to serve the property and premises of Grantor and adjacent premises described above, if any) together with all rights and privileges necessary or convenient for the full enjoyment or use thereof, including the right to clear and keep cleared all trees, undergrowth, growth on, and other obstructions, within a strip of land extending fifteen feet (15') on either side of the center line of the facilities as constructed, that would in the opinion of Company interfere with such facilities, and the right to cut all dead, weak, leaning or dangerous trees or limbs outside the said thirty foot (30') strip which, in the sole opinion of the Company, might endanger, interfere with or fall upon the poles, lines or other appliances of said Company.

Facilities to be installed under this agreement may be utilized in providing electric service to the Grantor and other Company customers located on property adjacent to the Property and with such service to adjacent property being extended and constructed simultaneously with the building of service facilities to Grantor.

The precise location on the property where the facilities are installed shall be conclusively deemed to be the location described in this grant for the placement of all such facilities. It is the intention of the parties that this grant shall be an easement on, under and over Grantor's land and shall be binding in the future on Grantor's successors, heirs and assigns.

4. Company shall have the rights of ingress and egress to and from the easement and the Property of Grantor for the purpose of installing, constructing, operating and maintaining its facilities in accordance with accepted industry standards.

In the event it becomes necessary or desirable for Company to move its lines of poles and appliances in connection with the construction or improvement of any public road or highway in proximity to its said power lines, Company is hereby granted the right to relocate its said lines of poles and appliances on lands of Grantor hereinabove described, provided, however, the said Company shall relocate its said lines of poles at a distance not greater than ten feet (10') outside the boundary of the right of way of any such public road or highway as established or re-established from time to time.

TO HAVE AND TO HOLD such easement to Company, its successors and assigns, forever.

IN WITNESS WHEREOF, _____ have set _____ hand(s) this the _____ day of _____, 19 _____

WITNESS:

GRANTOR(S)

This instrument prepared in
Birmingham Div. Real Estate
Dept. of Alabama Power Co.
Birmingham, AL

By Sara Parks

GRANTEE'S ADDRESS
ALABAMA POWER CO
15 SOUTH 20TH STREET
BIRMINGHAM, AL 35233

(SEAL)

(SEAL)

(SEAL)

(SEAL)

BOOK 337 PAGE 710

IN WITNESS WHEREOF, the said Grantor, has caused this instrument to be executed by its President, Raymond Gottlieb, who is authorized to execute this conveyance, has hereto set its signature and seal on this the 30th day of January, 1991.

Attest

By: Margaret M. Robinson
Its: Secretary

ROSC ASSOCIATES JOINT VENTURE
BY: RIVERCHASE OFFICE PARK, LTD.
BY: METROPOLITAN CONTRACTORS, INC.
By: Raymond Gottlieb
Its: President

STATE OF ALABAMA }
COUNTY OF Jefferson

I, the undersigned, a Notary Public, in and for said County in said State, hereby certify that Raymond Gottlieb, whose name as President of Metropolitan Contractors Inc. is known to me, acknowledged before me on this day that, being informed of the contents of the instrument, he is known to me, acknowledged before me on this day that, being informed of the contents of the instrument, he as such officer and with full authority, executed the same voluntarily for and as the act of said corporation in its capacity as aforesaid.
Given under my hand and official seal this the 30 day of January, 1991.

Margaret M. Robinson
Notary Public
My commission expires: 3/16/93

[SEAL]

STATE OF ALABAMA }
COUNTY OF _____

I, the undersigned, a Notary Public, in and for said County in said State, hereby certify that _____ whose name(s) _____ signed to the foregoing instrument and who _____ known to me, acknowledged before me on this day that, being informed of the contents of the instrument, _____ executed the same voluntarily, on the day the same bears date.
Given under my hand and official seal this the _____ day of _____, 19____.

Notary Public
My commission expires: _____

[SEAL]

STATE OF ALABAMA }
COUNTY OF _____

I, the undersigned, a Notary Public, in and for said County in said State, hereby certify that _____ whose name(s) _____ signed to the foregoing instrument and who _____ known to me, acknowledged before me on this day that, being informed of the contents of the instrument, _____ executed the same voluntarily, on the day the same bears date.
Given under my hand and official seal this the _____ day of _____, 19____.

Notary Public
My commission expires: _____

[SEAL]

Diagram illustrating a proposed cable route layout between four buildings (Building 1, Building 2, Building 3, and Building 4) and an office area. The route is marked with a thick line and includes various annotations:

- Building 1:** Contains a circled 'X' labeled '8574'.
- Building 2:** Contains a circled 'X' labeled '8575'.
- Building 3:** Contains a circled 'X' labeled '8577'.
- Office Area:** Labeled 'OFFICE'.
- Proposed Cable Route:** A thick line connects the buildings and office, with annotations including:
 - 'R. & E 3 1/0 SPICES' (near Building 1 and Building 2)
 - 'TRAFFIC B INSTALLED' (near Building 3)
 - 'PARKWAY' (top right)
 - 'OFFICE ROAD' (bottom left)
 - 'RIVERCHASE' (bottom left)
- Other Annotations:**
 - 'X 8574' and 'X 8575' are circled and labeled.
 - 'X 8577' is circled and labeled.
 - 'R. & E 3 1/0 SPICES' is written twice.
 - 'TRAFFIC B INSTALLED' is written near Building 3.
 - 'PARKWAY' is written at the top right.
 - 'OFFICE ROAD' is written at the bottom left.
 - 'RIVERCHASE' is written at the bottom left.

R: 3 1/0 SPLICES L: 6 1/0 SPLICES
CUSTOMER TO RELOCATE PULLBOX 1000
IN CONFLICT WITH PROPOSED PARKING AREA

R: 4 ± 3 / 1/0 SPLICES

E 3 #1/0 ALUM 35KV CABLE
2-5' CONDUITS PROVIDED
BY CUSTOMER (360°)

BOOK 337 PAGE 713

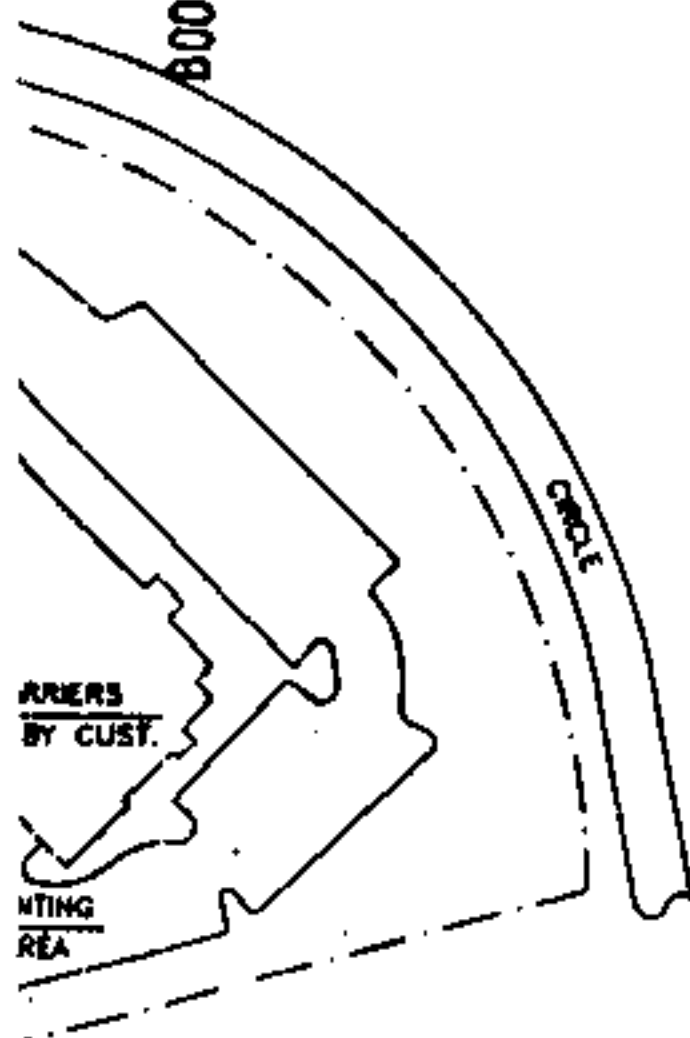

20 E 750KVA 34.5KV - 277/480V DFPN LOOP FEED (X) 8576
CALC. LD. = 634.4KVA

1E IN
D & INSTALLED

LOCATION SKETCH

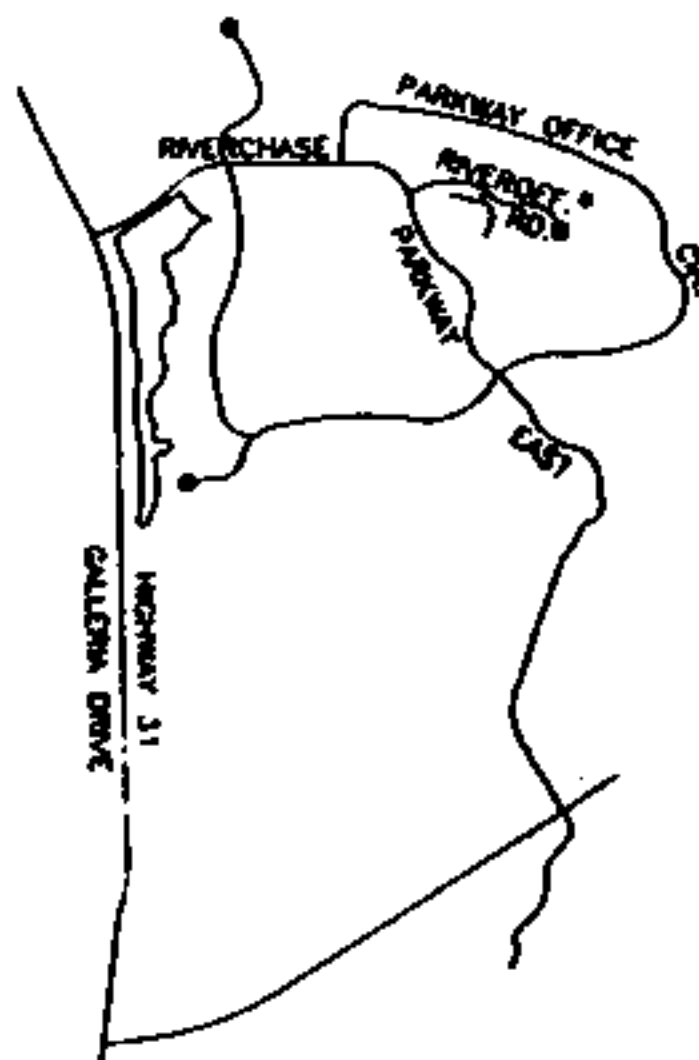

NON WIDTH OBSERVED 10 ft
CUT ON TOWN

0 50 150
PLAN SCALE



MAP REF: 2W-19-19-4 SEC-19.TP-19S.R-2W
DRAWN RONN ENGR C. COLEMAN DATE 11/14/90
APPROVED _____ DATE _____
APPROVED _____ DATE _____

554317

ALABAMA POWER COMPANY

JOB NORTH SHELBY 34.5KV DISTRIBUTION
DETAIL TO PROVIDE 277/480V OF SERVICE TO
METROPOLITAN PROPERTIES BLDG 700

SCALE 1" = 80' PLOTTED 2-5-91
SHEET 1 OF 1 SHEETS
SUPERSEDES C-61700-06-00010-00

2-6-91

- I: 11- 150W (15000L) HPS "BOX TYPE"
CUTOFF OPTICS FIXTURES ON
20' BRONZE FG POLES.
- CHANGE BALLAST TAPS FOR 277V
OPERATION
 - USE 277V P.E. CELLS
 - USE ONE FUSED & ONE NON-FUSED
BREAK-AWAY CONNECTOR AT EACH POLE
(FUSED ZB-20058; NON-FUSED ZB-20066)
(SEE PLATE LP-25)

BOOK 337 PAGE 714

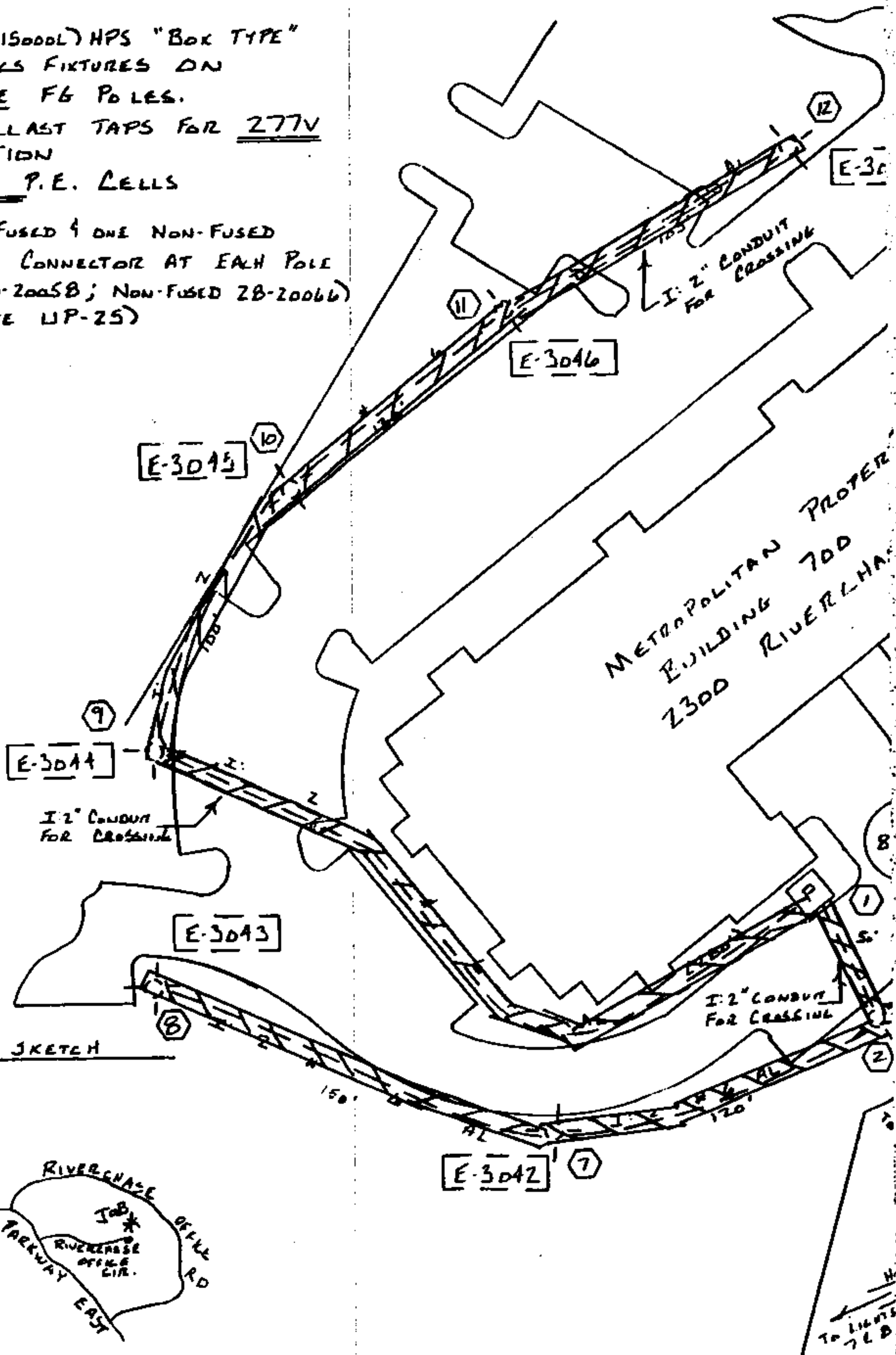

LOCATION SKETCH

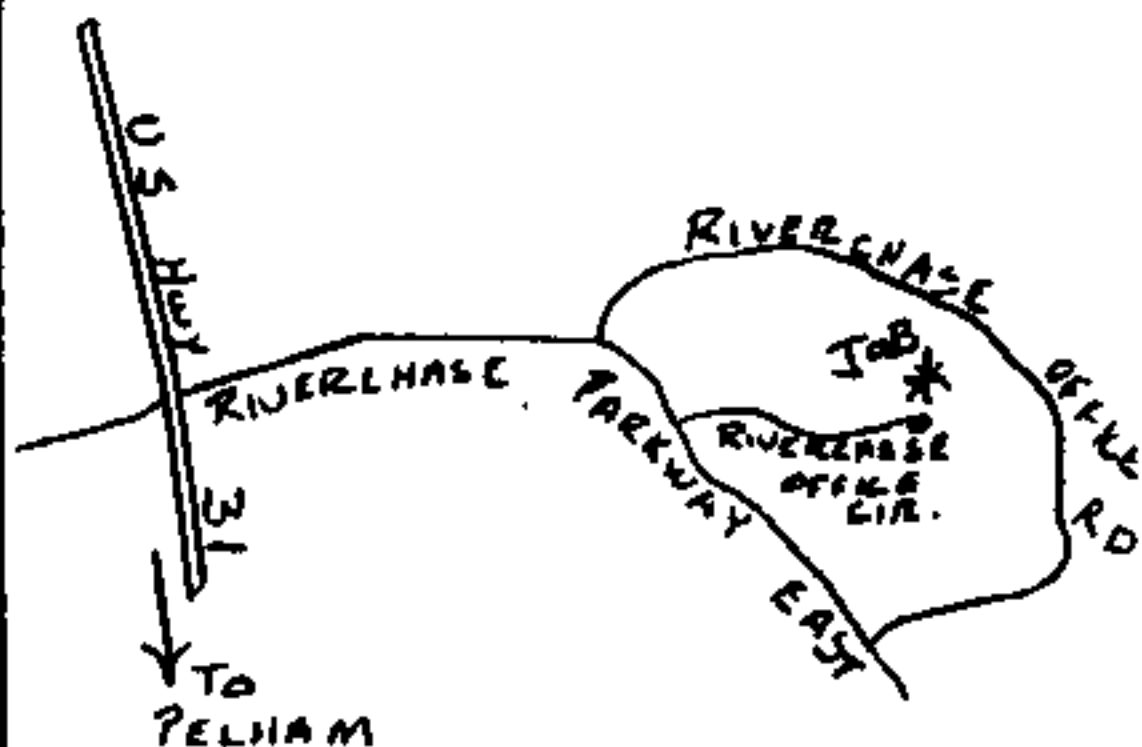

MAP REF: 2W-19-19-4

DRAWN P. Col
CHECKED _____
APPROVED _____

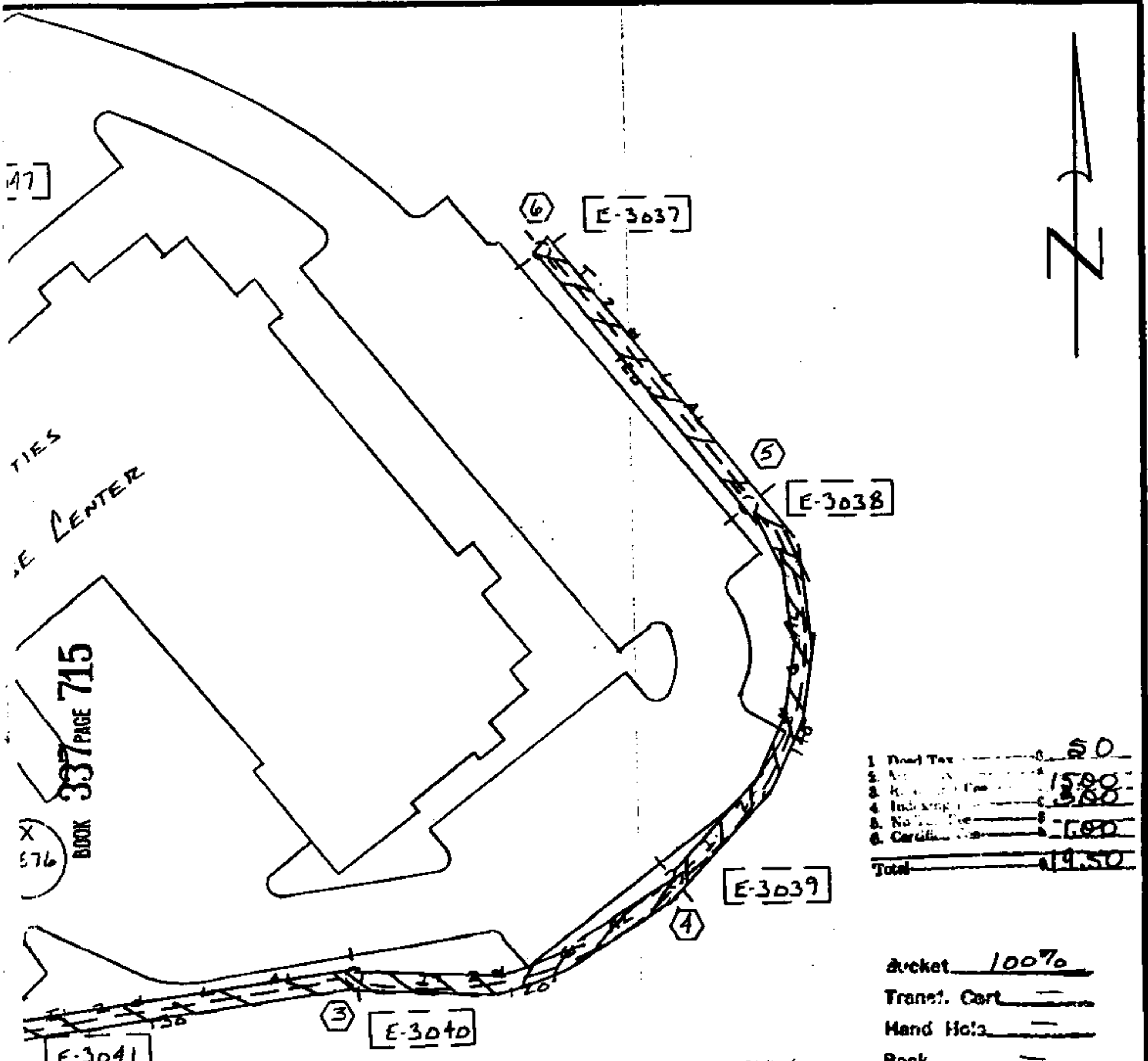

BOOK 337 PAGE 715
X 576

1. Road Tax	50
2. ...	15.00
3. ...	3.00
4. ...	1.00
5. ...	1.00
6. ...	1.00
Total	19.50

Bucket 10070
 Transl. Cart —
 Hand Hols —
 Rock —
 Tree Crew —
 Staked CALL ENG.
 Permit —
 Work with 617DD-4D-DD1A1

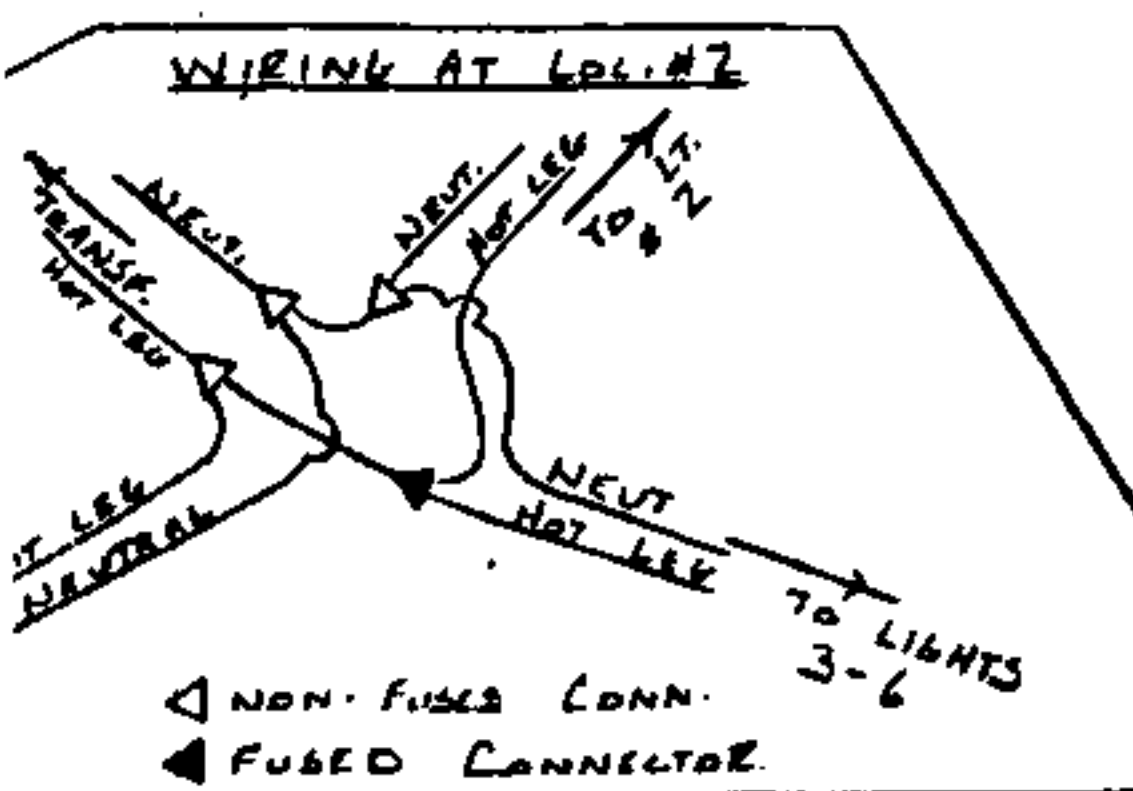

STATE OF ALA. SHELBY CO.
 I CERTIFY THIS INSTRUMENT WAS FILED
 91 APR 10 PM 1:45
 JUDGE OF PROBATE

DATE 1-7-91
 DATE —
 DATE —

ALABAMA POWER COMPANY	
SUBJECT <u>NORTH SHELBY 35KV DISTRIBUTION</u>	
DETAIL <u>PROVIDE AREA LIGHTING FOR METROPOLITAN</u>	
PROPERTIES - <u>BUILDING 700</u>	
SCALE <u>NTS</u>	B-617DD-4D-DD1A1
SHEET <u>1</u> OF <u>1</u> SHEETS	
SUPERSEDES <u>NONE</u>	

2-5-91