

Application For Electric Service Made By Applicant
Owning The Land And Premises To Be Served; And
Grant Of Land Easement By Landowner For Use Of
Alabama Power Company In Providing Such Electric Service

W.E. 61700-00-0045-1-00
Parcel # 556439
STA 2100 To STA 21290
Also: Guy AT STA 2100

1. Landowner (s) GARY L. NEWTON & WIFE, JANET D. NEWTON

(Grantor) hereby applies to Alabama Power Company (Company) for electrical service at 3004 INDIAN CREST DRIVE, PELHAM, AL. 35124

Grantor is the owner of the land and premises located at the above address, which by the parties are deemed to be legally described herein precisely as described and mapped in Grantor's ad valorem tax assessment for such land and premises in the office of the Tax Assessor of 5th/164 County, Alabama, as if herein set out in full detail.

2. To provide the requested electric service Company must install on such premises, from time to time, some or all of the following: electric poles, electric distribution lines, service laterals, metering equipment, transformers, guys, and equipment related thereto, both above and below ground, and must accomplish the cutting and trimming of trees both now and in the future to accommodate such facilities.

3. Grantor, in consideration of (a) the construction of the necessary service facilities, (b) the furnishing of electric service at Company's published rates, and, (c) the payment of one dollar and other good and valuable considerations, hereby grants, (for himself, his heirs, successors and assigns) to Company the right to install, improve, remove, maintain, and replace, upon, over, and under the above described lands such of the above electric facilities as are appropriate in the opinion of Company, to provide such requested service, at locations on Grantor's land deemed appropriate for such service by Company, and agreed to by Grantor at time of original extension of service (together with necessary and reasonable changes therein and extensions thereto to serve the land and premises) and construction of facilities, together with the right to clear and keep cleared all growth or obstructions within a strip of land fifteen feet on either side of the facilities as constructed, that would in the opinion of Company interfere with such facilities.

The precise physical location on the land where the facilities are installed shall be conclusively deemed to be the location described in this grant for the placement of all such facilities. It is the intention of the parties that this grant shall be an easement on, under and over Grantor's land and shall bind in the future Grantor's successors, heirs and assigns.

4. Alabama Power Company shall have the rights of ingress and egress to and from the within described land and premises for the purpose of installing, constructing, operating and maintaining its facilities in accordance with accepted industry standards.

TO HAVE AND TO HOLD such easement to Alabama Power Company, its successors and assigns, forever.

Given under OUR hands and seal 5 this the 11th day of FEBRUARY, 19 91.

WITNESS:

GRANTOR (S)
LANDOWNER OR LANDOWNERS

Gary L. Newton (SEAL)
Janet D. Newton (SEAL)

_____ (SEAL)

SE 1/4 - SW 1/4
Sec. 15
T. 19S
R. 2W

GRANTEE'S ADDRESS
ALABAMA POWER CO.
15 SOUTH 20TH STREET
BIRMINGHAM, AL 35233

(SEAL)
This instrument prepared in
Birmingham Div. Real Estate
Dept. of Alabama Power Co.
Birmingham, AL
By Sara Parks

IN WITNESS WHEREOF, the said _____ has caused this instrument to be executed in its name by _____ as its President and attested by _____, its Secretary, and its corporate seal to be affixed, on this _____ day of _____, 19 _____

Attest

In President

STATE OF ALABAMA
County of SHELBY }

I, DON D. BAILEY, a NOTARY PUBLIC STATE AT LARGE
in and for said County in said State, hereby certify that GARY L. NEWTON & WIFE, JANET
D. NEWTON

whose name ARE signed to the foregoing instrument and who ARE known to me, acknowledged before me
on this day that being informed of the contents of the instrument THEY executed the same voluntarily, on the
day the same bears date.

Given under my hand and official seal this the 11th day of FEBRUARY, 1991

Don D. Bailey
NOTARY PUBLIC STATE AT LARGE

BOOK 337 PAGE 740

STATE OF _____
County of _____ }

I, _____, a _____
in and for said County in said State, hereby certify that _____
whose name _____ signed to the foregoing instrument and who _____ known to me, acknowledged before me
on this day that being informed of the contents of the instrument _____ executed the same voluntarily, on the
day the same bears date.

Given under my hand and official seal this the _____ day of _____, 19____

STATE OF _____
County of _____ }

I, _____, a _____
in and for said County in said State, hereby certify that _____
whose name as President of _____, a corporation,
is signed to the foregoing instrument, and who is known to me, acknowledged before me on this day that, being
informed of the contents of the instrument, he, as such officer and with full authority, executed the same volun-
tarily for and as the act of said corporation.

Given under my hand and official seal this the _____ day of _____, 19____

SKETCH OF PROPOSED WORK — SIMPLIFIED W. E.

Alabama Power

Customer DR. GARY NEWTON		Location 3004 INDIAN CREST DR		Agreed Serv. Date		Estimate No. 61700-00-00451-00	
Division B'HAM		District NORTH SHELBY		Town INDIAN SPRINGS VILLAGE		Drawn by J FRENCH	
County SHELBY		Section 10		Township 19S		Range 2W	
Acquisition Agent D. BAILEY		Date R/W Assigned 2-11-91		Date R/W Cleared 2-11-91		Map Reference 2W-19S-15 SHR 3	
				LOC		Transformer Loading	

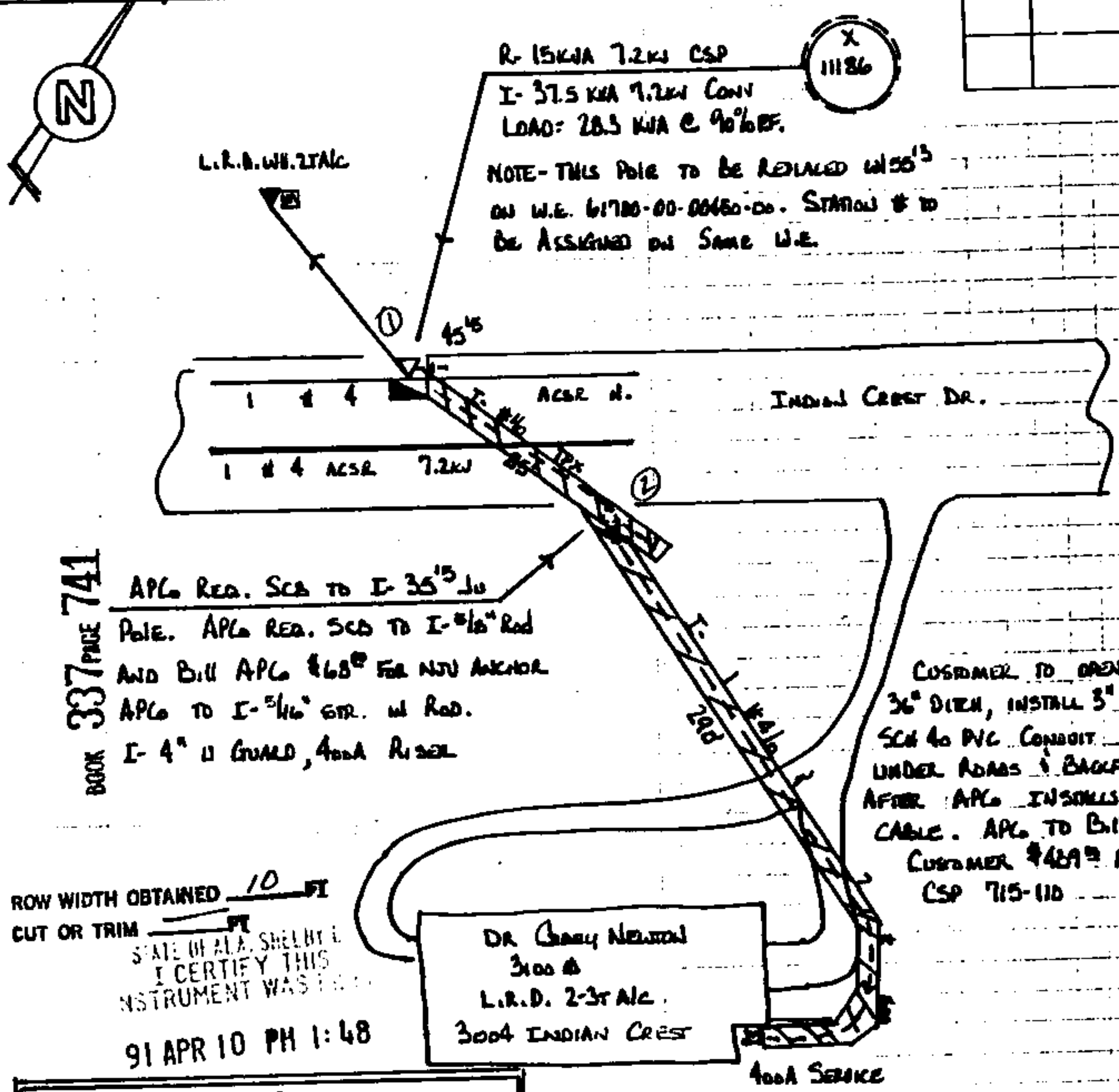

Voltage	
Pri	Sec.
7.2	120/240
PHONE CO.	
Co. Name SCB	
CATV CO.	
Co. Name	
ACCESSIBLE	
TREE CREW	
ROCK HOLE	
PERMITS REQ'D	
R/W	
CITY	
COUNTY	
STATE	
MISSALL	
OTHER	
SCALE	
NTS	
FL. Per Inch	