

AN EASEMENT IN TWO PARTS

FOR THE CONSTRUCTION, OPERATION, AND MAINTENANCE

OF A WATER LINE BY THE WATER WORKS BOARD OF THE CITY OF CALERA, ALABAMA

This EASEMENT, executed this 15 day of Sept., 1986, for the construction, operation, and maintenance of a water line, with appurtenances, by the CITY OF CALERA, across the property of the LANDOWNER, Willodean Simmons located in Section 2, Township 22S, Range 2W, in SHELBY County, Alabama, as shown on the sketch below. granted by the LANDOWNER to the BOARD for valuable considerations, the receipt and sufficiency of which are acknowledged by the LANDOWNER, for himself, and his heirs, executors, successors, and assigns. The easement is in two parts, described below:

PART I. A temporary construction easement 15 feet each side of the centerline of the water line, for construction of the water line as described below, to allow the BOARD'S Contractor and employees and agents of the WATER WORKS BOARD to construct the water line. The construction shall be with due regard to the property of the LANDOWNER. Clearing of trees, shrubs, and other growth is permitted within the construction easement. Debris will be removed from the property, and clean up accomplished. This easement is granted for the duration of the water line construction contract, and shall end when that contract is closed.

PART II. A permanent easement, 10 feet each side of the centerline of the water line, to go with the land, to allow the WATER WORKS BOARD, its employees and agents to operate, repair and maintain the water line, including the right of access by the WATER WORKS BOARD, its employees, agents, or officials and necessary related equipment. Included is the right to uncover the water line, with the obligation to leave the LANDOWNER'S property in good repair after completion of any repair to the water line. It is understood that construction of permanent structures, with the exclusion of parking lots, roadways and driveways on the above described easement is prohibited.

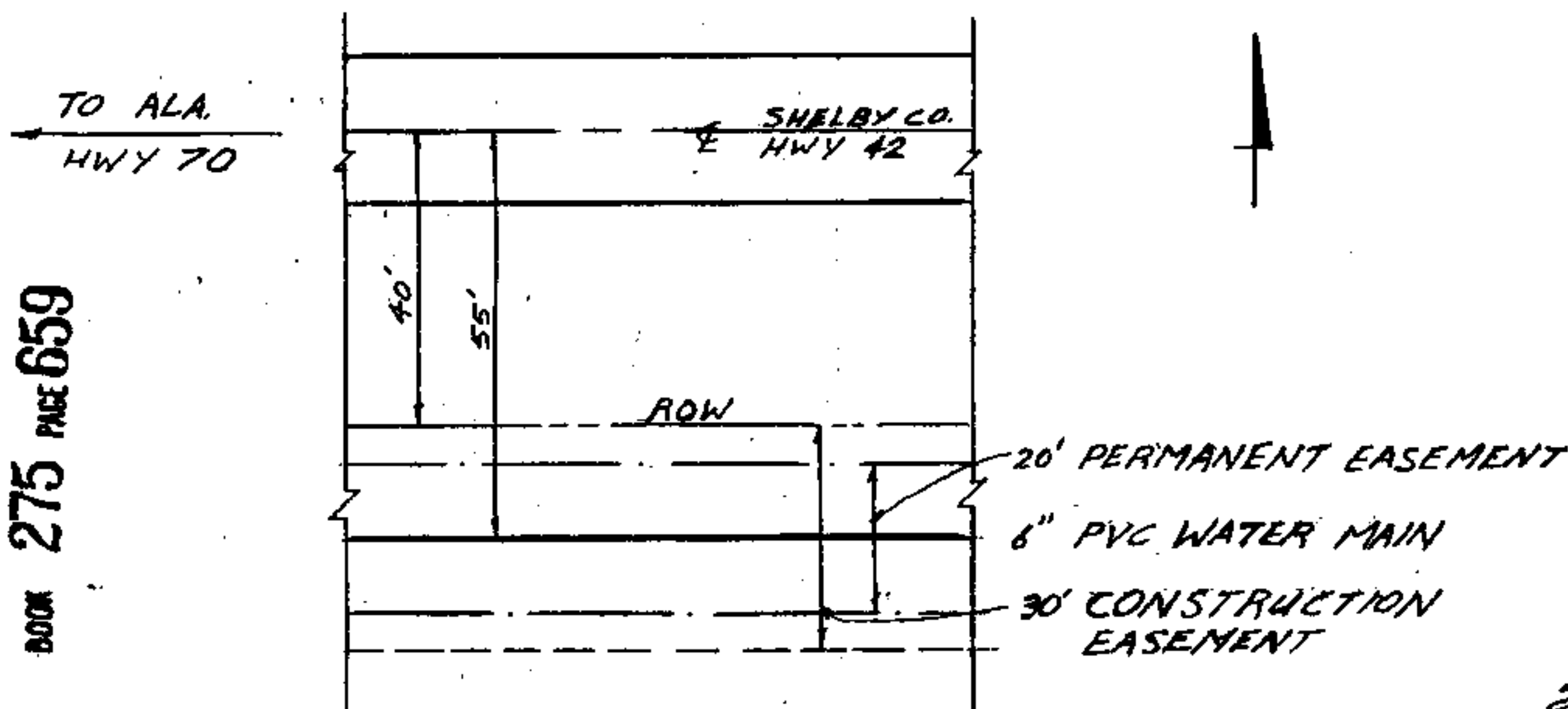

GENERALIZED SKETCH OF EASEMENT (NOT TO SCALE)

Executed the date shown above in three copies.

LANDOWNER:

By: Willodean Simmons

By: _____

WITNESS: JUDGE OF PROBATE
By: Derry L. Ryan

For the WATER WORKS BOARD OF THE CITY OF CALERA:
By: J. S. Rowe, Chairman

WITNESS: Lerame P. Taylor

Recorded the _____ day of _____, 1986, in Deed Book _____ Page _____, of the public records of SHELBY County, Alabama.

City of Calera