

535636

361

STATE OF ALABAMA)

WE # 61700-08-0037-9-00

County of Shelby)

STA 1 + 00 to STA 11 + 3/4
ALSO: ALL SERVICE LATERALS

KNOW ALL MEN BY THESE PRESENTS, that the undersigned, The Harbert-Equitable Joint Venture, for and in consideration of the sum of One and no/100 (\$1.00), to it in hand paid by Alabama Power Company, a corporation, the receipt whereof is acknowledged does hereby grant to said Alabama Power Company, its successors and assigns, the right to construct, install, operate and maintain, and the right to permit other corporations and persons to construct, install, operate and maintain, along routes to be selected by the grantee, (generally shown crosshatched on the attached drawing) its successors or assigns, all poles, wires, conduits, cables, trans closures and other appliances and facilities useful or necessary in connection therewith for the overhead and underground transmission and distribution of electric power and for the overhead and underground communication service upon, over, under and across the following described land situated in Shelby County, Alabama.

Riverchase Country Club 30th Addition

as recorded in Map Book 13, page 88

in the Office of the Judge of Probate.

GRANTEE'S ADDRESS
ALABAMA POWER CO.
P. O. BOX 2641
BIRMINGHAM, AL 35291
ATT. CORP. REAL ESTATE

This instrument prepared in
the Corporate Real Estate
Dept. of Alabama Power Co.
Birmingham, Ala.

By D. H. Rew

Together with all the rights and privileges necessary or convenient for the full enjoyment or use thereof, including the right of ingress and egress to and from said facilities and the right to excavate for installation, replacement, repair and removal thereof; and also the right to cut and keep clear all trees, underbrush, shrubbery, roots and other growth and to keep clear any and all obstructions or obstacles or whatever character on, under or above said facilities.

TO HAVE AND TO HOLD the same to the said Alabama Power Company, its successors and assigns forever.

IN WITNESS WHEREOF, the said Harbert-Equitable Joint Venture has caused this instrument to be executed in its name by

James O. Rein as its Vice-President
witnessed and attested by Joseph E. McKay as its Manager
on this the 18th day of September 1989.

HARBERT-EQUITABLE JOINT VENTURE

witness
Attest:

Joseph E. McKay

THE HARBERT-EQUITABLE JOINT VENTURE
Under Joint Venture Agreement Dated January 30, 1974
BY: HARBERT LAND CORPORATION
AS MANAGING VENTURER

BY:

James O. Rein
ITS V.P.

STATE OF Alabama)
County of Shelby)

I, Jada R. Hilger,

a Notary Public, in and for said State, hereby certify that

James O. Reiss whose name as
Vice-President of said corporation, is

signed to the foregoing instrument, and who is known to me,
acknowledged before me on this day that, being informed of the
contents of this instrument, he as such officer and with full
authority executed the same voluntarily for and as the act of
said corporation.

Given under my hand and official seal, this the

18th day of September, 1989.

Jada R. Hilger
Notary Public

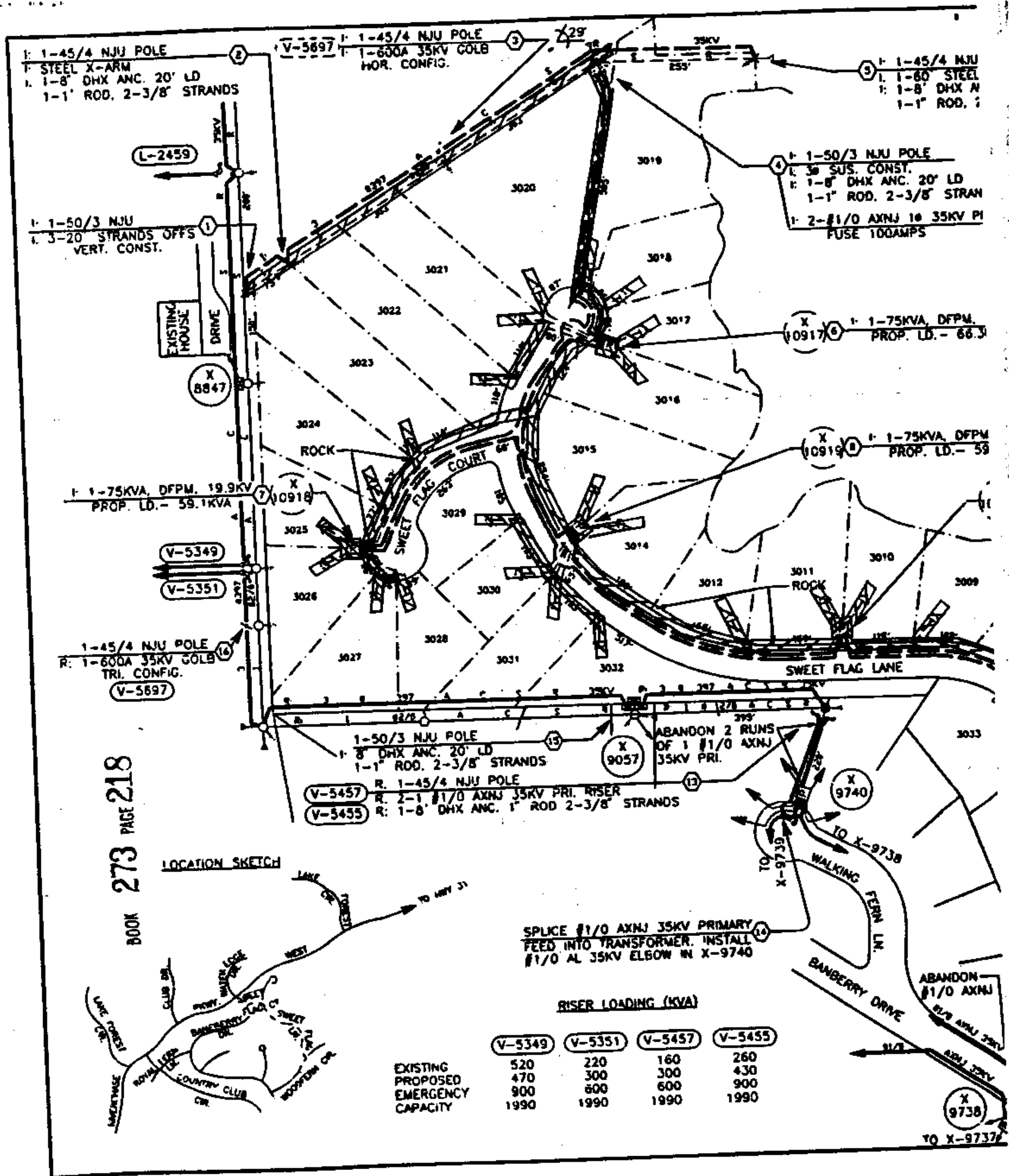

POLE
X-ARM
VC. 20' LD
-3/8" STRANDS

DS
RISERS: V-5455
V-5457

19.9KV
1KVA

ROW WIDTH OBTAINED 10 FT
CUT OR TRIM 10 FT

19.9KV
1KVA

X 1-50KVA, DFPM, 19.9KV
1920 PROP. LD. - 42.9KVA

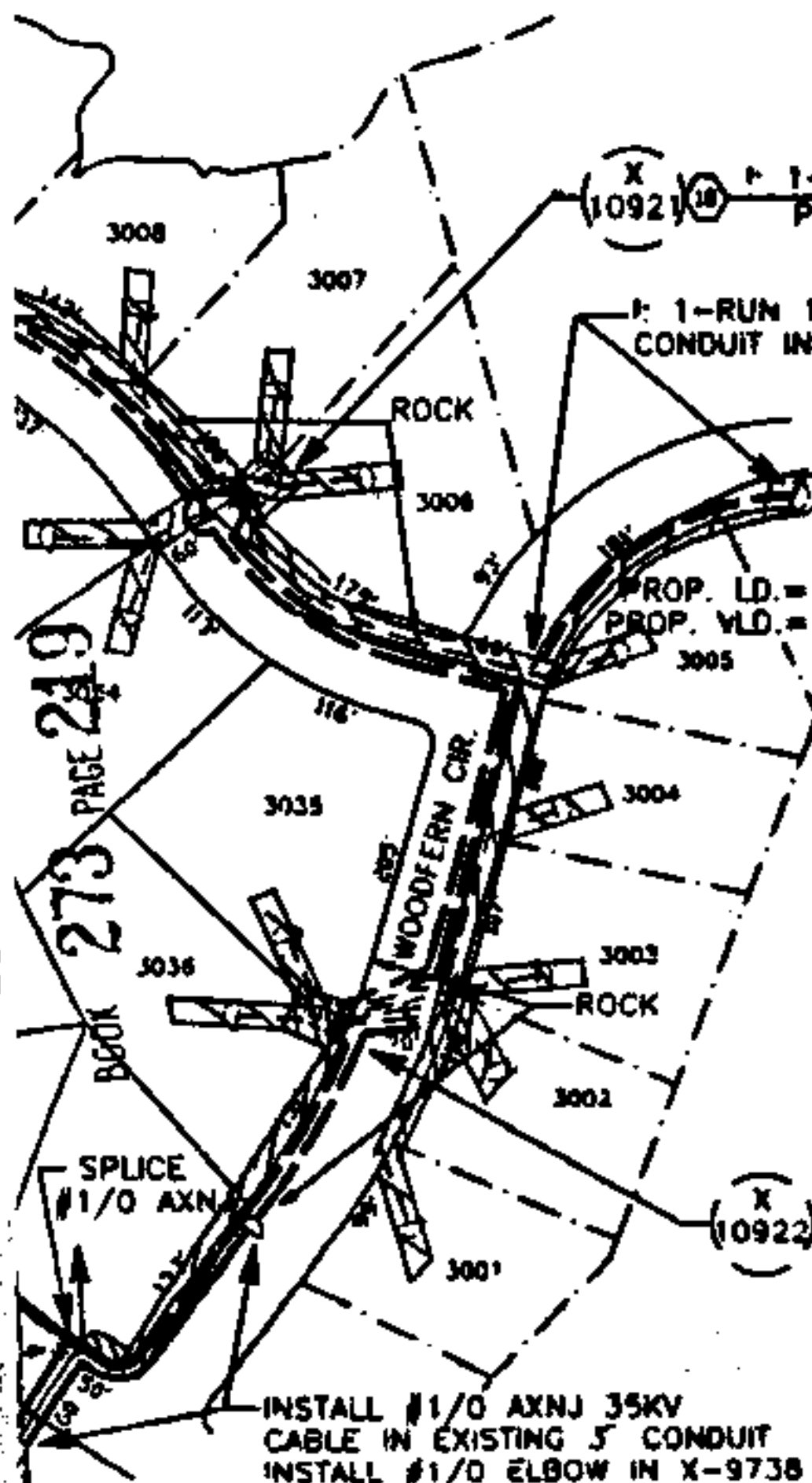

- NOTES
1. THE PRIMARY CONDUCTOR WILL BE 1 #1/0 AXNJ 35KV CABLE IN A 54" TRENCH UNLESS NOTED OTHERWISE.
 2. THE SECONDARY AND SERVICE CONDUCTORS WILL BE 1 #1/0 & 2 #3/0 XLP AL 600V CABLE. THE SECONDARY WILL BE IN A 48" TRENCH AND THE SERVICE IN A 36" TRENCH.
 3. THE PRIMARY CONDUCTOR WILL BE INSTALLED IN 3" DB PVC CONDUIT ON ALL ROAD CROSSINGS AND ON ALL RUNS ALONG PROPERTY LINES. THE SECONDARY WILL BE INSTALLED IN 2" DB PVC CONDUIT ON ALL ROAD CROSSING.
 4. APCO CONTRACTOR WILL PERFORM ALL TRENCHING AND INSTALL TRANSFORMER PADS, GROUND RODS, CONDUIT, PRIMARY, SECONDARY, AND SERVICE CONDUCTORS.
 5. THE TRANSFORMER LOADING IS BASED ON LRD 4T A/C.
 6. THE RISER LOADING IS BASED ON 10KVA PER LOT.
 7. THE AVERAGE SERVICE LENGTH IS 70 FEET.
 8. A 200A FAULT INDICATOR WILL BE INSTALLED IN EACH TRANSFORMER.
 9. THE VOLTAGE DROP AND FLICKER VOLTAGE DROP SHOWN IS THE WORST (SEE LOT 3005).
 10. LOTS 3019, 3020, 3021, 3022, & 3023 WILL BE EXCLUDED FROM THE RESTRICTED COVENANTS OF ALABAMA POWER COMPANY.
 11. THE MAIN OVERHEAD FEEDER LINE WILL BE BUILT 15' INSIDE OF THE PROPERTY LINE DUE TO RIGHT OF WAY REFUSAL.

35KV SECTIONALIZING

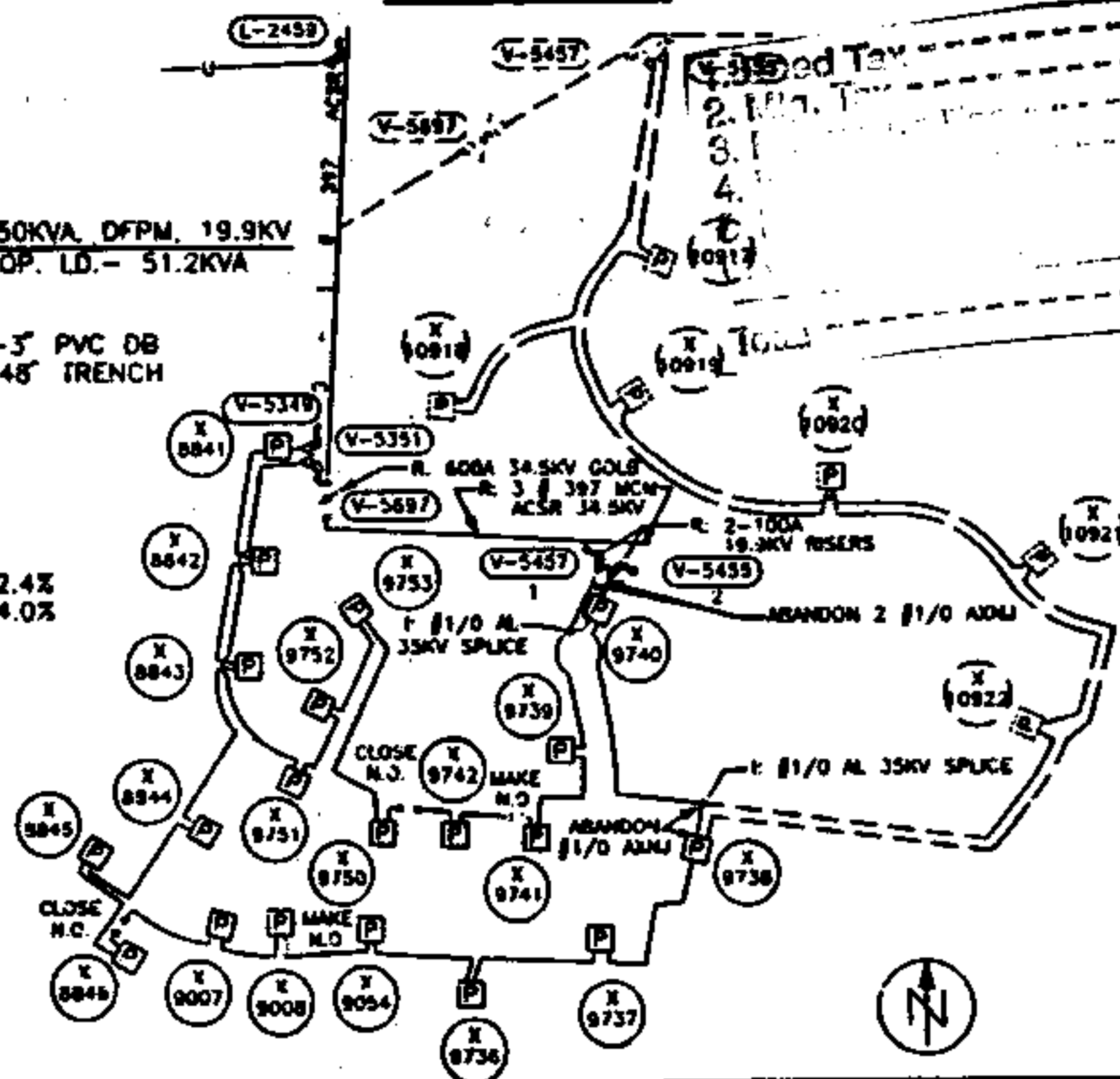

X 1-75KVA, DFPM, 19.9KV
10922 PROP. LD. - 59.1KVA

MAP REF: SW-19-35-1&2 SEC-3W.TP-19 R-35

DRAWN: RONN CHECKED: COCKRELL TRACED: 6-29-89
APPROVED: DATE: APPROVED: DATE:

ALABAMA POWER COMPANY

330 NORTH SHELBY 34.5 DIST. SYSTEM
DETAIL: PROVIDE 120/240V SERV TO 35 LOTS
RIVERCHASE COUNTRY CLUB WITH 400

SCALE: 1" = 100' H/M
SHEET 1 OF 1 SHEETS
SUPERSEDES: C-61700-08-00379-00

STATE OF ALA. SHELBY CO.
I CERTIFY THAT THIS
INSTRUMENT WAS FILED
90 JAN 18 1989
JUDGE F. OGBA

50-
2.50
3.00
1.00
17.00

9-26-89