

804

533561

STATE OF ALABAMA )

WE # 61700-06-0012-9-00

County of Shelby )

STA 1 + 00 to STA 2 + 15WE 61700-00-0155-9-00STA 1+00 To STA 3+480 (WEST)STA 3+480 To STA 4+00

KNOW ALL MEN BY THESE PRESENTS, that the undersigned, Harbert Properties Corporation, for and in consideration of the sum of One and no/100 (\$1.00), to it in hand paid by Alabama Power Company, a corporation, the receipt whereof is acknowledged does hereby grant to said Alabama Power Company, its successors and assigns, the right to construct, install, operate and maintain, and the right to permit other corporations and persons to construct, install, operate and maintain, along routes to be selected by the grantee, (as generally shown crosshatched on Exhibit A attached hereto and made a part hereof) its successors or assigns, all poles, wires, conduits, cables, translosures and other appliances and facilities useful or necessary in connection therewith for the overhead and underground transmission and distribution of electric power and for the overhead and underground communication service upon, over, under and across the following described land situated in Shelby County, Alabama.

This instrument prepared in  
Corporate Real Estate  
dept. of Alabama Power Co.  
Birmingham, Ala.

By R. C. Coggin

GRANTEE'S ADDRESS  
ALABAMA POWER CO.  
P. O. BOX 2641  
BIRMINGHAM, AL 35201  
ATT: CORP. REAL ESTATE

BOOK 270 PAGE 122

The construction, installation, operation and maintenance of such appliances and facilities by Alabama Power Company, its successors and assigns, shall comply with all jurisdictional codes and deed restrictions applicable to the property which is subject to this agreement, including the Declaration of Protective Covenants, Agreements, Easements, Charges and Liens for Riverchase (Business) as amended and recorded in Miscellaneous Book 19, beginning at page 633, in the Office of the Judge of Probate of Shelby County, Alabama which may restrict the construction, installation, operation and maintenance of overhead utility lines on the subject property.

*A TRACT OF LAND IN SECTION 30, TOWNSHIP 19 SOUTH, RANGE 3 WEST DESCRIBED AS FOLLOWS: COMMENCE AT THE SOUTHEAST CORNER OF THE NORTHEAST QUARTER OF THE SOUTHWEST QUARTER OF SAID SECTION 30, THENCE NORTH ALONG THE EAST LINE 770 FEET TO THE POINT OF BEGINNING; THENCE LEFT 90°00' AND RUN 220 FEET; THENCE RIGHT AND PARALLEL WITH THE WEST LINE OF LITTLE VALLEY COURT RUNNING NORTHERLY 800 FEET; THENCE RIGHT 90°00' AND RUN 150 FEET, MORE OR LESS TO THE EAST LINE OF THE SOUTHEAST QUARTER OF THE NORTHWEST QUARTER OF SAID SECTION 30; THENCE RIGHT AND SOUTHERLY ALONG SAID EAST LINE 80 FEET TO A POINT ON THE SOUTH LINE OF LITTLE VALLEY COURT; THENCE LEFT AND EASTERLY ALONG LITTLE VALLEY COURT 640 FEET TO THE WEST LINE OF RIVERCHASE PARKWAY EAST; THENCE RIGHT AND SOUTHERLY ALONG SAID PARKWAY 600 FEET; THENCE RIGHT 76°05' AND RUN 500 FEET; THENCE RIGHT 38°00' AND RUN 400 FEET TO THE POINT OF BEGINNING.*

*LESS & EXCEPT ANY PART OF THE ABOVE DESCRIBED WITHIN THE DEDICATED ROAD RIGHT OF WAY.*

BOOK 270 PAGE 124

Together with all the rights and privileges necessary or convenient for the full enjoyment or use thereof, including the right of ingress and egress to and from said facilities and the right to excavate for installation, replacement, repair and removal thereof; and also the right to cut and keep clear all trees, underbrush, shrubbery, roots and other growth except ornamental trees and shrubs which might be planted by Harbert Properties Corporation and which will not interfere or obstruct said facilities and to keep clear any and all obstructions or obstacles or whatever character on, under or above said facilities.

TO HAVE AND TO HOLD the same to the said Alabama Power Company, its successors and assigns forever.

IN WITNESS WHEREOF, the said Harbert Properties Corporation has caused this instrument to be executed in its name by

Michael P. White as its Vice President  
and attested by S. Perry Quinn Jr. as its Secretary  
on this the 14th day of July 1989.

HARBERT PROPERTIES CORPORATION

[Signature]  
VICE PRESIDENT

Attest:

[Signature]

STATE OF Alabama )  
County of Shelby )

I, Richard M. Chapman,

a Notary Public, in and for said State, hereby certify that

Michael P. White whose name as  
Vice President of said corporation, is

signed to the foregoing instrument, and who is known to me,  
acknowledged before me on this day that, being informed of the  
contents of this instrument, he as such officer and with full  
authority executed the same voluntarily for and as the act of  
said corporation.

Given under my hand and official seal, this the

14th day of July, 1989.

Richard M. Chapman  
Notary Public

# SKETCH OF PROPOSED WORK

EXHIBIT 'A'  
Alabama Power

WE No. 61700-06-00128-00		Customer THE CONCOURSE PHASE I			Estimate No.	
Division BHAM		District N. SHELBY		Town HOOVER		Drawn By E. BIDEZ
Scale Ft. Per Inch	Section 30	Township 19S	Range 3W	Map Reference 3W-19-30-4	Date 2-3-89	

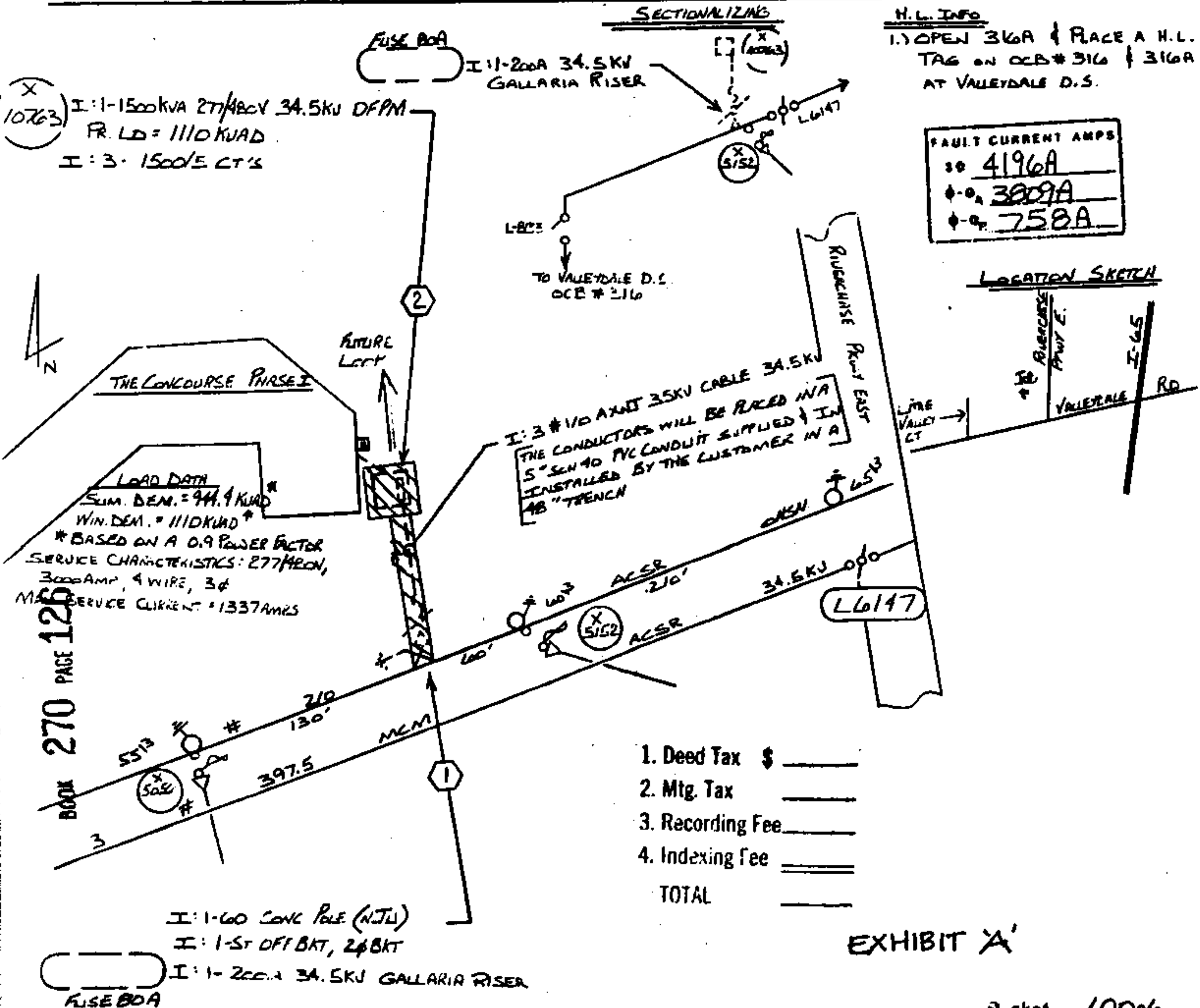

EXHIBIT 'A'

Bucket 100%  
Transl. Cont. CRANE  
Hole & Hole -  
Shovel -  
Time Crew -  
Shovel YES  
Permit RW, MESSAL, SEE  
th -

# SKETCH OF PROPOSED WORK

Alabama Power

WE No.	61700-00-01559-00			Customer	SOUTH CENTRAL BELL		Estimate No.	
Division	BHAM		District	N. SHELBY		Town	HOOVER	
Scale	Pt. Per Inch		Section	30		Range	3W	
			Township	19S		Map Reference	3W-A-30-2	
						Date	6-29-89	

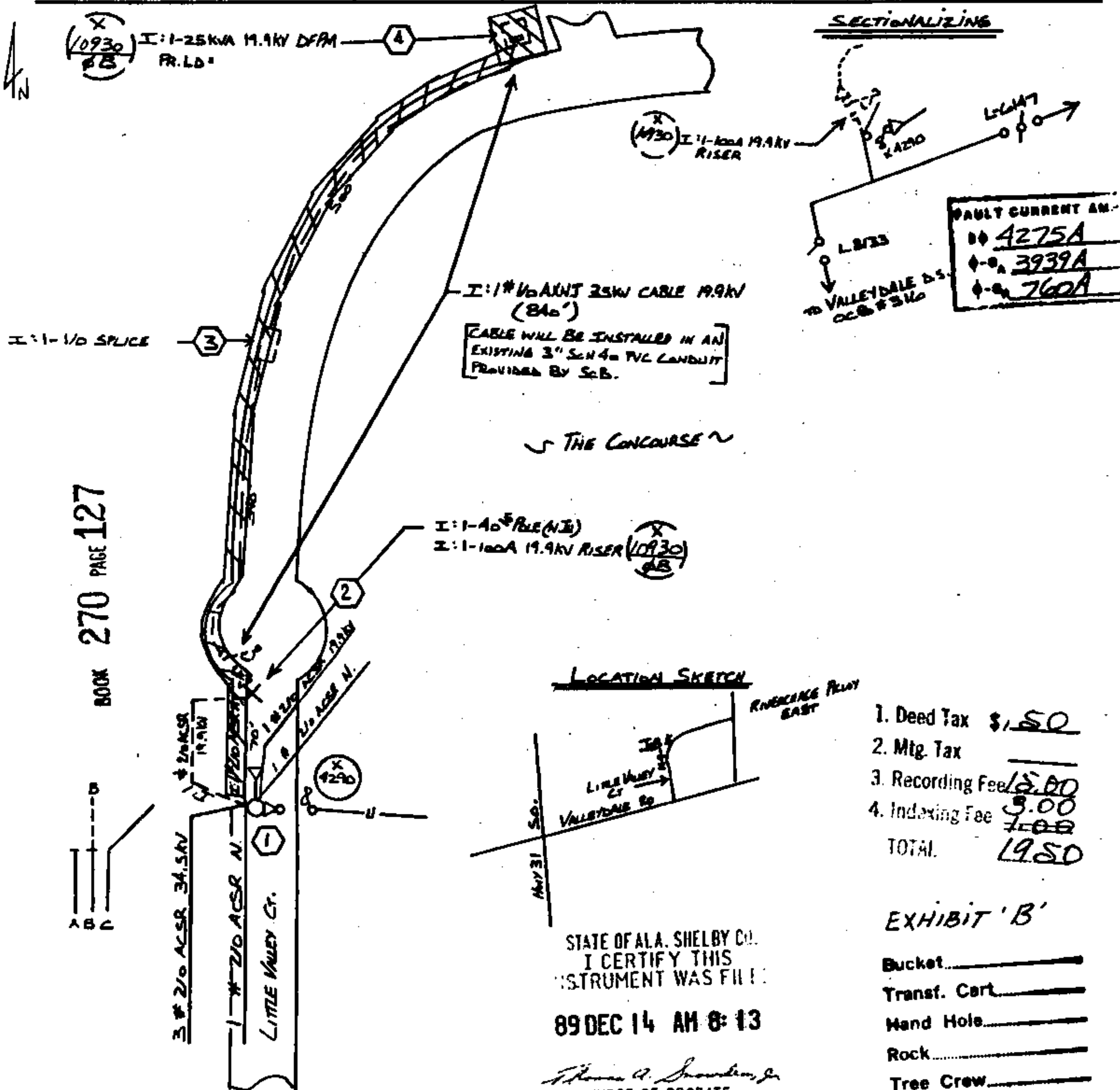

BOOK 270 PAGE 127

STATE OF ALA. SHELBY CO.  
I CERTIFY THIS  
INSTRUMENT WAS FILED

89 DEC 14 AM 8:13

Thomas A. Shanderson, Jr.  
JUDGE OF PROBATE

1. Deed Tax \$1.50
  2. Mtg. Tax
  3. Recording Fee 15.00
  4. Indexing Fee 3.00
- TOTAL 19.50

EXHIBIT 'B'

- Bucket
- Transf. Cart
- Hand Hole
- Rock
- Tree Crew
- Staked
- Permit
- Work with