

517869

STATE OF Alabama)WE NUMBER 64600000505800COUNTY OF Shelby)

KNOW ALL MEN BY THESE PRESENTS, that the undersigned,

Homer C. Joiner and wife, Barbara H. Joiner

in consideration of the sum of One and No/100 Dollars (\$1.00) to Us
in hand paid by Alabama Power Company, a corporation, the receipt whereof
is acknowledged, We hereby grant to said Alabama Power Company, its
successors and assigns, the right to construct, install, operate and maintain,
and the right to permit other corporations and persons to construct, install,
operate and maintain, along routes to be selected by the grantee (generally
shown crosshatched on the attached drawing), its successors or assigns,
all poles, wires, conduits, cables, trans closures and other appliances
and facilities useful or necessary in connection therewith for the overhead
and underground transmission and distribution of electric power and for
the overhead and underground communication service, upon, over, under and
across the following described land, situated in Shelby County,
Alabama:

The South $\frac{1}{2}$ of the North $\frac{1}{2}$ of the Northeast $\frac{1}{4}$ of the Southwest $\frac{1}{4}$
of Section 19, Township 21 South, Range 1 East.

GRANTEE'S ADDRESS
ALABAMA POWER CO.
P. O. BOX 2841
BIRMINGHAM, AL 35201
ATT: CORP. REAL ESTATE

This instrument prepared in
the Corporate Real Estate
Dept. of Alabama Power Co.
Birmingham, Ala.

By R. C. Coggins

BOOK 220 PAGE 473

Together with all the rights and privileges necessary or convenient for the full enjoyment or use thereof, including the right of ingress and egress to and from said facilities and the right to excavate for installation, replacement, repair and removal thereof; and also the right to cut and keep clear all trees, underbrush, shrubbery, roots and other growth, and to keep clear any and all obstructions or obstacles of whatever character on, under or above said facilities.

• TO HAVE AND TO HOLD the same to the said Company, its successors and assigns, forever.

IN WITNESS WHEREOF, we have hereunto set our hands and seals, this the

3rd day of August, 1988.

WITNESS:

Homer C Joiner (Seal)
Barbara H Joiner (Seal)

STATE OF Alabama)
COUNTY OF Shelby)

I, Larry D. Grouitt, a Notary Public, in and for said County in said State, hereby certify that Homer C. Joiner and wife, Barbara H. Joiner whose names are signed to the foregoing instrument and who are known to me, acknowledged before me on this day that being informed of the contents of the instrument They executed the same voluntarily, on the day the same bears date.

Given under my hand and official seal, this the 3rd day of

August, 1988.

Larry D. Grouitt
Notary Public, Shelby County, Alabama

ALABAMA POWER COMPANY

WE NO. 6460000050588DIVISION WEST

SKETCH OF PROPOSED WORK

ESTIMATE NO. _____

TOWN CLMBA DISTRICT MTVLO DRAWN BY BRITNELL DATE 7-15-88SCALE NTS FT. PER INCH SECT. 19 TOWNSHIP 21S RANGE 1E MAP REFERENCE 20793#6

X = 52770

Y = 6152

Z = Q

LOCATION 1.
R & I - SEC. DE.
25 KVA IN PLACE
C.L. = 20 KVA

LOCATION 2.
R & I - SEC. DE.
I - SVC. RISER.

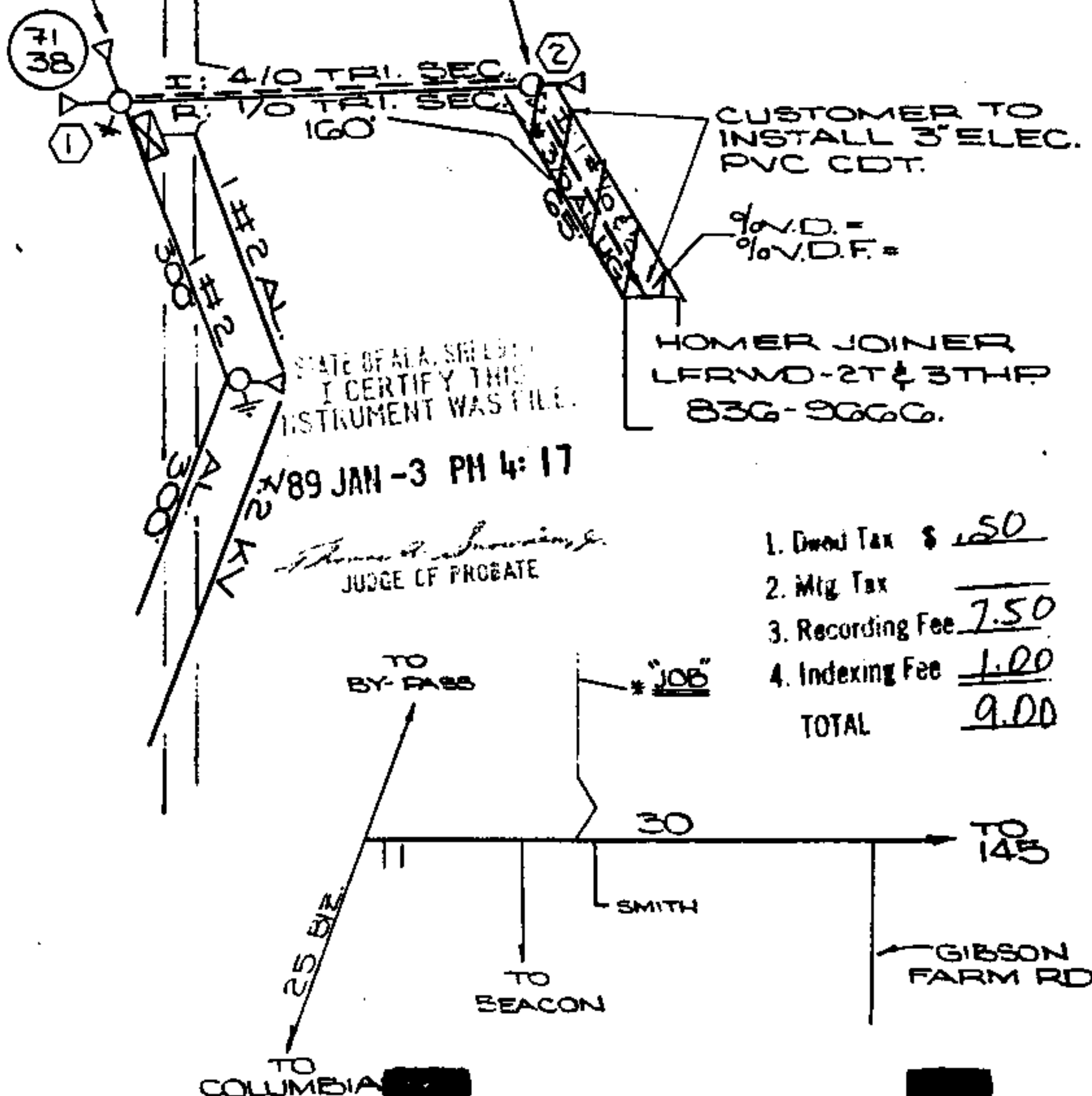

STATE OF ALA. SHEDDEN
I CERTIFY THIS
INSTRUMENT WAS FILED.

89 JAN -3 PM 4:17

Thomas H. Shedd, Jr.
JUDGE OF PROBATE

1. Dwdl Tax	\$ 1.50
2. Mtg Tax	
3. Recording Fee	7.50
4. Indexing Fee	1.00
TOTAL	9.00

TO
BY-PASS

*JOB

30

SMITH

TO
BEACON

TO
145

GIBSON
FARM RD.

TO
COLUMBIA

STANDARD SYMBOLS FOR THE DISTRIBUTION STANDARDS TO BE USED

BOOK 220 PAGE 481