

516988

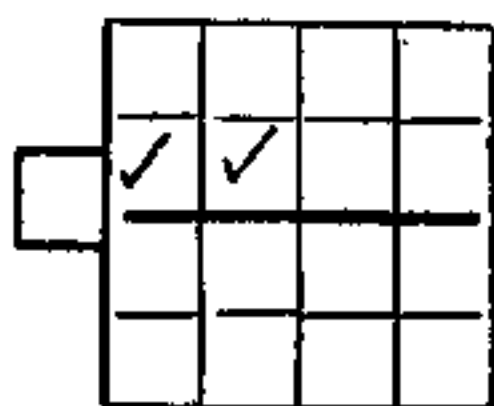

WB # 61700-00-0169-8-00

STATE OF ALABAMA,

County of Shelby

KNOWN ALL MEN BY THESE PRESENTS, that the undersigned,

Pelham Christian Fellowship

in consideration of the sum of One and No/100 Dollars (\$1.00), to it in had paid by Alabama Power Company, a corporation, the receipt whereof is acknowledged, does hereby grants to said Alabama Power Company, its successors and assigns, the right to construct, install, operate and maintain, and the right to permit other corporations and persons to construct, install operate and maintain, along routes to be selected by the grantee, (generally shown crosshatched on the attached drawing) its successors or assigns, all poles, wires, conduits, cables, translosures and other appliances and facilities useful or necessary in connection therewith for the overhead and underground transmission and distribution of electric power and for the overhead and underground communication service, upon, over, and under and across the following described land, situated in Shelby County, Alabama.

A tract of land in the South one half of the Northwest Quarter of Section 13, Township 20 South, Range 3 West, Shelby County, Alabama described as follows: Commence at the Southwest corner of said South one half and run Easterly along the South line a distance of 680 feet to the West line of Vance Street and the Point of Beginning; thence left 90 degrees 00 minutes and run 700 feet more or less to the South line of Court Place; thence right and Easterly along said Court Place a distance of 1320 feet to a point; thence right 90 degrees 00 minutes and run Southerly 700 feet more or less to the South line of said South one half; thence right and Westerly along South line to the Point of Beginning.

This instrument prepared in  
the Corporate Real Estate  
Dept. of Alabama Power Co.  
Birmingham, Ala.

By R. C. Capps

GRANTEE'S ADDRESS  
ALABAMA POWER CO.  
P. O. BOX 2641  
BIRMINGHAM, AL 35291  
ATT: CORP. REAL ESTATE

Together with all the rights and privileges necessary or convenient for the full enjoyment or use thereof, including the right of ingress and egress to and from said facilities and the right to excavate for installation, replacement, repair, and removal thereof; and also the right to cut and keep clear all trees, underbrush, shrubbery, roots and other growth, and to keep clear any and all obstructions or obstacles of whatever character on, under or above said facilities.

TO HAVE AND TO HOLD the same to the said Alabama Power Company, its successors and assigns forever.

IN WITNESS WHEREOF, the said Pelham Christian Fellowship has caused this instrument to be executed in its name by Jerry Bishop as its Pastor/President, and attested by Julia Bishop as its Secretary, and its corporate seal to be hereto affixed, on this the 18<sup>th</sup> day of July, 1988.

Attest:

Pelham Christian Fellowship

Jerry Bishop / Pastor

STATE OF Alabama

COUNTY OF Shelby

I, Donna Little, a Notary Public, in and for said County in said State, hereby certify that Jerry Bishop whose name as Pastor of Pelham Christian Fellowship a corporation, is signed to the foregoing instrument, and who is known to me, acknowledged before me on this day that, being informed of the contents of this instrument, he as such officer and with full authority executed the same voluntarily for and as the act of said corporation.

Given under my hand and official seal, this the 18<sup>th</sup> day of July, 1988.

Donna Little  
Notary Public

# SKETCH OF PROPOSED WORK

Alabama Power 

WE No. 61700-00-01698-00		Customer PELHAM CHRISTIAN FELLOWSHIP		Estimate No.	
Division BIRMINGHAM		District NORTH SHELBY		Town PELHAM	
Scale N.T.S. Ft. Per Inch		Section 13		Range 3W	
		Township 20-5		Map Reference 3W-20-13-2	
				Date 5-20-88	
				Drawn By J. SCHIFANO	

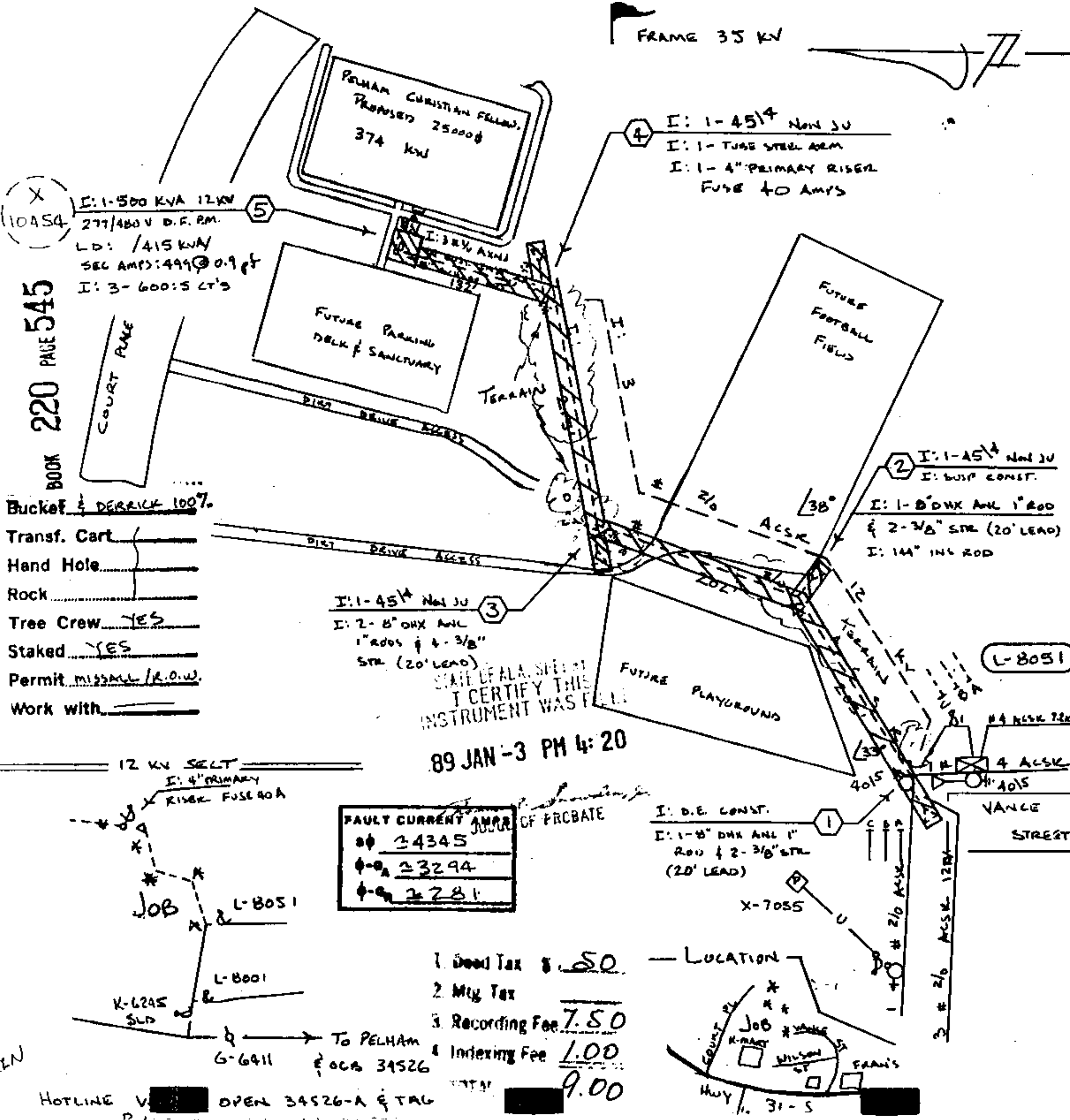

- Bucket & DERRICK 100%
- Transf. Cart
- Hand Hole
- Rock
- Tree Crew YES
- Staked YES
- Permit MISSALL / R.O.W.
- Work with

FAULT CURRENT AMPS	
#	34345
#	3294
#	2281

89 JAN -3 PM 4:20

- 1. Down Tax \$ 50
- 2. Mig. Tax
- 3. Recording Fee 7.50
- 4. Indexing Fee 1.00
- TOTAL 9.00

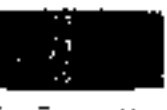

HOTLINE V  OPEN 34526-A & TAG