

SCB AUTH. # 834-7176  
SCB ROW # C-0876

2578 Comanche Trail  
Birmingham, Alabama  
(Shelby County)

652

I hereby give permission for utilities, gas, power and water, or any of them, to cross my property located on Highway 30, containing approximately 17 acres, Columbiana, Alabama, making said utilities available to adjoining acreage owned by Raymond and Margaret Lyon and to property adjoining theirs belonging to Byron and Sherry White.

Dated this 29th day of March, 1987.

Elna S. Usher  
Elna S. Usher

Sherry K. Petty  
Witness  
Garrett Brewer  
Witness

1. Deed Tax \$ .50  
2. Mtg. Tax  
3. Recording Fee 2.50  
4. Indexing Fee 1.00  
TOTAL 4.00

STATE OF ALA. SHELBY CO.  
I CERTIFY THIS  
INSTRUMENT WAS FILED

88 MAY -9 PM 2: 15

Thomas A. Shumaker, Jr.  
JUDGE OF PROBATE

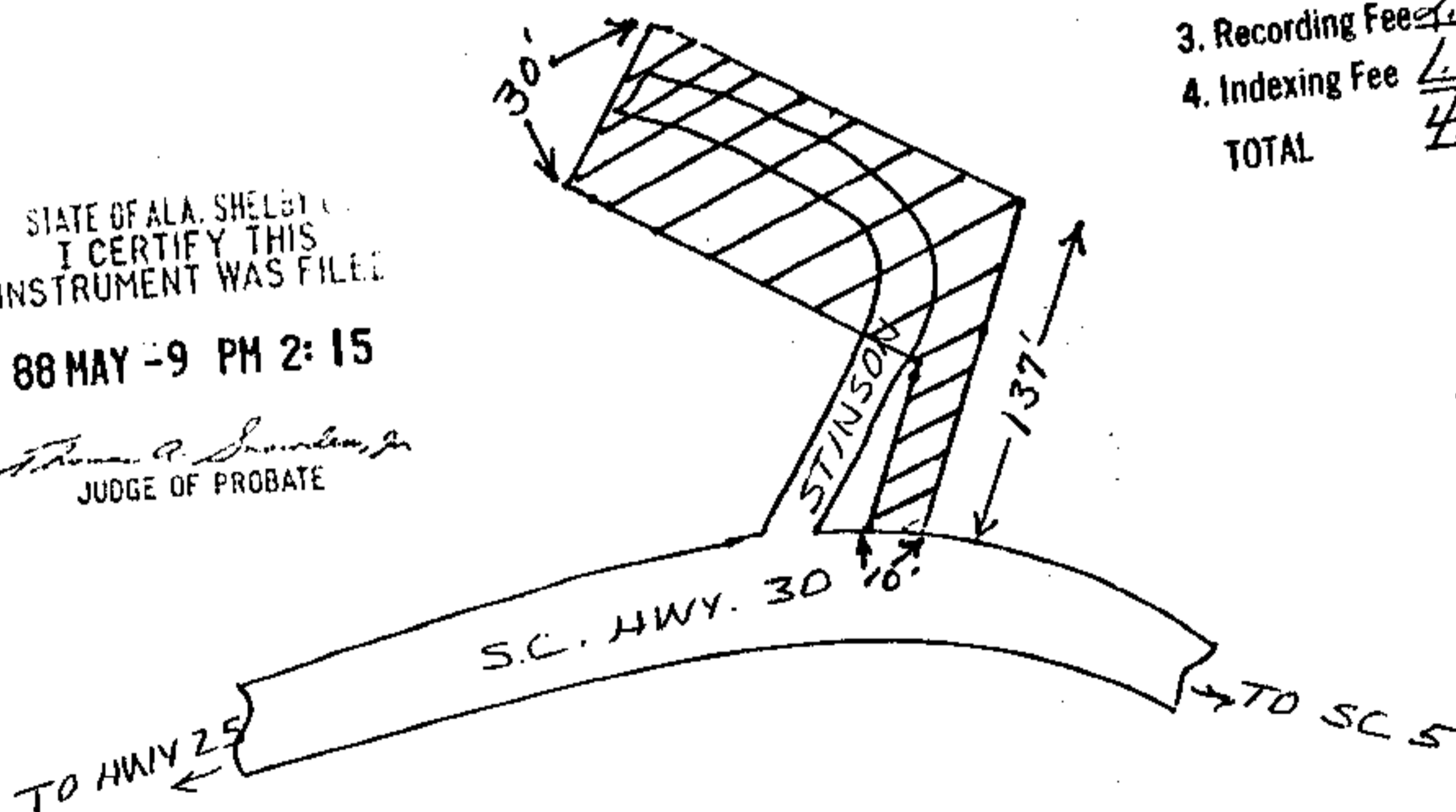

4/5/88

with Notary Bill